



## Yorkshire

Published 1907 - 1908

Source map scale - 1:10,560

The historical maps shown were reproduced from maps predominantly held at the scale adopted for England, Wales and Scotland in the 1840's. In 1854 the 1:2,500 scale was adopted for mapping urban areas; these maps were used to update the 1:10,560 maps. The published date given therefore is often some years later than the surveyed date. Before 1938, all OS maps were based on the Cassini Projection, with independent surveys of a single county or group of counties, giving rise to significant inaccuracies in outlying areas. In the late 1940's, a Provisional Edition was produced, which updated the 1:10,560 mapping from a number of sources. The maps appear unfinished - with all military camps and other strategic sites removed. These maps were initially overprinted with the National Grid. In 1970, the first 1:10,000 maps were produced using the Transverse Mercator Projection. The revision process continued until recently, with new editions appearing every 10 years or so for urban areas.

### Map Name(s) and Date(s)

260NE	1908	1:10,560
260SE	1907	1:10,560

### Historical Map - Slice A

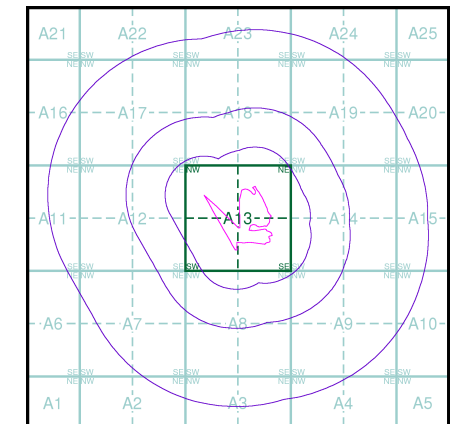

### Order Details

Order Number: 47933383\_1\_1  
 Customer Ref: MLR/07  
 National Grid Reference: 414750, 411150  
 Slice: A  
 Site Area (Ha): 7.51  
 Search Buffer (m): 1000

### Site Details

Land off Woodhead Rd, Brockholes, HOLMFIRTH, HD9 6PR

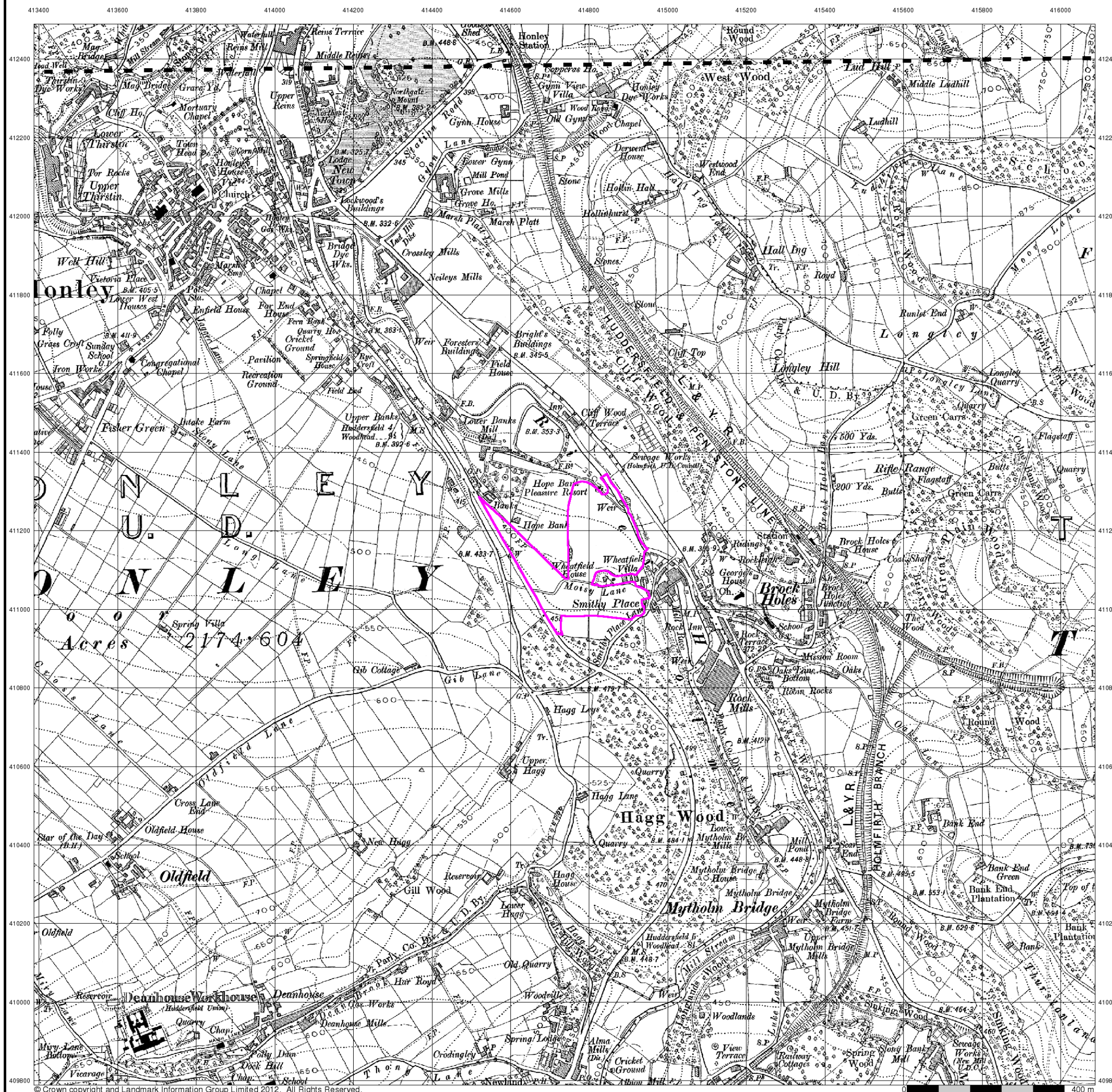



## Yorkshire

**Published 1930**

**Source map scale - 1:10,560**

The historical maps shown were reproduced from maps predominantly held at the scale adopted for England, Wales and Scotland in the 1840's. In 1854 the 1:2,500 scale was adopted for mapping urban areas; these maps were used to update the 1:10,560 maps. The published date given therefore is often some years later than the surveyed date. Before 1938, all OS maps were based on the Cassini Projection, with independent surveys of a single county or group of counties, giving rise to significant inaccuracies in outlying areas. In the late 1940's, a Provisional Edition was produced, which updated the 1:10,560 mapping from a number of sources. The maps appear unfinished - with all military camps and other strategic sites removed. These maps were initially overprinted with the National Grid. In 1970, the first 1:10,000 maps were produced using the Transverse Mercator Projection. The revision process continued until recently, with new editions appearing every 10 years or so for urban areas.

### Map Name(s) and Date(s)

260NE  
 1930  
 1:10,560



### Historical Map - Slice A

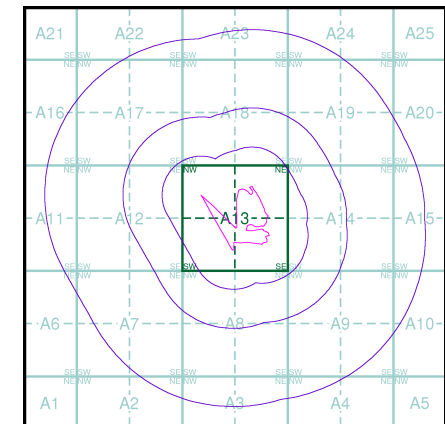

### Order Details

Order Number: 47933383\_1\_1  
 Customer Ref: MLR/07  
 National Grid Reference: 414750, 411150  
 Slice: A  
 Site Area (Ha): 7.51  
 Search Buffer (m): 1000

### Site Details

Land off Woodhead Rd, Brockholes, HOLMFIRTH, HD9 6PR

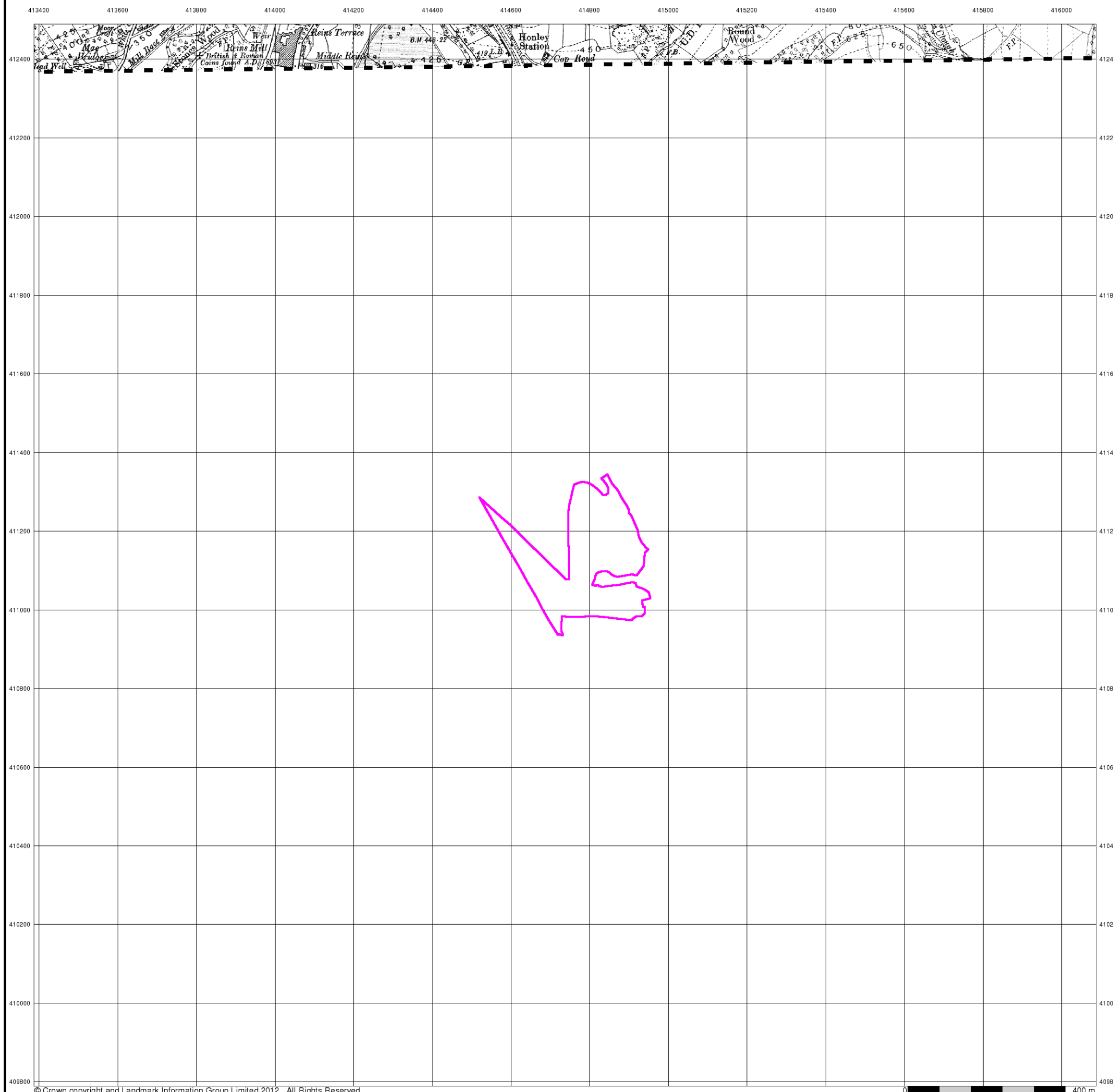



## Yorkshire

Published 1933

Source map scale - 1:10,560

The historical maps shown were reproduced from maps predominantly held at the scale adopted for England, Wales and Scotland in the 1840's. In 1854 the 1:2,500 scale was adopted for mapping urban areas; these maps were used to update the 1:10,560 maps. The published date given therefore is often some years later than the surveyed date. Before 1938, all OS maps were based on the Cassini Projection, with independent surveys of a single county or group of counties, giving rise to significant inaccuracies in outlying areas. In the late 1940's, a Provisional Edition was produced, which updated the 1:10,560 mapping from a number of sources. The maps appear unfinished - with all military camps and other strategic sites removed. These maps were initially overprinted with the National Grid. In 1970, the first 1:10,000 maps were produced using the Transverse Mercator Projection. The revision process continued until recently, with new editions appearing every 10 years or so for urban areas.

### Map Name(s) and Date(s)

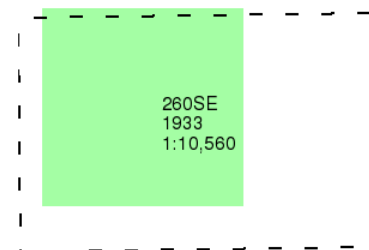

### Historical Map - Slice A

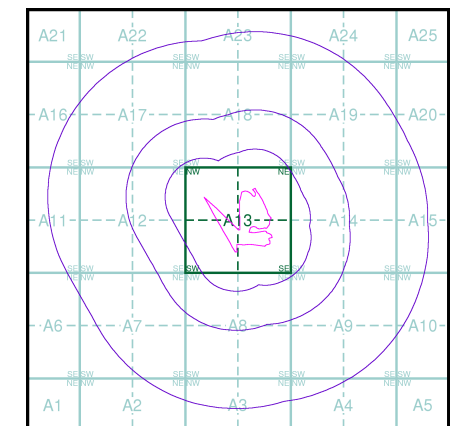

### Order Details

Order Number: 47933383\_1\_1  
Customer Ref: MLR/07  
National Grid Reference: 414750, 411150  
Slice: A  
Site Area (Ha): 7.51  
Search Buffer (m): 1000

### Site Details

Land off Woodhead Rd, Brockholes, HOLMFIRTH, HD9 6PR

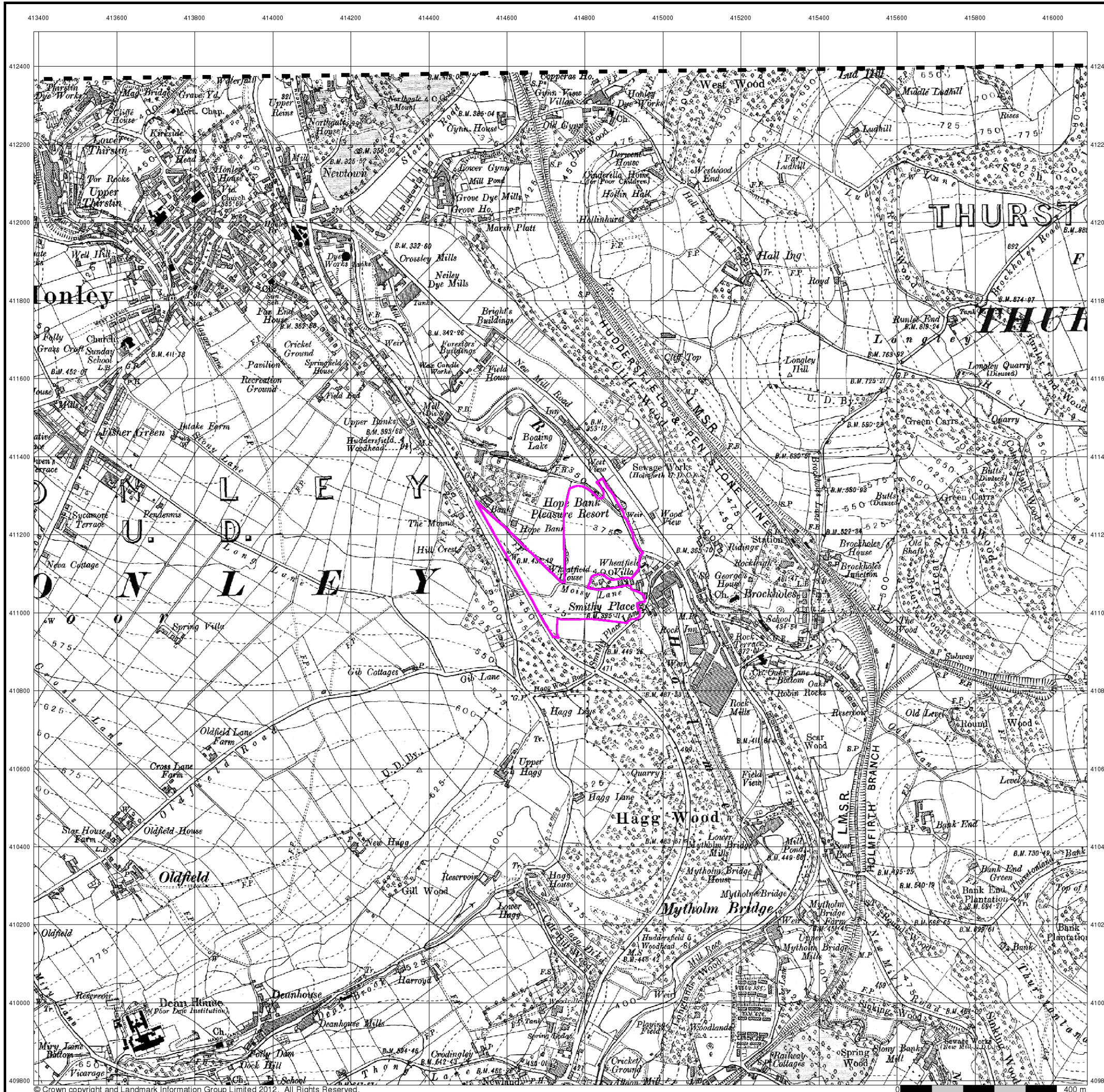



## Yorkshire

Published 1938

Source map scale - 1:10,560

The historical maps shown were reproduced from maps predominantly held at the scale adopted for England, Wales and Scotland in the 1840's. In 1854 the 1:2,500 scale was adopted for mapping urban areas; these maps were used to update the 1:10,560 maps. The published date given therefore is often some years later than the surveyed date. Before 1938, all OS maps were based on the Cassini Projection, with independent surveys of a single county or group of counties, giving rise to significant inaccuracies in outlying areas. In the late 1940's, a Provisional Edition was produced, which updated the 1:10,560 mapping from a number of sources. The maps appear unfinished - with all military camps and other strategic sites removed. These maps were initially overprinted with the National Grid. In 1970, the first 1:10,000 maps were produced using the Transverse Mercator Projection. The revision process continued until recently, with new editions appearing every 10 years or so for urban areas.

### Map Name(s) and Date(s)

260NE	1938	1:10,560
260SE	1938	1:10,560

### Historical Map - Slice A

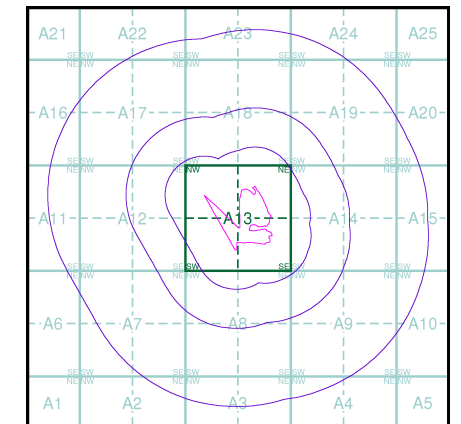

### Order Details

Order Number: 47933383\_1\_1  
 Customer Ref: MLR/07  
 National Grid Reference: 414750, 411150  
 Slice: A  
 Site Area (Ha): 7.51  
 Search Buffer (m): 1000

### Site Details

Land off Woodhead Rd, Brockholes, HOLMFIRTH, HD9 6PR

