

Ground floor

**Type D 'The Gingham'**  
 3B Detached house  
 89m<sup>2</sup>/ 957 sqft

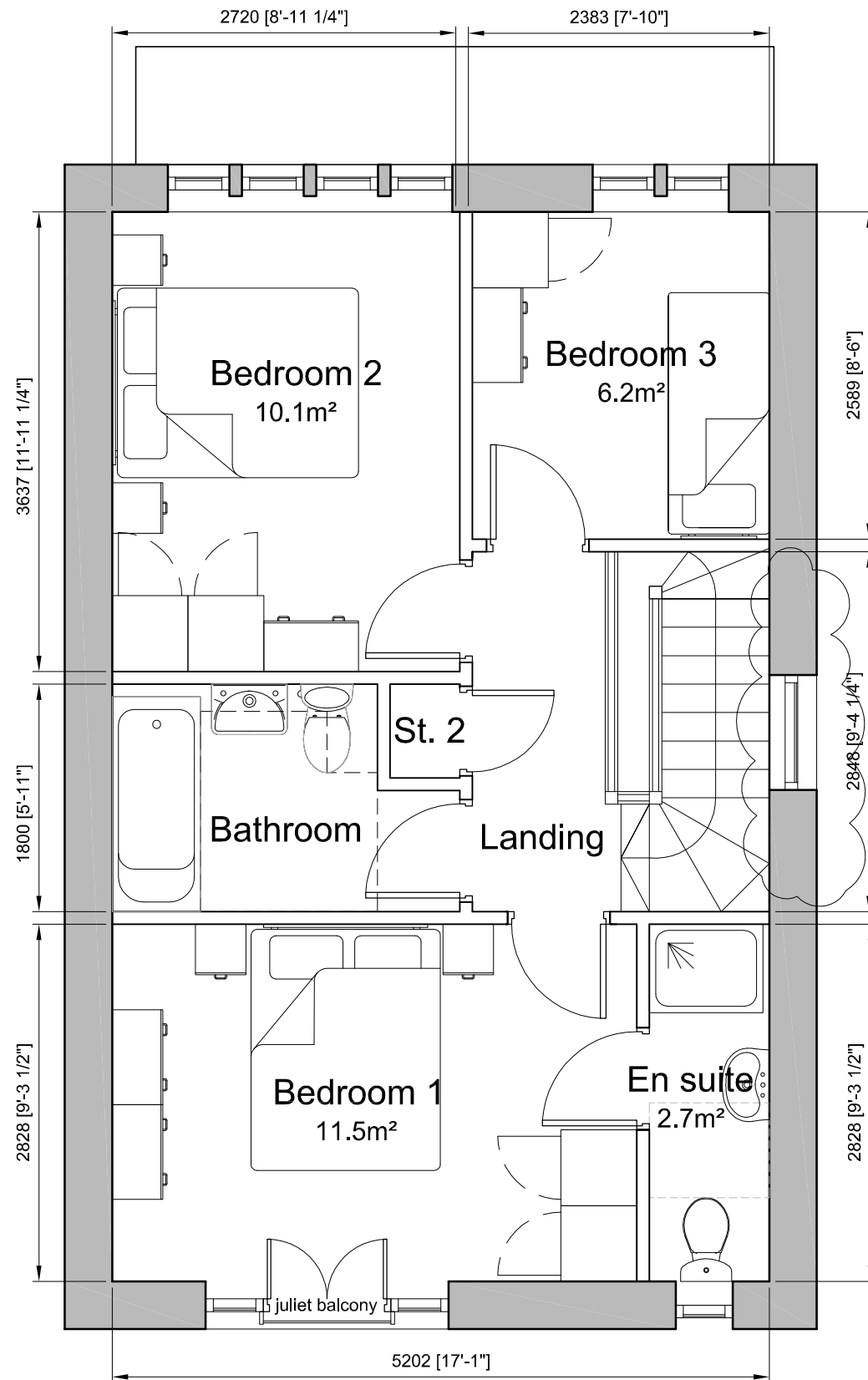

First floor

REV: A DATE: 11.1.16 DRAWN: GJ CHECKED: GJ  
 LANDING WINDOW AMENDED. FRENCH DOORS IN LIEU OF BI-FOLD DOORS

REVISIONS

This design is copyright ©

**Mark Oliver Homes**

Residential Development  
 Cowlersley Lane  
 Cowlersley, Huddersfield.

Floor Plans:  
 Type D 'The Gingham'  
 3-Bed Detached house

Drawn: GJ Scale: 1:50@A3  
 Date: 18.12.15 Checked: GJ

**brewsterbye architects**

5 NORTH HILL ROAD  
 HEADINGLEY  
 LEEDS  
 LS6 2EN

telephone  
 0113 2754000  
 facsimile  
 0113 2844250  
 e.mail  
 info@brewsterbye.co.uk



Dwg No: 486/01(02)014 A