

KIRKLEES COUNCIL

(On Street Parking Places) (No.4) Order 2020

Various Roads – Huddersfield Town Centre

The Council of the Borough of Kirklees propose to make the above Order under their powers in the Road Traffic Regulation Act 1984 the effect of which, as it affects lengths of road in the Huddersfield Town Centre in the Kirklees district, will be as follows: -

1. Cross Church Street - to remove the existing pay and display parking place
2. Dundas Street - north side to create two pay and display parking places measuring 38 metres in length to replace the existing one place.
- South side to reduce the existing pay and display parking place to 29 metres in length
3. Half Moon Street - to reduce the existing pay and display parking place to 21 metres in length
4. Queen Street - to remove the existing pay and display parking place
5. Queensgate - to remove the existing pay and display parking place
6. Upperhead Row - to remove the two existing pay and display parking places.

NB. These proposals should be read in conjunction with the other proposals recently advertised concerning these and other roads in Huddersfield town centre.

A copy of the draft Order, a plan and the Statement of Reasons for proposing the Order may be examined during normal office hours at –

1. Web address: <http://www.kirklees.gov.uk/trafficregulation>.
or
2. In the Covid-19 circumstances upon application to parking@kirklees.gov.uk for a copy to be sent by post.

If you wish to object to the proposed Order you may send the grounds of your objection in writing to reach the undersigned no later than Monday 2020 quoting reference PS/PPO.No 4 2020.

Dated this day of 2020

Julie Muscroft

Assistance Director – Legal Governance and Commissioning

Kirklees Council – Legal Services
2nd Floor High Street Buildings
High Street
Huddersfield
HD1 2ND

KIRKLEES COUNCIL

(On Street Parking Places) (No. 4) Order 2020

Various Roads – Huddersfield Town Centre

Statement of Reason for proposing to make the Order

These proposals affecting existing pay and display parking places in various roads in Huddersfield town centre are part of the more extensive changes affecting the town centre associated with the Huddersfield Blueprint, a 10 year vision to create a thriving modern-day town centre designed to improve access to the new Cultural Heart, Kingsgate Shopping Centre and surrounding areas.

The Blue Print proposals will limit parking in areas for specific purposes such as Loading or for blue badge holders for example and in consequence some parking places will be removed and some amended.

It is believed the changes will improve road safety and cyclist and pedestrian connectivity within the town centre.

KIRKLEES COUNCIL

(On Street Parking Places) (No. 4) Order 2020

The Council of the Borough of Kirklees (hereinafter referred to as “the Council”) in exercise of it’s powers under Sections 45, 46, 47 and 49 of the Road Traffic Regulation Act 1984 (hereinafter referred to as “the Act”) and Part 6 of the Traffic Management Act 2004, the Road Traffic (Permitted Parking Area and Specified Parking Area) (Metropolitan Borough of Kirklees) Order 2006 and of all other enabling powers, and after consultation with the Chief Officer of Police in accordance with Part III of Schedule 9 to the Act and with those persons and organisations specified in the Local Authorities’ Traffic Orders (Procedure) (England and Wales) Regulations 1996 hereby make the following order: -

1. This Order shall come into force on the day of 202 and may be cited as the “Kirklees Council (On Street Parking Places) (No. 4) Order 2020.
2. Kirklees Metropolitan Council (On Street Parking Places) (Consolidation) Order 2004 as amended is hereby further amended so as to replace the existing items 14a and 14b of the First Schedule with the items specified as items 1a – 1c of the First Schedule to this Order and to replace the existing item 19 of the First Schedule with the item specified as item 2 of the First Schedule to this Order.
3. The Orders specified in Column 1 of the Second Schedule to this Order are hereby revoked to the extent as is specified in Column 2 of the said Second Schedule.

GIVEN under the Corporate Common Seal of the Borough of Kirklees this day of
Two Thousand and Twenty.

THE CORPORATE COMMON SEAL OF)
THE COUNCIL OF THE BOROUGH OF)
KIRKLEES was hereunto affixed)
In the presence of:-)

FIRST SCHEDULE

ON STREET PARKING PLACES

COLUMN 1	COLUMN 2	COLUMN 3	COLUMN 4	COLUMN 5
Name of road and length affected	Days and hours of operation	Charging hours	Scale of charges during charging hours	Maximum period for which vehicles may wait
1. Dundas Street, Huddersfield				
a) North-east side from a point 12 metres south-east of its junction with Upperhead Row for a distance of 14 Metres in a south-easterly direction	All days All hours	8.00am to 6.00 pm Monday to Saturday 12 noon to 6.00pm Sunday	Monday to Saturday £1 for up to 45 minutes £2 for up to 90 minutes Sunday 50p for up to 90 minutes	During charging hours 90 minutes no return within 1 hour
b) North-east side from a point 37 metres south-east of its junction with Upperhead Row for a distance of 24 metres in a south-easterly direction	All days All hours	8.00am to 6.00 pm Monday to Saturday 12 noon to 6.00pm Sunday	Monday to Saturday £1 for up to 45 minutes £2 for up to 90 minutes Sunday 50p for up to 90 minutes	During charging hours 90 minutes no return within 1 hour
c) South-west side from a point of 30 metres south-east of its junction with Upperhead Row for a distance of 29 metres in a south easterly direction	All days All hours	8.00am to 6.00 pm Monday to Saturday 12 noon to 6.00pm Sunday	Monday to Saturday £1 for up to 45 minutes £2 for up to 90 minutes Sunday 50p for up to 90 minutes	During charging hours 90 minutes no return within 1 hour

COLUMN 1	COLUMN 2	COLUMN 3	COLUMN 4	COLUMN 5
Name of road and length affected	Days and hours of operation	Charging hours	Scale of charges during charging hours	Maximum period for which vehicles may wait
<p>2. Half Moon Street, Huddersfield</p> <p>South-east side from a point 11 metres west of its junction with Sergeantson Street for a distance of 21 metres in a south-westerly direction</p>	<p>All days All hours</p>	<p>8.00am to 6.00 pm Monday to Saturday</p> <p>12 noon to 6.00pm Sunday</p>	<p>Monday to Saturday £1 for up to 45 minutes £2 for up to 90 minutes</p> <p>Sunday 50p for up to 90 minutes</p>	<p>During charging hours 90 minutes no return within 1 hour</p>

SECOND SCHEDULE

REVOCATIONS

COLUMN 1

Kirklees Metropolitan Council
(On-Street Parking Places)
(Consolidation) Order 2004

Kirklees Metropolitan Council
On-Street Parking Places (No. 1)
Order 2007

Kirklees Council (On-Street Parking
Places) (No. 1) Order 2013

COLUMN 2

- i) First Schedule, item 38
- ii) First Schedule, items 51a and 51b

First Schedule, item 2 relating to Cross
Church Street

First Schedule, item 13



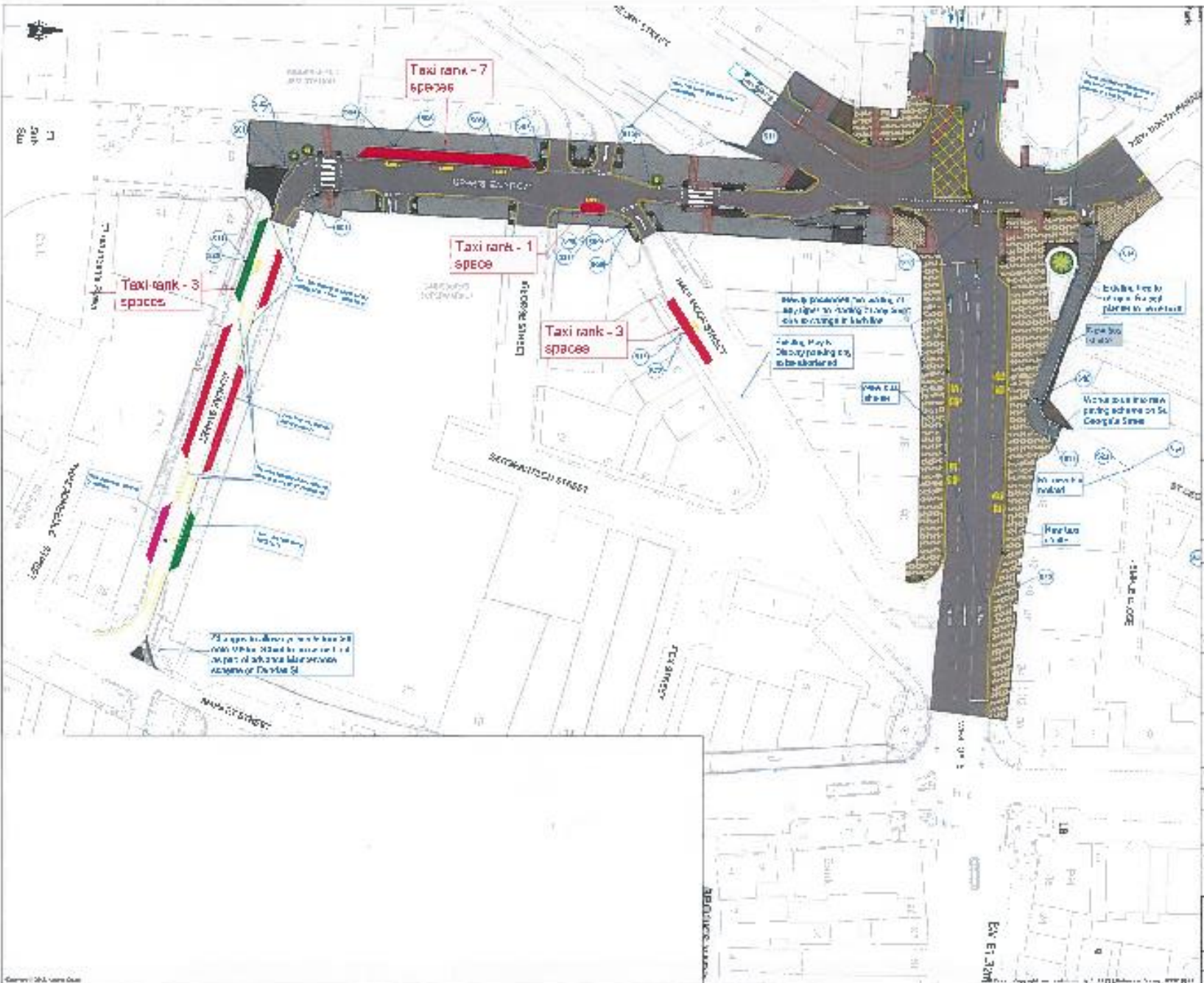

REVISED

Kirklees COUNCIL

Development of Plans for Public, Commercial and Industrial Units

PROJ: NEWHAM

REF: 101

NO: 115

DATE: 23/06/21

TO: 23/10/28

PROJECT: "PUBLIC, COMMERCIAL AND INDUSTRIAL UNITS" PLAN

SHEET: 01

Author: Mike Jones

Drawn: J. Green

Checked: J. Green

Scale: 1:200