

Huddersfield Rail Station Connections – Beck Road closure and diversions

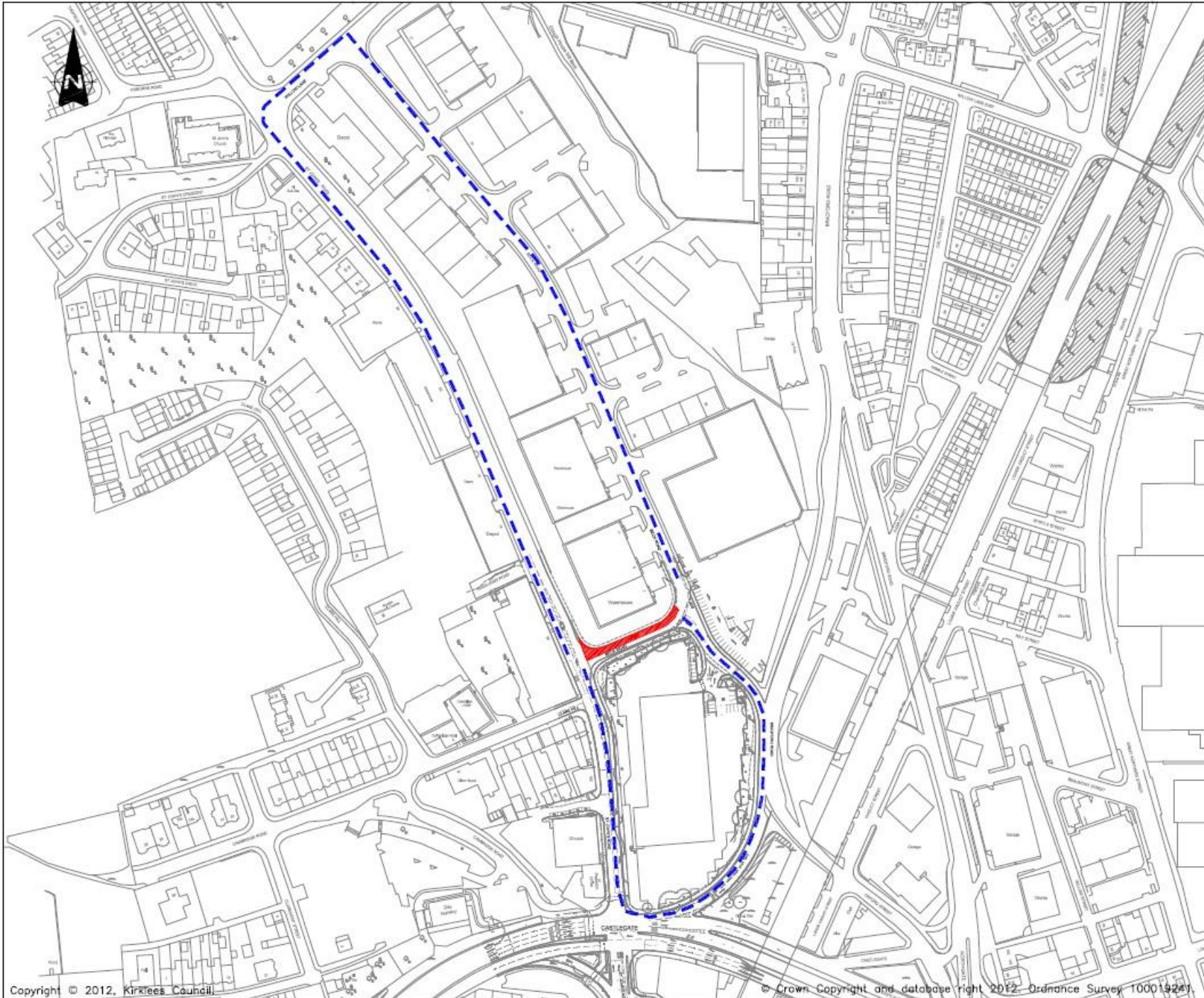

Key:

Beck Road closed In eastbound direction

Diversion route:
 Northbound: St. John's Road, Willow Lane, Beck Road
 Southbound: St. John's Road, Castlegate, Oxford Street, Bradford Road, Beck Road

Notes:

1. Eastbound closure to be in place 24/7 for the duration of the Works on Beck Road.
2. All associated signing and coning to be in accordance with Chapter 8 of the Traffic Signs Manual and Safety at Street Works and Road Works (the red book).

REF.	DATE	REVISIONS



Directorate of Place
 Civic Centre 3, Market Street
 Huddersfield, HD1 2TG

SECTION HIGHWAYS PUBLIC REALM

DRAWN BV	CHECKED
----------	---------

SCALE NTS@A3	PROJECT NO. 25/65533	DATE 08/12/25
--------------	----------------------	---------------

PROJECT
 HUDDERSFIELD RAIL STATION
 CONNECTIONS
 AREA 2 – ST. JOHN'S ROAD

TITLE
 Option 15F
 Beck Road Closure and
 Diversion Route Details

DRAWING No. 25-65533-AREA2-OPT15F-100-05A
 CAD No. FOR CONSTRUCTION