

# SCHEDULE 1

Regulation 2(2)(a)

## Application Form

### Form CA16

#### Application Form for deposits under section 31(6) of the Highways Act 1980 and section 15A(1) of the Commons Act 2006

#### Please read the following guidance carefully before completing this form

1. Guidance relating to completion of this form is available from <http://www.defra.gov.uk/rural/protected/greens/>. Please refer to these separate notes when completing this form.
2. Parts A and F must be completed in all cases.
3. The form must be signed and dated by, or by a duly authorised representative of, every owner of land to which the application relates who is an individual, and by the secretary or some other duly authorised officer of every owner of land to which the application relates which is a body corporate or an unincorporated association.
4. In the case of land in joint ownership all the joint owners must complete paragraphs 2 and 3 of Part A and complete and sign the application in Part F, unless a duly authorised representative completes and signs the form on behalf of all of the owners of the land. Paragraph 3 should be completed in full to clearly explain the capacity of each applicant e.g. trustee, landowner's managing agent, executor.
5. 'Owner' is defined in section 61(3) of the Commons Act 2006 and section 31(7) of the Highways Act 1980 and means, broadly, a legal owner of the freehold interest in the land.
6. Where the application relates to more than one parcel of land, a description of each parcel should be included in Paragraph 4 of Part A and the remainder of the form should be completed to clearly identify which statement and/or declaration relates to which parcel of land. This may require the insertion of additional wording. See separate notes for further guidance. Multiple parcels of land should be clearly identified by coloured edging on any accompanying map.
7. Where a statement or declaration requires reference to colouring shown on an accompanying map or previously lodged map, the colouring must be clearly specified and must match that shown on the relevant map. For example, if a footpath is specified in a Part C declaration as shown coloured brown, the accompanying map or previously deposited map referred to must reflect that colouring.
8. An application must be accompanied by an ordnance map, or (in respect of declarations under Part C or statements under Part D of this form) refer to a map previously deposited in accordance with the Commons (Registration of Town or Village Greens) and Dedicated Highways (Landowner Statements and Declaration) (England) Regulations 2013 or (if deposited before 1st October 2013) in accordance with section 31(6) of the Highways Act 1980. Any accompanying map must be an ordnance map at a scale of not less than 1:10,560 showing the boundary of the land to which the application relates in coloured edging.
9. An application must be accompanied by the requisite fee – please ask the appropriate authority for details.



10. 'Appropriate authority' means (a) in relation to a map or statement deposited or declaration lodged under section 31(6) of that Act, an appropriate council (as defined in section 31(7) of the Highways Act 1980); and (b) in relation to a statement and map deposited under section 15A(1) of the 2006 Act, a commons registration authority (defined in section 4 of the Commons Act 2006 and section 2 of the Commons Registration Act 1965). In practice, the appropriate council and commons registration authority will usually be the same body.

**PART A: Information relating to the applicant and land to which the application relates  
(all applicants must complete this Part)**

1. Name of appropriate authority to which the application is addressed:

Kirklees Metropolitan Council, Commons Registration Authority,  
Local Land Charges,  
Flint Street,  
Fartown  
Huddersfield  
HD1 6LG

2. Name and full address (including postcode) of applicant:

..... ANTHONY WILLIAM RIBBON [Secretary/Director] of  
Leeds Diocesan Board of Finance  
(Co. No. 8823593) whose registered office is at  
Church House, 17-19 York Place, Leeds, LS1 2EX

3. Status of applicant (tick relevant box or boxes):

I am

- (a)  the owner of the land(s) described in paragraph 4.  
(b)  making this application and the statements it contains on behalf of Leeds Diocesan Board of Finance (Co. No. 8823593) which is the owner of the land(s) described in paragraph 4 and in my capacity as [Secretary/Director] of Leeds Diocesan Board of Finance

4. Insert description of the land(s) to which the application relates (including full address and postcode):

Parcel A – Part Kirkheaton Glebe being agricultural land on the south side of Bankfield Lane, Huddersfield, West Yorkshire, comprised in the attached registered title number WYK814116 and shown edged red on the attached map A.

Parcel B – Part Kirkheaton Glebe being agricultural land on the North side of Wellhouse Lane, Huddersfield, West Yorkshire, comprised in the attached registered title number WYK814440 and shown edged red on the attached map B.

5. Ordnance Survey six-figure grid reference(s) of a point within the area of land(s) to which the application relates (if known):

Parcel A – SE174183.

Parcel B – SE 178177.

6. This deposit comprises the following statement(s) and/or declarations:

Parts B, D and F.



## Official copy of register of title

Title number WYK814440 Edition date 16.11.2017

- This official copy shows the entries on the register of title on 30 Nov 2017 at 13:30:11.
- This date must be quoted as the "search from date" in any official search application based on this copy.
- The date at the beginning of an entry is the date on which the entry was made in the register.
- Issued on 30 Nov 2017.
- Under s.67 of the Land Registration Act 2002, this copy is admissible in evidence to the same extent as the original.
- This title is dealt with by HM Land Registry Nottingham Office.

### A: Property Register

This register describes the land and estate comprised in the title.

WEST YORKSHIRE : KIRKLEES

- 1 (01.03.2006) The Freehold land shown edged with red on the plan of the above title filed at the Registry and being Land on the north side of Wellhouse Lane, Huddersfield.
- 2 (07.09.2006) The land edged and numbered in green on the title plan has been removed from this title and registered under the title number or numbers shown in green on the said plan.

### B: Proprietorship Register

This register specifies the class of title and identifies the owner. It contains any entries that affect the right of disposal.

Title absolute

- 1 (16.11.2017) PROPRIETOR: LEEDS DIOCESAN BOARD OF FINANCE (Co. Regn. No. 08823593) of Church House, 17-19 York Place, Leeds LS1 2EX.
- 2 (16.11.2017) RESTRICTION: No disposition of the registered estate is to be registered unless made in accordance with the Endowments and Glebe Measure 1976 or some other Measure or authority.

### C: Charges Register

This register contains any charges and other matters that affect the land.

- 1 (01.03.2006) The land is subject to such easements as affect the same by virtue of s.15(1)(b) Endowments and Glebe Measure 1976.
- 2 (07.09.2006) The land is subject to the following rights granted by a Transfer of the land edged and numbered WYK830586 in green on the title plan dated 15 August 2006 made between (1) Wakefield Diocesan Board of Finance and (2) Stephen Walker (Transferee):-

Rights Granted The right in common with all others entitled to a like

Title number WYK814440

## C: Charges Register continued

right to pass and repass with or without vehicles at all times and for all purposes over and along that part of the road shown coloured brown on the said plan subject to the Transferee paying a proportionate part of the cost of repair and maintenace thereof.

NOTE: Copy plan filed under WYK830586.

End of register



FILE NUMBER

WYK814440

A



Elk

WEST YORKSHIRE : KIRKLEES

WYK814440

ORDNANCE SURVEY MAP REFERENCE:

SE1718SW

SE

1749c 18311

SCALE: 1:2500

or SE174183

©CROWN COPYRIGHT. Produced by HMLR. Further reproduction in whole or in part is prohibited without the prior written permission of Ordnance Survey. Licence Number GD272728

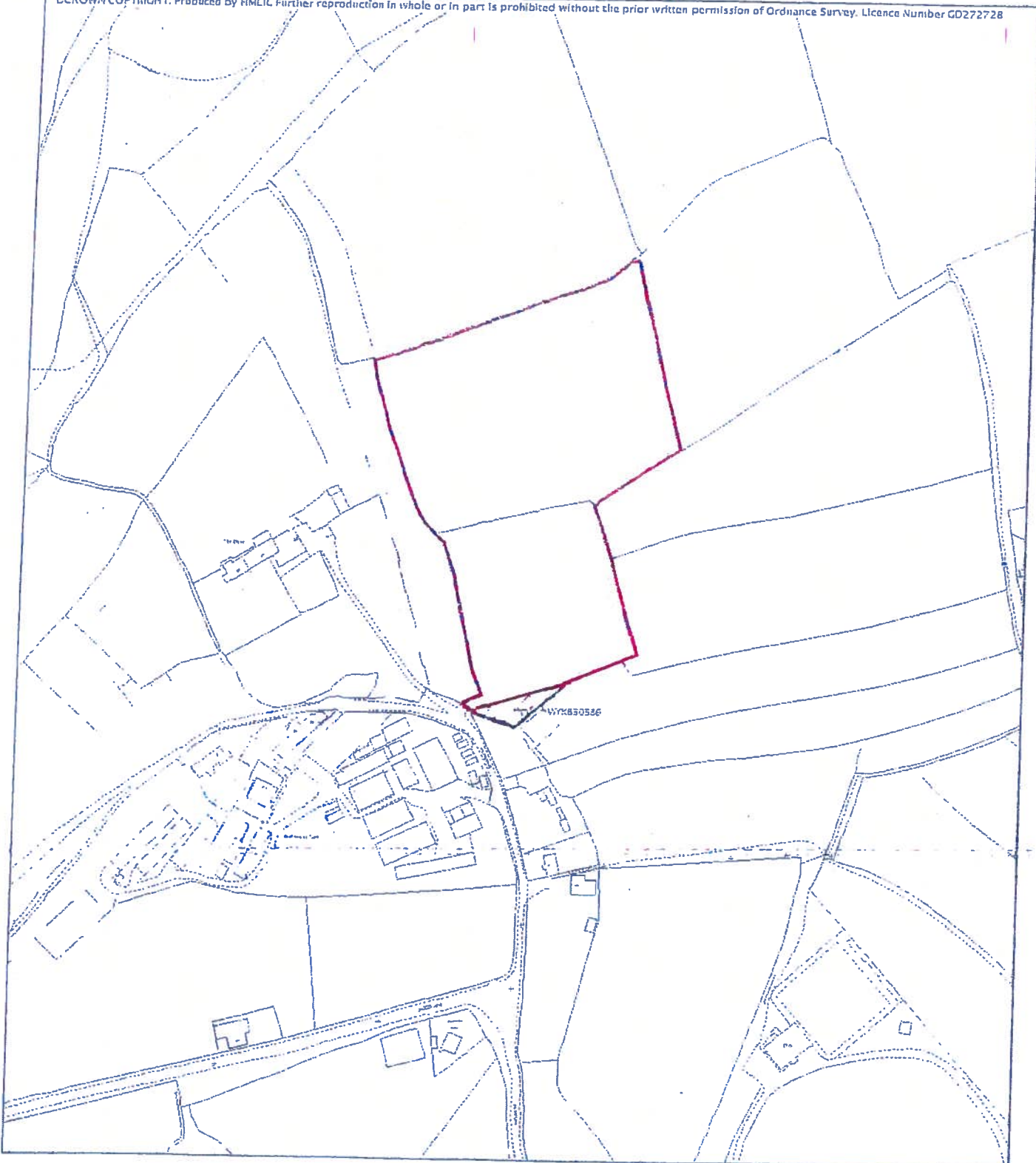

This Official Copy is incomplete without the preceding notes page.





# Official copy of register of title

Title number **WYK814116** Edition date **16.11.2017**

- This official copy shows the entries on the register of title on 30 Nov 2017 at 13:30:10.
- This date must be quoted as the "search from date" in any official search application based on this copy.
- The date at the beginning of an entry is the date on which the entry was made in the register.
- Issued on 30 Nov 2017.
- Under s.67 of the Land Registration Act 2002, this copy is admissible in evidence to the same extent as the original.
- This title is dealt with by HM Land Registry Nottingham Office.

## A: Property Register

This register describes the land and estate comprised in the title.

WEST YORKSHIRE : KIRKLEES

- 1 (24.02.2006) The Freehold land shown edged with red on the plan of the above title filed at the Registry and being Land on the south side of Bankfield Lane, Huddersfield.

## B: Proprietorship Register

This register specifies the class of title and identifies the owner. It contains any entries that affect the right of disposal.

### Title absolute

- 1 (16.11.2017) PROPRIETOR: LEEDS DIOCESAN BOARD OF FINANCE (Co. Regn. No. 08823593) of Church House, 17-19 York Place, Leeds LS1 2EX.
- 2 (16.11.2017) RESTRICTION: No disposition of the registered estate is to be registered unless made in accordance with Endowments and Glebe Measure 1976 or some other Measure or authority.

## C: Charges Register

This register contains any charges and other matters that affect the land.

- 1 (24.02.2006) The land is subject to such easements as affect the same by virtue of s.15(1)(b) Endowments and Glebe Measure 1976.

End of register

SE 17859 17763 or SE 178177

Land Registry  
Current title plan

Title number WYK814116  
Ordnance Survey map reference SE1717NE  
Scale 1:2500 reduced from 1:1250  
Administrative area West Yorkshire : Kirklees

B



Fleetwood

Kirkstall Cleeve

© Crown Copyright. Produced by Land Registry. Reproduction in whole or in part is prohibited without the prior written permission of Ordnance Survey. Licence Number 100026316.

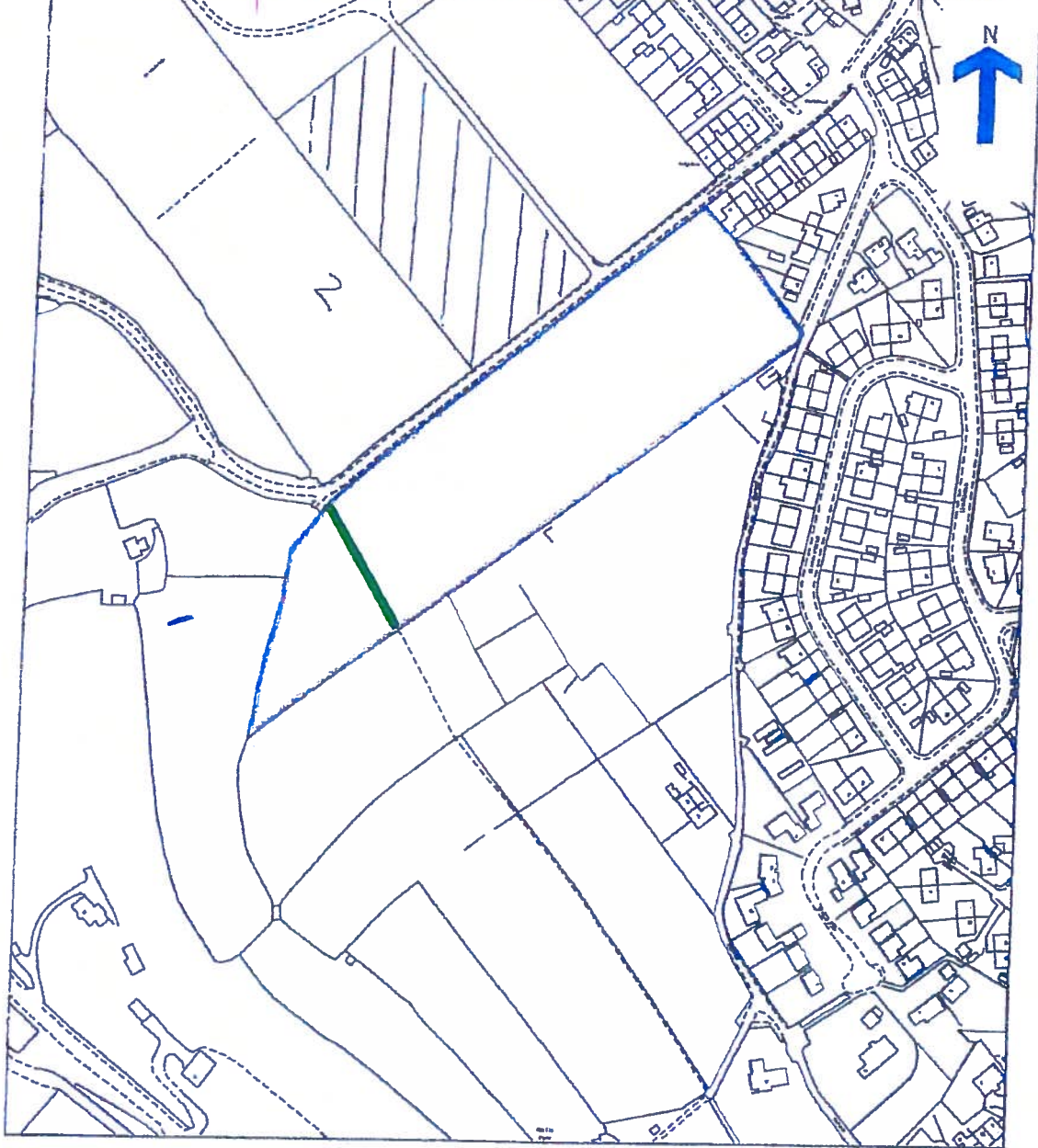

This is a copy of the title plan of WYK814116, produced by Ordnance Survey, for the purposes of registration. It is not a legal document and should not be relied upon for legal purposes.

This plan is not a legal document and should not be relied upon for legal purposes. It is a copy of the title plan of WYK814116, produced by Ordnance Survey, for the purposes of registration.

The Land Registry does not warrant the accuracy of the information shown on this plan. It is a copy of the title plan of WYK814116, produced by Ordnance Survey, for the purposes of registration.

© Crown Copyright. Produced by Land Registry. Reproduction in whole or in part is prohibited without the prior written permission of Ordnance Survey. Licence Number 100026316.



**PART B: Statement under section 31(6) of the Highways Act 1980**

Leeds Diocesan Board of Finance (Co. No. 8823593) is the owner of the lands described in paragraph 4 of Part A of this form and shown edged red on the maps A and B accompanying this statement.

No ways over the lands shown edged red on the accompanying maps A and B have been dedicated as highways. *except that the green line on map B shows the route of public footpaths Kirkstoultan 7*

**PART D: Statement under section 15A(1) of the Commons Act 2006**

Leeds Diocesan Board of Finance (Co. No. 8823593) is the owner of the lands described in paragraph 4 of Part A of this form and shown edged red on the maps A and B accompanying this statement.

Leeds Diocesan Board of Finance (Co. No. 8823593) wishes to bring to an end any period during which persons may have indulged as of right in lawful sports and pastimes on the whole or any part of the lands shown edged red on the accompanying maps A and B.

**PART F: Statement of Truth**

**WARNING: If you dishonestly enter information or make a statement that you know is, or might be, untrue or misleading, and intend by doing so to make a gain for yourself or another person, or to cause loss or the risk of loss to another person, you may commit the offence of fraud under section 1 of the Fraud Act 2006, the maximum penalty for which is 10 years' imprisonment or an unlimited fine, or both.**

**I BELIEVE THAT THE FACTS AND MATTERS CONTAINED IN THIS FORM ARE TRUE**

Signature (of the person making the statement of truth): ..  ..

Print full name: ..... *ANTHONY WILLIAM ROBINSON* .....  
[Secretary/Director] of Leeds Diocesan Board of Finance

Date: *20 December* 2017

You should keep a copy of the completed form

**Data Protection Act 1998 - Fair Processing Notice**

The purpose of this Fair Processing Notice is to inform you of the use that will be made of your personal data, as required by the Data Protection Act 1998.

The appropriate authority (see explanation of definition in above guidance notes) in England is the data controller in respect of any personal data that you provide when you complete this form.

The information that you provide will be used by the appropriate authority in its duties to process applications to deposit statements, maps and declarations under section 31(6) the Highways Act 1980 and statements under section 15A(1) of the Commons Act 2006. The information you provide will also be used by the appropriate authority in its duty to update the registers in which details of such deposits are recorded

under the Dedicated Highways (Registers under Section 31A of the Highways Act 1980) (England) Regulations 2007 and the Commons (Registration of Town or Village Greens) and Dedicated Highways (Landowner Statements and Declarations) (England) Regulations 2013.

The appropriate authority is required by the legislation above to maintain a register which holds information provided in this form, which can be inspected online or in person by members of the public on request. It may also be required to release information, including personal data and commercial information, on request under the Environmental Information Regulations 2004 or the Freedom of Information Act 2000. However, the appropriate authority will not permit any unwarranted breach of confidentiality nor will they act in contravention of their obligations under the Data Protection Act 1998.