

Copyright exist on the designs and information shown on this drawing. No part of this drawing can be reproduced without written confirmation of Heppenstalls. This drawing should only be used for the purpose was issued for and should not be used for construction unless it is marked for construction. Heppenstalls must be notified should any discrepancies be found.

Revision:
a 2025-05-18 Slate roof removed, flat roof with parapet proposal added. Rooflights changed to framed fixed flat rooflight, sizes & positions adjusted on plan.

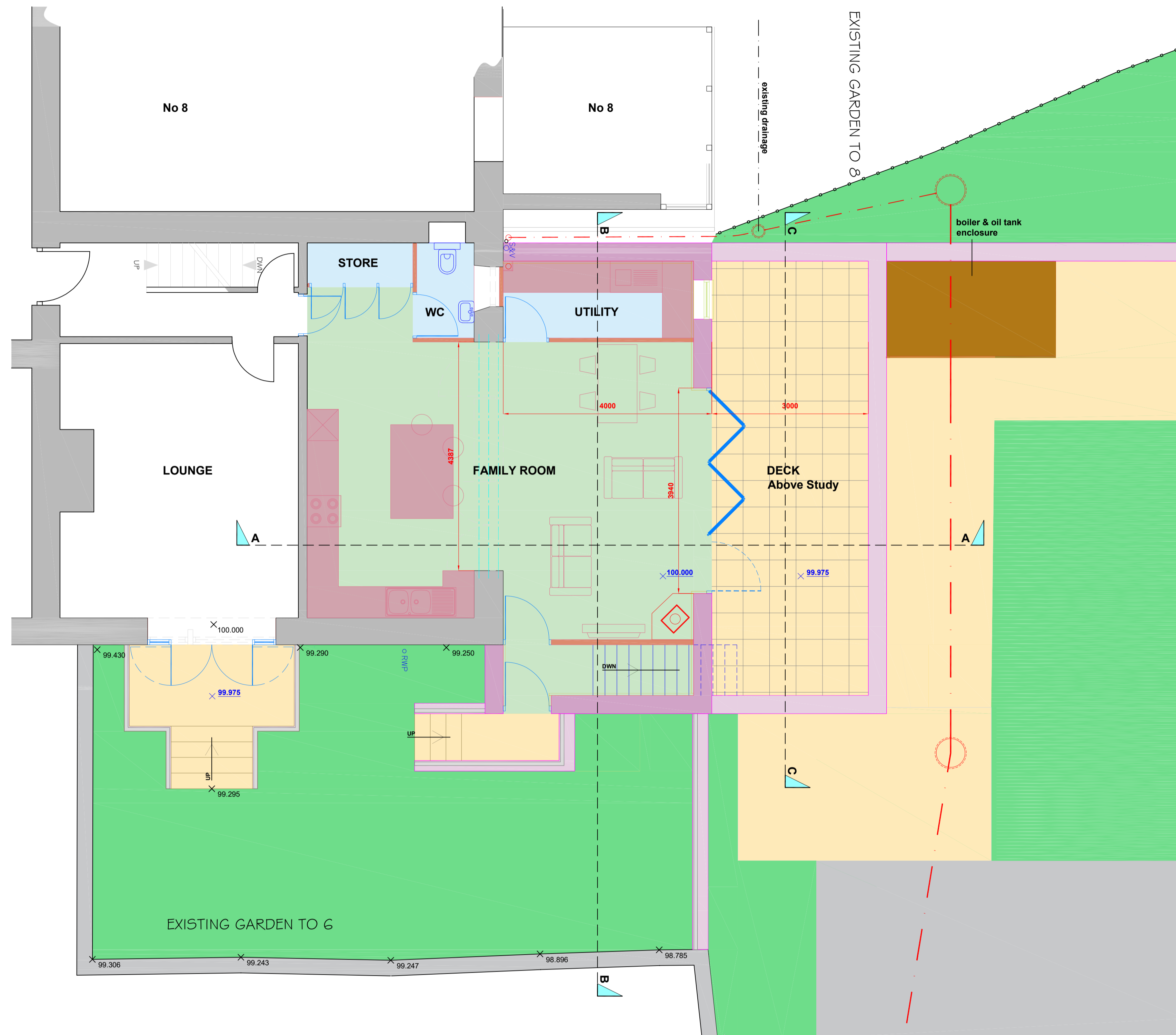

Ground Floor

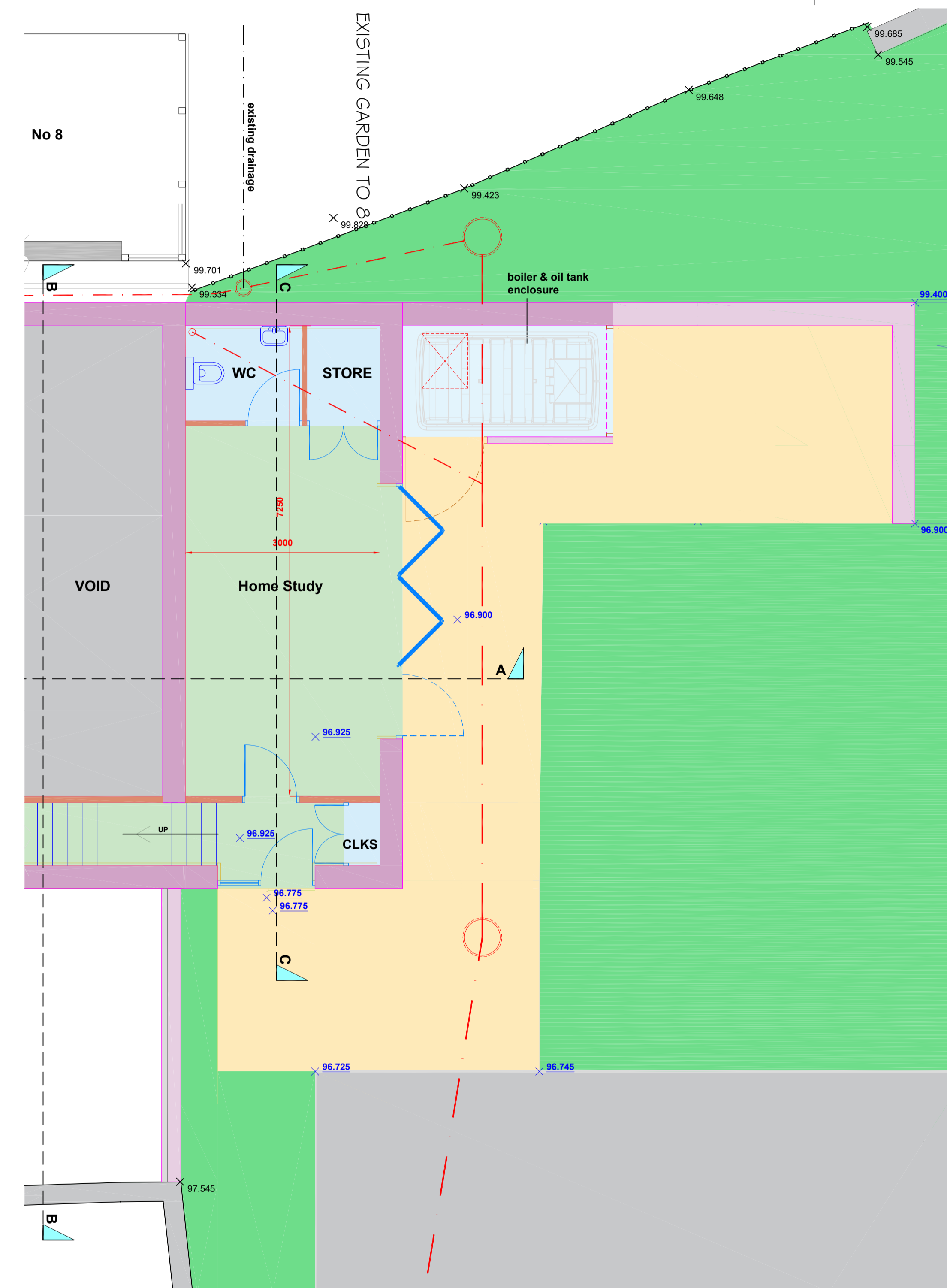

Lower Ground Floor

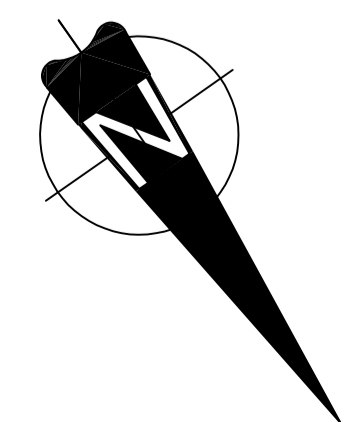

Proposed Floor Plans Extension to Dwelling



- Existing walls
- Proposed walls (Building)
- Proposed walls (Boundary / parapet)
- Existing drainage
- Proposed drainage
- Paving (Pedestrian)
- Permeable paving / macadam (Vehicle traffic)

Framed fixed flat rooflights

Client Michelle Falkingham-Bailey	
Project Proposed Extension to Dwelling 6 Moor Park, Bradshaw Road, Honley HD9 6RJ	
Drawing Proposed Floor Plans	
Number	Date 11/2025
4455-03-04a	As Marked

HEPPENSTALLS
Chartered Architects

Architecture
Surveying
Planning
Project Management

Allisons Buildings, 135 Armitage Road Milnsbridge,
Huddersfield, HD3 4JY tel 01484 658411
projects@heppenstalls.net www.heppenstalls.net

Proposed Floor Plans
Planning