

DO NOT SCALE

PROPOSED CONTAINMENT KERB 325MM HIGH (KIRKLEES COUNCIL SAFETY KERB TK2). SEE INSET A FOR DETAIL OF KERB

6.9M TRANSITION TAPERS ON THE KERBLINE APPROACHING THE NEW SAFETY FULL HEIGHT KERBS

470MM REQUIRED BETWEEN EXISTING WALL TO FRONT OF PROPOSED NEW KERB. SEE INSET A FOR DETAIL OF KERB

6.9M TRANSITION TAPERS ON THE KERBLINE APPROACHING THE NEW SAFETY FULL HEIGHT KERBS

PROVIDE EDGE OF CARRIAGEWAY ROAD MARKINGS (AS PER DIAGRAM 1012.1) ALONG AND IN ADVANCE OF THE NEW KERBING AND ON BOTH SIDES OF THE CARRIAGEWAY

PROPOSED ROAD CENTRELNE AS PER DIAGRAM 1004

INDICATIVE CARRIAGEWAY EDGE

PROPOSED ROAD CENTRELNE AS PER DIAGRAM 1004

EXISTING ROAD MARKINGS WORN SO RE-LINE. AMEND GIVEWAY MARKINGS AND CENTRELNE TO ALIGN TO CENTRE OF CARRIAGEWAY

AMEND GIVEWAY ROAD MARKINGS ON DOBB TOP ROAD TO ENCOURAGE BANKFIELD DRIVE DRIVERS TO PULL UP CLOSER TO CENTRE LINE AND COMPACT THE JUNCTION

- KEY:
- PROPOSED ROAD MARKING AMENDMENTS
 - PROPOSED CONTAINMENT KERB 325MM HIGH AND HARD MARGIN (KIRKLEES COUNCIL SAFETY KERB TK2 - SEE INSET A)
 - PROPOSED 1:20 TRANSITION KERBING - 6.9M IN LENGTH (SEE NOTE 2)
 - PROPOSED PLANING OF EXISTING CARRIAGEWAY TO A DEPTH OF 40MM THEN INSTALLATION OF HIGH FRICTION SURFACING (SMA 10 SURFACING (EN13108-5), 40MM THICK WITH A 68+PSV, OR AS OTHERWISE AGREED WITH THE LHA
 - EXISTING ROAD MARKINGS
 - HIGHWAY ADOPTION BOUNDARY
 - IMPROVED BANKFIELD DRIVE JUNCTION VISIBILITY SPLAY (SEE NOTE 3)
 - IMPROVED BANKFIELD DRIVE JUNCTION VISIBILITY SPLAY (SEE NOTE 4)
 - BANKFIELD DRIVE JUNCTION VISIBILITY SPLAY (SEE NOTE 5)
 - EXISTING STREET LIGHTING COLUMNS AFFECTED BY THE PROPOSED KERBING. A REVISED STREET LIGHTING DESIGN WILL BE AGREED AT THE DETAILED DESIGN STAGE (SEE NOTE 6)
 - EXISTING GULLIES TO BE RELOCATED AS NECESSARY TO SUIT NEW KERB LINE
 - PROPOSED RETRO-REFLECTIVE MARKER POST/BOLLARD
 - 'PEDESTRIAN IN ROAD' SIGN WHICH INCLUDES 'RURAL SCHOOL ROUTE' PLATE ON A YELLOW BACKING BOARD. LINES SHOW DIRECTION OF SIGN FACE. LOCATION SHOWN IS INDICATIVE AND SUBJECT TO AGREEMENT AT THE S278 TECHNICAL APPROVAL STAGE.

- NOTES
1. PRELIMINARY LAYOUT SUBJECT TO TOPOGRAPHICAL SURVEY, DETAILED DESIGN INCLUDING FULL CDM COMPLIANCE, STATUTORY UNDERTAKERS SEARCH/DIVERSION REQUIREMENTS, HIGHWAY DRAINAGE PROVISION, LAND AVAILABILITY, CAPACITY ASSESSMENT AND LOCAL AUTHORITY APPROVAL.
 2. 1:20 TRANSITION KERBING COMPRISING OF:
 - FLUSH/HALF BATTERED TRANSITION KERB;
 - SERIES OF HALF BATTER KERBS TO SUIT REQUIRED TAPER LENGTH; AND
 - HALF BATTER/TK2 TRANSITION KERBS.
 3. IMPROVED AVAILABLE VISIBILITY SPLAY TO THE WEST TO THE EXISTING KERB LINE ADJACENT TO THE EXISTING RETAINING WALL = 2.4M X 12.8M.
 4. 2.4M X 24.5M VISIBILITY SPLAY TO THE WEST BASED ON 85TH PERCENTILE SPEED OF 20.7MPH AS ADVISED BY KIRKLEES COUNCIL (2.4M X 24.5M INCLUDES ALLOWANCE FOR BONNET LENGTH).
 5. THE VISIBILITY SPLAY SHOWN TO THE EAST IN ACCORDANCE WITH RECORDED 85TH PERCENTILE WESTBOUND SPEED OF 20.5MPH = 2.4M X 25.7M (25.7M INCLUDES ALLOWANCE FOR BONNET LENGTH).
 6. THE HYDRANT AND CYCLE ROUTE SIGNAGE ATTACHED TO THE EXISTING LIGHTING COLUMN WILL BE REPLACED/RELOCATED AS NECESSARY, AND THE POTENTIAL IMPACT ON THE HYDRANT WILL BE ADDRESSED AT THE DETAILED DESIGN STAGE.

VEHICLE PROFILE

Large Car (2006)	5.079m
Overall Length	1.872m
Overall Width	1.525m
Overall Body Height	0.310m
Min Body Ground Clearance	1.831m
Max Track Width	4.00s
Lock to lock time	5.900m
Kerb to Kerb Turning Radius	

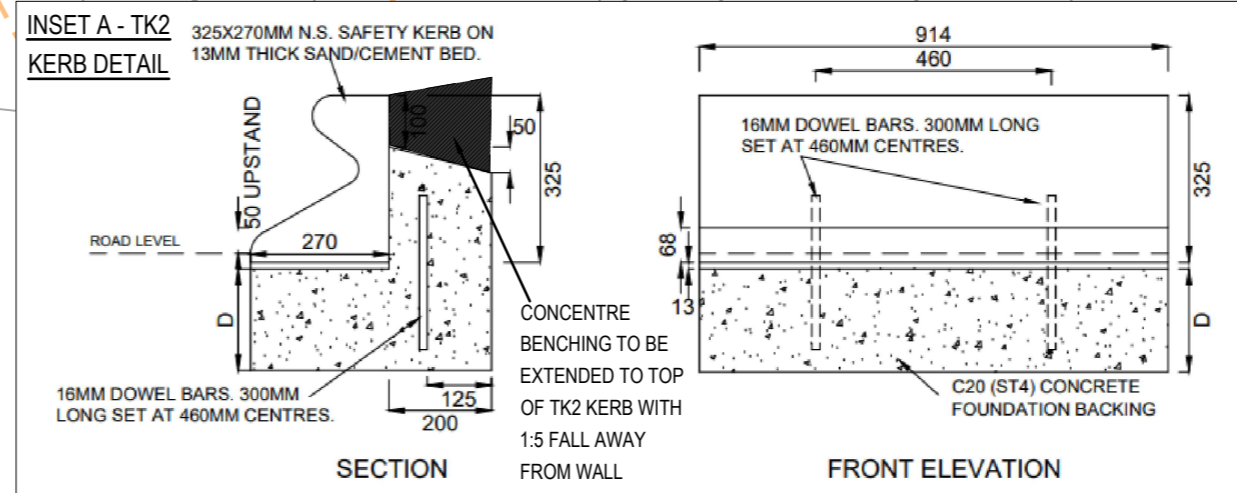
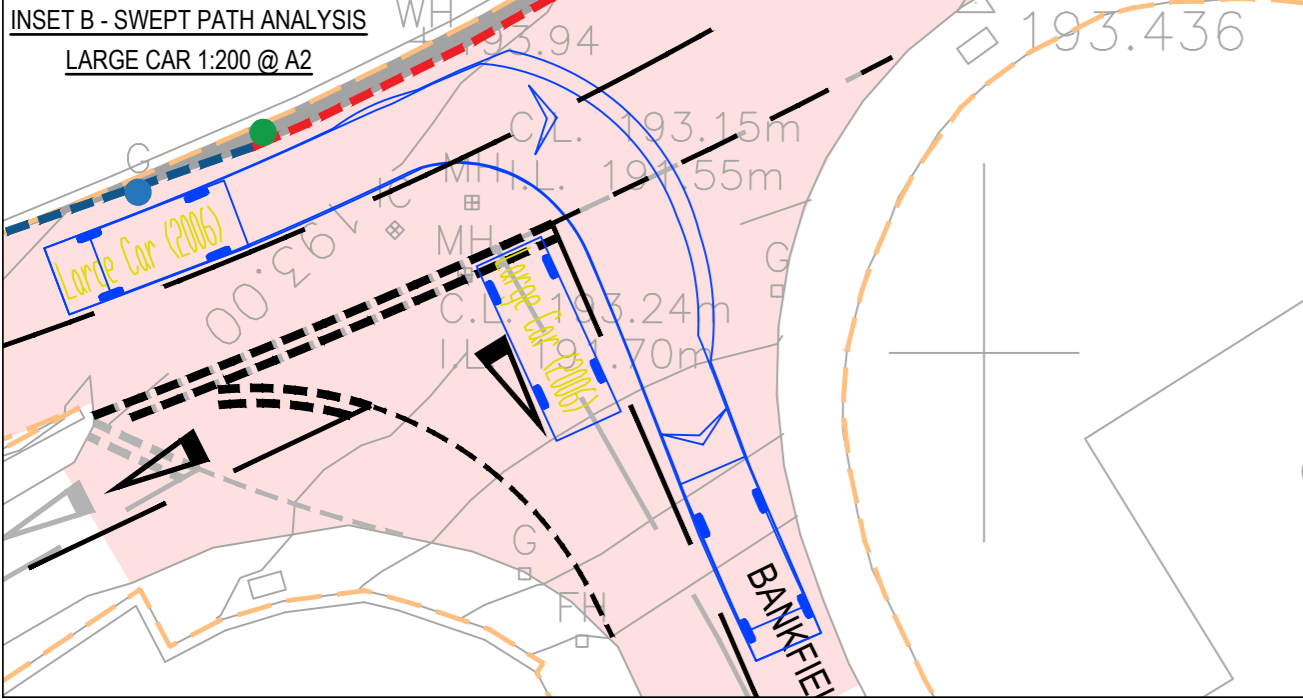

SAFETY KERB TK2

TK2 (DEPTH OF BED (mm))

REV	DATE	BY	DESCRIPTION	CHK	APP
D	21/11/23	SG	AMENDMENTS AS PER STAGE 1 RSA OVERSEEING ORGANISATION RESPONSE AND RECOMMENDATIONS	PO	PO
C	06/11/23	SG	AMENDMENT TO HIGH FRICTION SURFACING KEY WORDING, IN ACCORDANCE WITH STAGE 1 RSA	PO	PO
B	24/10/23	SG	JUNCTION VISIBILITY SPLAY TO THE RIGHT AMENDED	PO	PO
A	20/10/23	SG	UPDATED FOLLOWING KIRKLEES COUNCIL COMMENTS	PO	PO
-	05/10/23	SG	INITIAL ISSUE	PO	PO
STATUS	PRELIMINARY				

PROJECT	BANKFIELD DRIVE, HOLMBRIDGE			CLIENT	ORION HOMES		
DRAWING TITLE	DOBB TOP ROAD/ BANKFIELD DRIVE PROPOSED IMPROVEMENTS			CHECKED	APPROVED	DRG No.	
	PO	PO	PO	PO	PO	22027/GA/01	
	SG	SCALE @ A2	DATE	REV.			
		1:200	NOVEMBER 2023	D			

