

FIGURES & DRAWINGS



Drawn Scale 1:1250



Golcar

Ordnance Survey, (c) Crown Copyright 2015. All rights reserved. Licence number 100022432

"For the purposes of Planning Consent the following applies to any copy of this drawing made by the Local Authority:
 This copy has been made by and with the authority of the person required to make the plan and drawing open to public inspection pursuant to Section 47 of the Copyright, Designs and Patents Act 1988. Unless that Act provides a relevant exception to copyright, the copy must not be copied without the prior permission of the copyright owner. If any copy is made under the authority only the whole drawing including the copyright holder's name and this notice, is to be copied."

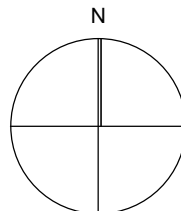

Issue Purpose: PLANNING APPLICATION

AHJ architects
 The Courtyard
 12a Commercial Road
 Skelmanthorpe
 Huddersfield
 HD8 9AA
 www.ahjarchitects.co.uk
 t | 07959944840
 e | info@ahjarchitects.co.uk

AHJ

architects

Client Jonathon Lindley
 Project 2589 : 44 Long Croft Street : New Dwelling
 Title Location Plan
 .
 Drawing Number

Issued From
 Date September 2025
 Scale 1:1250 @ A4
 Drawn BH Auth BH

2589 - D - 20 - 001

Revision
 Do not scale from this drawing. Work to stated dimensions, and any discrepancy is to be reported to the Architect.
 Refer to larger scale drawings where available.

"For the purposes of Planning Consent the following applies to any copy of this drawing made by the Local Authority:
 This copy has been made by and with the authority of the person required to make the plan and drawing open to public inspection pursuant to Section 47 of the Copyright, Designs and Patents Act 1988. Unless that Act provides a relevant exception to copyright, the copy must not be copied without the prior permission of the copyright owner.
 If any copy is made under the authority only the whole drawing including the copyright holder's name and this notice, is to be copied."

Drawn Scale 1:100

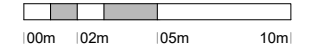

Drawn Scale 1:50

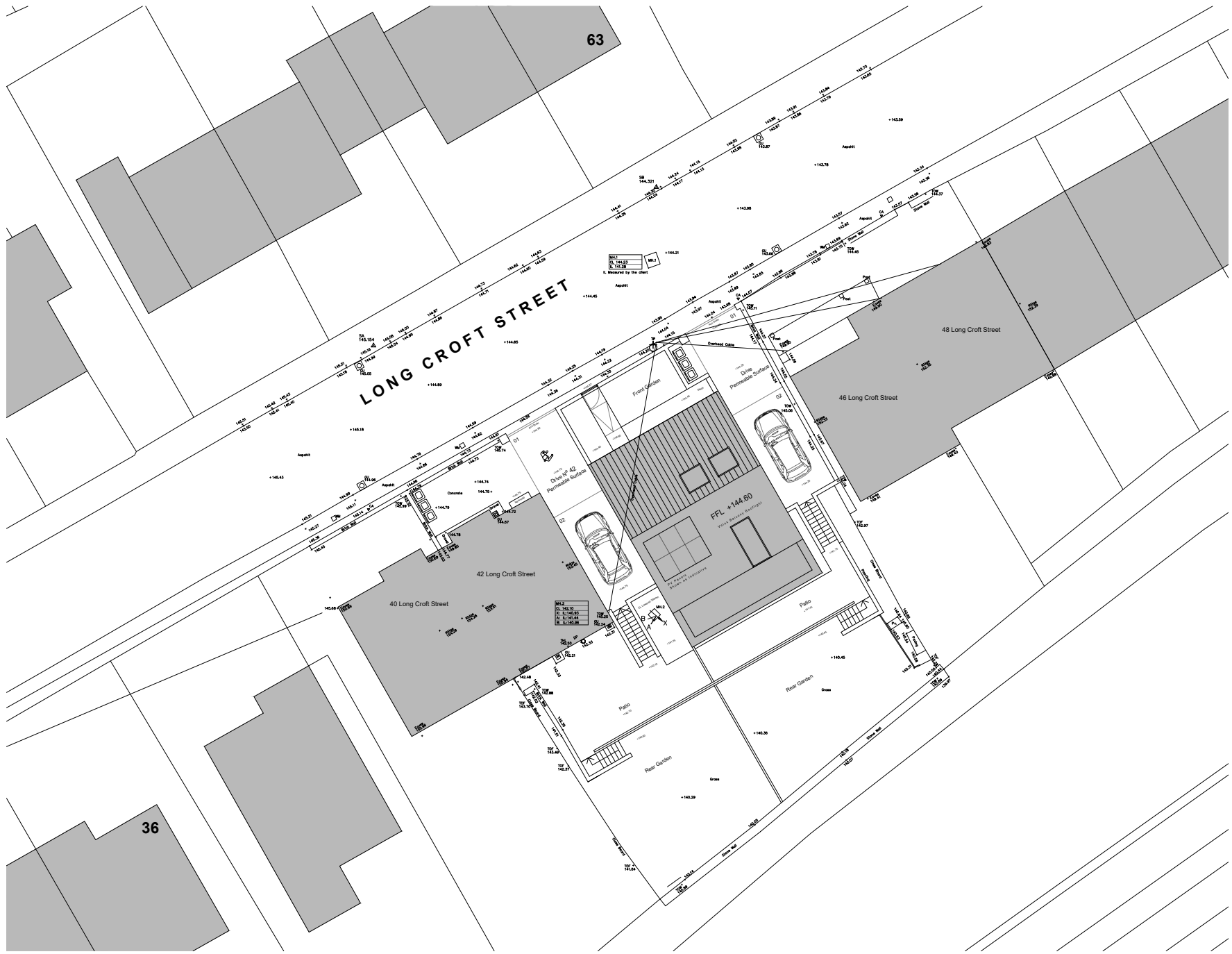
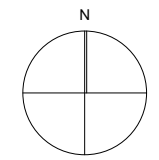
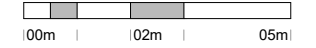

PROPOSED SITE PLAN 1:100 @ A1

Issue Purpose: PLANNING APPLICATION

AHJ architects
 The Courtyard
 124 Commercial Road
 Shelmeston
 Huddersfield
 HD8 9AA
 www.ahjarchitects.co.uk



Client: Jonathan Lindsey	Issued From:
Project: 2589 - 44 Long Croft Street - New Dwelling	Date: September 2025
Title: Proposed Site Plan	Scale: 1:100 @ A1
Drawn: BH Auth BH	Revision:

2589 - D - 20 - 003