

# **Network Rail (Huddersfield to Westtown (Dewsbury) Improvements) Order**

## **Condition 17: New Maintenance Access (Colne Bridge Road)– Stage 6 W3B**

**Document reference: 151667-TSA-00-TRU-REP-W-EN-900145**

**Network Rail**

**March 2026**



This page is intentionally left blank

**Contents**

**1. INTRODUCTION.....4**  
 1.1 Background .....4

**2. STAGED APPROACH TO DISCHARGE AND STAGE DESCRIPTION .....5**

**3. RELEVANT PLANNING CONDITION .....14**

**4. ACCESS DETAILS .....15**  
 4.1 Wood Lane Mirfield .....15  
 4.2 Colne Bridge Road, Bradley .....15

**APPENDIX A – COLNE BRIDGE ROAD ACCESS POINT, BRADLEY .....17**

**Tables**

Table 2-1 Proposed Stage 6 W3B works – Stations .....6

Table 2-2 Proposed Stage 6 W3B works – Structures .....7

Table 2-3 Proposed Stage 6 W3B works – Drainage.....11

Table 2-4 Proposed Stage 6 W3B works – Earthworks .....11

Table 2-5 Proposed Stage 6 W3B works – Demolitions.....12

## **1. INTRODUCTION**

### **1.1 Background**

- 1.1.1 The Scheme is part of a wider programme of works under the Transpennine Route Upgrade (TRU) which will improve the Transpennine railway between Manchester, Huddersfield, Leeds and York and improve connections between key towns and cities across the north of England.
- 1.1.2 Planning Direction for the Huddersfield to Westtown (Dewsbury) section of the TRU was received from the Department for Transport referenced TWA/21/APP/03, dated 13 October 2022.
- 1.1.3 This document sets out details in relation to Condition 17 of the Deemed Planning Permission for Stage 6 works in works area W3B, specifically the access from Colne Bridge Road, Bradley.

## 2. STAGED APPROACH TO DISCHARGE AND STAGE DESCRIPTION

- 2.1.1 As set out in document ref 151667-TSA-00-TRU-REP-W-EN-001189 version 3 (submitted in relation to Condition 3 of the Deemed Planning) a staged approach is proposed in relation to discharge of the deemed planning conditions.
- 2.1.2 Stage 6 comprises of the main construction phase for civils works for the Huddersfield to Westtown (Dewsbury) Scheme.
- 2.1.3 Stage 6 has been split into two submissions based on geographical areas:
- W3A – Huddersfield to Bradley Junction
  - W3B – Bradley Junction to Westtown (Dewsbury)
- 2.1.4 This document provides details in relation to the Stage 6 W3B works between Bradley Junction and Westtown (Dewsbury), which were set out in Figure 2-1<sup>1</sup> in Volume 4 of the Environmental Statement (ES) and in Chapter 2: Scheme Description (Route Sections 4<sup>2</sup>, 5<sup>3</sup> and 6<sup>4</sup>) in Volume 2ii of the ES.
- 2.1.5 The works required during Stage 6 W3B are summarised in Tables 2-1 to 2-5, and links to the relevant planning drawings are also provided.
- 2.1.6 Route drawings relevant to Stage 6 W3B are:
- Route Drawing 10 - [NR13 Planning Drawing - Route Drawing 10.pdf \(windows.net\)](#)
  - Route Drawing 11 - [NR13 Planning Drawing - Route Drawing 11.pdf \(windows.net\)](#)
  - Route Drawing 12 - [NR13 Planning Drawing - Route Drawing 12.pdf \(windows.net\)](#)
  - Route Drawing 13 - [NR13 Planning Drawing - Route Drawing 13.pdf \(windows.net\)](#)
  - Route Drawing 14 - [NR13 Planning Drawing - Route Drawing 14.pdf \(windows.net\)](#)
  - Route Drawing 15 - [NR13 Planning Drawing - Route Drawing 15.pdf \(windows.net\)](#)
  - Route Drawing 16 - [NR13 Planning Drawing - Route Drawing 16.pdf \(windows.net\)](#)
  - Route Drawing 17 - [NR13 Planning Drawing - Route Drawing 17.pdf \(windows.net\)](#)
  - Route Drawing 18 - [NR13 Planning Drawing - Route Drawing 18.pdf \(windows.net\)](#)
  - Route Drawing 19 - [NR13 Planning Drawing - Route Drawing 19.pdf \(windows.net\)](#)
  - Route Drawing 20 - [NR13 Planning Drawing - Route Drawing 20.pdf \(windows.net\)](#)
  - Route Drawing 21 - [NR13 Planning Drawing - Route Drawing 21.pdf \(windows.net\)](#)
  - Route Drawing 22 - [NR13 Planning Drawing - Route Drawing 22.pdf \(windows.net\)](#)
  - Route Drawing 23 - [NR13 Planning Drawing - Route Drawing 23.pdf \(windows.net\)](#)
  - Route Drawing 24 - [NR13 Planning Drawing - Route Drawing 24.pdf \(windows.net\)](#)
- 2.1.7 All works associated with the construction compounds between Bradley Junction and Westtown (Dewsbury) are detailed in the Stage 1 and Stage 2 documentation (previously submitted planning applications ref: 2022/44/93858/W and 2022/44/93945/W).

---

<sup>1</sup> [Ch02 Scheme Description - Fig 2-1 Scheme drawings.pdf \(windows.net\)](#)

<sup>2</sup> [W3 ES Volume 2ii: Ch02 Colne Bridge and Battysford - Scheme Description](#)

<sup>3</sup> [W3 ES Volume 2ii: Ch02 Mirfield and Lower Hopton - Scheme Description](#)

<sup>4</sup> [W3 ES Volume 2ii: Ch02 Ravensthorpe and Westtown - Scheme Description](#)

**Table 2-1 Proposed Stage 6 W3B works – Stations**

Station name	Description of works	Planning drawing title and ref
Mirfield Station	<ul style="list-style-type: none"> <li>• Reconstruction of the island platform (150m usable platform).</li> <li>• Island platform provided with two waiting shelter seating areas</li> <li>• Step free station access to be provided to the east of Station Road. Existing access on west side of Station Road to be infilled</li> <li>• Visual and audio announcements will be provided on platforms</li> <li>• CCTV and lighting will be provided on the platform, in the station entrance and car park</li> <li>• The station car park is to be retained in its current location</li> </ul>	<ul style="list-style-type: none"> <li>• Existing Site Plan (1) – <a href="#">151667-TSA-34-MVN2-DRG-T-LP-162451</a></li> <li>• Existing Site Plan (2) – <a href="#">151667-TSA-34-MVN2-DRG-T-LP-162452</a></li> <li>• Existing Site Plan (3) – <a href="#">151667-TSA-34-MVN2-DRG-T-LP-162453</a></li> <li>• Footbridge – Proposed Deck and Sections – <a href="#">151667-TSA-34-MVN2-DRG-T-LP-162470</a></li> <li>• Footbridge – Proposed Elevations and Lift – <a href="#">151667-TSA-34-MVN2-DRG-T-LP-162469</a></li> <li>• Footbridge – Proposed General Arrangement and Elevation - <a href="#">151667-TSA-34-MVN2-DRG-T-LP-162468</a></li> <li>• Existing Location Plan – <a href="#">151667-TSA-34-MVN2-DRG-T-LP-162450</a></li> <li>• Platform Elevation - <a href="#">151667-TSA-34-MVN2-DRG-T-LP-162461</a></li> <li>• Platform General Arrangement (1) – <a href="#">151667-TSA-34-MVN2-DRG-T-LP-162457</a></li> <li>• Platform General Arrangement (2) – <a href="#">151667-TSA-34-MVN2-DRG-T-LP-162458</a></li> <li>• Platform General Arrangement (3) – <a href="#">151667-TSA-34-MVN2-DRG-T-LP-162459</a></li> <li>• Platform Proposed Cross Sections – <a href="#">151667-TSA-34-MVN2-DRG-T-LP-162462</a></li> <li>• Proposed Highway Works General Arrangement - <a href="#">151667-TSA-34-MVN2-DRG-T-LP-162463</a></li> <li>• Proposed Site Plan (1) – <a href="#">151667-TSA-34-MVN2-DRG-T-LP-162454</a></li> <li>• Proposed Site Plan (2) – <a href="#">151667-TSA-34-MVN2-DRG-T-LP-162455</a></li> <li>• Proposed Site Plan (3) – <a href="#">151667-TSA-34-MVN2-DRG-T-LP-162456</a></li> <li>• Totem drawing – <a href="#">151667-TSA-34-MVN2-DRG-T-LP-162465</a></li> </ul>
Ravensthorpe Station	<ul style="list-style-type: none"> <li>• The existing station will be closed, and its existing platforms demolished. The existing Ravensthorpe Station Footbridge (MVL1/4) will also be demolished.</li> <li>• A new station will be provided to the west of the realigned Calder Road</li> <li>• Provision of an island platform (150m) to serve the stopping services on the slow lines. Passive provision to extend to 200m.</li> </ul>	<ul style="list-style-type: none"> <li>• Existing Site Plan (1) – <a href="#">151667-TSA-35-MVN2-DRG-T-LP-162552</a></li> <li>• Existing Site Plan (2) – <a href="#">151667-TSA-35-MVN2-DRG-T-LP-162553</a></li> <li>• Existing Site Plan (3) – <a href="#">151667-TSA-35-MVN2-DRG-T-LP-162554</a></li> <li>• Existing Site Plan (4) – <a href="#">151667-TSA-35-MVN2-DRG-T-LP-162555</a></li> <li>• Existing Site Plan (5) – <a href="#">151667-TSA-35-MVN2-DRG-T-LP-162565</a></li> <li>• Forecourt General Arrangement - <a href="#">151667-TSA-35-MVN2-DRG-T-LP-162556</a></li> <li>• Location Plan – <a href="#">151667-TSA-35-MVN2-DRG-T-LP-162550</a></li> <li>• Platform Cross Sections - <a href="#">151667-TSA-35-MVN2-DRG-T-LP-162567</a></li> <li>• Proposed Platform Elevation - <a href="#">151667-TSA-35-MVN2-DRG-T-LP-162566</a></li> <li>• Proposed Footbridge Elevations - <a href="#">151667-TSA-35-MVN2-DRG-T-LP-162576</a></li> <li>• Proposed Footbridge General Arrangement - <a href="#">151667-TSA-35-MVN2-DRG-T-LP-162575</a></li> </ul>

Station name	Description of works	Planning drawing title and ref
	<ul style="list-style-type: none"> <li>The platform will be provided with two waiting shelters seating areas</li> <li>Visual and audio announcements will be provided on platforms</li> <li>CCTV and lighting will be provided on both platform, forecourt and station entrance</li> <li>The station will be accessed from the south via a new forecourt from a roundabout on the realigned Calder Road, consisting of three number blue badge accessible parking spaces, a maintenance parking bay and a vehicle turning head.</li> <li>The platform will be accessed via a footbridge (Ravensthorpe Station Footbridge (MVN2/201A)) with stairs and a lift. The footbridge will be level with the new forecourt.</li> </ul>	<ul style="list-style-type: none"> <li>Proposed Footbridge Sections and Details - <a href="#">151667-TSA-35-MVN2-DRG-T-LP-162577</a></li> <li>Proposed Platform General Arrangement (1) - <a href="#">151667-TSA-35-MVN2-DRG-T-LP-162562</a></li> <li>Proposed Platform General Arrangement (2) - <a href="#">151667-TSA-35-MVN2-DRG-T-LP-162563</a></li> <li>Proposed Platform General Arrangement (3) - <a href="#">151667-TSA-35-MVN2-DRG-T-LP-162564</a></li> <li>Proposed Site Plan (1) - <a href="#">151667-TSA-35-MVN2-DRG-T-LP-162557</a></li> <li>Proposed Site Plan (2) - <a href="#">151667-TSA-35-MVN2-DRG-T-LP-162558</a></li> <li>Proposed Site Plan (3) - <a href="#">151667-TSA-35-MVN2-DRG-T-LP-162559</a></li> <li>Proposed Site Plan (4) - <a href="#">151667-TSA-35-MVN2-DRG-T-LP-162560</a></li> <li>Proposed Site Plan (5) - <a href="#">151667-TSA-35-MVN2-DRG-T-LP-162561</a></li> <li>Proposed Cross Sections (1) - <a href="#">151667-TSA-35-MVN2-DRG-T-LP-162568</a></li> <li>Proposed Cross Sections (2) - <a href="#">151667-TSA-35-MVN2-DRG-T-LP-162569</a></li> <li>Totem drawing - <a href="#">151667-TSA-35-MVN2-DRG-T-LP-162571</a></li> </ul>

**Table 2-2 Proposed Stage 6 W3B works – Structures**

Name of structure	Description of works	Planning drawing title and ref
B6118 Colne Bridge Road Overbridge (MVL3/107)	<ul style="list-style-type: none"> <li>A new bridge will be constructed offline to the east of the existing structure to accommodate new fast lines</li> </ul>	<ul style="list-style-type: none"> <li>Existing Highways General Arrangement - <a href="#">151667-TSA-33-MVL3-DRG-T-LP-163404</a></li> <li>Proposed Highway Profile and Cross Sections - <a href="#">151667-TSA-33-MVL3-DRG-T-LP-163406</a></li> <li>Proposed Highways General Arrangement - <a href="#">151667-TSA-33-MVL3-DRG-T-LP-163405</a></li> <li>Existing Plan - <a href="#">151667-TSA-33-MVL3-DRG-T-LP-168110</a></li> </ul>
Huddersfield Broad Canal Underbridge (MVL3/108S)	<ul style="list-style-type: none"> <li>Reconstruction of bridge deck superstructure on the existing substructure</li> </ul>	<ul style="list-style-type: none"> <li>Existing and Proposed Elevation and Cross Section - <a href="#">151667-TSA-33-MVL3-DRG-T-LP-162301</a></li> <li>Existing and Proposed Plan - <a href="#">151667-TSA-33-MVL3-DRG-T-LP-162300</a></li> </ul>
Colne Viaduct Underbridge (MVL3/109)	<ul style="list-style-type: none"> <li>New fast lines will be constructed to the south side of the existing railway corridor and will use the</li> </ul>	<ul style="list-style-type: none"> <li>Existing and Proposed Elevation and Cross Section - <a href="#">151667-TSA-33-MVL3-DRG-T-LP-162311</a></li> <li>Existing and Proposed Plan - <a href="#">151667-TSA-33-MVL3-DRG-T-LP-162310</a></li> </ul>

Name of structure	Description of works	Planning drawing title and ref
	<p>existing redundant spans to cross the river. To support the two new fast lines, the existing metallic deck to be to be modified and replaced with a new reinforced concrete deck. Two existing structures (masonry and steel) will both be modified to include a cantilever structure for a walkway and for the diverted sewer main to the south of line.</p>	
<p>Parks Overbridge (MVL3/110 and MVL4/1)</p>	<ul style="list-style-type: none"> <li>Construction of a new 2 to 3 span bridge to accommodate new track alignment and OLE.</li> </ul>	<ul style="list-style-type: none"> <li>Existing and Proposed Elevations and Cross Sections - <a href="#">151667-TSA-33-MVL3-DRG-T-LP-162321</a></li> <li>Existing Highways General Arrangement - <a href="#">151667-TSA-33-MVL3-DRG-T-LP-162323</a></li> <li>Existing and Proposed Plan - <a href="#">151667-TSA-33-MVL3-DRG-T-LP-162320</a></li> <li>Proposed Highway Profile and Cross Section - <a href="#">151667-TSA-33-MVL3-DRG-T-LP-162325</a></li> <li>Proposed Highways General Arrangement - <a href="#">151667-TSA-33-MVL3-DRG-T-LP-162324</a></li> </ul>
<p>Cooper Bridge Intersection (MVL4/2)</p>	<ul style="list-style-type: none"> <li>Replacement of existing masonry arch</li> </ul>	<ul style="list-style-type: none"> <li>Existing and Proposed Elevation and Cross Section - <a href="#">151667-TSA-33-MVL4-DRG-T-LP-162341</a></li> <li>Existing and Proposed Plan - <a href="#">151667-TSA-33-MVL4-DRG-T-LP-162340</a></li> </ul>
<p>Heaton Lane Footbridge (MVL4/4)</p>	<ul style="list-style-type: none"> <li>Construction of a new stepped footbridge to modern railway standards to accommodate OLE</li> </ul>	<ul style="list-style-type: none"> <li>Existing and Proposed Plan - <a href="#">151667-TSA-33-MVL4-DRG-T-LP-162372</a></li> <li>Elevations and Cross Sections (1) - <a href="#">151667-TSA-33-MVL4-DRG-T-LP-162373</a></li> <li>Elevations and Cross Sections (2) - <a href="#">151667-TSA-33-MVL4-DRG-T-LP-162374</a></li> </ul>
<p>Helm Lane Underbridge (MVN2/188)</p>	<ul style="list-style-type: none"> <li>Existing underpass to be filled and replacement subway to be provided.</li> </ul>	<ul style="list-style-type: none"> <li>Existing and Proposed Cross Sections - <a href="#">151667-TSA-33-MVL4-DRG-T-LP-162371</a></li> </ul>
<p>Mirfield Viaduct (MVN2/192 and 192A)</p>	<ul style="list-style-type: none"> <li>Additional track to be added to MVN2/192A</li> <li>Strengthening works along viaduct</li> </ul>	<ul style="list-style-type: none"> <li>Existing and Proposed Sections - <a href="#">151667-TSA-34-MVN2-DRG-T-LP-168124</a></li> <li>Existing and Proposed Plan - <a href="#">151667-TSA-34-MVN2-DRG-T-LP-168120</a></li> <li>North Elevation (1) - <a href="#">151667-TSA-34-MVN2-DRG-T-LP-168121</a></li> <li>North Elevation (2) - <a href="#">151667-TSA-34-MVN2-DRG-T-LP-168122</a></li> <li>North Elevation (3) - <a href="#">151667-TSA-34-MVN2-DRG-T-LP-168123</a></li> </ul>



Name of structure	Description of works	Planning drawing title and ref
Station Road Underbridge (MVN2/193)	<ul style="list-style-type: none"> <li>• Bridge deck replacement and removal of eastern abutment due to inadequate horizontal clearance for four tracking and works within the station, including relocation of platforms.</li> </ul>	<ul style="list-style-type: none"> <li>• Existing and Proposed Plans - <a href="#">151667-TSA-34-MVN2-DRG-T-LP-162473</a></li> <li>• Existing and Proposed Sections - <a href="#">151667-TSA-34-MVN2-DRG-T-LP-162474</a></li> </ul>
Calder Road Overbridge (MVN2/202)	<ul style="list-style-type: none"> <li>• A new bridge will be constructed to the west of the existing bridge to allow for the change in vertical alignment of the tracks to facilitate construction of the Flyover Intersection (RBA/1)</li> </ul>	<ul style="list-style-type: none"> <li>• Existing and Proposed Elevations - <a href="#">151667-TSA-35-MVN2-DRG-T-LP-162431</a></li> <li>• Existing Highways General Arrangement (1) - <a href="#">151667-TSA-35-MVN2-DRG-T-LP-162433</a></li> <li>• Existing Highways General Arrangement (2) - <a href="#">151667-TSA-35-MVN2-DRG-T-LP-162434</a></li> <li>• Existing Highways General Arrangement (3) - <a href="#">151667-TSA-35-MVN2-DRG-T-LP-162435</a></li> <li>• Existing Highways General Arrangement (4) - <a href="#">151667-TSA-35-MVN2-DRG-T-LP-162436</a></li> <li>• Existing and Proposed Plan - <a href="#">151667-TSA-35-MVN2-DRG-T-LP-162430</a></li> <li>• Proposed Highway Profile - <a href="#">151667-TSA-35-MVN2-DRG-T-LP-162441</a></li> <li>• Proposed Highway Cross Sections - <a href="#">151667-TSA-35-MVN2-DRG-T-LP-162442</a></li> <li>• Proposed Highway General Arrangement (1) - <a href="#">151667-TSA-35-MVN2-DRG-T-LP-162437</a></li> <li>• Proposed Highway General Arrangement (2) - <a href="#">151667-TSA-35-MVN2-DRG-T-LP-162438</a></li> <li>• Proposed Highway General Arrangement (3) - <a href="#">151667-TSA-35-MVN2-DRG-T-LP-162439</a></li> <li>• Proposed Highway General Arrangement (4) - <a href="#">151667-TSA-35-MVN2-DRG-T-LP-162440</a></li> </ul>
Flyover Intersection (RBA/1)	<ul style="list-style-type: none"> <li>• To achieve the grade separated junction to enable the fast lines to cross over the slow lines towards Wakefield a new intersection structure will be constructed</li> </ul>	<ul style="list-style-type: none"> <li>• Existing and Proposed Plan - <a href="#">151667-TSA-35-MVN2-DRG-T-LP-162670</a></li> <li>• Proposed Elevation and Cross Section - <a href="#">151667-TSA-35-MVN2-DRG-T-LP-162671</a></li> </ul>
Baker Viaduct (RBA/2)	<ul style="list-style-type: none"> <li>• Construction of new 9 span viaduct to carry the fast and slow lines (new railway) (300-400m long) over the Calder and Hebble Navigation and River Calder.</li> </ul>	<ul style="list-style-type: none"> <li>• Detailed Elevation - <a href="#">151667-TSA-35-MVN2-DRG-T-LP-162616</a></li> <li>• Elevations and Sections - <a href="#">151667-TSA-35-MVN2-DRG-T-LP-162615</a></li> <li>• Existing and Proposed Plan - <a href="#">151667-TSA-35-MVN2-DRG-T-LP-162601</a></li> </ul>
Lees Hall Farm Underbridge (MVN2/204)	<ul style="list-style-type: none"> <li>• Infilling of structure due to the realignment of railway lines to facilitate the Flyover Intersection (RBA/1)</li> </ul>	<ul style="list-style-type: none"> <li>• Existing and Proposed Elevation - <a href="#">151667-TSA-35-MVN2-DRG-T-LP-162502</a></li> <li>• Existing and Proposed Plan - <a href="#">151667-TSA-35-MVN2-DRG-T-LP-162500</a></li> <li>• Existing and Proposed Section - <a href="#">151667-TSA-35-MVN2-DRG-T-LP-162501</a></li> </ul>

Name of structure	Description of works	Planning drawing title and ref
B6117 Fall Lane, Thornhill Road Underbridge (MDL1/9)	<ul style="list-style-type: none"> <li>New structure is required to accommodate the railway realignment</li> </ul>	<ul style="list-style-type: none"> <li>Existing and Proposed Section - <a href="#">151667-TSA-35-MVN2-DRG-T-LP-162516</a></li> <li>Existing and Proposed Elevation - <a href="#">151667-TSA-35-MVN2-DRG-T-LP-162511</a></li> <li>Existing Highway General Arrangement - <a href="#">151667-TSA-35-MVN2-DRG-T-LP-162512</a></li> <li>Highway Profile Cross Section - <a href="#">151667-TSA-35-MVN2-DRG-T-LP-162514</a></li> <li>Existing and Proposed Plan - <a href="#">151667-TSA-35-MVN2-DRG-T-LP-162510</a></li> <li>Proposed Highway General Arrangement - <a href="#">151667-TSA-35-MVN2-DRG-T-LP-162513</a></li> </ul>
Occupation Underbridge (MDL1/10)	<ul style="list-style-type: none"> <li>Infilling of structure severing private access to a residential property. A new access will be provided to the south of the residential property from Calder Bank Road.</li> </ul>	<ul style="list-style-type: none"> <li>Existing and Proposed Sections - <a href="#">151667-TSA-35-MVN2-DRG-T-LP-168143</a></li> <li>Existing and Proposed Plan - <a href="#">151667-TSA-35-MVN2-DRG-T-LP-168140</a></li> <li>North Elevation - <a href="#">151667-TSA-35-MVN2-DRG-T-LP-168141</a></li> <li>South Elevation - <a href="#">151667-TSA-35-MVN2-DRG-T-LP-168142</a></li> </ul>
Toad Holes Underbridge (MDL1/12)	<ul style="list-style-type: none"> <li>Infilling of structure due to poor condition</li> </ul>	<ul style="list-style-type: none"> <li>Existing and Proposed Elevation - <a href="#">151667-TSA-35-MVN2-DRG-T-LP-168151</a></li> <li>Existing and Proposed Plan - <a href="#">151667-TSA-35-MVN2-DRG-T-LP-168152</a></li> </ul>
Ming Hill Underbridge (MDL1/14)	<ul style="list-style-type: none"> <li>Infilling of structure (southern side) due to potential future maintenance liability of retaining the structure</li> </ul>	<ul style="list-style-type: none"> <li>Existing and Proposed Elevation - <a href="#">151667-TSA-35-MVN2-DRG-T-LP-168161</a></li> <li>Existing and Proposed Plan - <a href="#">151667-TSA-35-MVN2-DRG-T-LP-168160</a></li> <li>Existing and Proposed Section - <a href="#">151667-TSA-35-MVN2-DRG-T-LP-168162</a></li> </ul>

2.1.8 Locations are shown in Figure 1 in Appendix A.

**Table 2-3 Proposed Stage 6 W3B works – Drainage**

Culvert name	Description of works
Colnebridge Culvert (MVL3/110A)	<ul style="list-style-type: none"> <li>• Culvert extended by 15m to the south to take existing watercourse under new fast lines.</li> <li>• Existing headwall to be removed and replaced with new headwall</li> </ul>
Heaton Lodge Junction Culvert (MVN2/190)	<ul style="list-style-type: none"> <li>• Culvert to be repaired and modified</li> </ul>
Mirfield Culvert (MVN2/190B)	<ul style="list-style-type: none"> <li>• Culvert to be repaired and modified</li> </ul>
Mirfield Culvert (MVN2/190C)	<ul style="list-style-type: none"> <li>• Culvert to be repaired and modified</li> </ul>
Chadwick Close Culvert (MVN2/191A)	<ul style="list-style-type: none"> <li>• Repairs and modifications which may include culvert extensions upstream and downstream with replacement of chambers</li> </ul>
Mirfield Station (MVN2/none)	<ul style="list-style-type: none"> <li>• A new storm water drainage system is required for the re-modelled platforms and additional track drainage</li> </ul>
Sands Lane Culvert (MVN2/198B)	<ul style="list-style-type: none"> <li>• Culvert to be repaired and modified</li> </ul>
Ladywood Culvert (MVN2/200C)	<ul style="list-style-type: none"> <li>• Culvert to be extended by 5m</li> </ul>
Ladywood Road Culvert (MVN2/200)	<ul style="list-style-type: none"> <li>• Culvert to be extended with a new headwall</li> </ul>
Ravensthorpe Station	<ul style="list-style-type: none"> <li>• Re-grading of existing drainage within the adjacent property will be required</li> </ul>
Ravensthorpe Triangle	<ul style="list-style-type: none"> <li>• Drainage will replicate existing and use of storm water attenuation structures and infiltration basins</li> </ul>

2.1.9 There are existing earthworks throughout the Scheme area associated with the existing operational railway. Earthworks allow the track to stay relatively level through a varied topography and allows trains to operate more efficiently by reducing the need for additional acceleration and deceleration to climb and descend climbs.

2.1.10 Earthworks (new and where they have been reworked) will generally be covered in topsoil and landscaped as appropriate. Any exceptions to this will be detailed within the Landscape and Ecological Management Plan (LEMP) Stage 8.

2.1.11 Locations are shown in Figure 1 in Appendix A.

**Table 2-4 Proposed Stage 6 W3B works – Earthworks**

Earthworks ID	Description of works
E9	<ul style="list-style-type: none"> <li>• Widening of cutting to facilitate four tracking and track realignment</li> <li>• 150m length and 2.2m height</li> </ul>
W11	<ul style="list-style-type: none"> <li>• Reprofilling to a 1 in 2 slope</li> <li>• Wall needed due to track realignment affecting existing embankment</li> <li>• 80m length and 3m height</li> </ul>
E10	<ul style="list-style-type: none"> <li>• Reprofilling and widening of earthworks embankment</li> <li>• 100m length and 3-5m in height</li> </ul>
E11	<ul style="list-style-type: none"> <li>• New cutting for construction of fast lines</li> <li>• 1050m in length and 10m in height</li> </ul>
W13	<ul style="list-style-type: none"> <li>• Reinforced soil wall at Ravensthorpe Junction – Flyover Intersection (RBA/1)</li> <li>• Required to support works to fast line</li> </ul>

Earthworks ID	Description of works
	<ul style="list-style-type: none"> <li>• 75m length and 6m height</li> </ul>
W15	<ul style="list-style-type: none"> <li>• Reinforced soil wall at Ravensthorpe Junction – Flyover Intersection (RBA/1)</li> <li>• 80m length and 7m height</li> </ul>
E13	<ul style="list-style-type: none"> <li>• Earthwork cutting to west of Calder Road Overbridge (MVN2/202) as part of new station site.</li> <li>• 465m length up to 16.9m in height</li> </ul>
E15	<ul style="list-style-type: none"> <li>• Embankment</li> <li>• Widening of cutting for track works</li> <li>• 120m length and up to 6m height</li> </ul>
E16	<ul style="list-style-type: none"> <li>• Earthwork at Ravensthorpe Junction as part of new flyover and viaduct structures.</li> <li>• Lies within the Thornhill Quarry Landfill site.</li> <li>• 390m length and up to 10m height</li> </ul>
W17	<ul style="list-style-type: none"> <li>• Reinforced soil retaining wall adjacent to Kirklees Household Waste Recycling Centre (HWRC)</li> <li>• Required due to construction of Baker Viaduct Underbridge (RBA/2)</li> <li>• 265m length and 9m height</li> </ul>
E18	<ul style="list-style-type: none"> <li>• Widening of existing soil embankment west of Thornhill Road</li> <li>• 100m length and 4.5m height</li> </ul>
W19	<ul style="list-style-type: none"> <li>• Existing soil embankment to be replaced by a ballast retention wall.</li> <li>• Works required due to vertical track realignment at Thornhill Road</li> <li>• 150m length and 1.5m height</li> </ul>
E19	<ul style="list-style-type: none"> <li>• Widening of existing soil embankment east of Thornhill Road</li> <li>• 125m length and 5m height</li> </ul>
W20/W21	<ul style="list-style-type: none"> <li>• Reinforced soil wall</li> <li>• Required due to road realignment of Thornhill Road</li> <li>• Combined 80m length and up to 6m in height</li> </ul>
E20	<ul style="list-style-type: none"> <li>• Soil embankment at the Wakefield line due to works to realign the line.</li> <li>• 480m length and 5m height</li> </ul>
W22	<ul style="list-style-type: none"> <li>• Sheet piled wall</li> <li>• 65m in length and 3m height</li> </ul>

**Table 2-5 Proposed Stage 6 W3B works – Demolitions**

Building requiring demolition	Description of works
Portal Frame building at MVL3/108S	<ul style="list-style-type: none"> <li>• Demolition of industrial building adjacent to the existing line close to Colne Viaduct Underbridge (MVL3/109) and falls under the footprint of the earthworks (embankment)</li> </ul>
Thornhill House, Thornhill Road, Dewsbury	<ul style="list-style-type: none"> <li>• Demolition of commercial unit adjacent to existing line close to Occupation Underbridge (MDL1/10) and falls under the footprint of the earthworks (embankment) in this location.</li> </ul>

2.1.12 The Scheme impacts on various existing transmission and distribution utility networks. Conflicts with utility services may occur where the Scheme crosses highways and over/underbridge structures, or on private land.

2.1.13 Works within the highway will be carried out in compliance with the Highways Agreement and any impacts on the highways network will be discussed through the Highway Network Management Group.

2.1.14 Other specific utilities works within the Stage 6 W3B area include:

- Tensioning of overhead power lines at Huddersfield Broad Canal Underbridge (MVL3/108S);
- Temporary and permanent diversion of Yorkshire Water sludge main onto bridge abutment at Colne Viaduct Underbridge (MVL3/109);
- Works to overhead power lines in Ravensthorpe area including undergrounding of part of the system (Ouzelwell Lane); and
- Gas main diversion works at Heaton Lodge.

### 3. RELEVANT PLANNING CONDITION

3.1.1 The wording of Condition 17 (New Maintenance Access) is reproduced below:

*No development (including preliminary works) in respect of the maintenance access roads to be provided and identified on planning direction drawings 151667-TSA-W3-000-DRG-T-LP-16294 Rev P02 (Wood Lane, Mirfield) and 151667-TSA-W3-000-DRG-T-LP-162939 Rev P02 (Colne Bridge Road, Bradley) must commence until the details of such maintenance access roads have been submitted to and approved in writing by the local planning authority. Thereafter such maintenance access roads shall be provided in accordance with the approved details and retained thereafter.*

**Reason:** *In the interests of highway safety and in accordance with Local Plan policy LP21.*

## **4. ACCESS DETAILS**

### **4.1 Wood Lane Mirfield**

4.1.1 Details relating to Wood Lane were approved – ref 2023/91990 dated 26 February 2026.

### **4.2 Colne Bridge Road, Bradley**

4.2.1 The following drawings are provided in Appendix A:

- 151667-TSA-33-MVL3-DRG-D-HW-074597-P01 – General Arrangement
- 151667-TSA-33-MVL3-DRG-D-HW-074598-P01 – Swept Path Analysis (sheet 1 of 2)
- 151667-TSA-33-MVL3-DRG-D-HW-074588-P01 – Swept Path Analysis (sheet 2 of 2)
- 151667-TSA-33-MVL3-DRG-D-HW-074599-P01 – Pavement and Kerb Details

# Appendices



## **APPENDIX A – COLNE BRIDGE ROAD ACCESS POINT, BRADLEY**

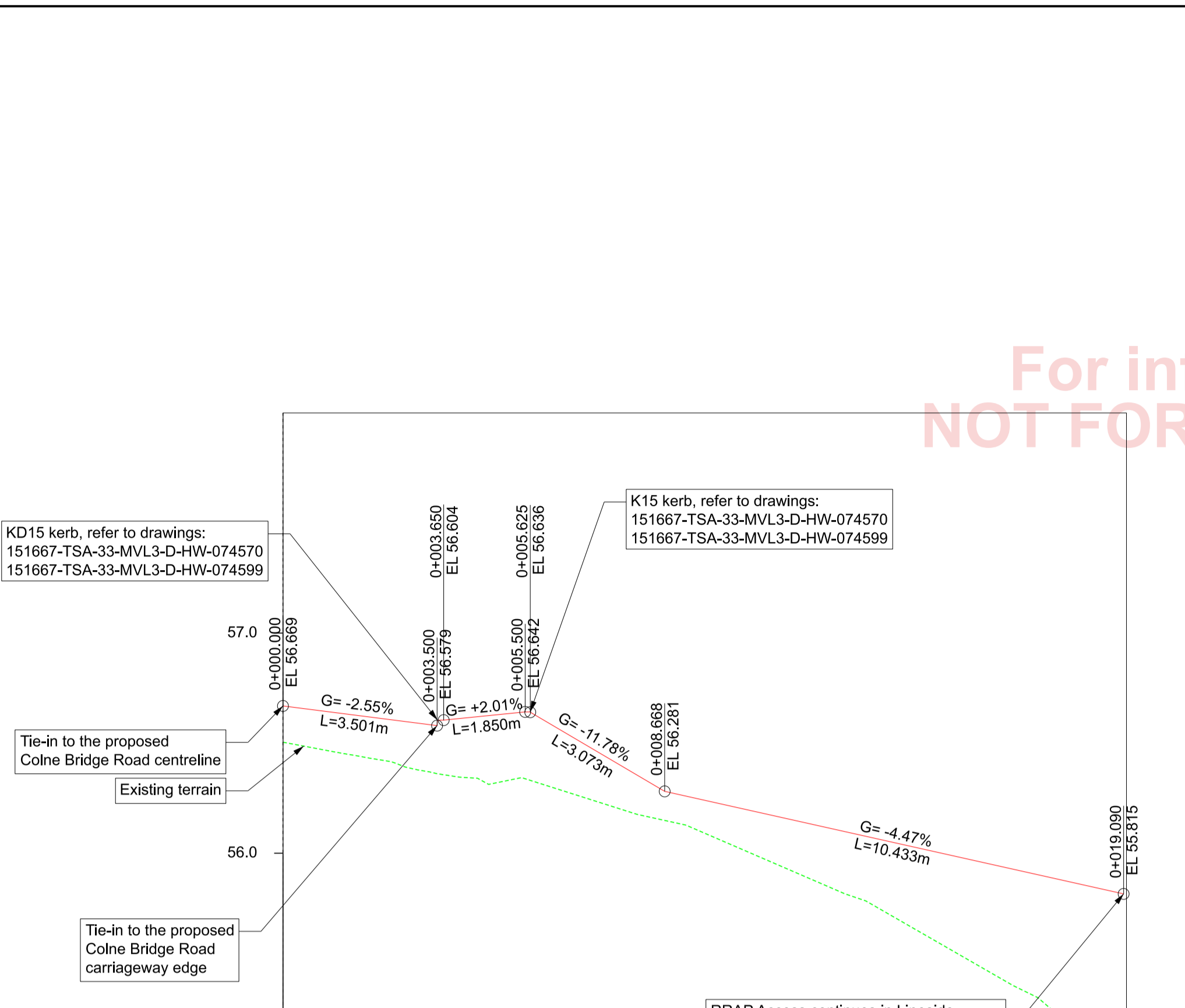
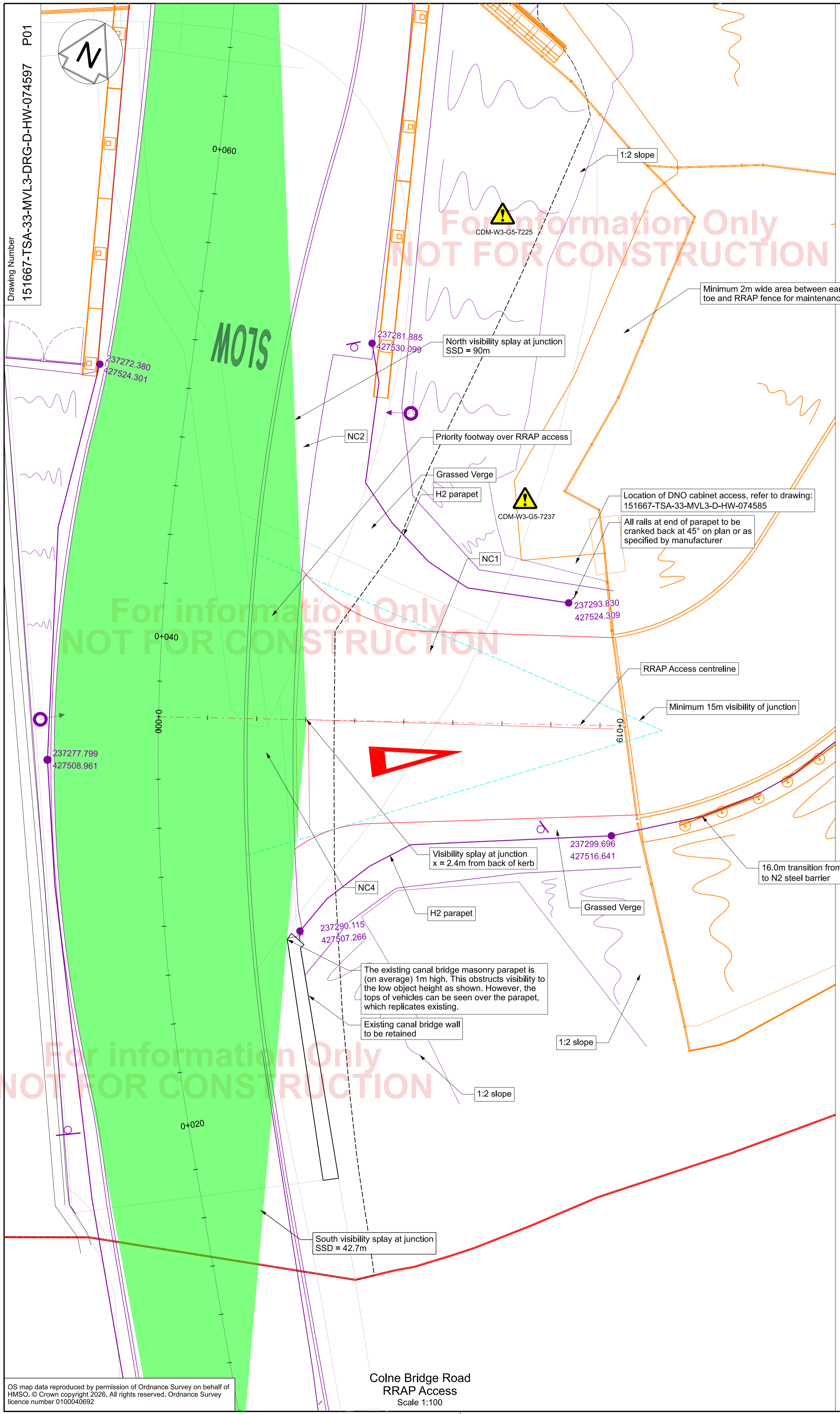

Chainage	0+000.000	0+002.000	0+004.000	0+006.000	0+008.000	0+010.000	0+012.000	0+014.000	0+016.000	0+018.000	0+019.091
Existing level	56.504	56.431	56.345	56.306	56.179	56.054	55.881	55.695	55.465	55.239	55.158
Proposed level	56.669	56.618	56.612	56.575	56.355	56.221	56.132	56.043	55.953	55.864	55.815
Horizontal geometry	L = 19.091m										
Vertical geometry											

Colne Bridge Road RRAP Access Profile  
Horizontal Scale: 1:100  
Vertical Scale: 1:20

**Legend**

- Proposed
- To be removed
- To be modified
- Existing
- Works by other disciplines
- Relevant discipline details but not the focus of this drawing
- Ordnance survey data
- Aerial survey data (LIDAR)
- Indicative Network Rail land boundary
- Highway geometry with 120m radius
- Proposed future works
- Limit of Land to be Acquired or Used
- Limit of Deviation - Bridges and Network Rail Boundary
- RRAP Access Junction Visibility Envelope
- Visibility of Junction

**CDM-W3-G5-7225** Potential to strike 11kv HV ducts, existing ducts and diverted ducts have potential to be struck through the works.

**CDM-W3-G5-7228** Potential for existing utilities to be struck during construction works.

**CDM-W3-G5-7237** Potential for damage to occur to H pole and/or associated bracing systems. Damage to H pole transformer when lifting equipment during construction of highway works in close proximity to H pole.

**CDM-W3-G5-7420** Latest available survey information date June 2024, states findings were negligible, but roosting zones have been confirmed in the surrounding area along the line, potential for bats to now be roosting in the existing structure.

**CDM-W3-G5-7422** The hazard directory (P8) has highlighted the area around Colne Bridge as being at risk from the migration of landfill gasses. Potential exposure to contaminants during excavation.

**WARNING:** Buried Services information supplied is to PAS LEVEL B and has not been verified by intrusive positions. It MUST be considered as "for guidance purposes only". Appropriate safe systems of work shall be employed if breaking ground.

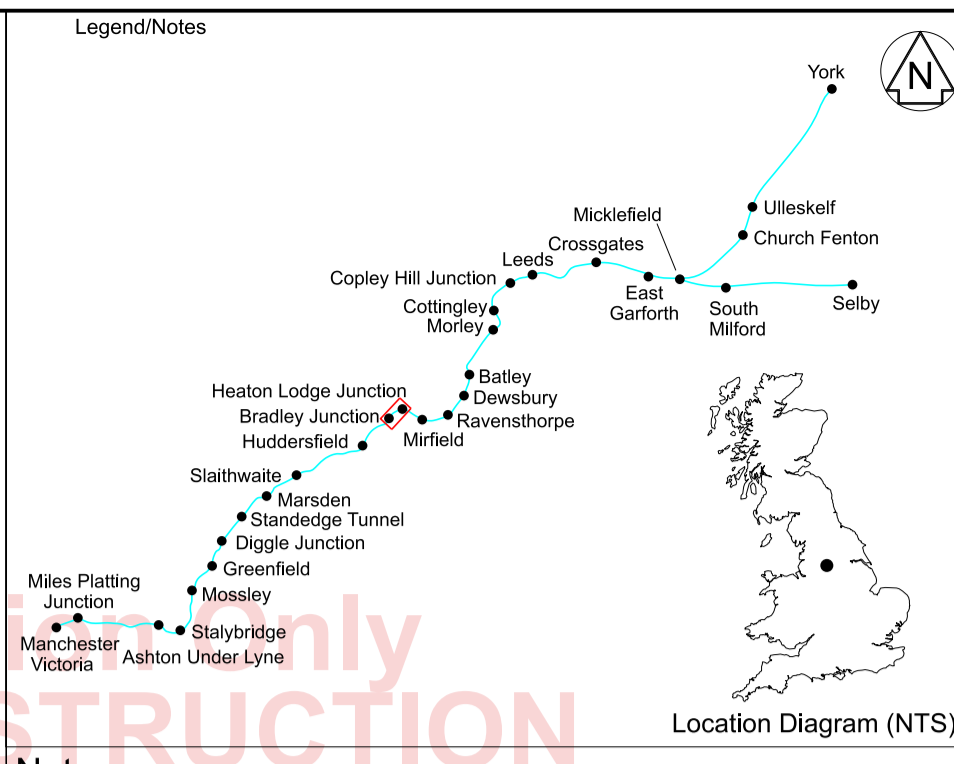

- Notes**
- All dimensions are in metres unless stated otherwise.
  - Do not scale from this drawing.
  - Refer to CDM Hazard log extract: 151667-TSA-33-MVL3-REG-W-MF-000002.
  - This drawing shall be read in conjunction with drawing list: 151667-TSA-33-MVL3-DRG-D-HW-074516.
  - This drawing shall be read in conjunction with the Specification for Highway Works (MCHW) and associated appendices where applicable: 151667-TSA-33-MVL3-SPE-W-HW-075003.
  - Works by other disciplines are shown indicatively, therefore this drawing shall be read in conjunction with all applicable drawings and specifications for this scheme.
  - Buried services information shown is of a varying degree of accuracy. Where available the Quality Level in accordance with PAS 128 (Underground Utility Detection, Verification and Location - Specification) is indicated. Where it is not indicated it should be assumed that the data is Quality Level D (from records).
  - Position and types of utility services are approximate only. Utility services may exist that are not shown on the plan, and those that are shown may not be in the locations indicated. The contractor shall implement measures to confirm the presence of buried services where ground disturbance is required in accordance with HSG47 and NR/L2/INI/1030. This may include, but not limited to, Electromagnetic Location (EML, eg. CAT scanning), Ground Penetrating Radar (GPR) and/or trial holes as appropriate. Any buried services identified are to be marked up, diverted or protected as appropriate in accordance with NR/L2/INI/1030.

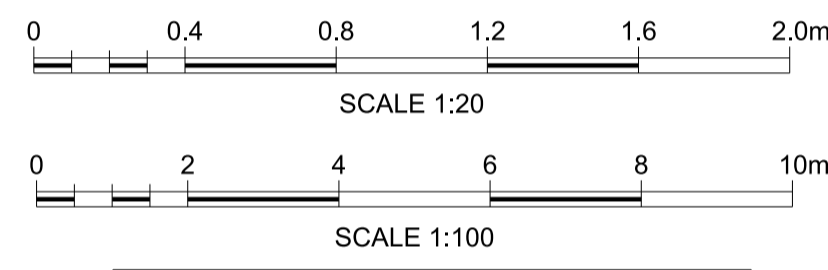

Safety, Health and Environmental Information  
For Health and Safety information, refer to 151667-TSA-33-MVL3-REG-W-MF-000001.

Rev	Date	Description of Revisions	Drawn	Chkd	Appr	Suitability
P01	17/03/26	Issue to Kirklees	SB	RP	CW	S2



Authorised: \_\_\_\_\_ Signed: \_\_\_\_\_ Date: \_\_\_\_\_

Contractor(s): **TRU West Alliance**

Location: **STALYBRIDGE STN - HEATON LODGE JN (HUDD-MANC LINE)**

Type: **CAD Drawing** Sub-type: \_\_\_\_\_

Role: **Drainage and Highways Engineer** Sub-Role: **Highways**

Zone: **Colne Bridge and Battyford**

Phasing: **Proposed** Project Stage: **GRIP 5**

Project: **Transpennine Route Upgrade**

Contract No.: **151667**

Contract Title: **TRU - West of Leeds**

Drawing Title: **Colne Bridge Road RRAP Access**

General Arrangement

Sheet 1 of 1

Designed: **M.Taylor** Signed: \_\_\_\_\_ Date: **17/03/26**

Drawn: **S.Battersby** Signed: **Electronically Signed** Date: **17/03/26**

Checked: **R.Peatfield** Signed: **Electronically Signed** Date: **17/03/26**

Approved: **C.Williams1** Signed: **Electronically Signed** Date: **17/03/26**

Scale(s): **As Shown** ELR & Mileage: **7.163** to **29.0957**

Alternative Reference: \_\_\_\_\_ Sheet **1** of **1**

Drawing Number: **151667-TSA-33-MVL3-DRG-D-HW-074597** Revision: **P01**

OS map data reproduced by permission of Ordnance Survey on behalf of HMSO. © Crown copyright 2026. All rights reserved. Ordnance Survey licence number 0100040892

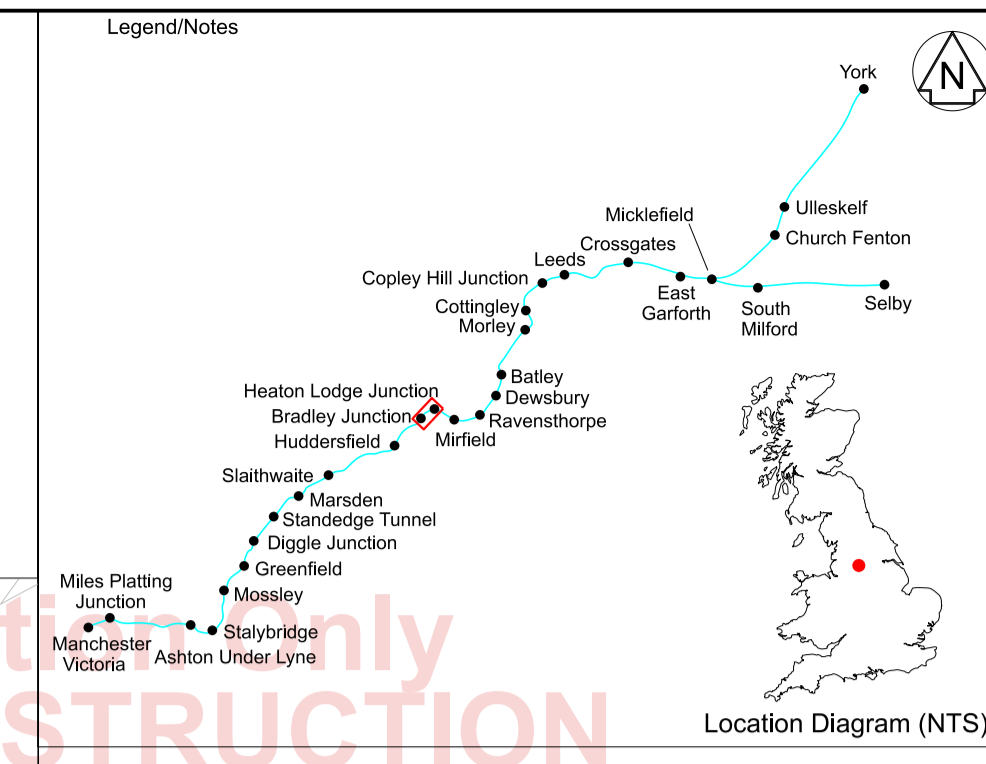
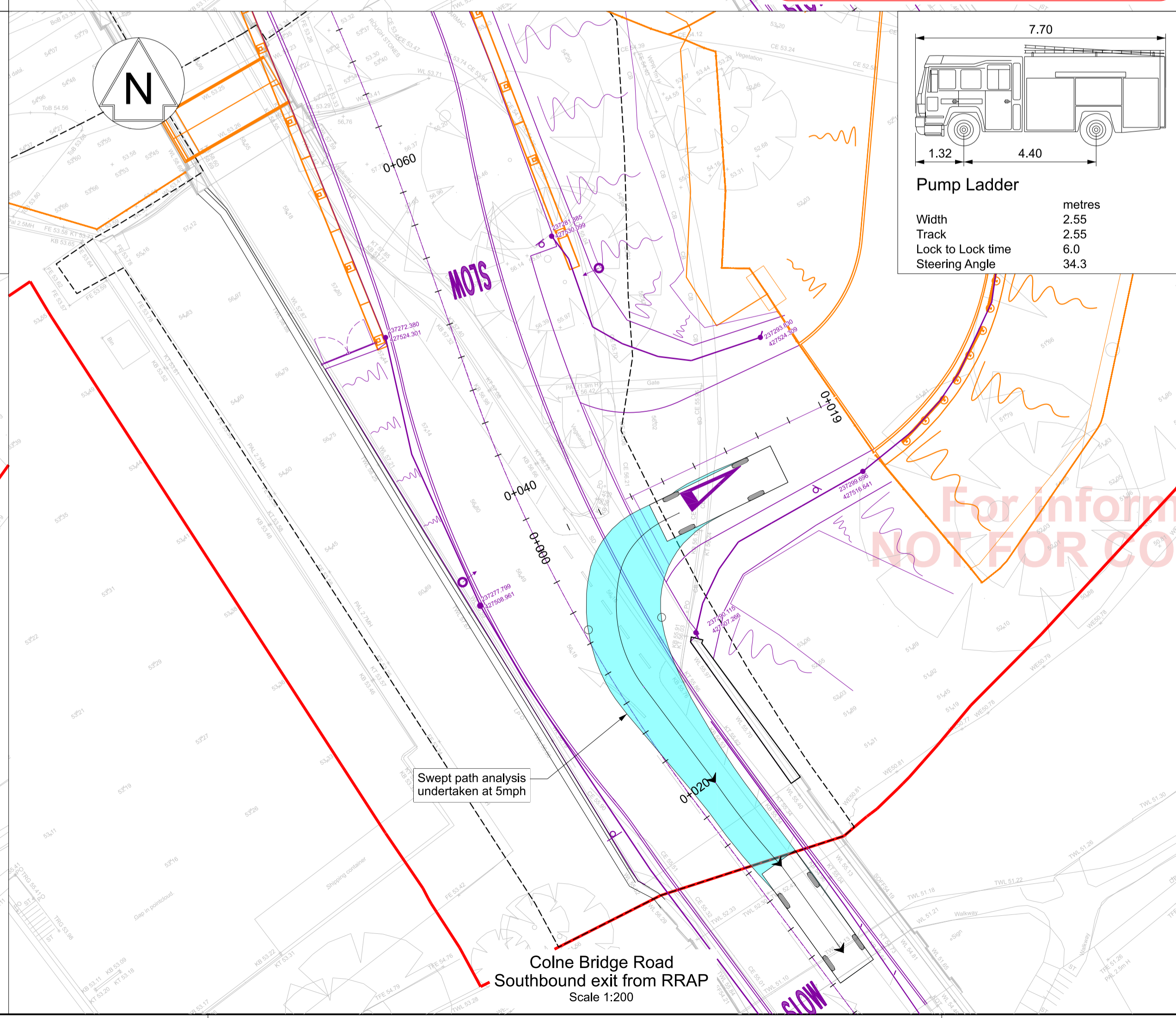
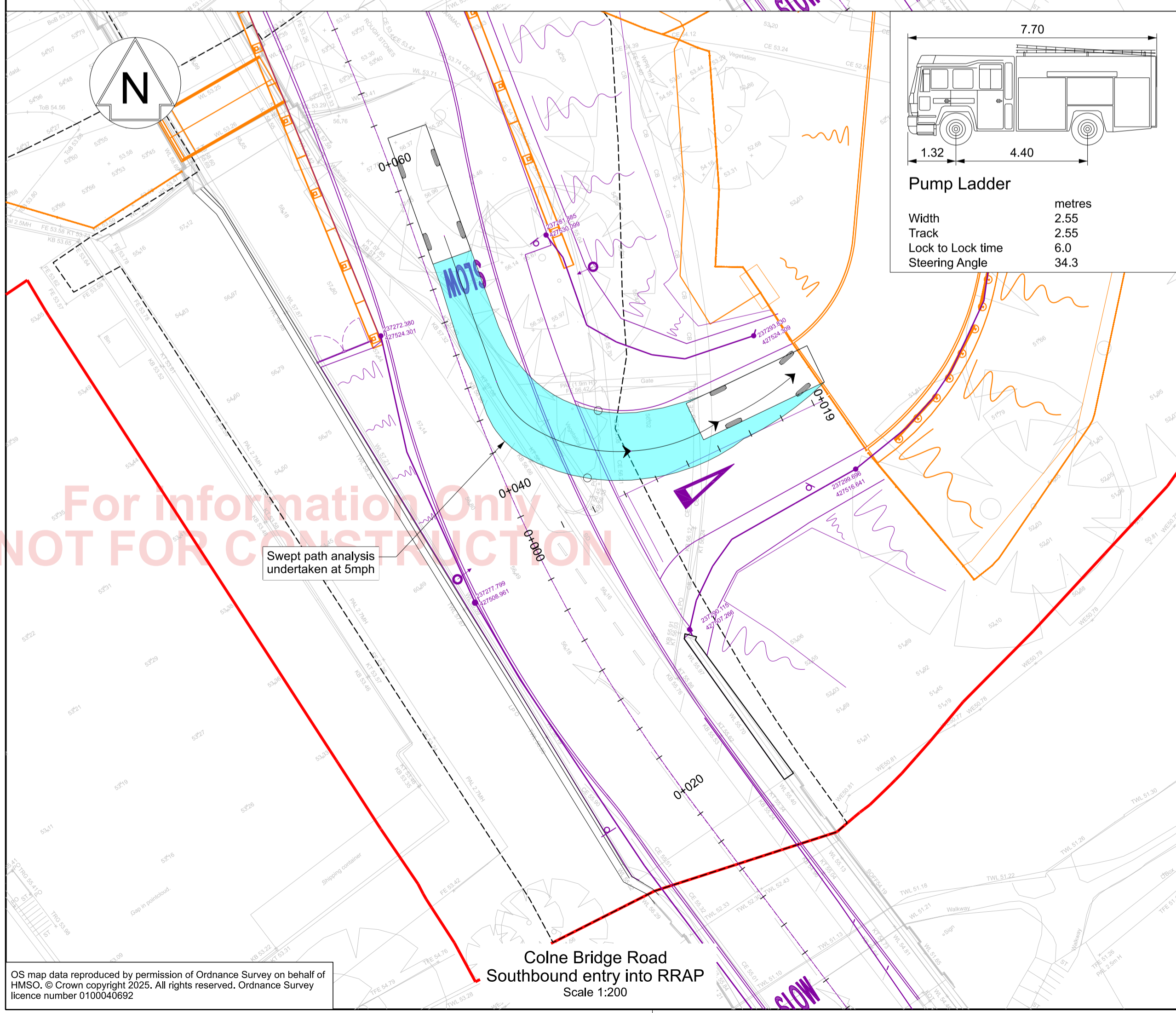
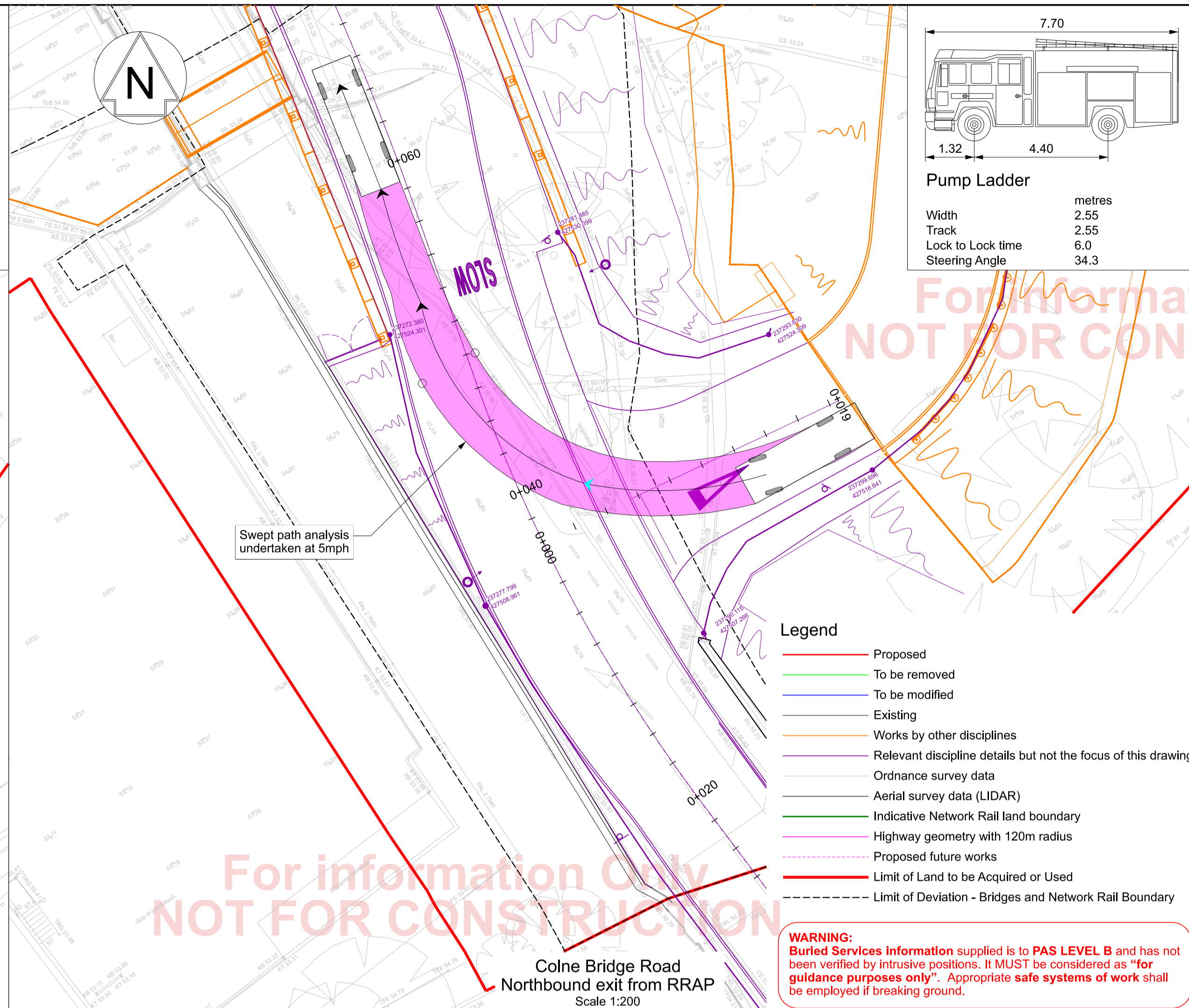
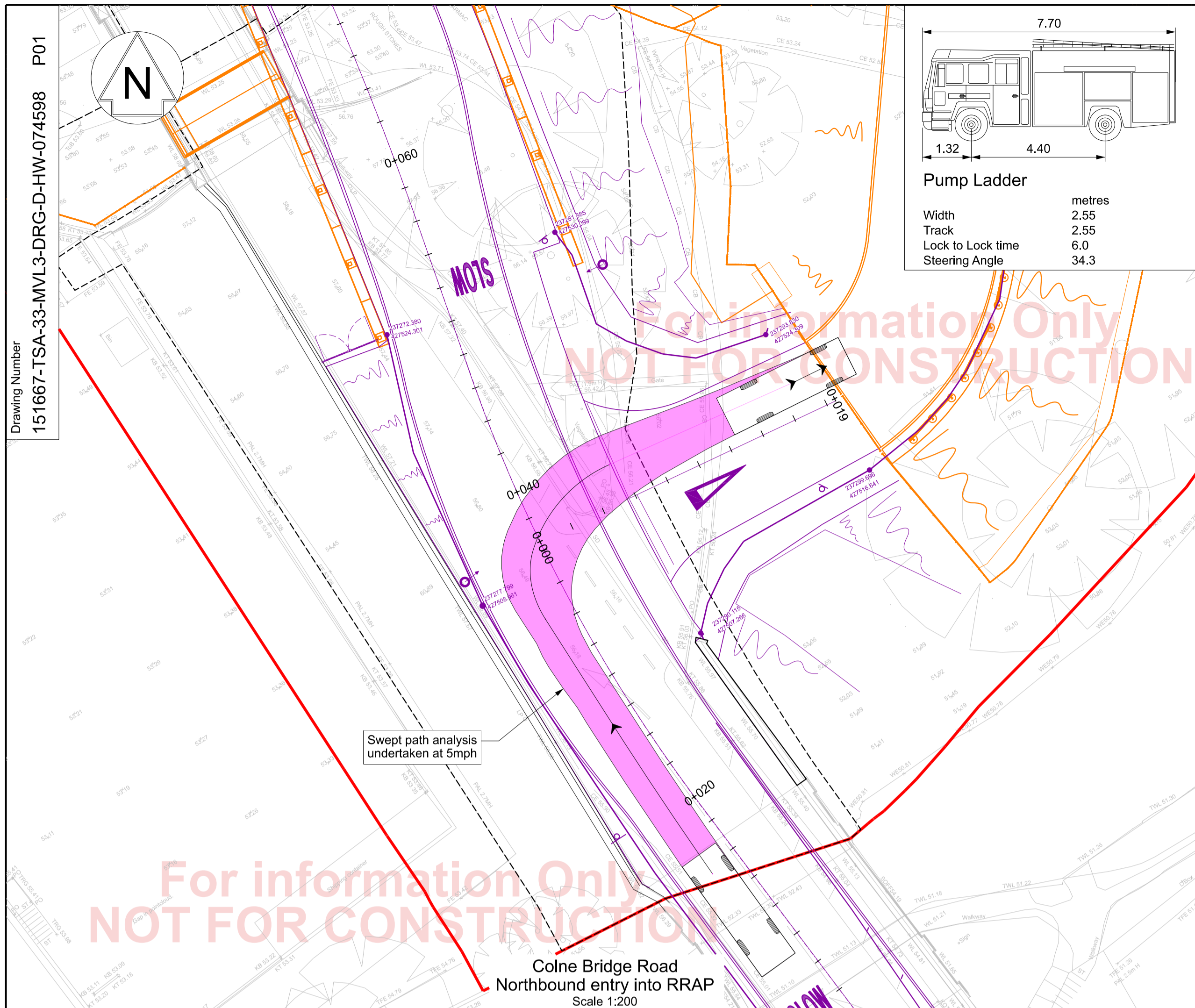

- Notes**
- All dimensions are in metres unless stated otherwise.
  - Do not scale from this drawing.
  - Refer to CDM Hazard log extract: 151667-TSA-33-MVL3-REG-W-MF-000002.
  - This drawing shall be read in conjunction with drawing list: 151667-TSA-33-MVL3-DRG-D-HW-074516.
  - This drawing shall be read in conjunction with the Specification for Highway Works (MCHW) and associated appendices where applicable: 151667-TSA-33-MVL3-SPE-W-HW-075003.
  - Works by other disciplines are shown inductively, therefore this drawing shall be read in conjunction with all applicable drawings and specifications for this scheme.
  - For completion, swept paths have been shown for vehicular movements in both directions into and out of the RRAP access, however in practise the only movements that will be required are left-in and right-out as this is the route from / to the strategic road network.

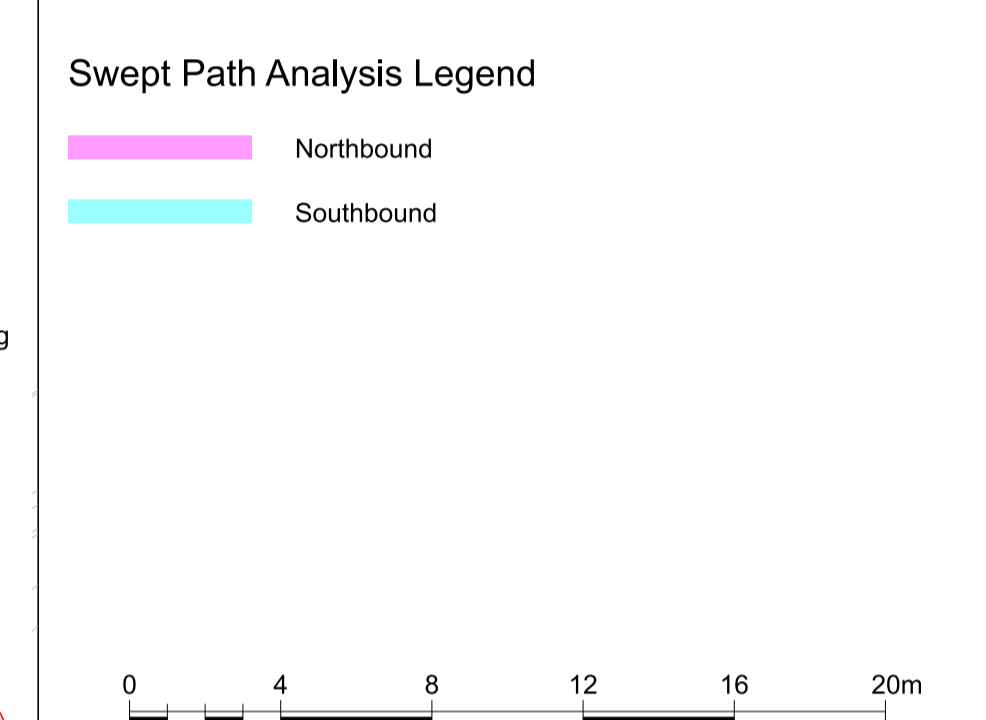

**WARNING:** Buried Services information supplied is to PAS LEVEL B and has not been verified by intrusive positions. It MUST be considered as "for guidance purposes only". Appropriate safe systems of work shall be employed if breaking ground.

**Safety, Health and Environmental Information**  
For Health and Safety information, refer to 151667-TSA-33-MVL3-REG-W-MF-000001.

P01	17/03/26	Issue to Kirklees	SB	RP	CW
Rev	Date	Description of Revisions	Drawn	Chkd	Appr
Status				Suitability	
				<b>S2</b>	



Authorised	Signed	Date
Contractor(s)		
<b>TRU West Alliance</b>		
Location	STALYBRIDGE STN - HEATON LODGE JN (HUDD-MANC LINE)	
Type	CAD Drawing	Sub-type
Role	Drainage and Highways Engineer	Sub-Role
Zone	Colne Bridge and Battyford	
Phasing	Proposed	Project Stage
Project	GRIP 5	

**Transpennine Route Upgrade**  
Contract No. **151667**  
Contract Title **TRU - West of Leeds**  
Drawing Title **Colne Bridge Road RRAP Access Swept Path Analysis Sheet 1 of 2**

Designed	M.Taylor	Signed		Date	17/03/26
Drawn	S.Battersby	Signed	Electronically Signed	Date	17/03/26
Checked	R.Peatfield	Signed	Electronically Signed	Date	17/03/26
Approved	C.Williams1	Signed	Electronically Signed	Date	17/03/26
Scales	1:200	ELR & Mileage	7.163	to	29.0957
Alternative Reference					Sheet
					1 of 2
Drawing Number	151667-TSA-33-MVL3-DRG-D-HW-074598				Revision
					P01

OS map data reproduced by permission of Ordnance Survey on behalf of HMSO. © Crown copyright 2025. All rights reserved. Ordnance Survey licence number 0100040892

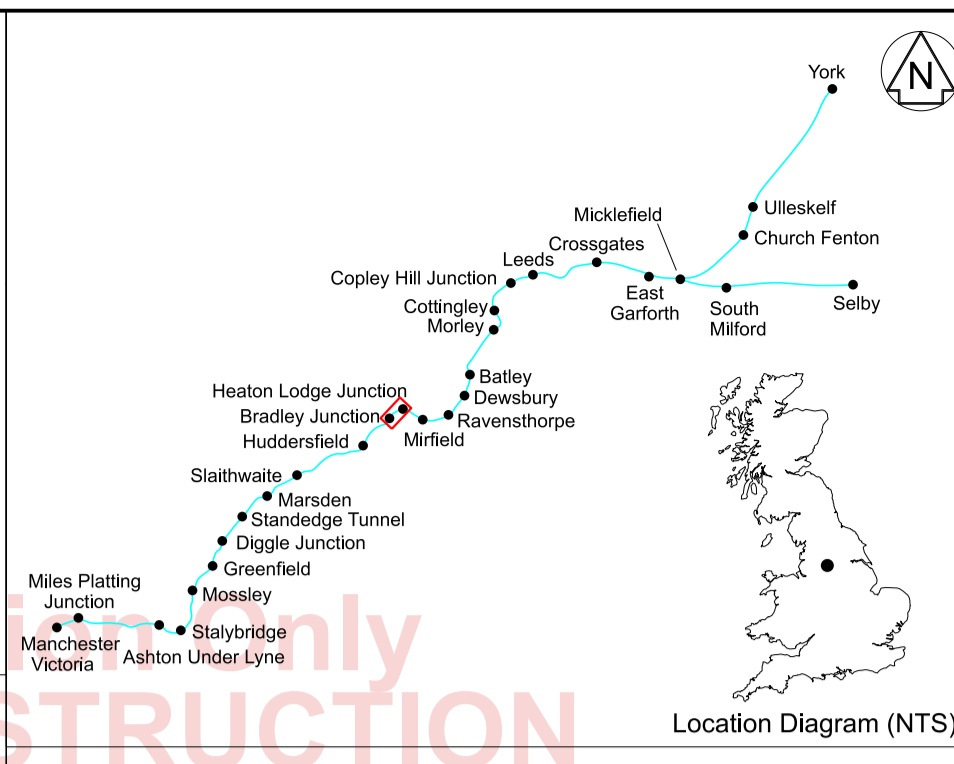
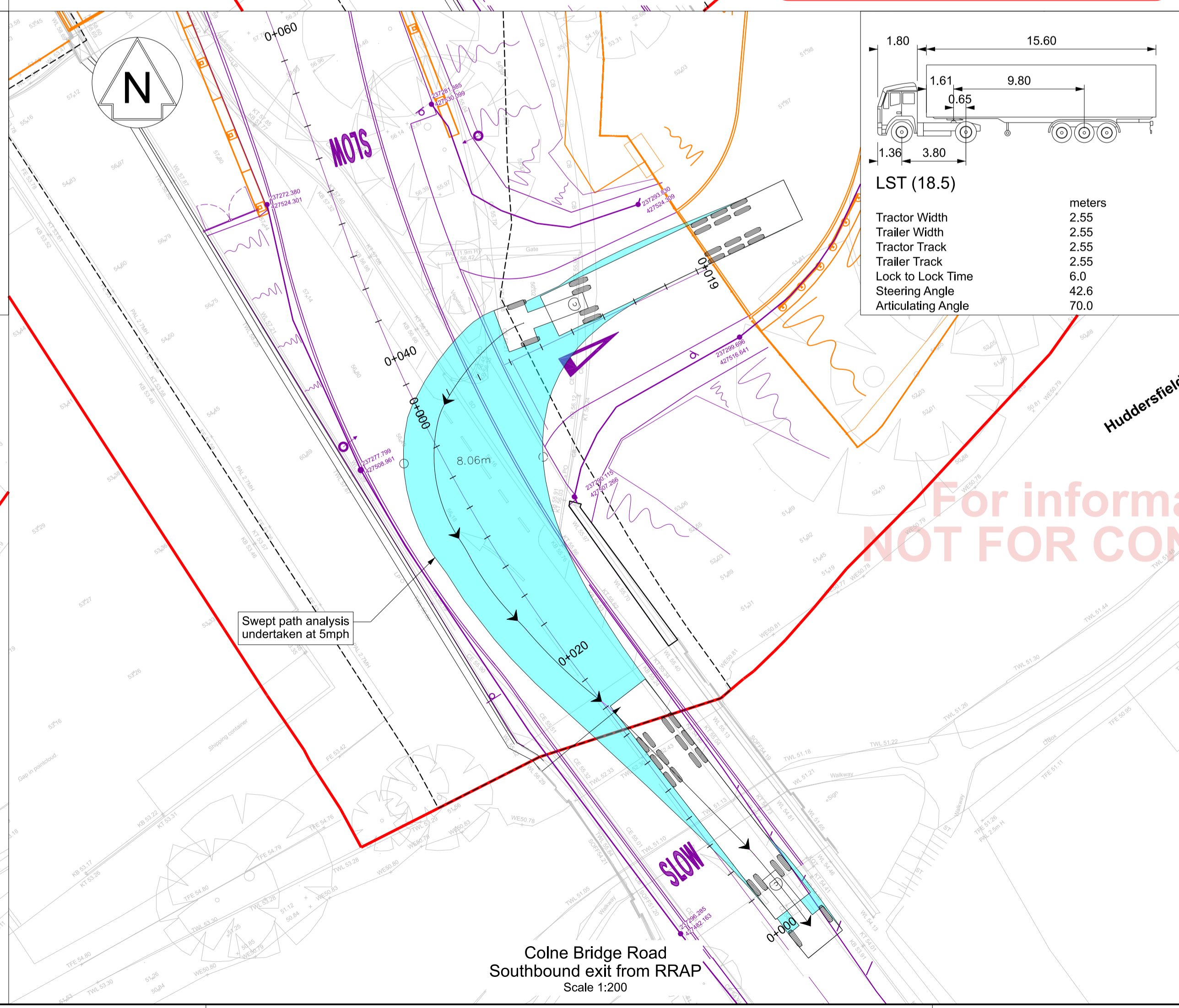
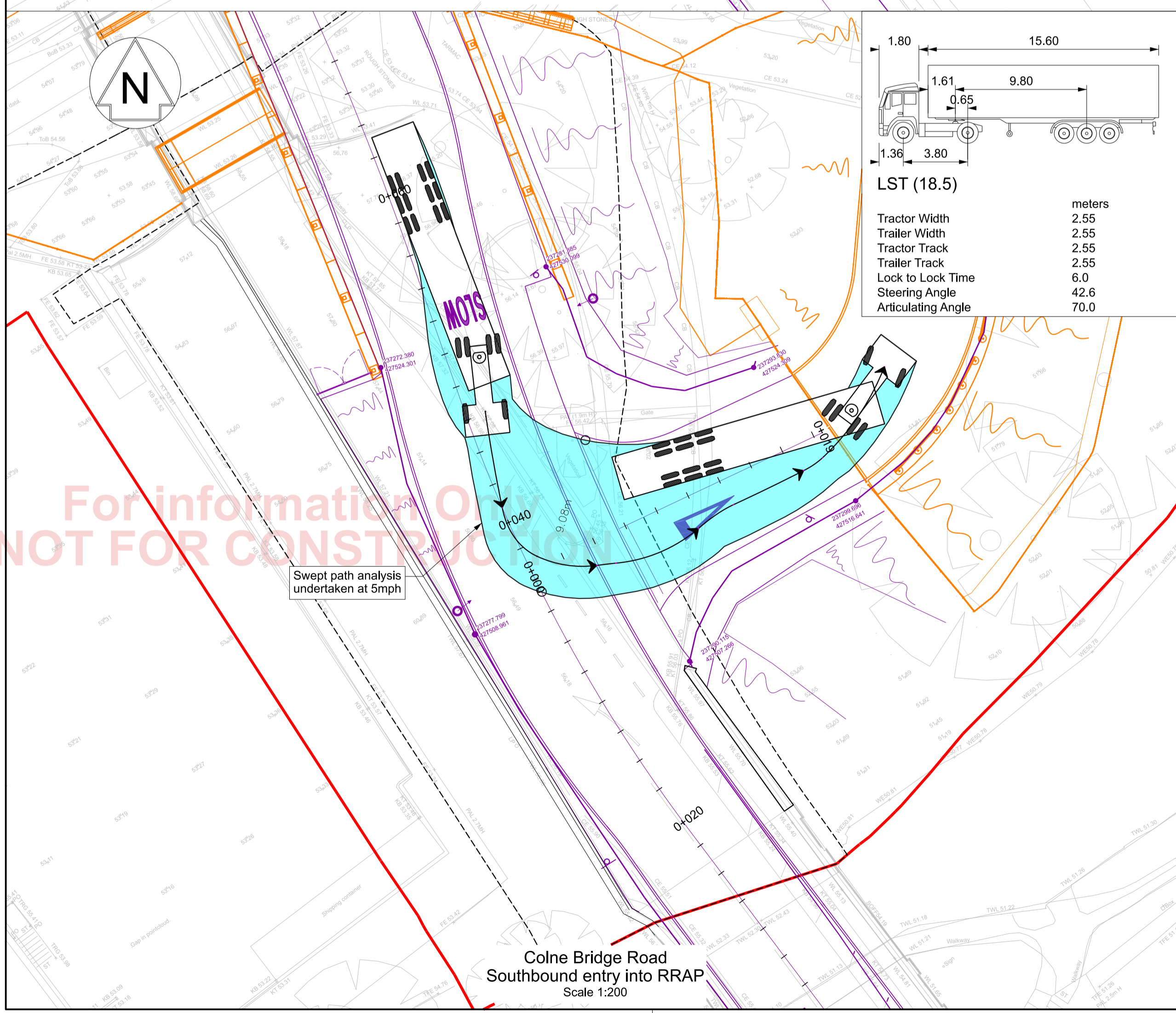
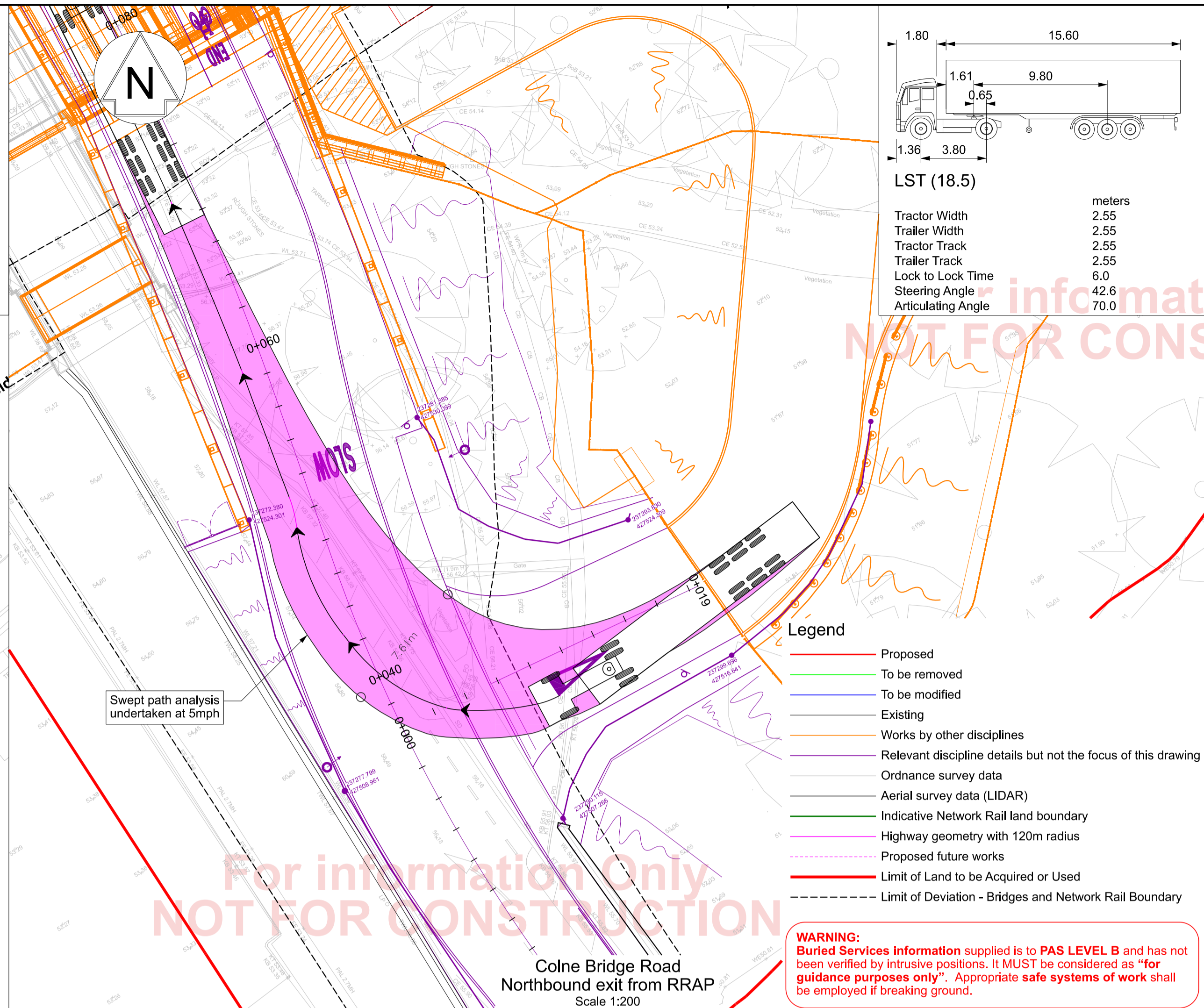
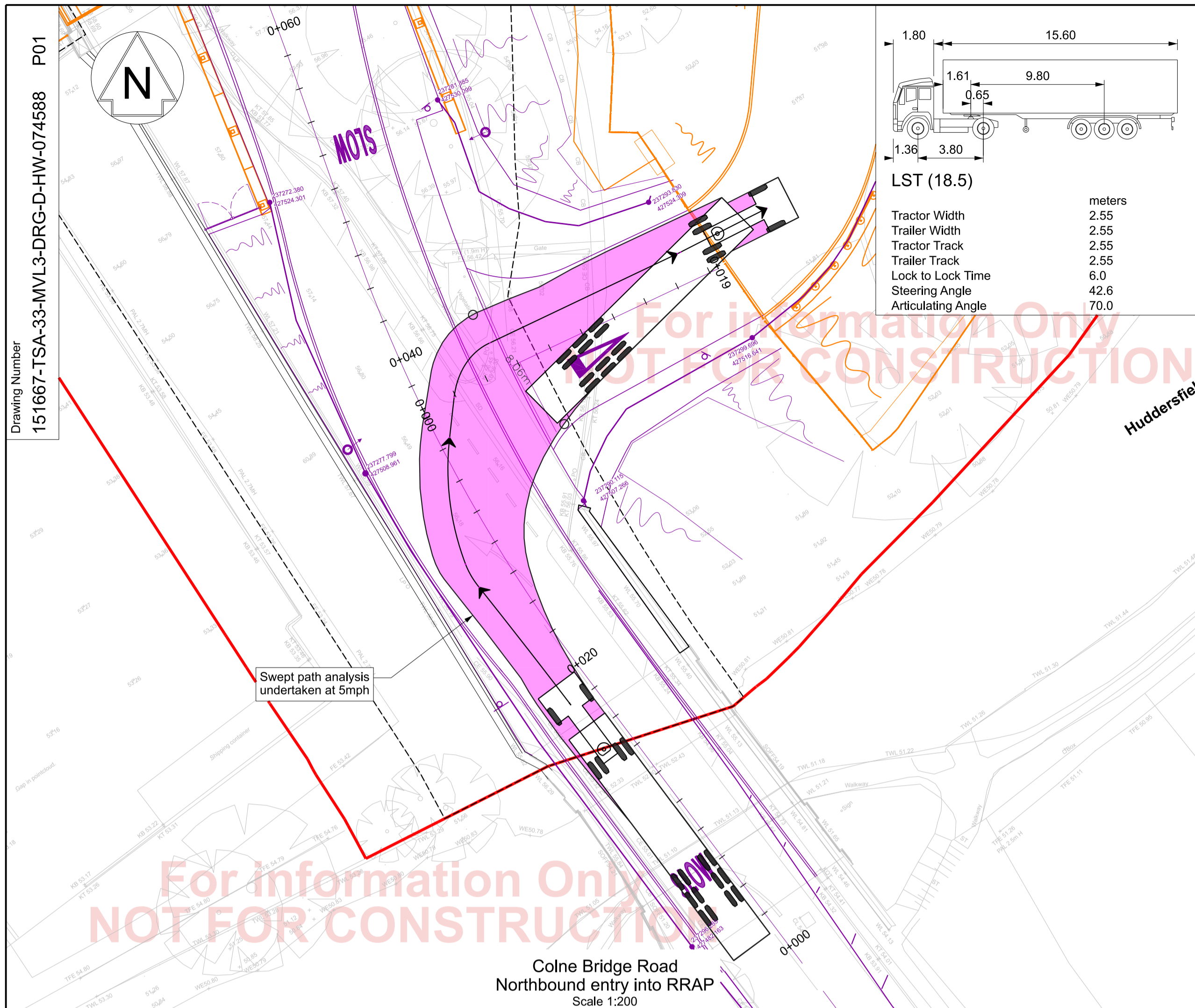

- Notes**
- All dimensions are in metres unless stated otherwise.
  - Do not scale from this drawing.
  - Refer to CDM Hazard log extract: 151667-TSA-33-MVL3-REG-WF-000002.
  - This drawing shall be read in conjunction with drawing list: 151667-TSA-33-MVL3-DRG-D-HW-074516.
  - This drawing shall be read in conjunction with the Specification for Highway Works (MCHW) and associated appendices where applicable: 151667-TSA-33-MVL3-SPE-WH-075003.
  - Works by other disciplines are shown indicatively, therefore this drawing shall be read in conjunction with all applicable drawings and specifications for this scheme.
  - For completion, swept paths have been shown for vehicular movements in both directions into and out of the RRAP access, however in practise the only movements that will be required are left-in and right-out as this is the route from / to the strategic road network.

**Legend**

- Proposed
- To be removed
- To be modified
- Existing
- Works by other disciplines
- Relevant discipline details but not the focus of this drawing
- Ordnance survey data
- Aerial survey data (LIDAR)
- Indicative Network Rail land boundary
- Highway geometry with 120m radius
- Proposed future works
- Limit of Land to be Acquired or Used
- Limit of Deviation - Bridges and Network Rail Boundary

**Swept Path Analysis Legend**

- Northbound
- Southbound

**WARNING:**  
Buried Services information supplied is to PAS LEVEL B and has not been verified by intrusive positions. It MUST be considered as "for guidance purposes only". Appropriate safe systems of work shall be employed if breaking ground.

0 4 8 12 16 20m  
SCALE 1:200

Safety, Health and Environmental Information  
For Health and Safety information, refer to 151667-TSA-33-MVL3-REG-WF-000001.

P01	17/03/26	Issue to Kirklees	SB	RP	CW
Rev	Date	Description of Revisions	Drawn	Chkd	Appr
Status					Suitability
					S2

**Fit for Information**

Authorised	Signed	Date
Contractor(s) <b>TRU West Alliance</b>		
Location	STALYBRIDGE STN - HEATON LODGE JN (HUDD-MANC LINE)	
Type	CAD Drawing	
Role	Drainage and Highways Engineer	
Zone	Colne Bridge and Battyford	
Phasing	Proposed	
Project	Transpennine Route Upgrade	
Contract No.	151667	
Contract Title	TRU - West of Leeds	
Drawing Title	Colne Bridge Road RRAP Access Swept Path Analysis Sheet 2 of 2	
Designed	M. Taylor	Signed
Drawn	S. Battersby	Signed
Checked	R. Peatfield	Signed
Approved	C. Williams1	Signed
Scale(s)	1:200	ELR & Mileage
Alternative Reference	7.163	to
Drawing Number	151667-TSA-33-MVL3-DRG-D-HW-074588	Sheet
		2 of 2
		Revision
		P01

For information Only NOT FOR CONSTRUCTION

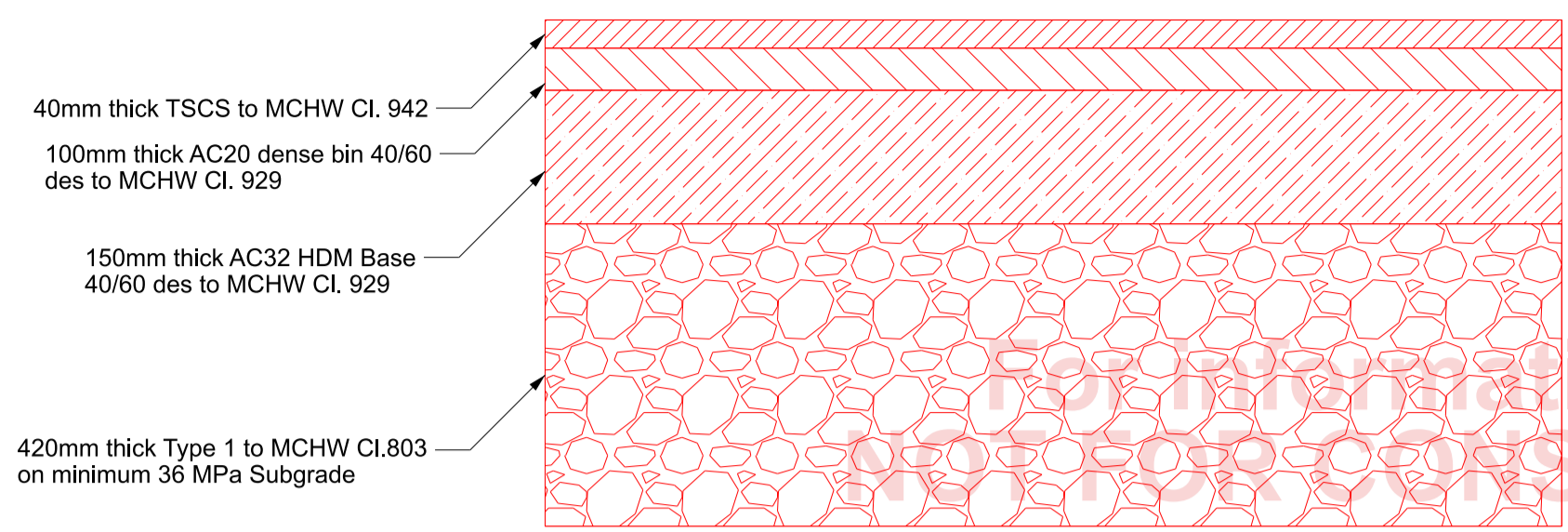

RRAP Access - Carriageway (NC1)

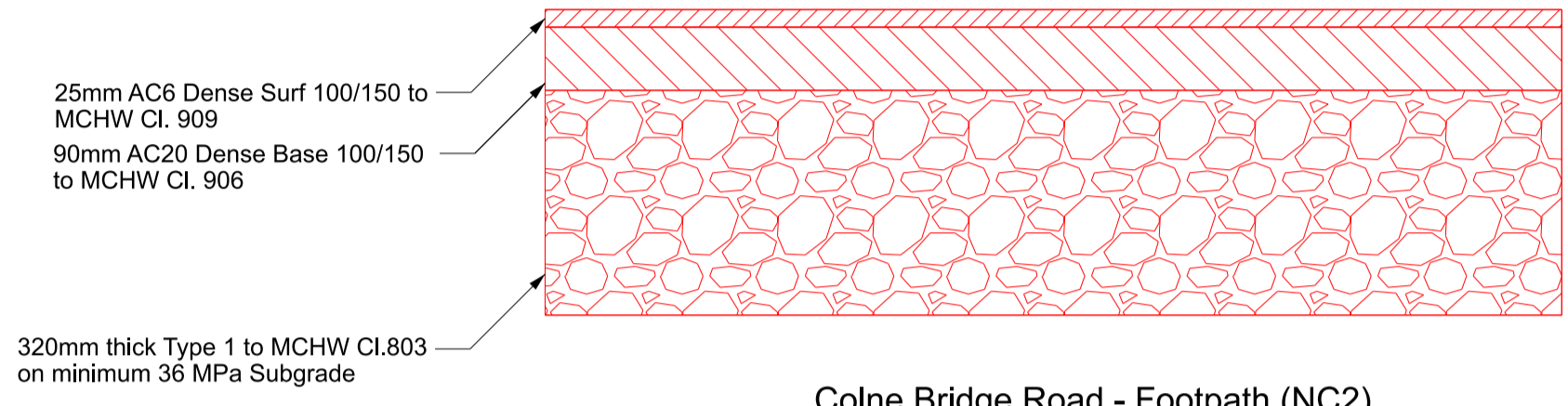

Colne Bridge Road - Footpath (NC2)

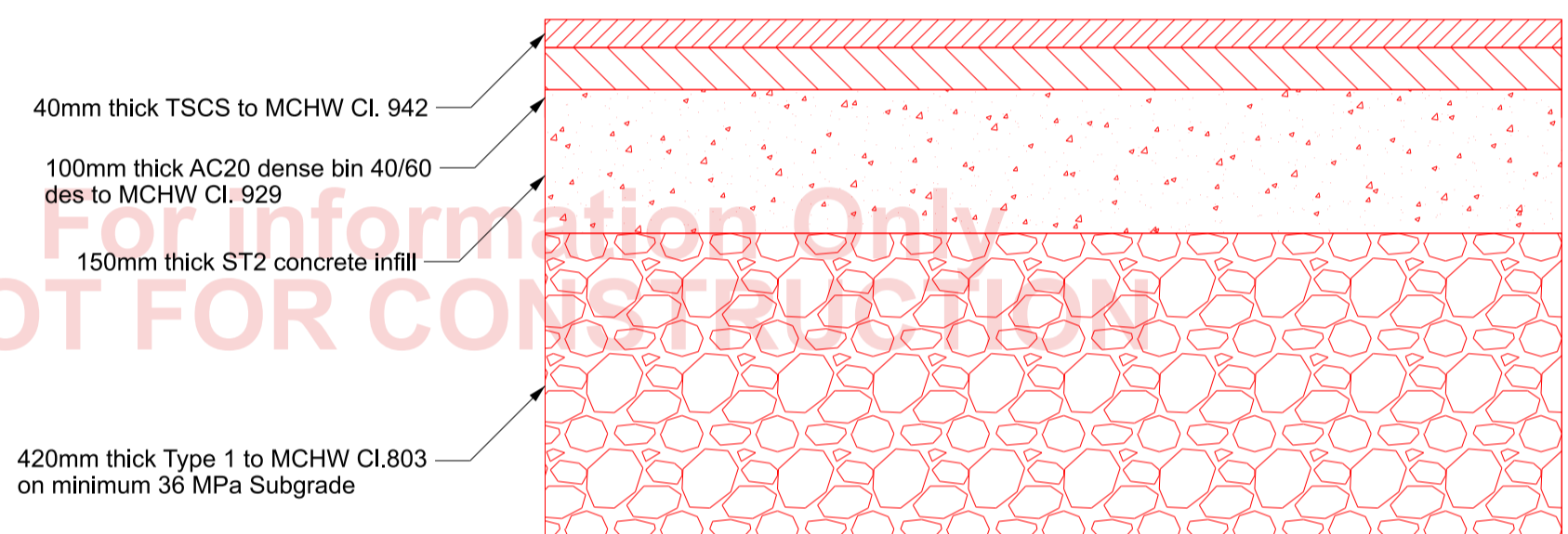

RRAP Access - Continuous Footpath (NC4)

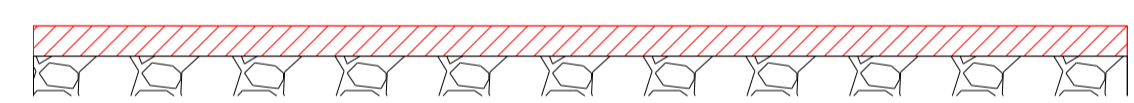

Narrow Widening Detail

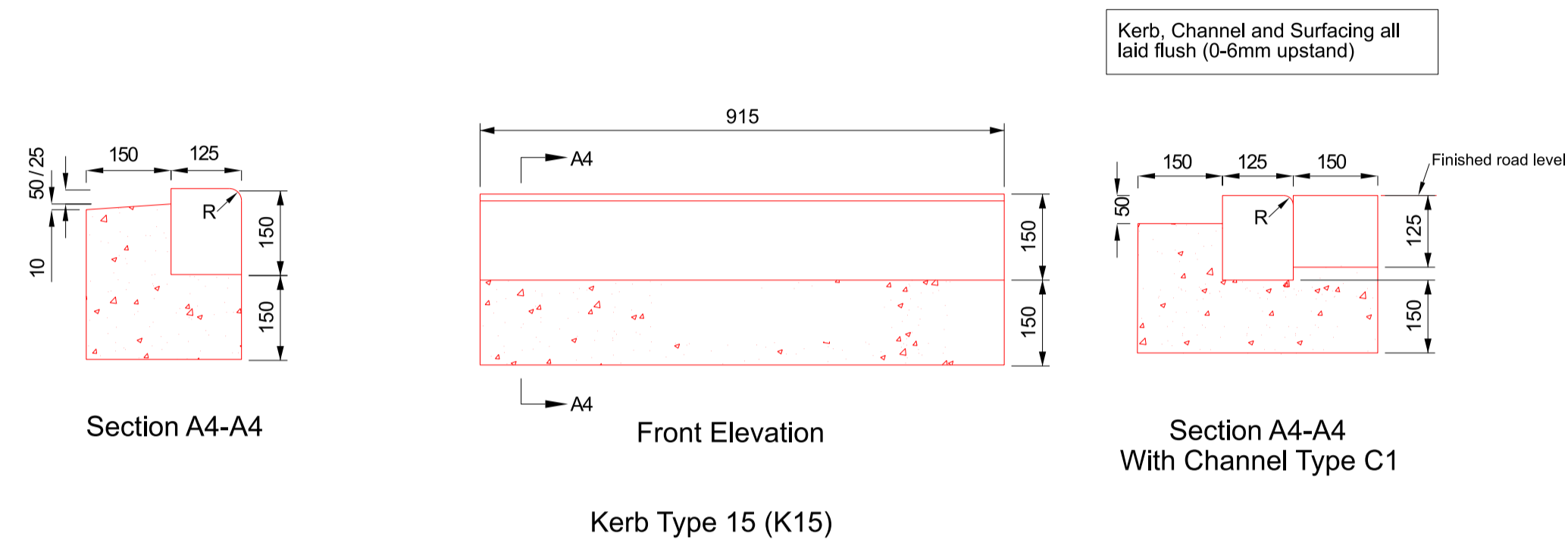
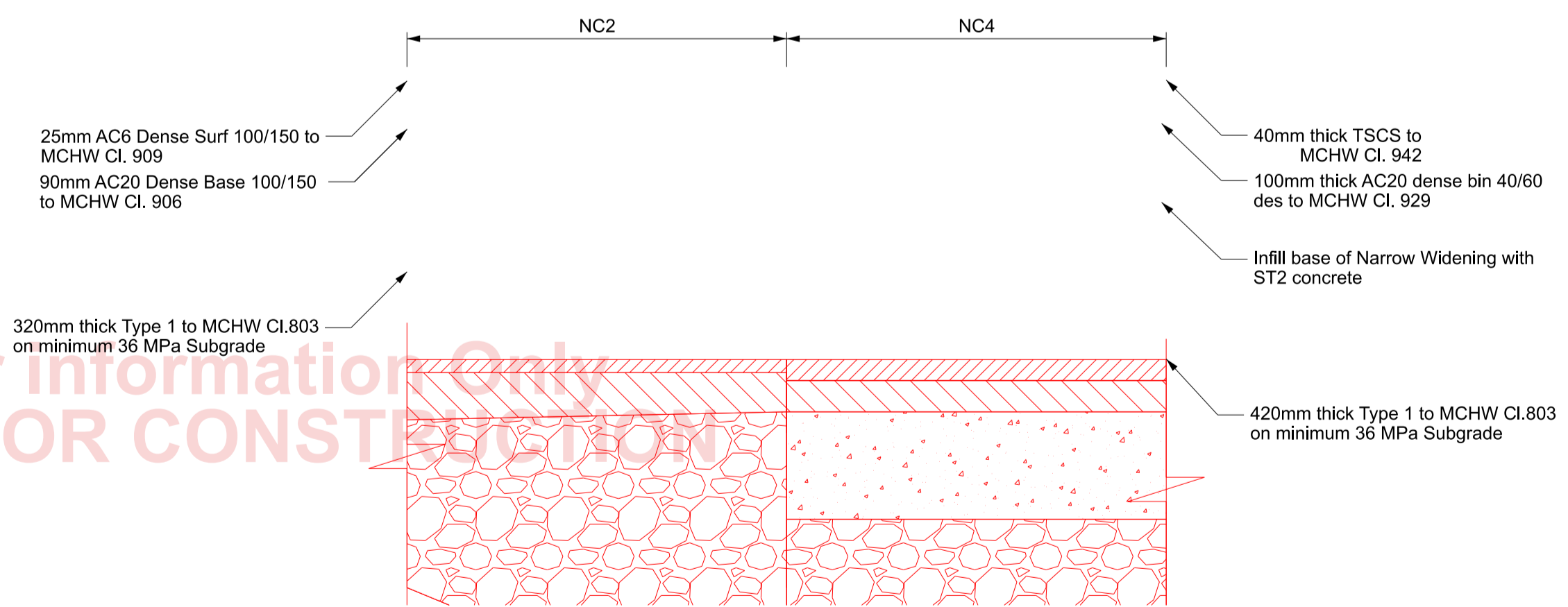

For information Only  
NOT FOR CONSTRUCTION

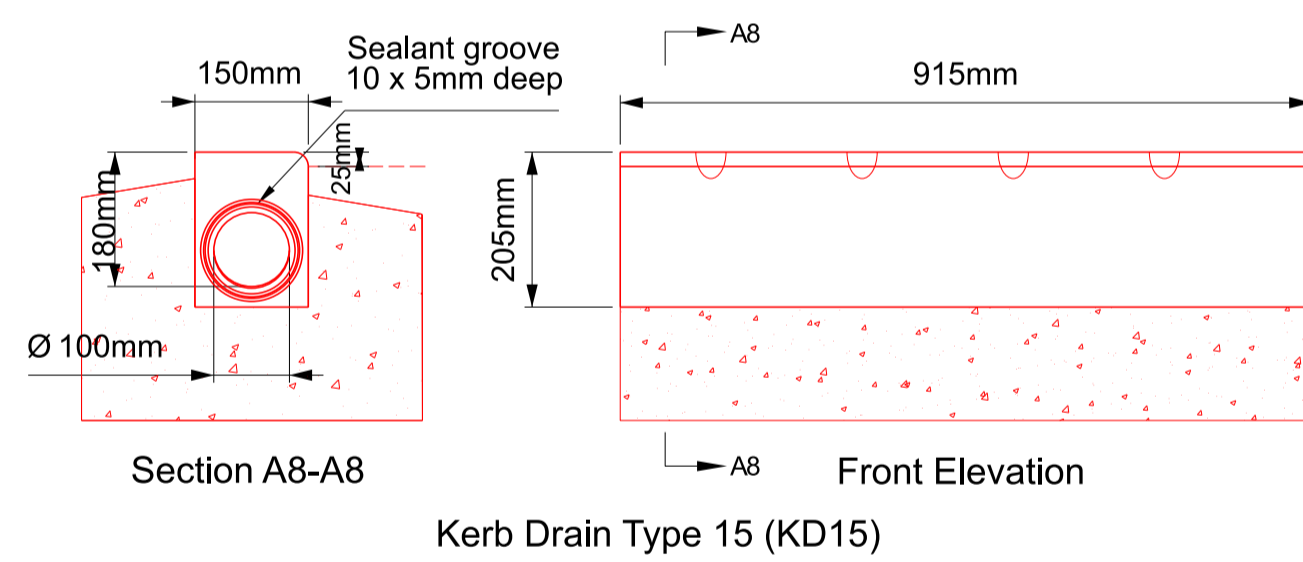

- Notes**
- All dimensions are in metres unless stated otherwise.
  - Do not scale from this drawing.
  - Refer to CDM Hazard log extract: 151667-TSA-33-MVL3-REG-W-MF-000002.
  - This drawing shall be read in conjunction with drawing list: 151667-TSA-33-MVL3-DRG-D-HW-074516.
  - This drawing shall be read in conjunction with the Specification for Highway Works (MCHW) and associated appendices where applicable: 151667-TSA-33-MVL3-SPE-W-HW-075003.
  - Works by other disciplines are shown indicatively, therefore this drawing shall be read in conjunction with all applicable drawings and specifications for this scheme.
  - Buried services information shown is of a varying degree of accuracy. Where available the Quality Level in accordance with PAS 128 (Underground Utility Detection, Verification and Location - Specification) is indicated. Where it is not indicated it should be assumed that the data id Quality Level D (from records).
  - Position and types of utility services are approximate only. Utility services may exist that are not shown on the plan, and those that are shown may not be in the locations indicated. The contractor shall implement measures to confirm the presence of buried services where ground disturbance is required in accordance with HSG47 and NR/L2/INI/1030. This may include, but not limited to, Electromagnetic Location (EML, eg. CAT scanning), Ground Penetrating Radar (GPR) and /or trail holes as appropriate. Any buried services identified are to be marked up, diverted or protected as appropriate in accordance with NR/L2/INI/1030.

For information Only  
NOT FOR CONSTRUCTION

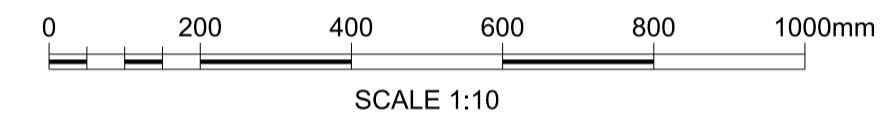

Safety, Health and Environmental Information  
For Health and Safety information, refer to 151667-TSA-33-MVL3-REG-W-MF-000001.

P01	17/03/26	Issue to Kirklees	SB	RP	CW
Rev	Date	Description of Revisions	Drawn	Chkd	Appr
Status					Suitability
					<b>S2</b>



Authorised	Signed	Date
Contractor(s) <b>TRU West Alliance</b>		
Location STALYBRIDGE STN - HEATON LODGE JN (HUDD-MANC LINE)		
Type	Sub-type	
CAD Drawing		
Role	Sub-Role	
Drainage and Highways Engineer	Highways	
Zone	Colne Bridge and Battyford	
Phasing	Project Stage	
Proposed	GRIP 5	
Project <b>Transpennine Route Upgrade</b>		
Contract No. <b>151667</b>		
Contract Title <b>TRU - West of Leeds</b>		
Drawing Title <b>Colne Bridge Road RRAP Access Pavement and Kerb Details Sheet 1 of 1</b>		

Designed	M.Taylor	Signed		Date	17/03/26
Drawn	S.Battersby	Signed	Electronically Signed	Date	17/03/26
Checked	R.Peatfield	Signed	Electronically Signed	Date	17/03/26
Approved	C.Williams1	Signed	Electronically Signed	Date	17/03/26
Scale(s)	1:10		ELR & Mileage	7.163	to 29.0957
Alternative Reference			Sheet	1	of 1
Drawing Number	151667-TSA-33-MVL3-DRG-D-HW-074599		Revision	P01	

NOT FOR CONSTRUCTION

For information Only

Network Rail  
Waterloo General Office  
London  
SE1 8SW

[www.networkrail.co.uk](http://www.networkrail.co.uk)