

**Notes**

Do not scale from drawing, use figured dimensions only.  
 All dimensions must be checked and verified on site prior to commencement of work and Architect to be notified of any discrepancies.  
 This drawing is intended to permit overall scheme proposals only and cannot be used for construction purposes without further information.

Rev	Description	Drawn	Date
•	Drawing created.	KA	11.02.26
A	Red line boundary amended following client comment.	KA	20.03.26

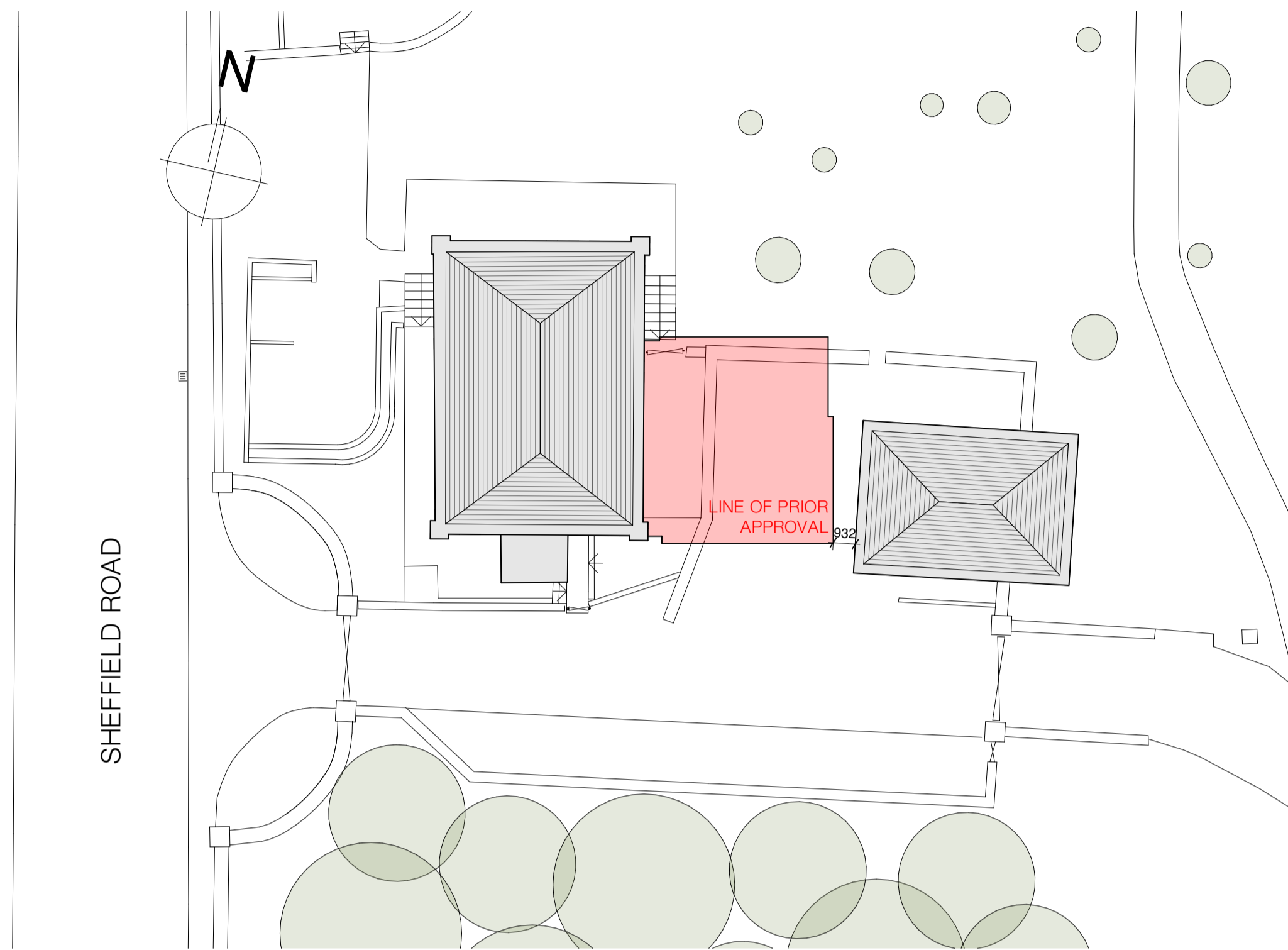

Existing Roof Plan - 1:200

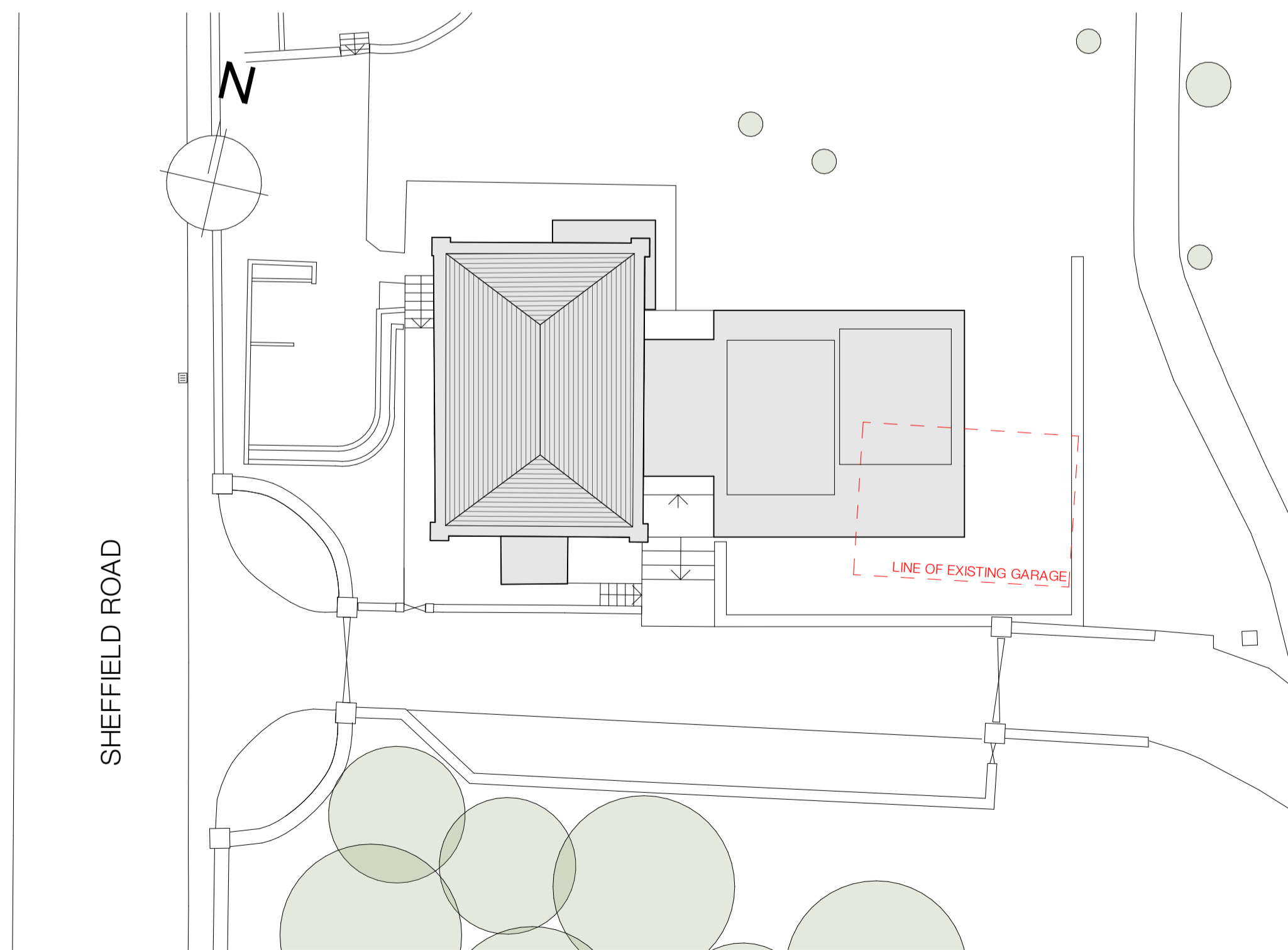

Proposed Roof Plan - 1:200

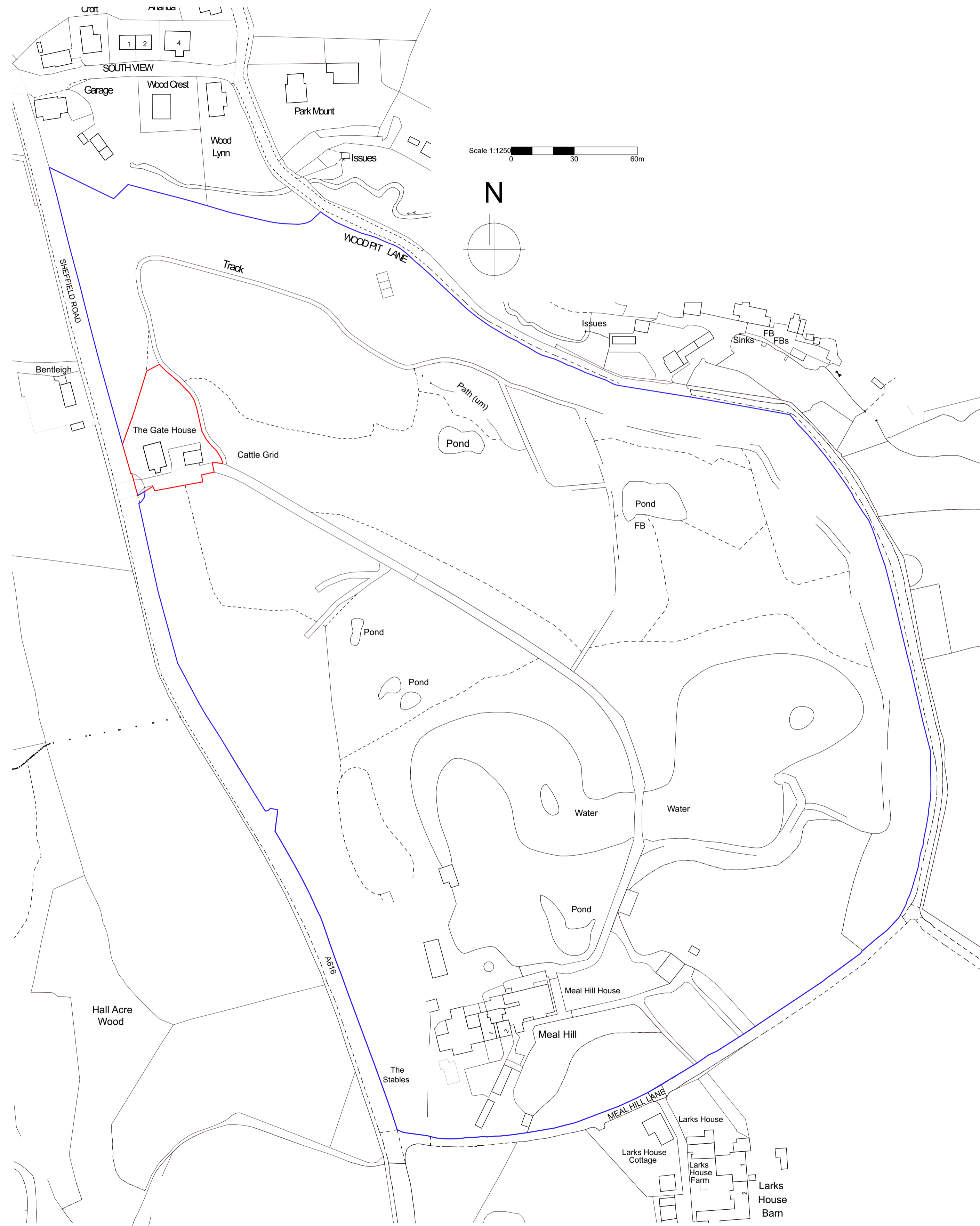

Location Plan - 1:1250

Scale 1:100  
 0 3000 6000mm

**Client**  
 Helen Verity and Chris Watkins

**Site Address**  
 The Gate House, Sheffield Road, Jackson Bridge, HD9 7HS

**Project Description**  
 Extension and Internal Alterations  
**Status**  
 Planning

**Date** February 2026 **Drawn** KA **Checked** MAL

**Drawing** Roof Plan **Scale @ A1** 1:200, 1:1250

**Drawing No.** 3676 (0-) 03 **Revision** A

**ONE17**  
 DESIGN  
 THE DYEHOUSE, ARMITAGE BRIDGE  
 HUDDERSFIELD, WEST YORKS HD4 7PD  
 T 01484 448000 E SOLUTIONS@ONE17DESIGN.COM  
 ONE17DESIGN.COM