

**Key of interventions**

- Areas of proposed works subject to findings of ongoing monitoring
- Areas of proposed works required

**Notes**

1. This drawing is subject to copyright and must not be reproduced, stored or transmitted in any form without prior permission from Mason Clark Associates.
2. This drawing is not to be scaled. All dimensions are to be checked on site by the contractor. Any discrepancies are to be notified to Mason Clark Associates. Obtain instructions prior to works commencing.
3. This drawing is to be read in conjunction with all the relevant contract drawings and specifications.
4. All dimensions are in millimetres and all levels are in metres AOD unless noted otherwise.
5. All work shall be carried out in accordance with Local Authority, Statutory Authority and Health & Safety Regulations.
6. Mason Clark Associates are not responsible for determining the appropriate fire period, fire boundary conditions or the associated design of fire protection or inherent fire resistance to any elements of structure, including all frames, posts, beams, joists, roof members and secondary structural elements such as lintels. Refer to the Architect or Project Manager for this information.

Refer to sketch SK006 for details of the proposed approaches to remedial works.

Allow for the installation of Cintec anchors (M16 stainless steel rods), 1.2m long, at 1.0m centres, along the full height of the chimney breast. Access from the exterior where feasible. Design to be confirmed.

Repointing of cracks and grout holes with lime-based mortar following completion of previous works.

Investigations and remedial works as described in sketch SK-006.

Allow for the installation of Cintec anchors (M16 stainless steel rods), 1.2m long, at 1.0m centres, along the full height of the chimney breast. Access from the exterior where feasible. Design to be confirmed.

Repointing of cracks and grout holes with lime-based mortar following completion of previous works.

Circular patches and archive information suggest past installation of anchors (unclear if resin or grout)

Allow for the installation of Cintec anchors (M16 stainless steel rods), 1.2m long, at 1.0m centres, along the full height of the chimney breast. Access from the exterior where feasible. Design to be confirmed.

Repointing of cracks and grout holes with lime-based mortar following completion of previous works.

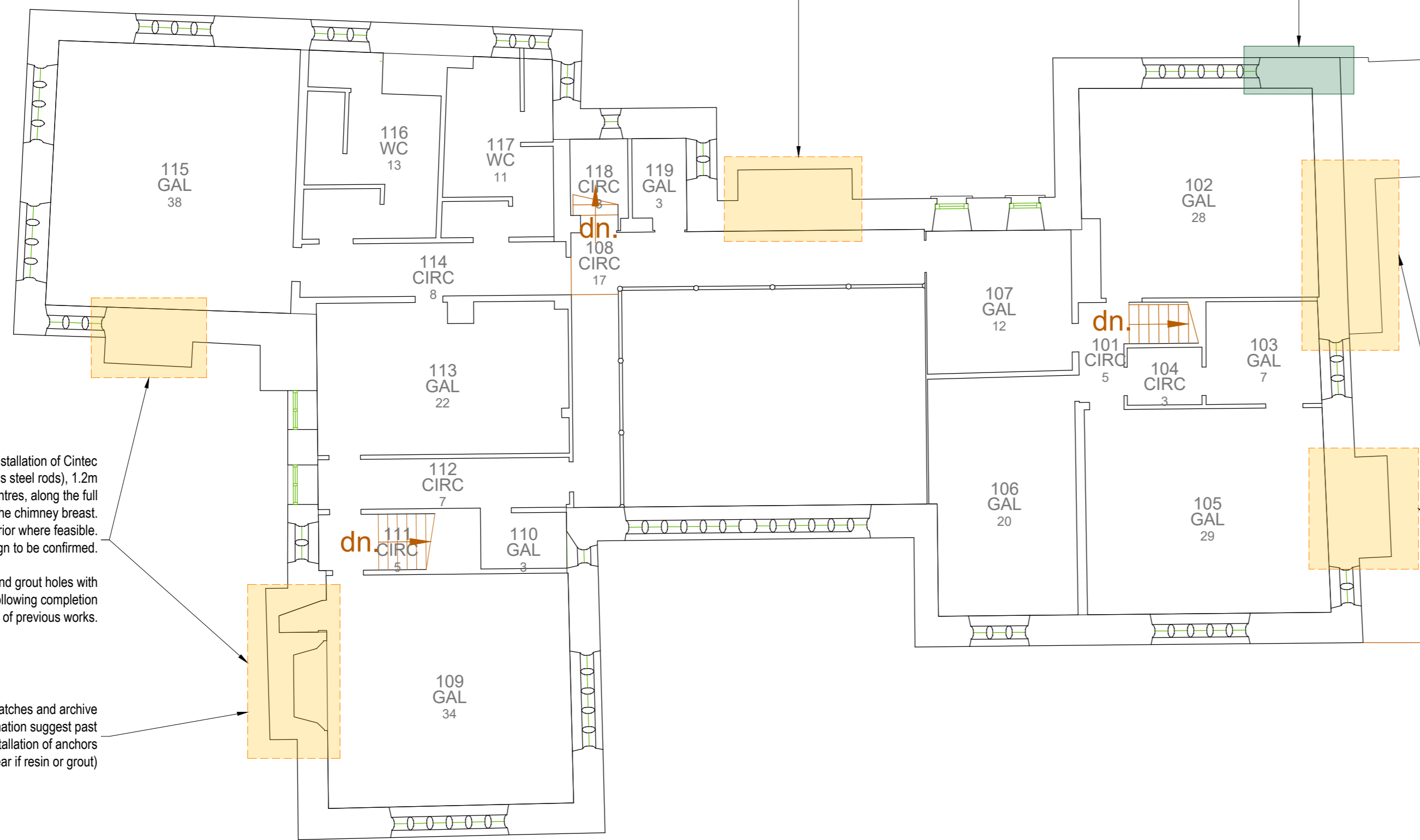

01 First floor plan  
Scale: 1:100

P2	Preliminary issue - For LBC	SM	21.01.2026
P1	Preliminary issue - For comment	SM	05.01.2026
Rev	Details	By	Date
 <div style="float: right; font-size: 8px;">                 Hull +44 (0) 1482 345797                  Leeds +44 (0) 113 277 9542                  York +44 (0) 1904 438005  <a href="http://www.masonclark.co.uk">www.masonclark.co.uk</a> </div> <p><b>masonclarkassociates</b> civil and structural engineering consultants</p>			
Client: Kirklees Council			
Project: Oakwell Hall			
Title: Proposed structural interventions First floor			
Drawn: SM	Checked: RMP	Date: 23.12.2025	
Scale @ A2: As noted			
Drawing No: 22333-Y-SK-007			Rev: P2