

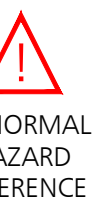

DO NOT SCALE

DESIGNERS HAZARD IDENTIFICATION
IT IS ASSUMED THAT ALL WORKS WILL BE UNDERTAKEN BY A COMPETENT CONTRACTOR WORKING WHERE APPROPRIATE TO AN APPROVED METHOD STATEMENT IN ACCORDANCE WITH THE HAZARDS TYPICALLY ASSOCIATED WITH THE TYPE OF CONSTRUCTION DETAILED ON THIS DRAWING. ANY KNOWN ABNORMAL HAZARDS SPECIFIC TO THIS SCHEME HAVE BEEN IDENTIFIED.



NOTES

- DO NOT SCALE FROM THIS DRAWING.
- THIS DRAWING IS TO BE REPRODUCED IN COLOUR.
- IF ANY DISCREPANCIES ARE FOUND IN THIS DRAWING, PLEASE REPORT TO DUDLEYS CONSULTING ENGINEERS.
- THIS DRAWING HAS BEEN ORIENTATED TO OS BRITISH NATIONAL GRID (EPSG:27700 OSGB80). EXISTING SURVEY STATIONS ARE SHOWN ON THE TOPOGRAPHICAL SURVEY.
- THIS DRAWING IS BASED ON THE FOLLOWING INFORMATION:
 - EXISTING BUILDING SURVEYS BY LAND SURVEY CONSULTANTS DATED DECEMBER 2004
 - EXISTING BUILDING SURVEYS BY CT SURVEYS DATED DECEMBER 2020
 - RIVER SURVEYS BY ZS SURVEYS DATED AUGUST 2024
 - DRAINAGE SURVEYS BY ZS SURVEYS DATED APRIL 2025
 - 2024 PROPOSED MASTERPLAN DRAFT BY KPP ARCHITECTS
- THIS DRAWING IS TO BE READ IN CONJUNCTION WITH RELEVANT ARCHITECTS AND ENGINEERS DRAWINGS AND THE FOLLOWING SPECIFICATIONS:
 - ENSPREC 06 - ROAD, PAVING AND CAR PARKING AREAS
 - ENSPREC 17 - DRAINAGE WORK
 - ENSPREC 24 - SPECIFICATION FOR HIGHWAY DRAINAGE
- ALL WORK TO BE UNDERTAKEN IN ACCORDANCE WITH THE CURRENT EDITION OF THE BUILDING REGULATIONS, SEWERAGE SECTOR CODES OF PRACTICE, AND THE RELEVANT LOCAL HIGHWAY AUTHORITY STANDARDS.
- THE POSITIONS OF EXISTING UTILITIES SHOWN ON THIS DRAWING HAVE BEEN BASED ON INFORMATION EXTRACTED FROM RECORDS OBTAINED FROM UTILITY PROVIDERS. THESE MUST BE REGARDED AS APPROXIMATE ONLY. THE ACCURACY OR COMPLETENESS OF THE INFORMATION OR THE LOCATION OF SUCH APPARATUS IS NOT GUARANTEED AND NO WARRANTY IS GIVEN OR IMPLIED REGARDING THE POSITION, DEPTH, SIZE OR GRADIENT THEREOF. THE CONTRACTOR MUST MAKE THEIR OWN ENQUIRIES OF THE UTILITY PROVIDERS AND PUBLIC AUTHORITIES AND SATISFY THEMSELVES AS TO THE EXACT POSITION, DEPTH, SIZE AND GRADIENT OF SERVICES. IN THE INTEREST OF SAFETY, THE APPROXIMATE POSITION OF UNDERGROUND CABLES SHOULD BE OBTAINED BY USE OF ELECTRONIC CABLE LOCATORS AND THIS POSITION CONFIRMED BY CAREFUL TRIAL-HOLING USING HAND-DUG METHODS.
- BEFORE UNDERTAKING ANY DRAINAGE WORKS, THE CONTRACTOR IS RESPONSIBLE FOR CONFIRMING THE LOCATION AND DEPTH OF THE FINAL CONNECTION POINTS. ANY DISCREPANCIES MUST BE NOTIFIED TO DUDLEYS CONSULTING ENGINEERS IMMEDIATELY TO ALLOW SUFFICIENT TIME FOR ANY NECESSARY DESIGN CHANGES. COMMENCING NEW DRAINAGE WORKS WITHOUT FIRST ESTABLISHING THE CONNECTION IS ENTIRELY AT THE CONTRACTORS OWN RISK AND MAY RESULT IN ABORTIVE WORK IF THE POSITION OR DEPTH OF THE CONNECTION POINTS DIFFERS TO WHAT IS DETAILED ON THIS DRAWING.

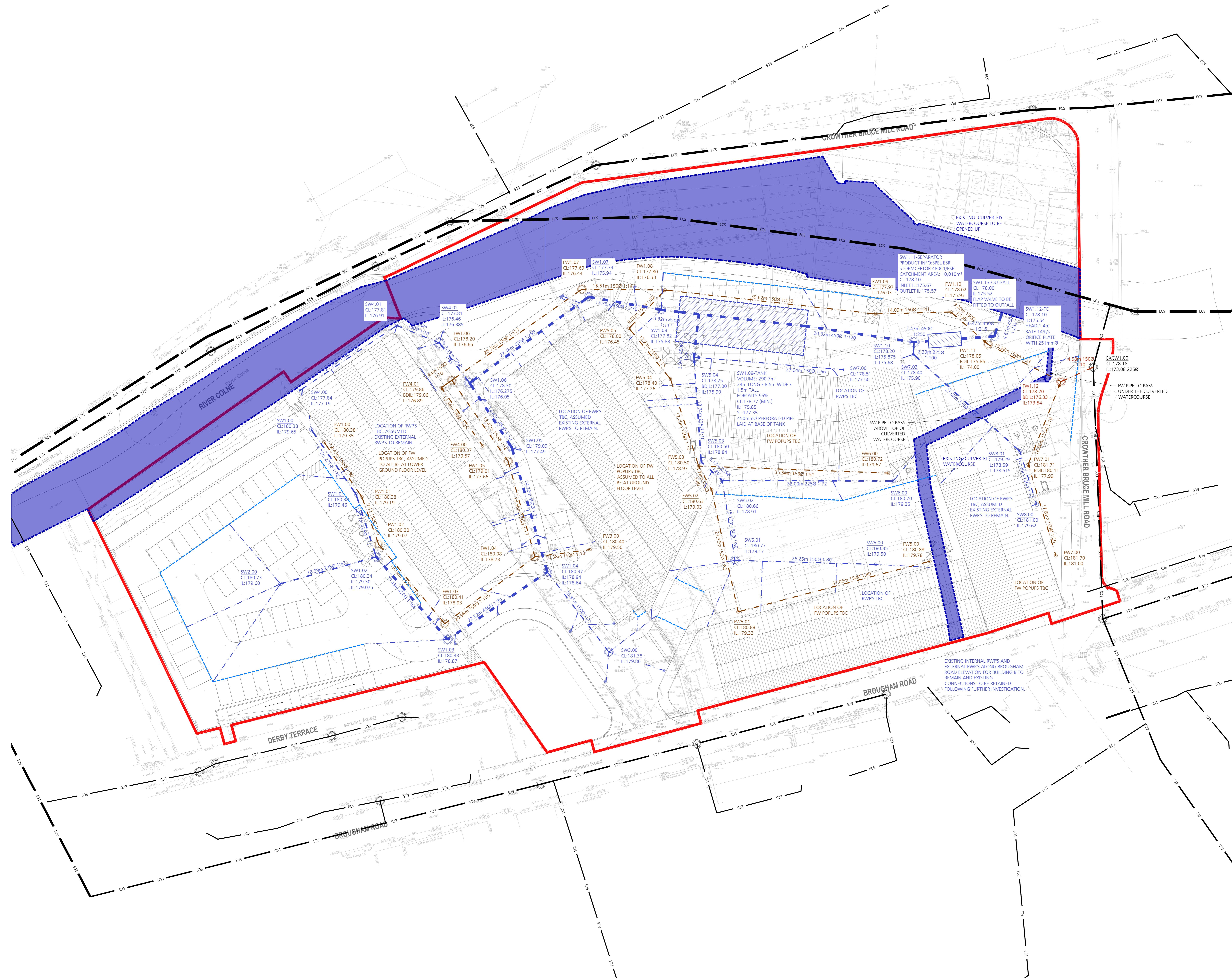

KEY

- SITE BOUNDARY
- - - PROPOSED PRIVATE SURFACE WATER DRAIN
- - - PROPOSED PRIVATE FOULED WATER DRAIN
- PROPOSED PRIVATE SURFACE WATER MANHOLE
- PROPOSED PRIVATE SURFACE WATER PPIC
- PROPOSED PRIVATE FOULED WATER MANHOLE
- PROPOSED PRIVATE FOULED WATER PPIC
- ▼ PROPOSED PRIVATE SURFACE WATER RODDING EYE
- PROPOSED PRIVATE SURFACE WATER YARD GULLY
- ▨ PROPOSED PRIVATE SURFACE WATER ATTENUATION TANK
- - - PROPOSED PRIVATE SURFACE WATER CHANNEL DRAIN
- ▨ PROPOSED PRIVATE BYPASS SEPARATOR
- PROPOSED ADOPTED S106 FOULED WATER LATERAL
- PROPOSED ADOPTED S106 FOULED WATER MANHOLE
- EXISTING ADOPTED COMBINED SEWER
- EXISTING ADOPTED COMBINED MANHOLE
- - - EXISTING WATERCOURSE

03.13.25	UPDATED LAYOUT AND DESIGN	JA	RD	PO3
10.07.25	UPDATED LAYOUT AND DESIGN	JA	RD	PO2
16.09.24	PRELIMINARY ISSUE	JA	RD	PO1
DATE	REVISION DESCRIPTION	BY	CHK	REV.

DUDLEYS
CONSULTING ENGINEERS

Tel: 0117 258 961
35 Town Street
Leeds, LS1 8 BL
info@dudleys.co.uk

PROJECT
**NEW MILLS
MARSDEN**

TITLE
DRAINAGE STRATEGY

SCALE: **1:250** PAPER: **A0** STATUS: **PRELIMINARY**

DRAWING NO. **23421-DCE-XX-XX-D-C-100** REV. **PO3**