

# APPENDICES A-F

## New Mills, Marsden

Job No: 23112

January 2026



VIA SOLUTIONS



# APPENDIX A

## Existing Site Plans



Notes:  
 This drawing is the sole copyright of KPP Architects Ltd and reproduction in any form is forbidden unless permission is obtained in writing.  
 Do not scale from this drawing. Any discrepancies on site should be brought to the attention of KPP Architects Ltd.  
 Work and materials must comply with the current building regulations and codes of practice and be read in conjunction with building specifications and other sub-contractors information. All materials are to be installed in strict accordance with the recommendations of the manufacturers.

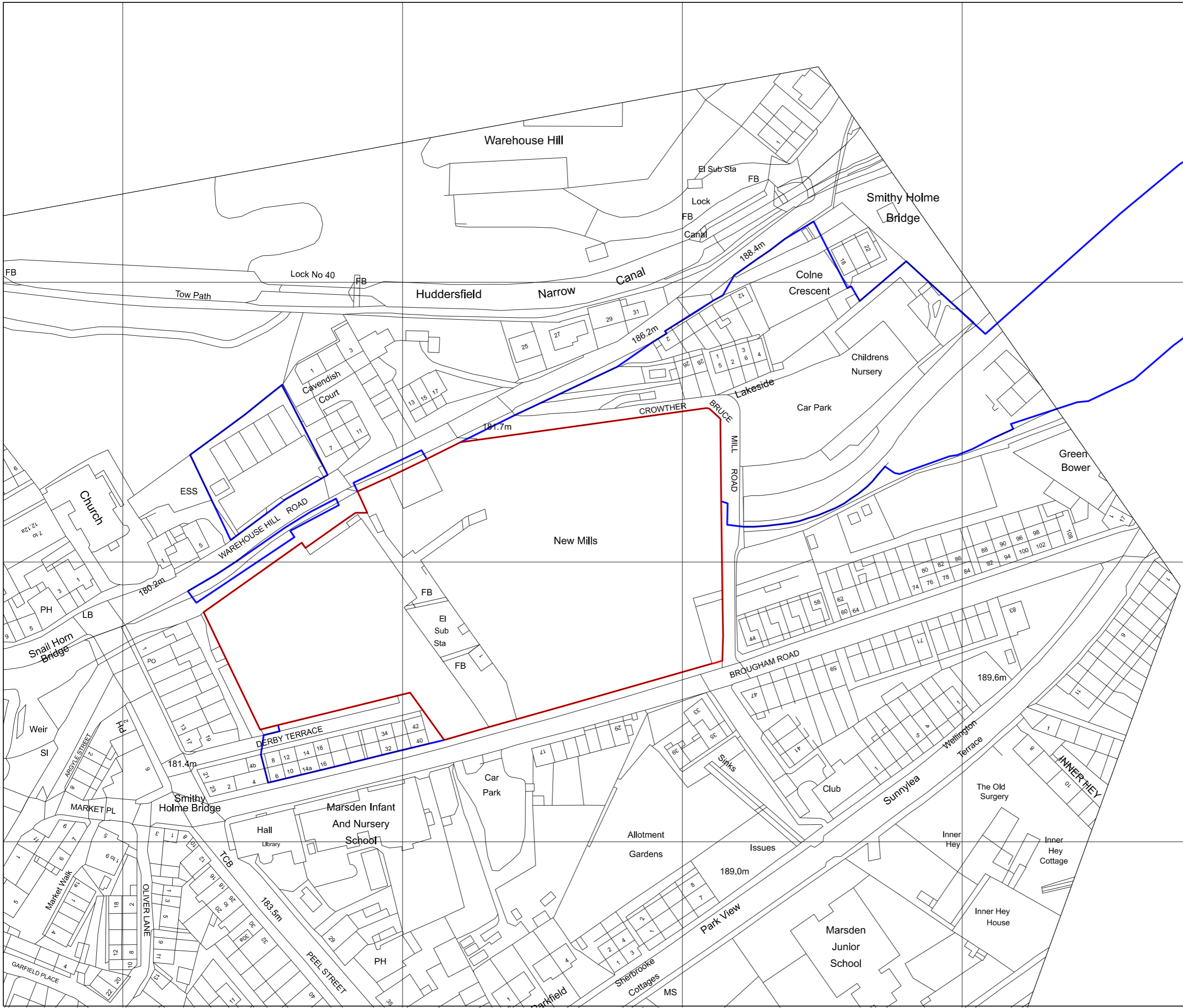

P1	FOR DISCUSSION	SF	.	07.02.25
Rev	Description	By	Chkd	Date

Client  
**JOHN EDWARD CROWTHER Ltd**

Project Title  
**PROPOSED REGENERATION OF NEW MILLS MARSDEN**

Drawing Title  
**SITE LOCATION PLAN**

**KPP ARCHITECTS**  
 Lodge House  
 12 Town Street  
 Horsforth, Leeds LS184RJ  
 T : +44 (0) 113 2390460  
 E : architects@kpp-leeds.co.uk  
 W : www.kpp-leeds.co.uk

Scale	Size	Date	Drawn	Checked
1:1250	A3	Nov'24	KW	RS
Status	<b>PLANNING</b>			
KPP Job No	<b>2197-02</b>			Rev
Number	<b>2000</b>			<b>P1</b>



Notes:  
 This drawing is the sole copyright of KPP Architects Ltd and reproduction in any form is forbidden unless permission is obtained in writing.  
 Do not scale from this drawing. Any discrepancies on site should be brought to the attention of KPP Architects Ltd.  
 Work and materials must comply with the current building regulations and codes of practice and be read in conjunction with building specifications and other sub-contractors information. All materials are to be installed in strict accordance with the recommendations of the manufacturers.

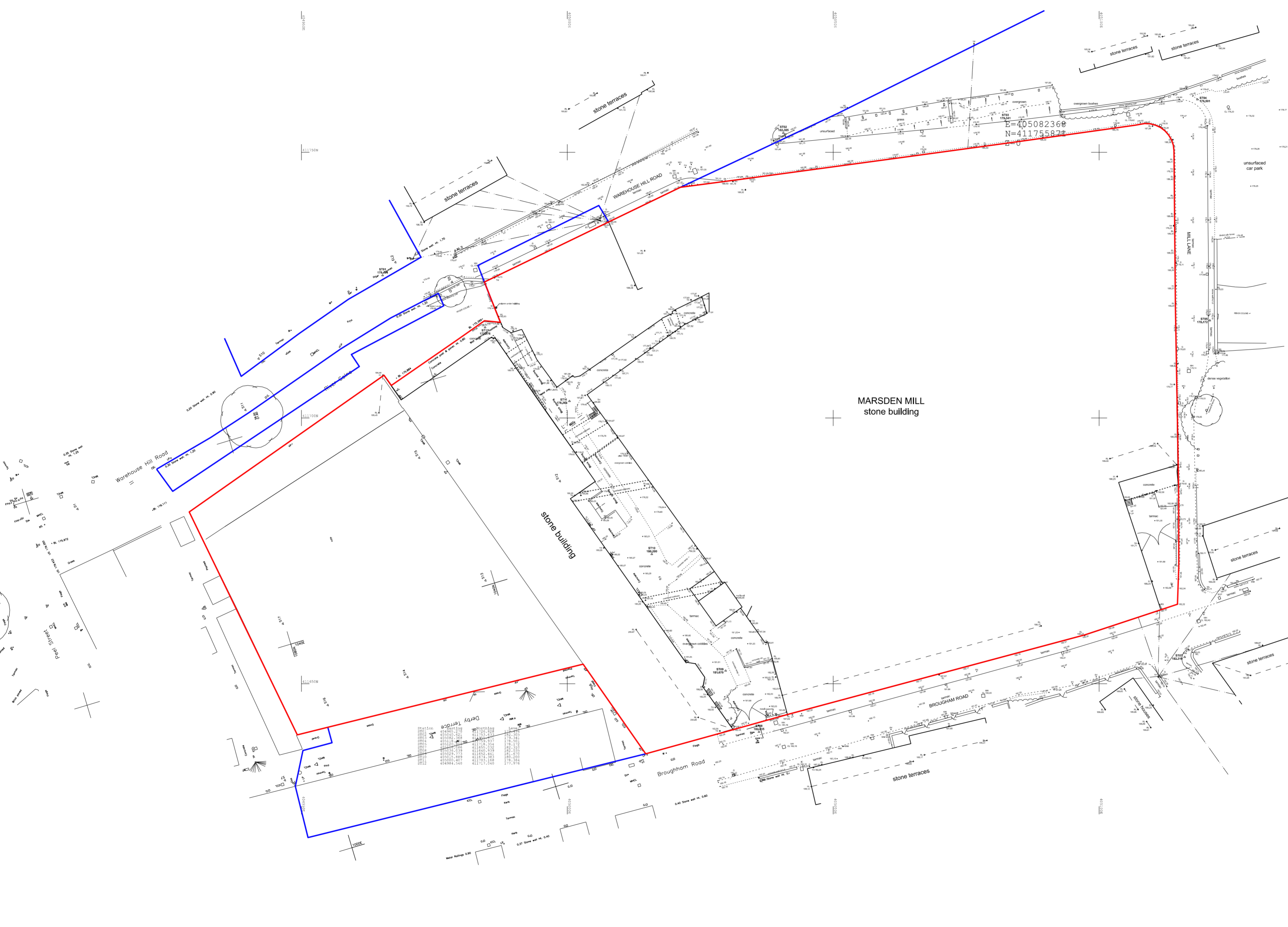

MARSDEN MILL  
stone building

stone building

P1	FOR DISCUSSION	SF	-	07.02.25
Rev	Description	By	Chkd	Date

Client  
**JOHN EDWARD CROWTHER Ltd.**

Project Title  
**PROPOSED REGENERATION  
 NEW MILLS, MARSDEN**

Drawing Title  
**EXISTING SITE PLAN**

**KPP** ARCHITECTS  
 Lodge House  
 12 Town Street  
 Horsforth, Leeds LS184RJ  
 T : +44 (0) 113 2390460  
 E : architects@kpp-leeds.co.uk  
 W : www.kpp-leeds.co.uk

Scale	Size	Date	Drawn	Checked
1:500	A2	Nov'24	MH	RS

Status  
**PLANNING**

KPP Job No	Rev
<b>2197-02</b>	<b>P1</b>
Number	
<b>2000</b>	

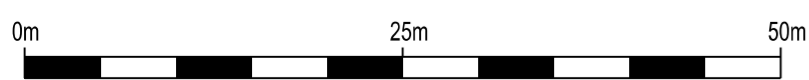

# APPENDIX B

## Collision Data





### Validated Data

**Crash Date:** Saturday, March 7, 2020  
**Highest Injury Severity:** Slight  
**Highway Authority:** Kirklees  
**Local Authority:** Kirklees  
**Weather Description:** Fine without high winds  
**Road Surface Description:** Wet or Damp  
**Speed Limit:** 30  
**Light Conditions:** Darkness: street lights present and lit  
**Carriageway Hazards:** None  
**Junction Detail:** T or staggered junction  
**Junction Pedestrian Crossing:** No physical crossing facility within 50 metres  
**Road Type:** Single carriageway  
**Junction Control:** Give way or uncontrolled

**Time of Crash:** 19:20:00  
**Road Number:** A62

**Crash Reference:** 2020137371613

**Casualties:** 1

**Vehicles:** 1

**OS Grid Reference:** 405287 411722

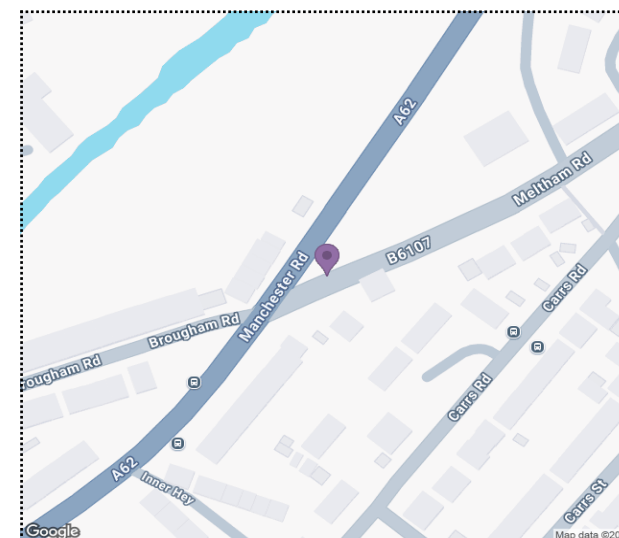

For more information about the data please visit: [www.crashmap.co.uk/home/faq](http://www.crashmap.co.uk/home/faq)

To subscribe to unlimited reports using CrashMap Pro visit: [www.crashmap.co.uk/home/premium\\_services](http://www.crashmap.co.uk/home/premium_services)



### Validated Data

<b>Crash Date:</b>	Friday, July 16, 2021	<b>Time of Crash:</b>	10:00:00	<b>Crash Reference:</b>	2021131066800
<b>Highest Injury Severity:</b>	Serious	<b>Road Number:</b>	U	<b>Casualties:</b>	1
<b>Highway Authority:</b>	Kirklees			<b>Vehicles:</b>	2
<b>Local Authority:</b>	Kirklees			<b>OS Grid Reference:</b>	405204 411684
<b>Weather Description:</b>	Fine without high winds				
<b>Road Surface Description:</b>	Dry				
<b>Speed Limit:</b>	30				
<b>Light Conditions:</b>	Daylight: regardless of presence of streetlights				
<b>Carriageway Hazards:</b>	None				
<b>Junction Detail:</b>	Not at or within 20 metres of junction				
<b>Junction Pedestrian Crossing:</b>	No physical crossing facility within 50 metres				
<b>Road Type:</b>	Single carriageway				
<b>Junction Control:</b>	Unknown				

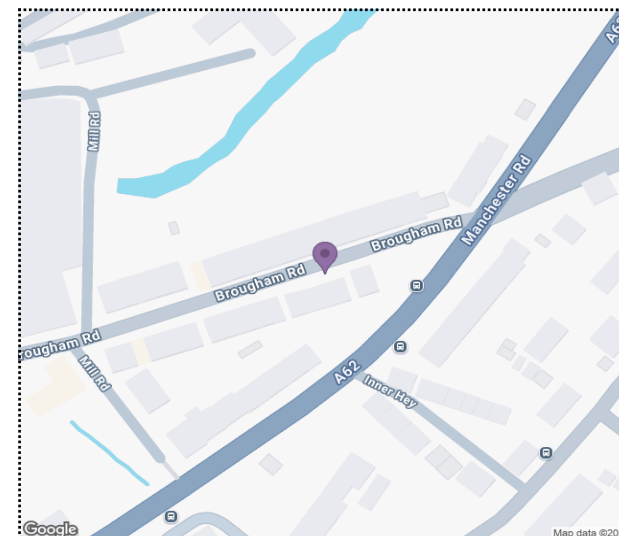

For more information about the data please visit: [www.crashmap.co.uk/home/faq](http://www.crashmap.co.uk/home/faq)

To subscribe to unlimited reports using CrashMap Pro visit: [www.crashmap.co.uk/home/premium\\_services](http://www.crashmap.co.uk/home/premium_services)

**Validated Data**
**Crash Date:**

Friday, July 16, 2021

**Time of Crash:** 10:00:00

**Crash Reference:** 2021131066800

**Vehicles Involved**

Vehicle Ref	Vehicle Type	Vehicle Age	Driver Gender	Driver Age Band	Vehicle Manoeuvre	First Point of Impact	Journey Purpose	Hit Object - On Carriageway	Hit Object - Off Carriageway
1	Car (excluding private hire cars 2005 onwards)	7	Female	Over 75	Vehicle proceeding normally along the carriageway, not on a bend	Nearside	Other	None	None
2	Car (excluding private hire cars 2005 onwards)	16	Unknown	Unknown	Vehicle is parked in the carriageway	Offside	Unknown	None	None

**Casualties**

Vehicle Ref	Casualty Ref	Injury Severity	Casualty Class	Gender	Age Band	Pedestrian Location	Pedestrian Movement
1	1	Serious	Driver or rider	Female	Over 75	Unknown or other	Unknown or other

 For more information about the data please visit: [www.crashmap.co.uk/home/faq](http://www.crashmap.co.uk/home/faq)

 To subscribe to unlimited reports using CrashMap Pro visit: [www.crashmap.co.uk/home/premium\\_services](http://www.crashmap.co.uk/home/premium_services)

## Validated Data

Crash Date:

Saturday, March 7, 2020

Time of Crash: 19:20:00

Crash Reference: 2020137371613

## Vehicles Involved

Vehicle Ref	Vehicle Type	Vehicle Age	Driver Gender	Driver Age Band	Vehicle Manoeuvre	First Point of Impact	Journey Purpose	Hit Object - On Carriageway	Hit Object - Off Carriageway
1	Car (excluding private hire cars 2005 onwards)	-1	Female	36 - 45	Vehicle is in the act of turning right	Nearside	Journey as part of work	None	Wall or fence

## Casualties

Vehicle Ref	Casualty Ref	Injury Severity	Casualty Class	Gender	Age Band	Pedestrian Location	Pedestrian Movement
1	1	Slight	Driver or rider	Female	36 - 45	Unknown or other	Unknown or other

For more information about the data please visit: [www.crashmap.co.uk/home/faq](http://www.crashmap.co.uk/home/faq)

To subscribe to unlimited reports using CrashMap Pro visit: [www.crashmap.co.uk/home/premium\\_services](http://www.crashmap.co.uk/home/premium_services)



**Validated Data**

**Crash Date:** Friday, April 2, 2021

**Time of Crash:** 13:40:00

**Crash Reference:** 2021138420924

**Highest Injury Severity:** Slight

**Road Number:** U

**Casualties:** 1

**Highway Authority:** Kirklees

**Vehicles:** 1

**Local Authority:** Kirklees

**OS Grid Reference:** 404914 411628

**Weather Description:** Fine without high winds

**Road Surface Description:** Dry

**Speed Limit:** 30

**Light Conditions:** Daylight: regardless of presence of streetlights

**Carriageway Hazards:** None

**Junction Detail:** Not at or within 20 metres of junction

**Junction Pedestrian Crossing:** No physical crossing facility within 50 metres

**Road Type:** Single carriageway

**Junction Control:** Unknown

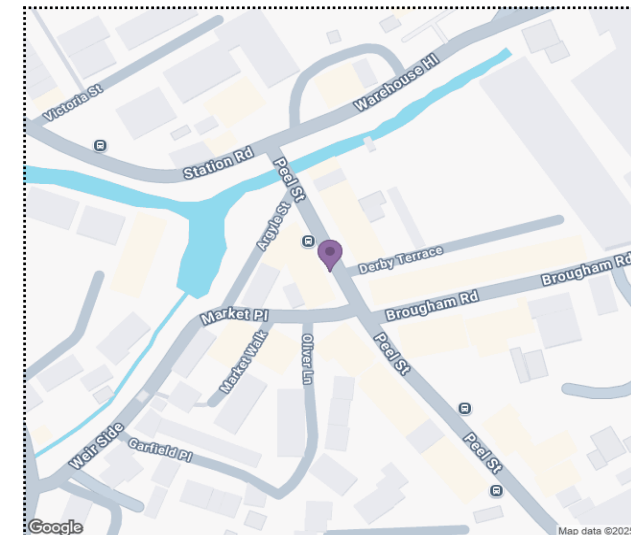

For more information about the data please visit: [www.crashmap.co.uk/home/faq](http://www.crashmap.co.uk/home/faq)

To subscribe to unlimited reports using CrashMap Pro visit: [www.crashmap.co.uk/home/premium\\_services](http://www.crashmap.co.uk/home/premium_services)

Crash Date:

Friday, April 2, 2021

Time of Crash: 13:40:00

Crash Reference: 2021138420924

## Vehicles Involved

Vehicle Ref	Vehicle Type	Vehicle Age	Driver Gender	Driver Age Band	Vehicle Manoeuvre	First Point of Impact	Journey Purpose	Hit Object - On Carriageway	Hit Object - Off Carriageway
1	Car (excluding private hire cars 2005 onwards)	-1	Unknown	Unknown	Vehicle is reversing	Back	Unknown	None	None

## Casualties

Vehicle Ref	Casualty Ref	Injury Severity	Casualty Class	Gender	Age Band	Pedestrian Location	Pedestrian Movement
1	1	Slight	Pedestrian	Male	21 - 25	In carriageway, crossing elsewhere	Unknown or other

For more information about the data please visit: [www.crashmap.co.uk/home/faq](http://www.crashmap.co.uk/home/faq)

To subscribe to unlimited reports using CrashMap Pro visit: [www.crashmap.co.uk/home/premium\\_services](http://www.crashmap.co.uk/home/premium_services)

# APENDIX C

## Traffic Survey Report



**PLEASE REFER TO SEPARATE  
DOCUMENT**

# APPENDIX D

## Base Traffic Flow Diagrams



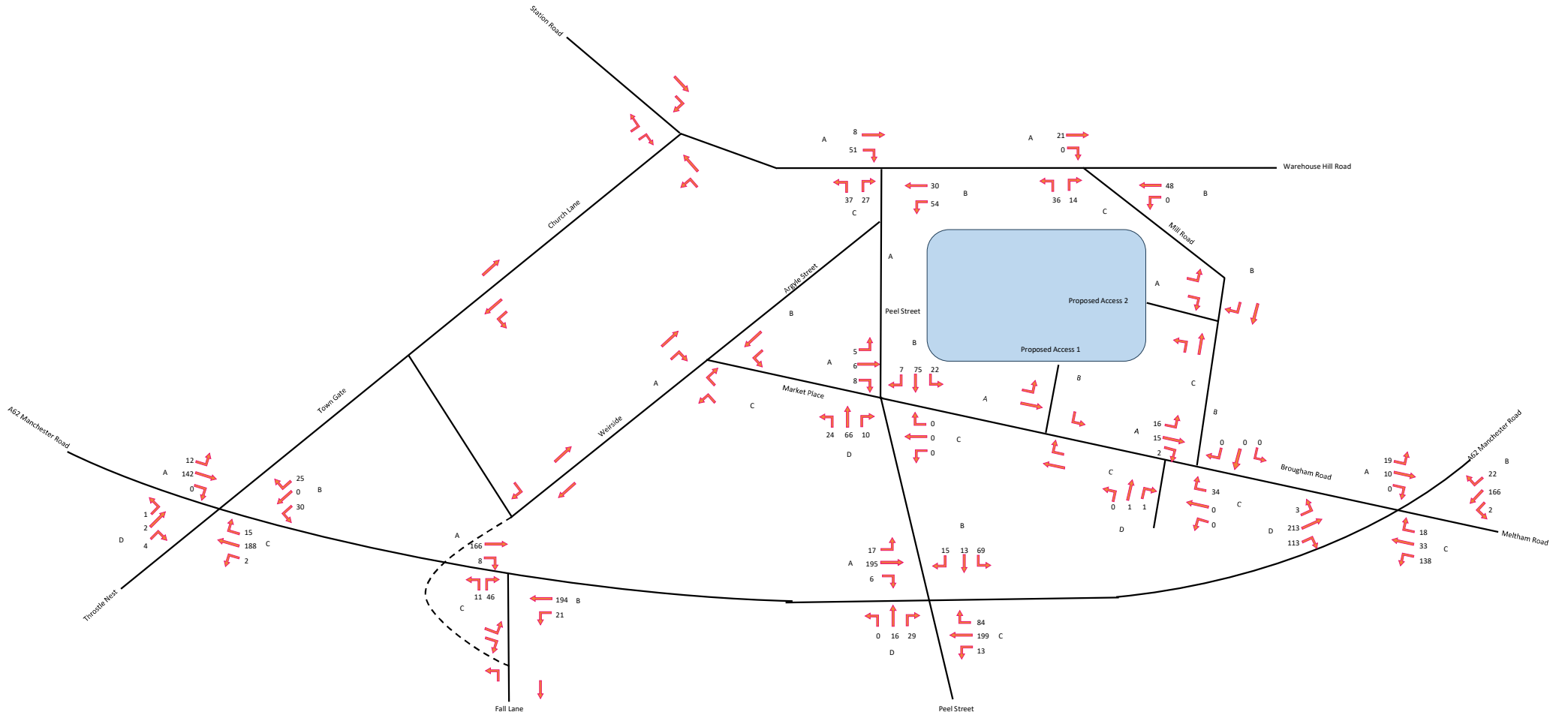

FIGURE 3 - 2024 BASE TRAFFIC - WEEKDAY AM PEAK PERIOD

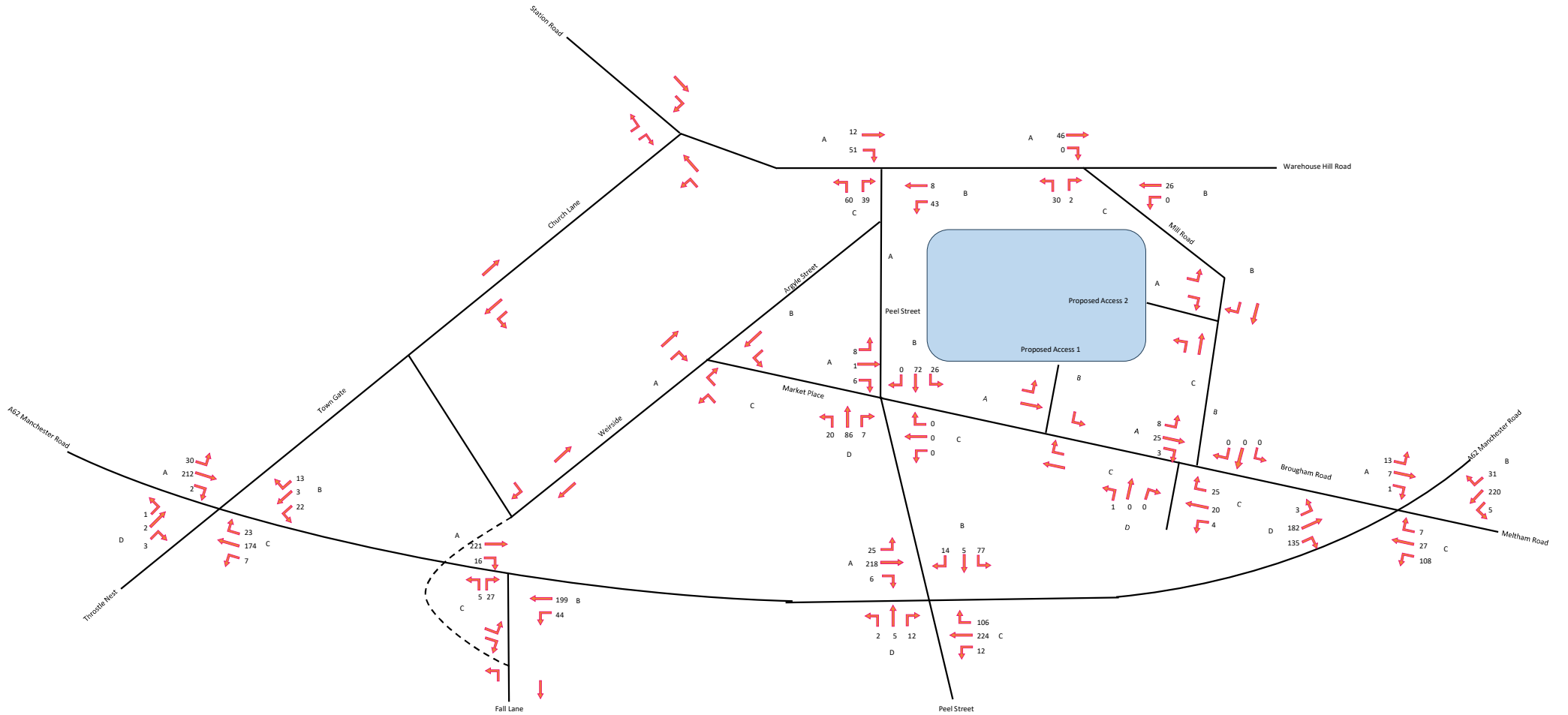

FIGURE 4 - 2024 BASE TRAFFIC - WEEKDAY PM PEAK PERIOD

TEMPro Growth Factor: 1.0396

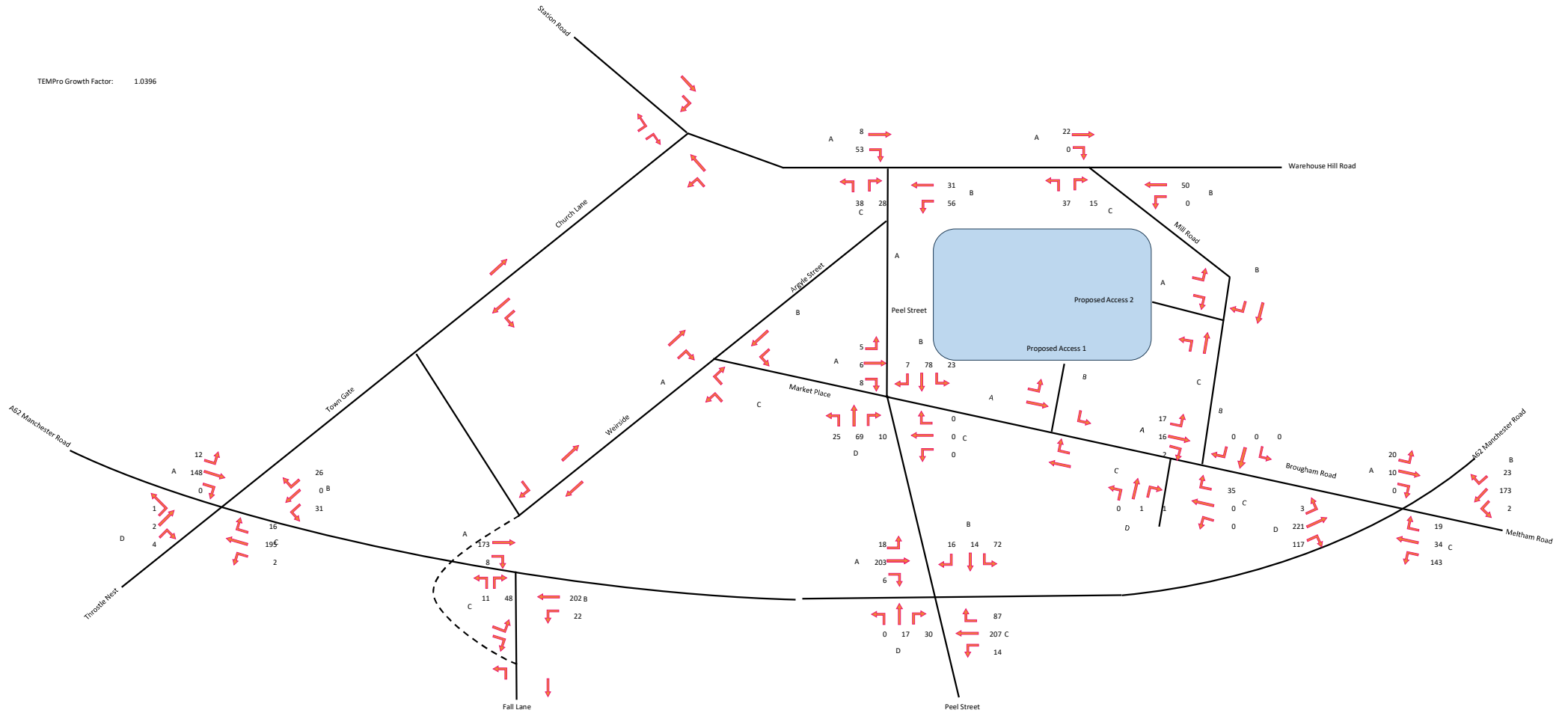

FIGURE 9 - 2029 BASE TRAFFIC - WEEKDAY AM PEAK PERIOD

TEMPro Growth Factor: 1.0432

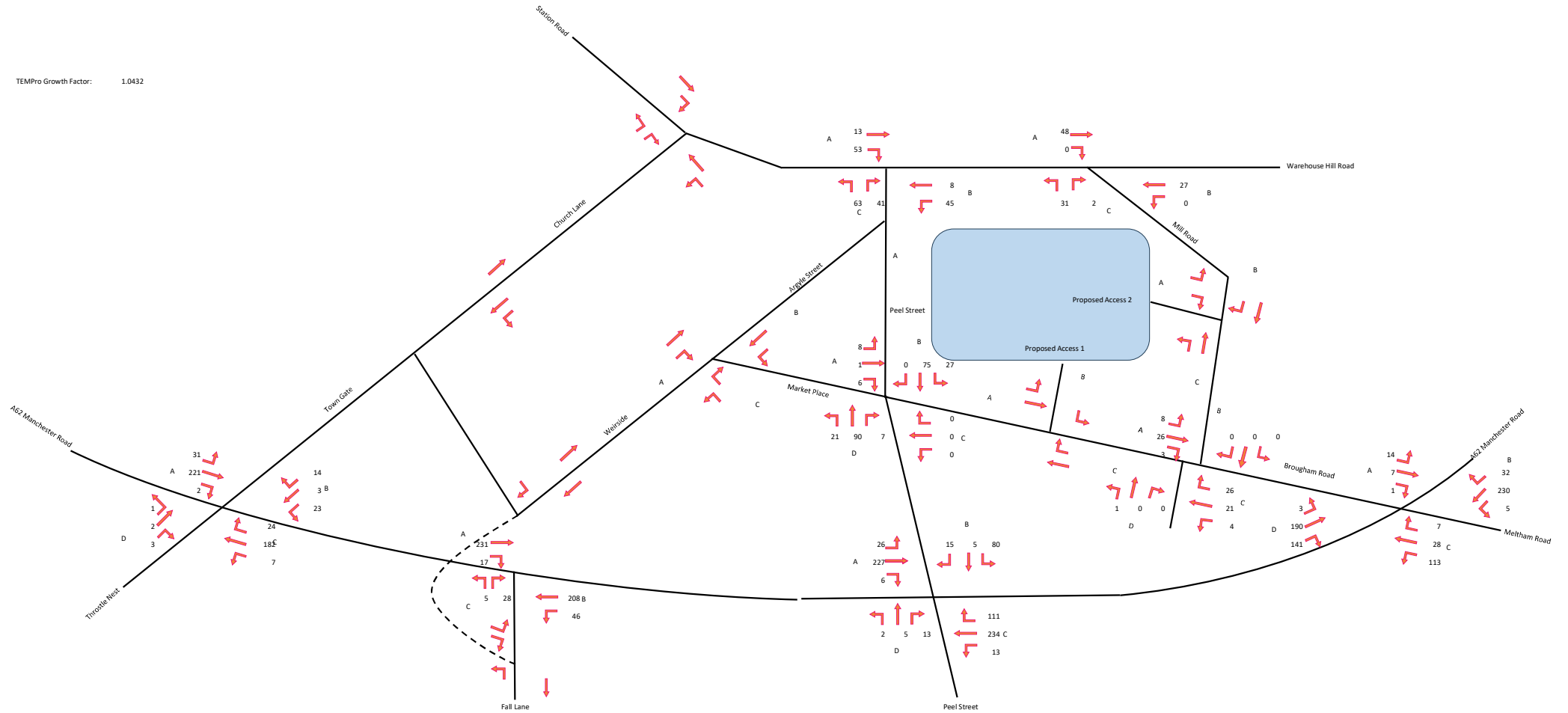

FIGURE 10 - 2029 BASE TRAFFIC - WEEKDAY PM PEAK PERIOD

# APPENDIX E

## Census Data Outputs



## QS703EW - Method of Travel to Work (2001 specification)

ONS Crown Copyright Reserved [from Nomis on 6 March 2025]

population All usual residents aged 16 to 74  
units Persons  
date 2011

Method of Travel to Work	E01011070 :	E01011074 :	E01011075 :	E01011076 :		
	Kirklees 052A	Kirklees 052B	Kirklees 052C	Kirklees 052D		
Underground, metro, light rail, t	2	0	0	0	2	0.1%
Train	59	103	75	33	270	9.5%
Bus, minibus or coach	18	54	44	66	182	6.4%
Taxi	2	2	0	2	6	0.2%
Motorcycle, scooter or moped	3	9	8	4	24	0.8%
Driving a car or van	517	589	395	443	1,944	68.2%
Passenger in a car or van	27	55	39	37	158	5.5%
Bicycle	11	13	8	6	38	1.3%
On foot	56	78	43	43	220	7.7%
Other method of travel to work	1	0	1	3	5	0.2%
					2,849	

In order to protect against disclosure of personal information, records have been swapped between different geographic areas. Some counts will be affected, particularly small counts at the lowest geographic

**WP7103EW - Workplace and usual residence by method of travel to work (2001 specification) (Workplace population)**

ONS Crown Copyright Reserved [from Nomis on 3 June 2025]

population All usual residents aged 16 and over in employment in the area the week before the census  
 units Persons  
 date 2011  
 usual residence All categories: Usual residence

Method of travel to work	E33012082	Modal Share	E33012084	Modal Share	Average	
Underground, metro, light rail or	0	0%	0	0%	0%	0
Train	9	3%	14	6%	4%	23
Bus, minibus or coach	24	7%	19	8%	8%	43
Taxi	0	0%	0	0%	0%	0
Motorcycle, scooter or moped	3	1%	0	0%	0%	3
Driving a car or van	205	62%	143	59%	61%	348
Passenger in a car or van	19	6%	9	4%	5%	28
Bicycle	3	1%	0	0%	0%	3
On foot	67	20%	56	23%	22%	123
Other method of travel to work	0	0%	0	0%	0%	0
	330		241			571

In order to protect against disclosure of personal information, records have been swapped between different geographic areas. Some counts will be affected, particula

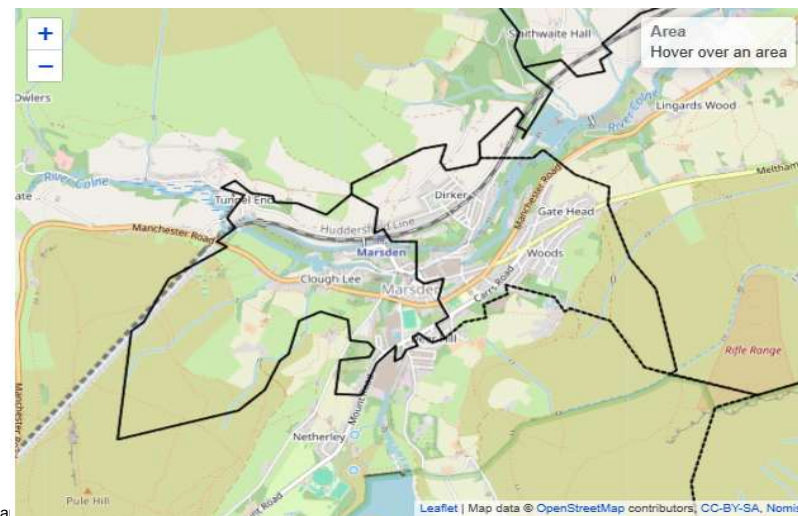

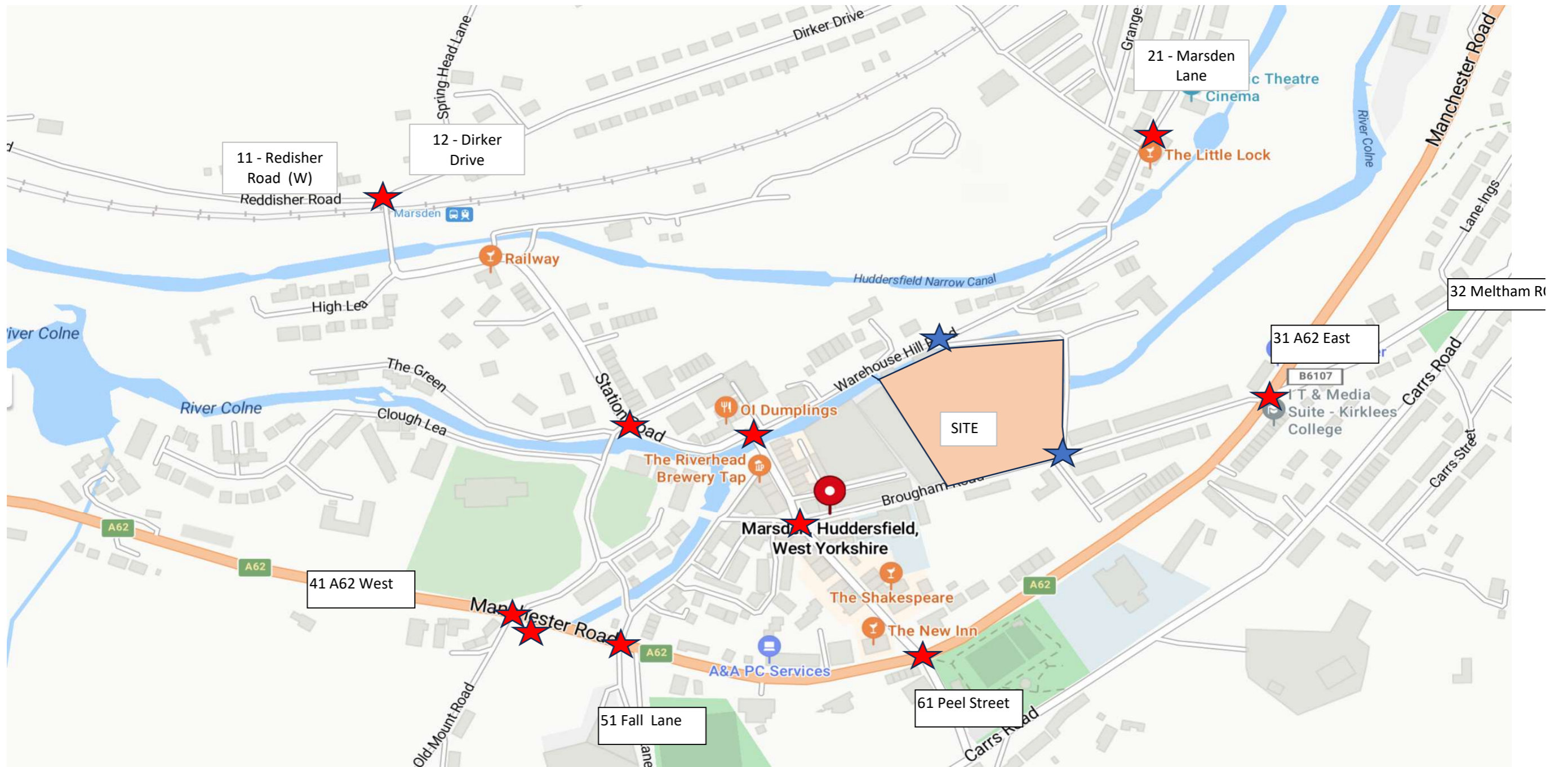

## WF01BEW - Location of usual residence and place of work (OA level)

ONS Crown Copyright Reserved [from Nomis on 6 December 2021]

population All usual residents ages 16 and over in employment the week before the census  
 units Persons  
 date 2011

### place of work

currently residing in	E01011074 : Kirklees 052B	E01011075 : Kirklees 052C	E01011076 : Kirklees 052D		
Broxbourne	0	1	0	1	0%
Maldon	0	2	0	2	0%
Darlington	0	1	0	1	0%
Sunderland	0	1	0	1	0%
Bury	0	2	0	2	0%
Liverpool	1	0	0	1	0%
Manchester	2	0	0	2	0%
Oldham	5	4	0	9	1%
Rochdale	0	2	0	2	0%
Tameside	0	2	0	2	0%
East Hampshire	0	1	0	1	0%
Woking	1	0	0	1	0%
Denbighshire	0	1	0	1	0%
Barnsley	1	0	0	1	0%
Bradford	0	1	1	2	0%
Calderdale	7	7	4	18	3%
Kirklees	173	290	139	602	90%
Leeds	3	5	1	9	1%
Wakefield	4	1	0	5	1%
Sheffield	1	0	0	1	0%
York	0	2	0	2	0%
				666	

### Place of work: 2011 super output layer - lower layer

		%age	Adj. %age
E01011233 : Kirklees 039B	7	1%	2%
E01011152 : Kirklees 041D	7	1%	2%
E01011077 : Kirklees 045A	15	2%	4%
E01011071 : Kirklees 049A	15	2%	4%
E01011072 : Kirklees 049B	13	2%	3%
E01011073 : Kirklees 049C	15	2%	4%
E01011078 : Kirklees 049D	17	3%	5%
<b>E01011070 : Kirklees 052A</b>	<b>8</b>	<b>1%</b>	<b>2%</b>
<b>E01011074 : Kirklees 052B</b>	<b>110</b>	<b>18%</b>	<b>29%</b>
<b>E01011075 : Kirklees 052C</b>	<b>56</b>	<b>9%</b>	<b>15%</b>
<b>E01011076 : Kirklees 052D</b>	<b>54</b>	<b>9%</b>	<b>14%</b>
E01011168 : Kirklees 055A	7	1%	2%
E01011174 : Kirklees 055B	8	1%	2%
E01011177 : Kirklees 055D	7	1%	2%
	339	56%	90%

Adjusted because I took out any routings with less than 1% and adjusted the others upwards



**WF01BEW - Location of usual residence and place of work (OA level)**

ONS Crown Copyright Reserved [from Nomis on 1 January 2025]

population All usual residents ages 16 and over in employment the week before the census  
 units Persons  
 date 2011

place of work	currently residing in					
	E01011074 : Kirklees 052B	E01011075 : Kirklees 052C	E01011076 : Kirklees 052D			
Manchester	52	24	19	95	5%	
Oldham	73	35	32	140	7%	
Rochdale	11	3	11	25	1%	
Salford	9	6	4	19	1%	
Stockport	4	4	2	10	1%	
Tameside	39	14	6	59	3%	
Trafford	9	3	4	16	1%	
Barnsley	3	2	5	10	1%	
Bradford	20	15	16	51	3%	
Calderdale	56	27	43	126	7%	
Kirklees	484	338	386	1,208	64%	
Leeds	45	22	24	91	5%	
Wakefield	6	10	11	27	1%	
				1,877		

Adjusted because I took out any routings with less than 1% and adjusted the othersupwards

**Place of work: 2011 super output layer - lower layer**

		%age	Adj. %age
E01011130 : Kirklees 017B	10	1%	1%
E01011103 : Kirklees 025B	21	2%	1%
E01011106 : Kirklees 029C	23	2%	2%
E01011107 : Kirklees 029D	138	11%	9%
E01011045 : Kirklees 031D	14	1%	1%
E01011208 : Kirklees 033C	54	4%	4%
E01011236 : Kirklees 034B	29	2%	2%
E01011151 : Kirklees 036B	8	1%	1%
E01011150 : Kirklees 038A	16	1%	1%
E01011235 : Kirklees 039C	19	2%	1%
E01011237 : Kirklees 039D	11	1%	1%
E01011229 : Kirklees 042D	82	7%	6%
E01011081 : Kirklees 043B	14	1%	1%
E01011230 : Kirklees 043D	12	1%	1%
E01011077 : Kirklees 045A	38	3%	3%
E01011149 : Kirklees 045B	20	2%	1%
E01011153 : Kirklees 045C	9	1%	1%
E01011071 : Kirklees 049A	12	1%	1%
E01011072 : Kirklees 049B	31	3%	2%
E01011073 : Kirklees 049C	55	5%	4%
E01011078 : Kirklees 049D	23	2%	2%
E01011222 : Kirklees 050D	11	1%	1%
E01011070 : Kirklees 052A	18	1%	1%
E01011074 : Kirklees 052B	78	6%	5%
E01011075 : Kirklees 052C	119	10%	8%
E01011076 : Kirklees 052D	23	2%	2%
E01011174 : Kirklees 055B	14	1%	1%
E01011178 : Kirklees 055E	17	1%	1%
E01011186 : Kirklees 058C	9	1%	1%
E01011181 : Kirklees 059B	14	1%	1%
	425	78%	64%

Adjusted because I took out any routings with less than 1% and adjusted the othersupwards



# APPENDIX F

## Proposed Site Layout Drawings





Notes:  
 This drawing is the sole copyright of KPP Architects Ltd and reproduction in any form is forbidden unless permission is obtained in writing.  
 Do not scale from this drawing. Any discrepancies on site should be brought to the attention of KPP Architects Ltd.  
 Work and materials must comply with the current building regulations and codes of practice and be read in conjunction with Building Specifications and other associated information. All materials are to be installed in strict accordance with the recommendations of the manufacturers.

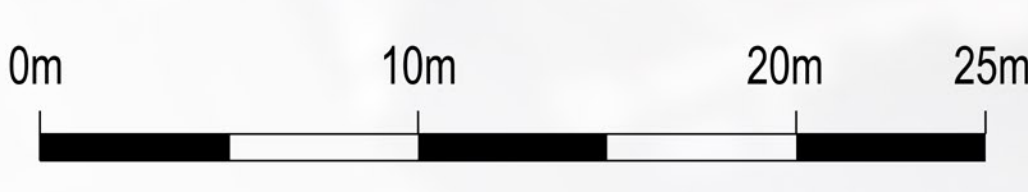
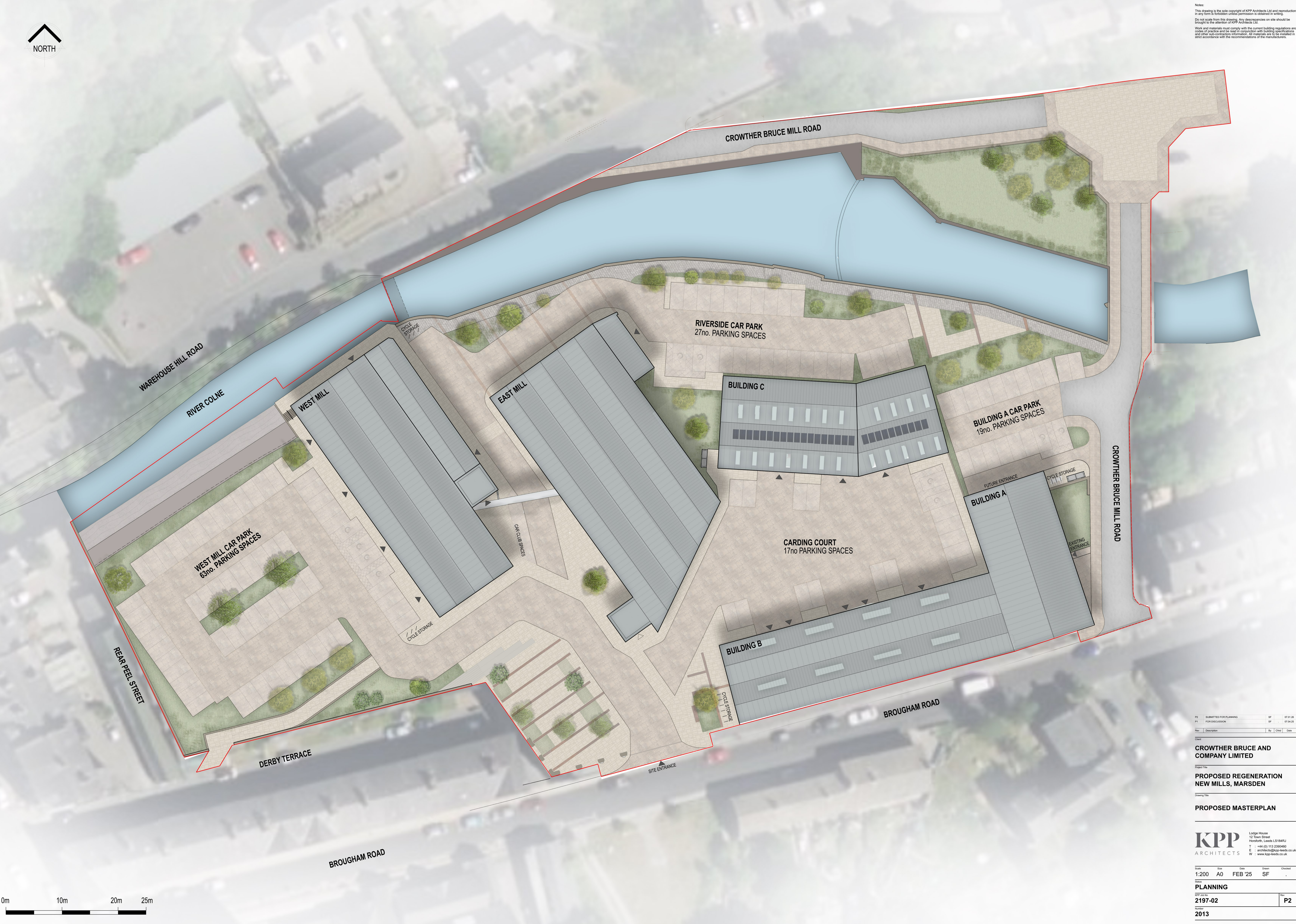

P2	SUBMITTED FOR PLANNING	SF	07.01.20
P1	FOR DISCUSSION	SF	07.04.20
Rev	Description	By	Check

Client:  
**CROWTHER BRUCE AND COMPANY LIMITED**

Project Title:  
**PROPOSED REGENERATION NEW MILLS, MARSDEN**

Drawing Title:  
**PROPOSED MASTERPLAN**

**KPP ARCHITECTS**  
 Lodge House  
 12 Town Street  
 Horsforth, Leeds LS18 4RU  
 T : +44 (0) 113 2390480  
 E : architects@kpp-leeds.co.uk  
 W : www.kpp-leeds.co.uk

Scale	Size	Date	Drawn	Checked
1:200	A0	FEB '25	SF	.

Drawn:  
**PLANNING**  
 KPP Job No:  
**2197-02**  
 Number:  
**2013**

