

**Key plan**

**North**

**Building fabric performance required:**

External walls:	0.15 W/m <sup>2</sup> K
Ground floor slab:	0.10 W/m <sup>2</sup> K
Roof:	0.12 W/m <sup>2</sup> K
Windows/Roof Lights:	1.20 W/m <sup>2</sup> K
Personnel Doors:	1.60 W/m <sup>2</sup> K
Air Permeability:	3m <sup>3</sup> /(h.m <sup>2</sup> ) at 50 Pa

**Room markers:**

G01 ← Room Number  
5m<sup>2</sup> ← Area (m<sup>2</sup>)

**Elevation markers:**

E-01 ← Elevation ID  
3001 ← Drawing number

**Section markers:**

S-01 ← GA section ID  
4101 ← Drawing number

**Detail markers:**

D-01 ← Detailed section ID  
4401 ← Drawing number

**Detail markers:**

WallExt-D01 ← Detail ID  
7001 ← Drawing number

**Balustrade-D01** Balustrade Detail  
**CurtainWall-D01** Curtain Wall Detail  
**Cladding-D01** Cladding Detail  
**Column-D01** Column Detail  
**DoorInt-D01** Door Internal Detail  
**DoorExt-D01** Door External Detail  
**Floor-D01** Floor Detail  
**Floor-D01** Floor Detail  
**Lift-D01** Lift Detail  
**Misc-D01** Miscellaneous Detail  
**Roof-D01** Roof Detail  
**Roof-D01** Roof Detail  
**Stair-D01** Stair Detail  
**Waterproof-D01** Waterproofing Detail  
**WallExt-D01** Wall External Detail  
**WallInt-D01** Wall Internal Detail  
**WindowExt-D01** Window External Detail  
**WindowInt-D01** Window Internal Detail

**Notes:**

Drawing to be read in conjunction with the following BBA drawings:

Typical Site Sections

- 6BKD2-BBA-33-XX-D-A-4201
- 6BKD2-BBA-33-XX-D-A-4202
- 6BKD2-BBA-33-XX-D-A-4203
- 6BKD2-BBA-33-XX-D-A-4204
- 6BKD2-BBA-33-XX-D-A-4205
- 6BKD2-BBA-33-XX-D-A-4206
- 6BKD2-BBA-33-XX-D-A-4207

Details

- 6BKD2-BBA-41-R1-D-A-7801 Roof Railing Design Intent and Details
- 6BKD2-BBA-34-ZZ-D-A-7451 Rooflight Schedule and Details
- 6BKD2-BBA-34-ZZ-D-A-7253 External Plant Louvre and Screen Details

**For Roof Railing Details, refer to drawing 6BKD2-BBA-41-R1-D-A-7801 Roof Railing Design Intent.**

Drawing to be read in conjunction with the following subcontractor documents:

- NRA Roof details and specification
- WPL Plant Louvre Screen drawings and specification
- Elecomm
- 6BKD2-ELE-S2-R1-D-M-3505 Roof Level - Above Ground Drainage
- 6BKD2-ELE-37-R1-D-ME-5002 Combined Services - Roof

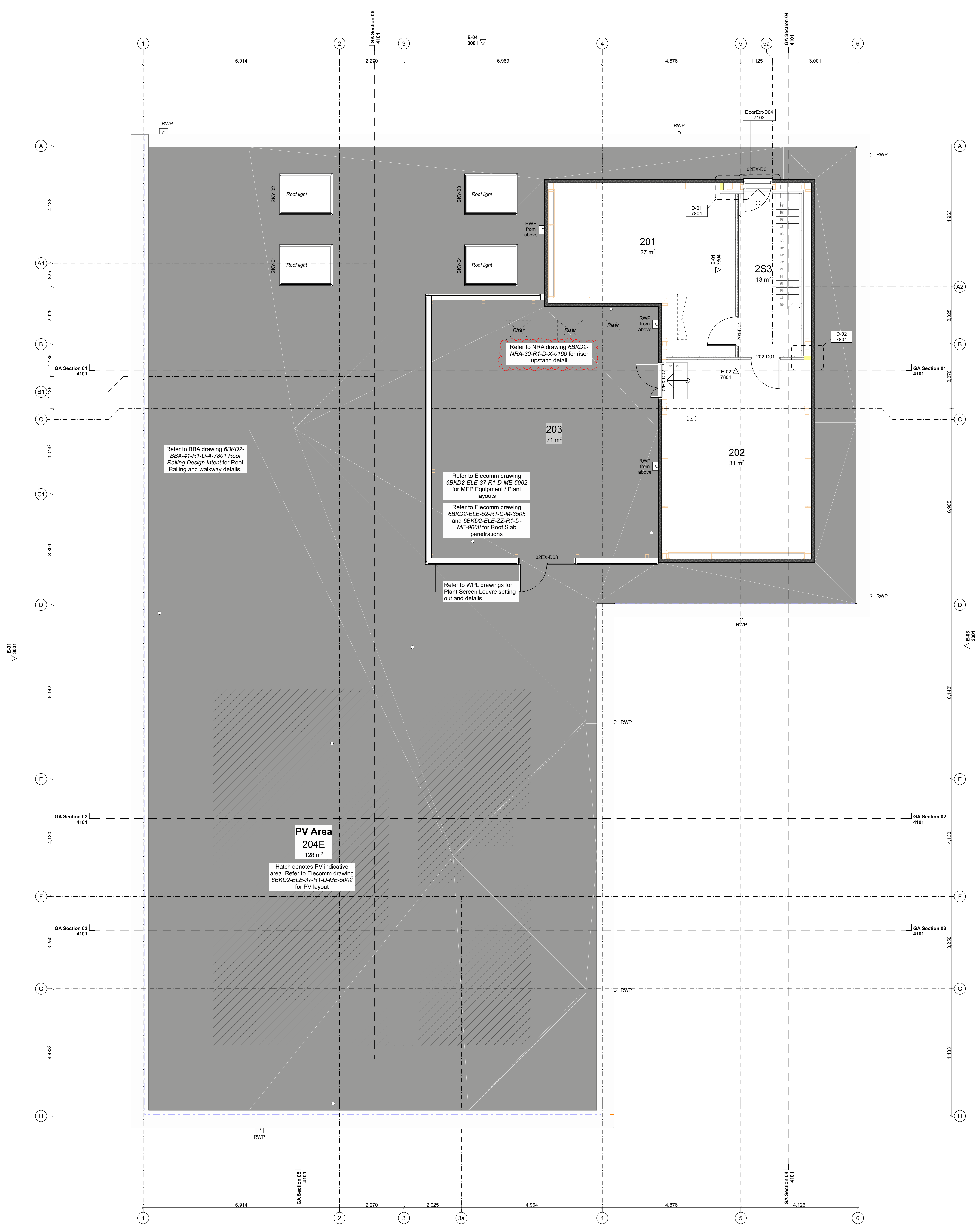

Second Floor Level  
1:50

C08	Day termed detail note updated as per comments on Viewport	JCC	DH	01/04/2026
C07	Drawing amended as per MSC comments	JCC	DH	28/03/2025
C06	RWP at GL 1A moved following Site coordination. Parapet width increased by 100mm	JCC	AD	14/11/2025
C05	RWP on GL 04 moved. Drawing name amended as per MSC request dated 20/09/2025. Drawing amended as per MSC comments dated 11/09/2025	JCC	DH	02/09/2025
C04	Door 025X 012 with amended following meeting dated 23/09/2025	JCC	DH	18/07/2025
C03	Rainwater Pipes moved on Elevation 01 to Elevation 02 & 04. Movement joints moved on Elevation 01	JCC	AD	02/06/2025
C02	Gridlines amended	JCC	AD	29/05/2025
C01	Construction Issue	JCC	AD	15/05/2025
P02	Stage 2b Issue	JCC	AD	10/10/2024
P01	First Issue	JCC	AD	23/09/2024
Rev	Description	Drawn	Checked	Date

**B**

**BOND BRYAN**

info@bondbryan.co.uk  
www.bondbryan.co.uk

**Morgan Sindall**

**MORGAN SINDALL**

**6BKD2**

**Roof Level GA Plan**

Originator project ref: **2148**  
Purpose of issue: **For Construction**  
Scale(s): **1:50**  
Paper size: **A0**

project	originator	volume	level	type	rate	number	revision
6BKD2-BBA-31-R1-D-A-2104							C08