

Environmental
Geotechnical
Specialists



COAL MINING RISK ASSESSMENT REPORT

< ENVIRONMENTAL > < GEOTECHNICAL >

job number	date
site address	
written by	checked by
issued by	

 Please consider the environment before printing this report.



Rogers Geotechnical Services Ltd
Offices 1 & 2 Barncliffe Business Park, Near Bank, Shelley, Huddersfield, HD8 8LU
☎ 01484 604354 Company No. 5130864

Contents

		Page
1.	Introduction	1
2.	Geological Desk Study	1
2.1	British Geological Survey Maps and Viewer	2
2.2	Coal Authority Mines Report	3
2.3	Geological Survey Borehole Records	4
3.	Risk Assessment	4
3.1	Risks Posed by Shall Coal Workings	5
3.2	Risks Posed by Coal Workings at Depth	5
3.3	Risks Posed by Mine Gas	6
4.	Conclusions	6

Appendices

1.	Site Plan
2.	Coal Authority Report

Report on a Coal Mining Risk Assessment

Location: **4 Exley Gate**
Huddersfield, West Yorkshire, HD8 8YN

For: Castlehill Damage Restoration Ltd

Report No. C5600/25/E/8665

Report date: November 2025

For and on behalf of **Rogers Geotechnical Services Ltd**

Steven Hale BSc FGS
Geo-environmental Engineer

Scott Alexander BSc FGS
Senior Geo-environmental Engineer

1. Introduction

It is understood that as part of the planning application at the site, a Coal Mining Risk Assessment has been requested by the planning authority. Consequently, a desktop study was commissioned in order to assess the risk to the development from coal mining. This report presents the findings of the study.

2. Geological Desk Study

The geological desk study has been undertaken using the following sources of information.

- British Geological Survey (BGS) map sheet¹.
- British Geological Survey *GeoIndex Onshore Viewer*².
- Coal Authority Consultants Coal Mining Report³.
- British Geological Survey *Borehole Records*⁴.

¹ Sources: British Geological Survey (NERC) Map Sheet 86; Glossop Solid and Drift Editions

² Sources: British Geological Survey (NERC) GeoIndex Onshore Viewer [online resource from www.bgs.ac.uk]

³ Coal Authority Reference: 51003534469001 dated 28th October 2025.

⁴ Sources: British Geological Survey (NERC) Borehole Records [online resource from <http://www.bgs.ac.uk/>]

2.1 British Geological Survey Maps and Viewer

The appropriate map sheet for the site and the geology viewer has been examined and the following table presents the indicated geology:

Strata Type	Strata Name ⁵	Parent Unit ⁶	Description
Superficial Geology	None recorded	-	-
Solid Geology	Pennine Lower Coal Measures formation	Grey Measures of Yorkshire and Nottingham	Interbedded grey mudstone, siltstone and pale grey sandstone, commonly with mudstones containing marine fossils in the lower part, and more numerous and thicker coal seams in the upper part.

On the geological map, there are no dip indicators relevant to the site (i.e. within the same fault block). However, there are two indicators on neighbouring faulted blocks that should be noted. One is located approximately 360m south that suggests the solid geology beneath the site dips gently to the south. It should be appreciated that as no value is given, it is assumed that the dip is sub-horizontal (i.e close to zero degrees). The other indicator is located approximately 155m east of the site and suggests a degree of dip of 4° to the southeast. It is of note that the local area is subject to faulting whereby variations in dip may occur.

On inspection of the published geological records there are no coal seam outcrops within the fault block of the site itself however outcrops are recorded on the adjacent fault blocks to the east and west which are anticipated to be present beneath the site. The table below summaries the coal seams, and their relationship to the site:

Seam Name	Seam Thickness ^{5*}	Outcrop Distance from Site ^{5*}	Anticipated Depth below Site
Black Band (Shertcliffe) Coal (BD)	0.3m – 0.8m	330m W – on western fault block 400m E – on eastern fault block	Within 10m of the surface.
Whinmoor (Cumberworth Thick) (W)	1.30m	500m SE – on eastern fault block	20m to 30m.
Cumberworth Thin (CT)	0.0 – 0.40m	475m S – On western fault block 800m SE – on eastern fault block	30m to 40m.

*All distances are given as approximations only. It should be noted that coal seam thicknesses vary over relatively short distances

In light of the above and taking into account the regional structural geology and the topography of the area, the above coal seams are anticipated to be present at depths of less than 30m below the surface of the site. It is of note that the Black Band (Shertcliffe), Whinmoor (Cumberworth Thick), and the Cumberworth Thin Coal, are considered to be part of the Beeston Coal Group.

⁵ Sources: British Geological Survey (NERC) Map Sheets 86; Glossop; Solid and Drift Edition, and Geology of Britain Viewer [online resource from www.bgs.ac.uk]

⁶ Sources: British Geological Survey (NERC) Lexicon of Named Rock Units [online resource from www.bgs.ac.uk]

2.2 Coal Authority Mines Report

As part of this study a Coal Authority Consultants Coal Mining Report has been obtained. The report is presented as Appendix 2 and for the purposes of discussion has been summarised below:

Table 3: Summary of the Consultant's Coal Mining Report		
Has the report highlighted evidence or potential of:		
Mining Feature	Yes/No	Comments
Underground Coal Mining	No	None recorded.
Probable Unrecorded Shallow Workings	Yes	No further details given.
Spine Roadways at Shallow Depth	No	No spine roadway recorded at shallow depth.
Mine Entries	No	None recorded within 100m of the enquiry boundary.
Abandoned mine plans	No	None available.
Outcrops	Yes	Top Beeston – 33.4m S.
Geological Faults	No	No faults, fissures or breaklines recorded.
Opencast Mines	No	None recorded within 500 metres of the enquiry boundary.
Coal Authority Managed Tips	No	None recorded within 500 metres of the enquiry boundary.
Site Investigations	No	None recorded within 50 metres of the enquiry boundary
Remediated Sites	No	None recorded within 50 metres of the enquiry boundary.
Coal Mining Subsidence	No	<p>The Coal Authority has not received a damage notice or claim for the subject property, or any property within 50 metres of the enquiry boundary, since 31st October 1994.</p> <p>There is no current Stop Notice delaying the start of remedial works or repairs to the property.</p> <p>The Coal Authority is not aware of any request having been made to carry out preventive works before coal is worked under section 33 of the Coal Mining Subsidence Act 1991.</p>
Mine Gas	No	None recorded within 500 metres of the enquiry boundary.
Mine Water Treatment Schemes	No	None recorded within 500 metres of the enquiry boundary.
Future underground mining	No	For further information please see section 3 of the Consultant's Coal Mining Report.
Coal mining licensing	No	
Court orders	No	
Section 46 notices	No	
Withdrawal of support notices	No	
Payments to owners of former copyhold land	No	

It should be noted that the while the Top Beeston is recorded as outcropping 33.4m south of the site, no published geological records support this. While a suggested outcropping of the Top Beeston is noted approximately 485m southeast, there is no indication that it outcrops in close proximity to the site.

2.3 Geological Survey Borehole Records

The BGS (NERC) keeps borehole records from across Britain which are available for public viewing through their website⁷. As part of this study, the records in the area around the site have been reviewed in order to assist in establishing the geological conditions. The logs of the borehole can be viewed through the BGS website however the most pertinent features are summarised below:

Borehole	Approx. Distance from Site	Depth of Borehole (m)	Notable Features
SE20NW10 ⁸	180m SW	61.00	Coal (Intact) "Black Band Coal?" – 4.60m to 4.80m (0.20m thickness).
SE20NW41 ⁹	690m SE	41.00	Coal -11.40 (0.20m thickness)

It should be appreciated that there was limited borehole data within the immediate vicinity of the site that was available for public viewing. Other borehole scans were available at a greater distance from the site (within other fault blocks), however, these were felt to be of limited value to the study as they are not anticipated to present comparable ground conditions to those below the surface of the site.

Nevertheless, the borehole has indicated one notable coal seam present within 10.0m of the ground surface within the local area. Based on the available geological data, it is anticipated that this seam may represent the Black Band Coal. This coal seam was proven intact within the nearby borehole. Moreover, the seam encountered within this borehole is not considered to be of an economic thickness. However, it should be appreciated that coal seam thicknesses and quality can vary over relatively short distances. Therefore, there remains the possibility that coal seams of economic value may be present below the site surface.

3. Risk Assessment

The risk to the stability of the proposed residential development has been evaluated from the data obtained and with reference to the following ratings and definitions:

- Low - The possibility of instability is unlikely therefore no further action is necessary.
- Moderate - The possibility of instability is likely and further investigation or remedial action may be required.
- High - The possibility of instability is highly likely and further investigation or remedial action will be necessary.

⁷ Sources: British Geological Survey (NERC) Onshore Geoindex [online resource from <https://mapapps2.bgs.ac.uk/geoindex/home.html>]

⁸ Sources: BGS Borehole Scan SE20NW10 online resource from <https://api.bgs.ac.uk/sobi-scans/v1/borehole/scans/items/56256>

⁹ Sources: BGS Borehole Scan SE20NW10 online resource from <https://api.bgs.ac.uk/sobi-scans/v1/borehole/scans/items/13842834>

Table 5: Development Specific Risk Assessment

Item	Risk attributed to	Feature(s) Considered	Risk Rating
3.1	Shallow coal workings	Black Band Coal seam	Moderate
3.2	Coal workings at depth	The Coal Authority report indicates that the property is not within a surface area that could be affected by past underground mining.	Low
3.3	Mine gas	Shallow coal workings	Low to Moderate

3.1 Risks Posed by Shallow Coal Workings

On the basis of all of the information provided above, one coal seam is anticipated to be present within 30m of the surface at the site. Whilst this seam may be of limited thickness, the possibility of this seam being worked below the site cannot be ruled out. Historic mining activity is evident in the nearby area, and therefore it is considered that if coal was known to be close to ground level it could have been removed illicitly via shallow mining methods with relative ease.

It may be noted that guidance available from both the NHBC and the CIRIA publication, SP32 - *construction over abandoned mine workings*, suggests that competent overburden thickness above a coal seam should be greater than 10 times the thickness of a seam plus seam thickness in order that the collapse of workings would pose a low risk to surface structures.

On this basis, assuming a maximum thickness of the coal seams, the table below suggests the thickness of competent overburden required above each seam to mitigate instability at the surface.

Table 6: Required Thickness of Competent Overburden

Seam Name	Seam Thickness	Anticipated Depth Below Site	Required Thickness of Competent Overburden
Black Band Coal (BD)	0.3m – 0.8m	5m to 10m	8.80m
Whinmoor (Cumberworth Thick) (W)	1.30m	20m to 30m	14.30m
Cumberworth Thin (CT)	0.0 – 0.40m	30m to 40m	4.40m

Based on the above information, it is considered that there may not be a sufficient thickness of competent overburden above the Black Band Seam in order to prevent the risk of instability posed by the presence of any illicit workings. Therefore, a moderate risk rating has been placed on these seams, and further investigation is recommended to prove or disprove the presence of illicit mining activity. However, based on its anticipated depth below ground level, there may be a sufficient thickness of competent overburden above the Soft Bed Coal such that the risk from the collapse of workings is low. Nevertheless, it is strongly recommended that the true thickness and depth of this seam is investigated to validate this opinion. Therefore, a low to moderate risk rating has been assigned to this seam.

3.2 Risks Posed by Coal Workings at Depth

In regard to deeper mining which could affect the site, the property is not within a surface area that could be affected by past underground mining.

3.3 Risks Posed by Mine Gas

This assessment has identified that there is potential for shallow mine workings to be present beneath the proposed development. Whilst the Consultants Coal Mining Report has not reported any incidents of mine gas within the vicinity of the development, shallow mining activity represents a credible source of ground gas. As such, a low to moderate risk rating has been assigned, and further assessment may be required.

Should evidence of workings be proven via further intrusive works, it is strongly recommended that a detailed gas risk assessment is undertaken in accordance with relevant guidance. The risk assessment should take into consideration the current site conditions, and should be subject to reassessment after the formulation and/or completion of any remedial measures and proposed foundation solution. These documents should be prepared by a suitably experienced and qualified specialist.

4. Conclusions

In light of the potential risks of instability at the site from the working of shallow coal, it cannot be recommended that development takes place without further investigation to conclusively determine the presence of such workings. This work should include physical drilling methods to explore the ground conditions.

General practice is to undertake rotary openhole boreholes at three locations across the site to mitigate against the potential for drilling through intact columns associated with pillar and stall workings. Furthermore, it is normal to investigate the ground to 30m below ground level; any workings below this depth are unlikely to result in significant instability. However, in this case, the risk of instability is due to shallow workings at depths of less than 20m, therefore, drilling to these depths may not be necessary and the objective should be to ensure that the shallow seams are un-worked or have sufficient competent cover. It may therefore be possible, in the first instance, to undertake one borehole to 20m below the top of the rockhead, with a second borehole proving the depth and continuity of the coal seam(s). In any event, it is considered that approval should be sought with the Local Authority as to the efficacy of this approach.

It is of note that Rogers Geotechnical Services would be happy to assist in any further intrusive investigation that may be required.



Appendix 1

Site Plan

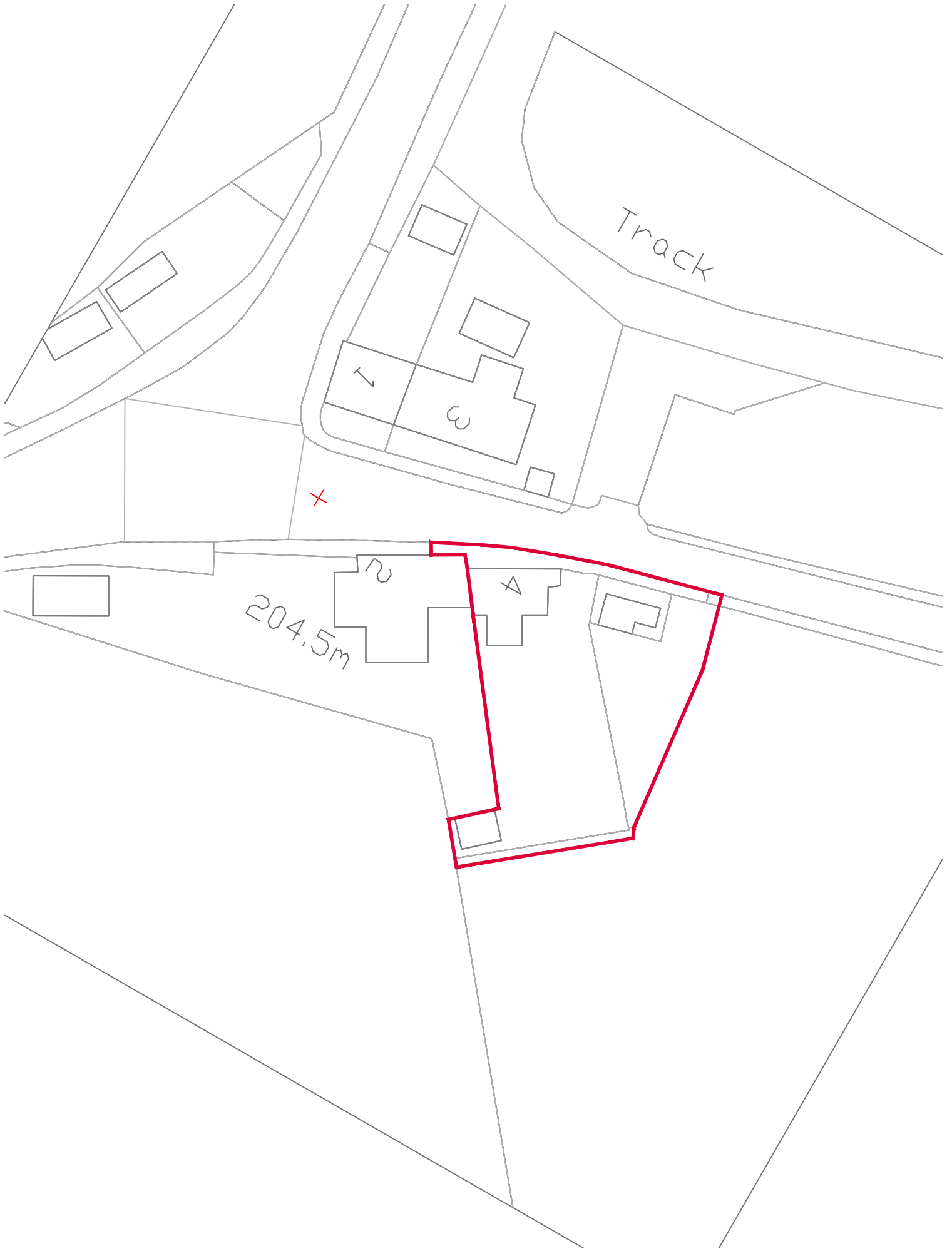

Track

+

204.5m

1

2

3

4

5

Appendix 2

Coal Authority Report



The Coal
Authority

Consultants Coal Mining Report

4
Exley Gate
Dry Hill Lane
Denby Dale
Huddersfield
Kirklees
HD8 8YN

Date of enquiry: 28 October 2025
Date enquiry received: 28 October 2025
Issue date: 28 October 2025

Our reference: 51003534469001
Your reference: C/5600/25/E/8665 - PO-
3594

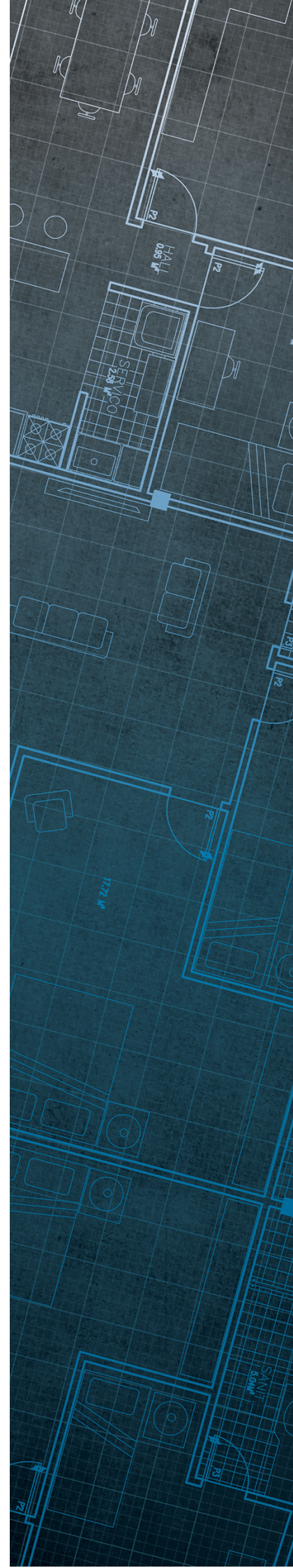

Consultants

Coal Mining Report

This report is based on and limited to the records held by the Coal Authority at the time the report was produced.

Client name

ROGERS GEOTECHNICAL SERVICES LTD

Enquiry address

4
Exley Gate
Dry Hill Lane
Denby Dale
Huddersfield
Kirklees
HD8 8YN

How to contact us

0345 762 6848 (UK)
+44 (0)1623 637 000 (International)

200 Lichfield Lane
Mansfield
Nottinghamshire
NG18 4RG

www.groundstability.com

 @coalauthority

 /company/the-coal-authority

 /thecoalauthority

 /thecoalauthority

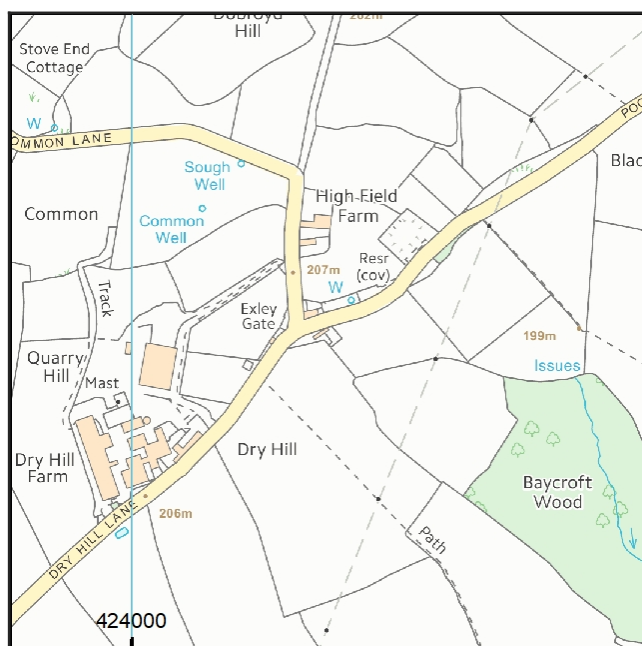

Approximate position of property



Reproduced by permission of Ordnance Survey on behalf of HMSO. © Crown copyright and database right 2018. All rights reserved.

Ordnance Survey Licence number: AC0000820577

Section 1 – Mining activity and geology

Past underground mining

No past mining recorded.

Probable unrecorded shallow workings

Yes.

Spine roadways at shallow depth

No spine roadway recorded at shallow depth.

Mine entries

None recorded within 100 metres of the enquiry boundary.

Abandoned mine plan catalogue numbers

None available.

Outcrops

Seam name	Mineral	Seam workable	Distance to outcrop (m)	Direction to outcrop	Bearing of outcrop
TOP BEESTON	Coal	Yes	33.4	South	271

Geological faults, fissures and breaklines

No faults, fissures or breaklines recorded.

Opencast mines

None recorded within 500 metres of the enquiry boundary.

Coal Authority managed tips

None recorded within 500 metres of the enquiry boundary.

Section 2 – Investigative or remedial activity

Please refer to the 'Summary of findings' map (on separate sheet) for details of any activity within the area of the site boundary.

Site investigations

None recorded within 50 metres of the enquiry boundary.

Remediated sites

None recorded within 50 metres of the enquiry boundary.

Coal mining subsidence

The Coal Authority has not received a damage notice or claim for the subject property, or any property within 50 metres of the enquiry boundary, since 31 October 1994.

There is no current Stop Notice delaying the start of remedial works or repairs to the property.

The Coal Authority is not aware of any request having been made to carry out preventive works before coal is worked under section 33 of the Coal Mining Subsidence Act 1991.

Mine gas

None recorded within 500 metres of the enquiry boundary.

Mine water treatment schemes

None recorded within 500 metres of the enquiry boundary.

Section 3 – Licensing and future mining activity

Future underground mining

None recorded.

Coal mining licensing

None recorded within 200 metres of the enquiry boundary.

Court orders

None recorded.

Section 46 notices

No notices have been given, under section 46 of the Coal Mining Subsidence Act 1991, stating that the land is at risk of subsidence.

Withdrawal of support notices

The property is not in an area where a notice to withdraw support has been given.

The property is not in an area where a notice has been given under section 41 of the Coal Industry Act 1994, cancelling the entitlement to withdraw support.

Payments to owners of former copyhold land

The property is not in an area where a relevant notice has been published under the Coal Industry Act 1975/Coal Industry Act 1994.

Section 4 – Further information

Based on the responses in this report, no further information has been highlighted.

Future development

If development proposals are being considered, technical advice relating to both the investigation of coal and former coal mines and their treatment should be obtained before beginning work on site. All proposals should apply specialist engineering practice required for former mining areas. No development should be undertaken that intersects, disturbs or interferes with any coal or coal mines without first obtaining the permission of the Coal Authority.

MINE GAS: Please note, if there are no recorded instances of mine gas within 500m of the enquiry boundary, this does not mean that mine gas is not present within the vicinity. The Coal Authority Mine Gas data is limited to only those sites where a Mine Gas incident has been recorded. Developers should be aware that the investigation of coal seams, mine workings or mine entries may have the potential to generate and/or displace underground gases. Associated risks both to the development site and any neighbouring land or properties should be fully considered when undertaking any ground works. The need for effective measures to prevent gases migrating onto any land or into any properties, either during investigation or remediation work, or after development must also be assessed and properly addressed. In these instances, the Coal Authority recommends that a more detailed Gas Risk Assessment is undertaken by a competent assessor.

Section 5 – Data definitions

The datasets used in this report have limitations and assumptions within their results. For more guidance on the data and the results specific to the enquiry boundary, please **call us on 0345 762 6848** or **email us at groundstability@coal.gov.uk**.

Past underground coal mining

Details of all recorded underground mining relative to the enquiry boundary. Only past underground workings where the enquiry boundary is within 0.7 times the depth of the workings (zone of likely physical influence) allowing for seam inclination, will be included.

Probable unrecorded shallow workings

Areas where the Coal Authority believes there to be unrecorded coal workings that exist at or close to the surface (less than 30 metres deep).

Spine roadways at shallow depth

Connecting roadways either, working to working, or, surface to working, both in-seam and cross measures that exist at or close to the surface (less than 30 metres deep), either within or within 10 metres of the enquiry boundary.

Mine entries

Details of any shaft or adit either within, or within 100 metres of the enquiry boundary including approximate location, brief treatment details where known, the mineral worked from the mine entry and conveyance details where the mine entry has previously been sold by the Authority or its predecessors British Coal or the National Coal Board.

Abandoned mine plan catalogue numbers

Plan numbers extracted from the abandoned mines catalogue containing details of coal and other mineral abandonment plans deposited via the Mines Inspectorate in accordance with the Coal Mines Regulation Act and Metalliferous Mines Regulation Act 1872. A maximum of 9 plan extents that intersect with the enquiry boundary will be included. This does not infer that the workings and/or mine entries shown on the abandonment plan will be relevant to the site/property boundary.

Outcrops

Details of seam outcrops will be included where the enquiry boundary intersects with a conjectured or actual seam outcrop location (derived by either the British Geological Survey or the Coal Authority) or intersects with a defined 50 metres buffer on the coal (dip) side of the outcrop. An indication of whether the Coal Authority believes the seam to be of sufficient thickness and/or quality to have been worked will also be included.

Geological faults, fissures and breaklines

Geological disturbances or fractures in the bedrock. Surface fault lines (British Geological Survey derived data) and fissures and breaklines (Coal Authority derived data) intersecting with the enquiry boundary will be included. In some circumstances faults, fissures or breaklines have been known to contribute to surface subsidence damage as a consequence of underground coal mining.

Opencast mines

Opencast coal sites from which coal has been removed in the past by opencast (surface) methods and where the enquiry boundary is within 500 metres of either the licence area, site boundary, excavation area (high wall) or coaling area.

Coal Authority managed tips

Locations of disused colliery tip sites owned and managed by the Coal Authority, located within 500 metres of the enquiry boundary.

Site investigations

Details of site investigations within 50 metres of the enquiry boundary where the Coal Authority has received information relating to coal mining risk investigation and/or remediation by third parties.

Remediated sites

Sites where the Coal Authority has undertaken remedial works either within or within 50 metres of the enquiry boundary following report of a hazard relating to coal mining under the Coal Authority's Emergency Surface Hazard Call Out procedures.

Coal mining subsidence

Details of alleged coal mining subsidence claims made since 31 October 1994 either within or within 50 metres of the enquiry boundary. Where the claim relates to the enquiry boundary confirmation of whether the claim was accepted, rejected or whether liability is still being determined will be given. Where the claim has been discharged, whether this was by repair, payment of compensation or a combination of both, the value of the claim, where known, will also be given.

Details of any current 'Stop Notice' deferring remedial works or repairs affecting the property/site, and if so the date of the notice.

Details of any request made to execute preventative works before coal is worked under section 33 of the Coal Mining Subsidence Act 1991. If yes, whether any person withheld consent or failed to comply with any request to execute preventative works.

Mine gas

Reports of alleged mine gas emissions received by the Coal Authority, either within or within 500 metres of the enquiry boundary that subsequently required investigation and action by the Coal Authority to mitigate the effects of the mine gas emission. Please note, if there are no recorded instances of mine gas reported, this does not mean that mine gas is not present within the vicinity. The Coal Authority Mine Gas data is limited to only those sites where a Mine Gas incident has been recorded.

Mine water treatment schemes

Locations where the Coal Authority has constructed or operates assets that remove pollutants from mine water prior to the treated mine water being discharged into the receiving water body.

These schemes are part of the UK's strategy to meet the requirements of the Water Framework Directive. Schemes fall into 2 basic categories: Remedial – mitigating the impact of existing pollution or Preventative – preventing a future pollution incident.

Mine water treatment schemes generally consist of one or more primary settlement lagoons and one or more reed beds for secondary treatment. A small number are more specialised process treatment plants.

Future underground mining

Details of all planned underground mining relative to the enquiry boundary. Only those future workings where the enquiry boundary is within 0.7 times the depth of the workings (zone of likely physical influence) allowing for seam inclination will be included.

Coal mining licensing

Details of all licenses issued by the Coal Authority either within or within 200 metres of the enquiry boundary in relation to the under taking of surface coal mining, underground coal mining or underground coal gasification.

Court orders

Orders in respect of the working of coal under the Mines (Working Facilities and Support) Acts of 1923 and 1966 or any statutory modification or amendment thereof.

Section 46 notices

Notice of proposals relating to underground coal mining operations that have been given under section 46 of the Coal Mining Subsidence Act 1991.

Withdrawal of support notices



Published notices of entitlement to withdraw support and the date of the notice. Details of any revocation notice withdrawing the entitlement to withdraw support given under Section 41 of the Coal Industry Act 1994.

Payment to owners of former copyhold land

Relevant notices which may affect the property and any subsequent notice of retained interests in coal and coal mines, acceptance or rejection notices and whether any compensation has been paid to a claimant.

The map highlights any specific surface or subsurface features within or near to the boundary of the site.

Key

- Approximate position of the enquiry boundary shown 
- Outcrop (Conjectured) 

How to contact us
 0345 762 6848 (UK)
 +44 (0)1623 637 000 (International)
 www.groundstability.com

