

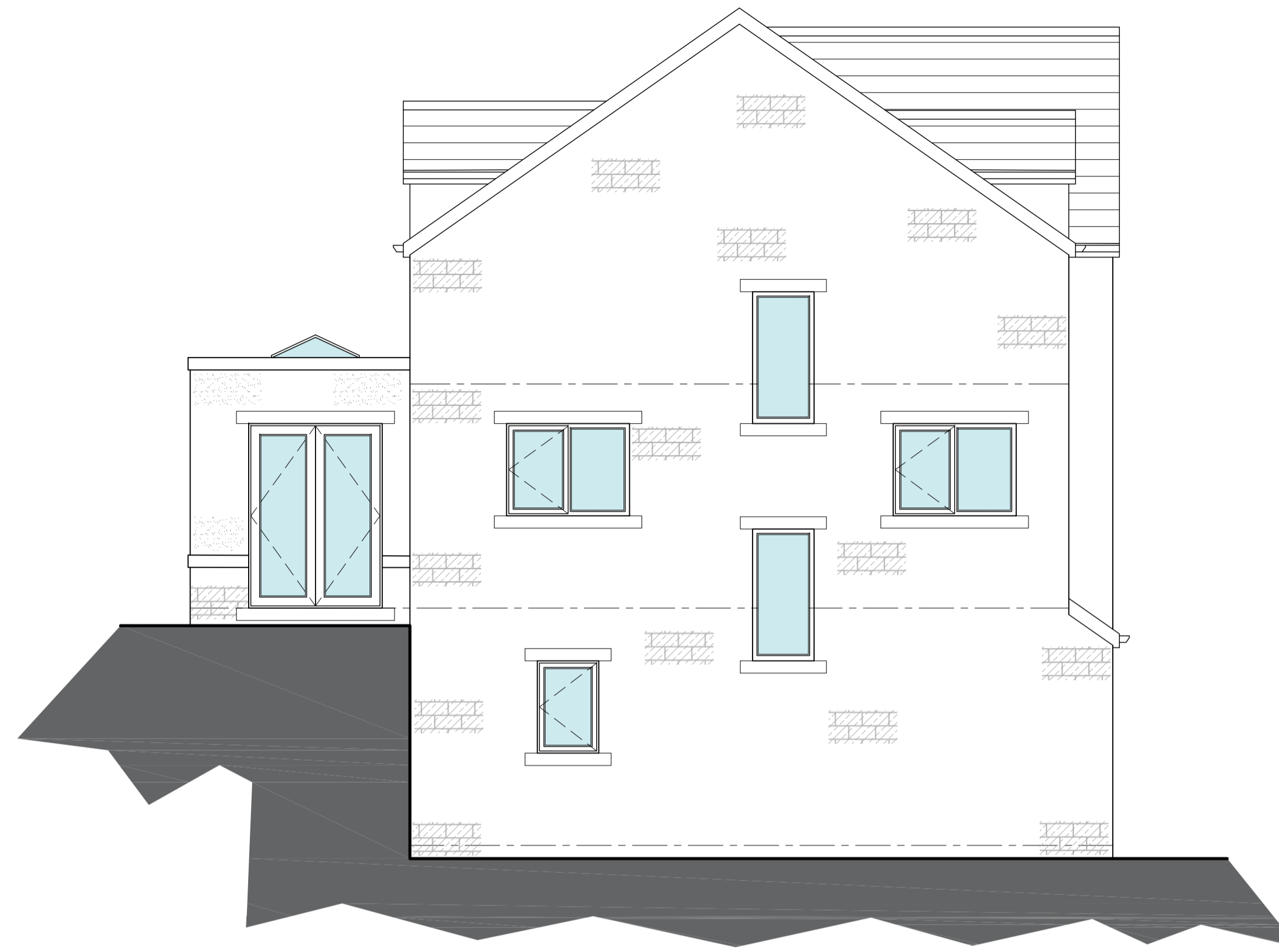

Proposed South East Facing Front Elevation
Scale 1:50



Proposed South West Facing Side Elevation
Scale 1:50



Proposed North West Facing Rear Elevation
Scale 1:50

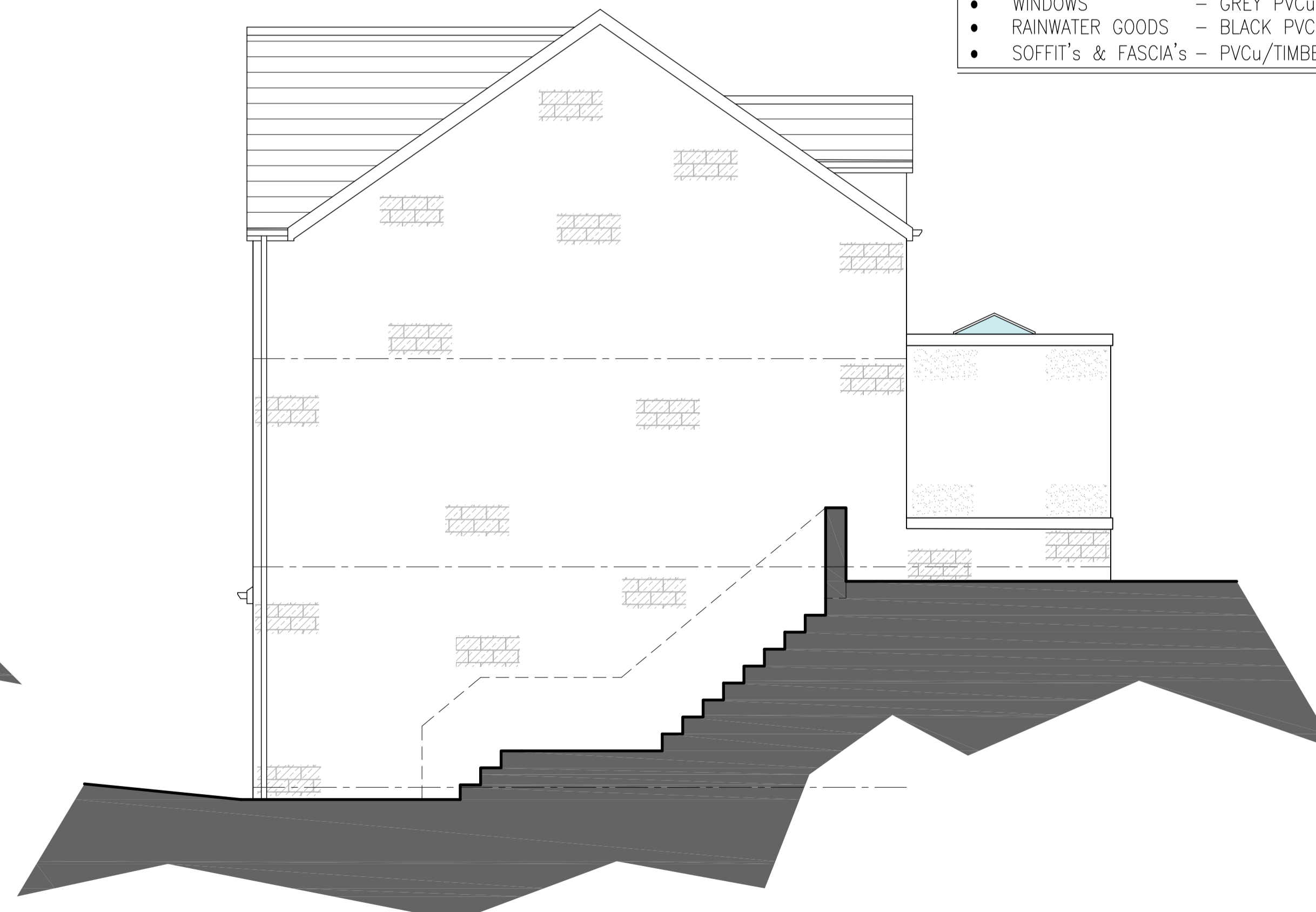

Proposed North East Facing Side Elevation
Scale 1:50

PROPOSED MATERIALS	
• MASONRY	- COURSED STONE & RENDER
• ROOF TILES	- CONCRETE TILE
• DORMERS	- STANDING SEAM
• DOORS	- GREY COMPOSITE
• WINDOWS	- GREY PVCu
• RAINWATER GOODS	- BLACK PVCu
• SOFFIT'S & FASCIA'S	- PVCu/TIMBER

NOTES

1. No dimensions to be scaled. IF IN DOUBT ASK.
2. All dimensions must be checked and verified on site by the Contractor prior to the commencement of works and Hinchliffe Architecture & Design Ltd. to be notified of any discrepancies.
3. The copyright of these drawings remains the property of Hinchliffe Architecture & Design Ltd. They must not be reproduced in any way without prior written consent from the originator (Hinchliffe Architecture & Design Ltd.)

C	02/25	ELEVATIONS AMENDED
B	10/25	LEVELS UPDATED
A	18/25	FIRST ISSUE
Rev.	Date	Description

Status **PLANNING**

hinchliffe
 architecture & design

Hinchliffe A&D
 24 Carr View Road
 Heptonstall
 West Yorkshire
 HX9 7JL

01921 907 762
 01484 620 764
 info@hinch-architecture.co.uk
 www.hinch-architecture.co.uk

Client **FHH DEVELOPMENTS LTD.**

Project **274 CUMBERWORTH LANE
 DENBY DALE
 HUDDERSFIELD
 WEST YORKSHIRE
 HD8 8QS**

Drawing Title
**LOT 2
 PROPOSED ELEVATIONS**

Scale (at A1)	Date
AS SHOWN	JUNE' 2025

Drg. no.	Rev.
290-25-PL05	C