

Harron Homes

Land off Roslyn Avenue,
Netherton, Huddersfield

Stage 1 Road Safety Audit

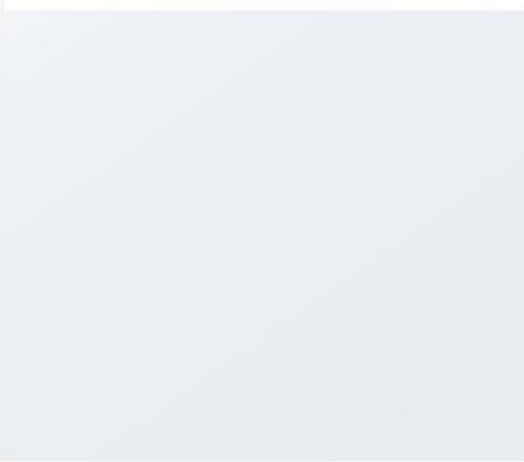

Control Sheet

CLIENT: Harron Homes
PROJECT TITLE: Land off Roslyn Avenue
 Netherton, Huddersfield
REPORT TITLE: Stage 1 Road Safety Audit
PROJECT REFERENCE: 400187
DOCUMENT NUMBER: 001
ISSUE NUMBER: 01
DATE: March 2026

Issue & Approval Schedule	Issue 01 Final		Name		Signature		Date	
	Prepared by		David Ramsden		A signed copy is available on request		4 th March 2026	
	Checked by		Ashley Armitage				5 th March 2026	
	Approved by							
Issue Record	Issue	Date	Status	Description	Name			
	02				Prepared			
					Checked			
					Approved			
	03				Prepared			
					Checked			
Approved								

Sanderson Associates Consulting Engineers is a trading name of Fairhurst Group LLP, a limited liability partnership registered in Scotland with the registered number SO307306 and registered office at 43 George Street, Edinburgh EH2 2HT.

This document has been prepared in accordance with the Fairhurst Quality and Environmental Management System and in accordance with the instructions of the client, Harron Homes, for the client's sole and specific use. Any other persons who use any information contained herein do so at their own risk. Any information provided by third parties and referred to herein has not been checked or verified by Fairhurst unless otherwise expressly stated within this report.

Unless otherwise agreed in writing, all intellectual property rights in, or arising out of, or in connection with this report, are owned by Fairhurst. The client named above has a licence to copy and use this report only for the purposes for which it was provided. The licence to use and copy this report is subject to other terms and conditions agreed between Fairhurst and the client.

Contents

1. Introduction.....	4
2. Items Raised from Previous Road Safety Audit.....	6
3. Items Raised for this Stage 1 Road Safety Audit	7
4. Audit Team Statement	8

List of Appendices

Appendix A

Marked Up Plan for the Stage 1 RSA

Project Summary

Report title:	Stage 1 Road Safety Audit
Date:	6 th March 2026
Document reference and revision:	400187-001-01
Prepared by:	Sanderson Associates
On behalf of:	Kirklees
	Council (Overseeing Organisation)

1. Introduction

- 1.1 Sanderson Associates Consulting Engineers has been appointed by Harron Homes to carry out a Stage 1 Road Safety Audit (RSA) of Land off Roslyn Avenue, Netherton, Huddersfield. The nearest postcode to the site is HD4 7EW.
- 1.2 This Stage 1 Road Safety Audit was instructed by Peter Maurice of Fairhurst Group LLP T/A Sanderson Associates on behalf of Harron Homes on the 24/02/2026. The Highway Authority is Kirklees Council.
- 1.3 A Stage 1 Road Safety Audit Brief has been prepared by Optima Intelligent Highways Solutions on behalf of Harron Homes for the project dated 17/02/2026 which was approved by the Overseeing Organisation (Kirklees Council) on 17/02/2026. A copy of the Audit Brief and supporting information was issued to the Audit Team on 24/02/2026.
- 1.4 The Audit Team members are as follows:
- Audit Team Leader: David Ramsden DipASM, CertAI, FIHE, FARRM, Consultant Road Safety Engineer at Sanderson Associates
 - Audit Team Member: Ashley Armitage MIHE, Senior Engineer at Sanderson Associates
- 1.5 The following S38 drawings and information has been used for Audit purposes.
- Drawings and reports prepared by Harron Homes, Elston Engineering and Optima Highways.
- 02 Rev:- - Location Plan
 - 03 Rev:C – Materials Plan
 - 06 Rev:B – Boundary Treatment Plan
 - 07 Rev:B – Affordable Housing Plan
 - PL01 Rev:G – Site Layout
 - PL-021 Rev:A – Site Cross Sections
 - EE100008-200 – Section 38 Layout Plan
 - EE100008-215 – Longitudinal Sections
 - EE100008-301 – Proposed Highways Plan
 - EE100008-306 – Highways Area Plan
 - 260217 Roslyn Avenue, Netherton – Road Safety Audit Brief (Rev3)
 - Traffic Flow Diagrams
 - 25041-ATR-01-E – Swept Path Analysis (Refuse Vehicle)
 - 25041-ATR-02-E – Swept Path Analysis (Delivery Vehicle)
 - 25041-IN-01-C – Junction Visibility Splays (20mph requirements)
 - 25041-IN-02-C – Junction Visibility Splays (30mph requirements)
 - 23046/GA/01 – Off-site improvements (for information purposes only)
- 1.6 The proposed S38 highway works are shown on drawing EE100008-200 and relate to the internal road network of a proposed residential housing development comprising of 82 dwellings. Any S278 works are not included in this road safety audit.

- 1.7 A review of the MAVRIC database was conducted to assess the road safety record in the vicinity of the proposed development. This interrogation of verified collision data, covering the most recent five-year period, confirms that no recorded personal injury collisions have occurred at, or within a 100-metre radius of the proposed site access point off Roslyn Avenue.
- 1.8 The nearest recorded incident occurred approximately 200 metres to the north-east at the junction of Roslyn Avenue and Chapel Street. This collision involved two pedestrians, aged 66 and 72; however, given the distance from the site, it is not considered relevant to the current development proposal. The lack of recent activity in the immediate vicinity suggests that the local highway geometry currently operates with a high degree of safety.
- 1.9 The Audit took place on site on 26/02/2026 at 1pm. During the site visit the weather was light rain. The road surface was wet. Vehicle, pedestrian and cycle flows appeared normal for the type of area. No incidents were observed on the street.
- 1.10 The terms of reference of the Road Safety Audit are as described in GG119. The team has examined the works and reported only on the road safety implications of the scheme as presented and has not examined or verified the compliance of the works to any other criteria.
- 1.11 All of the problems described in Section 3 of this report are considered by the Audit Team to require action in order to improve the safety of the scheme. However, any recommendation included within this report should not be regarded as being a prescriptive design solution to the problem raised. They are intended only to indicate a proportionate means of eliminating or mitigating the identified problem. It is noted that there may be alternative methods of addressing a problem that would be equally acceptable in achieving the desired elimination or mitigation and these should be considered when responding to this report.
- 1.12 Marked-up plans are included at **Appendix A**, which identifies the approximate location of problems that have been raised. General problems or those with multiple locations have not all been shown.
- 1.13 Following the completion of the Road Safety Audit, the design team should prepare a '*Road Safety Audit Response Report*' in collaboration with the Overseeing Organisation. The response report should incorporate the following:
- Decision Log spreadsheet, where each Problem and Recommendation in the Road Safety Audit report is reiterated;
 - In the Decision Log, a response should be provided by the Design Team and then by the Overseeing Organisation for each problem raised. This should then be followed by an agreed action.

Further information to assist the preparation of the Road Safety Audit Response Report is provided in **GG119 Sections 4.11 to 4.19 and Appendix F** (that includes a Road Safety Audit Response Report template). In accordance with GG119, the response report should be produced and finalised within one month of the issue of the Road Safety Audit report. A copy of the response report should be issued to the Road Safety Audit Team for information.

2. Items Raised from Previous Road Safety Audit

- 2.1 No previous road safety audits have been carried out on the proposals as presented.

3. Items Raised for this Stage 1 Road Safety Audit

- 3.1 The problems that are raised in the stage 1 Road Safety Audit are presented in this section. A copy of marked-up plans showing stage 1 RSA problem locations is included in **Appendix A** of this Audit Report.

Problem 3.1:

Location: Junction adjacent to Plot 67.

Summary: Lack of dropped crossing.

Detail: Proposed dropped kerb pedestrian crossing facilities are indicated on the Section 38 Layout Plan at the majority of significant junctions within the development. However, no dropped crossing provision is shown at the junction located at the north-east end of the loop road. There is a footpath link to and from the development adjacent to Plot 67 that connects to this junction, which is likely to generate pedestrian movements across the carriageway at this location. The absence of a dropped crossing may therefore result in an inconsistent level of pedestrian provision and may create difficulties for mobility-impaired users, wheelchair users, and those with pushchairs attempting to cross the carriageway. This may discourage pedestrians from using the footway network as intended or lead to informal crossing at locations without appropriate tactile paving or level access.

Recommendation: It is recommended that a dropped kerb pedestrian crossing point be included in the design at this junction including appropriate tactile paving.

4. Audit Team Statement

4.1 We certify that the terms of reference of the audit are as described in GG119.

Audit Team Leader:

David Ramsden DipASM, CertAI, FIHE, FARRM

Consultant Road Safety Engineer at Sanderson Associates Consulting Engineers

Signed:  Dated: 4th March 2026

Audit Team Member:

Ashley Armitage MIHE

Senior Engineer at Sanderson Associates Consulting Engineers

Signed:  A. Armitage Dated: 5th March 2026



Appendix A

Marked Up Plan for the Stage 1 RSA

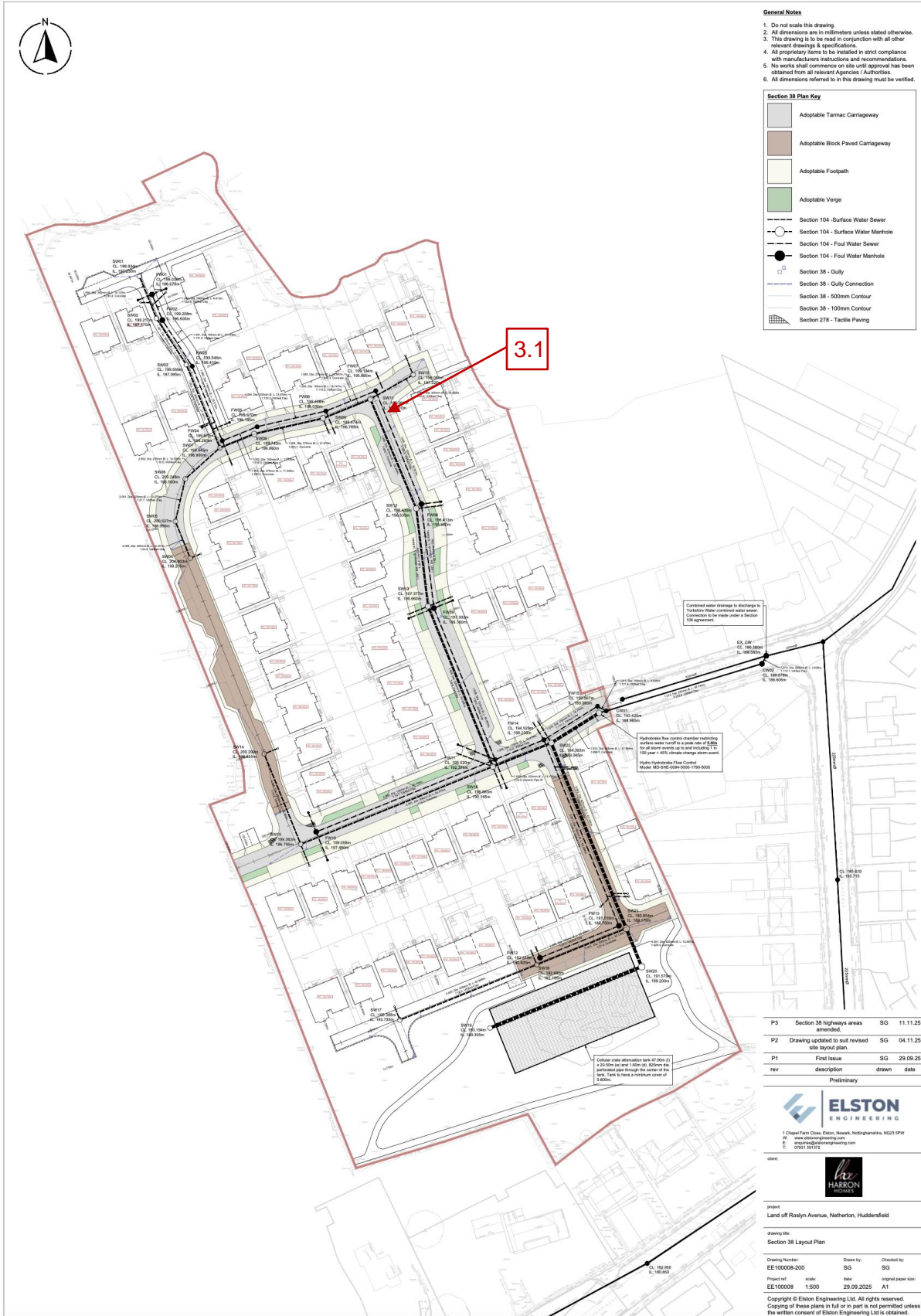

📍 Sanderson House, Jubilee Way, Grange Moor,
Huddersfield, WF4 4TD

☎ 01924 844080

✉ mail@sandersonassociates.co.uk

🌐 www.sandersonassociates.co.uk

CIVIL ENGINEERING • STRUCTURAL ENGINEERING • TRANSPORTATION • ROADS & BRIDGES
PORTS & HARBOURS • GEOTECHNICAL & ENVIRONMENTAL ENGINEERING • PLANNING &
DEVELOPMENT • WATER SERVICES • HEALTH & SAFETY / CDM SERVICES

