

BARBARA HEPWORTH BUILDING

Existing Refuge Point Sign

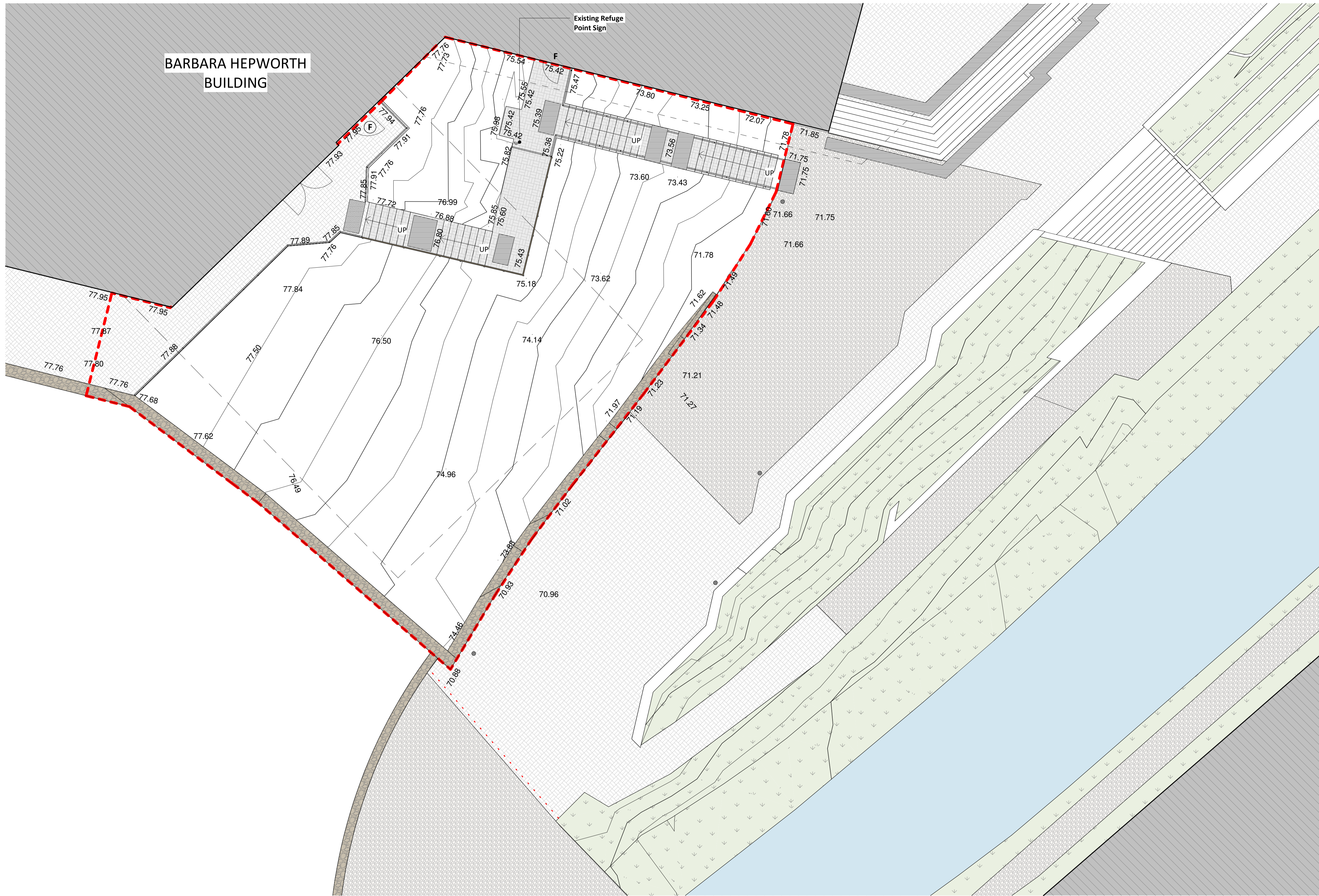

**1. Existing GA Plan (BH)**  
SCALE - 1 : 100@A1

1:100 Scale 0 1m 2m 5m 10m

Legend

- Site Boundaries
- Existing Tactile Paving
- Existing Grass Areas
- Existing Steel Balustrade
- Existing Wood Balustrade
- Existing Buildings
- Existing Canal
- Existing Overhang
- Existing Cobbles
- Existing Ancheson Glover Plaza Paving Block
- Listed Stone Wall
- Existing Seating
- Existing Lighting
- Existing Granite Blockwork
- F Existing Fire Doors
- Existing Vehical barrier/ Emergency and maintenace vehical gate

Key Plan

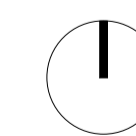

**GSSarchitecture**  
KETERING | GLOUCESTER | HARRGATE | LEEDS | MILTON KEYNES | NEWCASTLE

Project Title:  
Campus Landscaping Schemes  
Client:  
University of Huddersfield  
Drawing Title:  
Existing GA Plan (BH)

Drawn By: AMG	Checked By: CJPW	Scale @A1: 1 : 100	Date: 09/12/2024
Status: Preliminary Issue	File No: UNI049H		Rev: P02

P02	10.02.25	AMG	CJPW	Planning Issue. For Design Team Comments.
P01	19.12.24	AMG	CJPW	Preliminary Issue
Rev	Date	Drn	Chk	Description

This drawing is purely for discussion purposes only. It is not to be taken as a proposal for construction detailing, and instead it is primarily intended to convey the overall spatial layout of the building or parts of it. Please refer to the developed production information drawings for detail, construction and measurement purposes. Do not scale from this drawing for construction or acquisition purposes. Responsibility is not accepted for errors made by others in scaling from this drawing. All construction information must be taken from figured dimensions only. All dimensions and levels must be checked on site and discrepancies between drawings and specification must be reported to GSSArchitecture. © Copyright GSSArchitecture. Ordnance Survey © Crown Copyright 2024. All rights reserved. Licence number GSS 100017356. Map Data Copyright 2024 Google. Registered Office: 35 Headlands, Kettering, Northants, NN15 7ES. Tel: 01536 513 165. Email: studio@gssarchitecture.com