

Bradley Villa - Schedule of Accomodation Private DWH product						
HT Name	Floor Area (Sqm)	Beds	Storeys	Total	Total Sqm	% of Mix
Primrose	71.35	2	2	20	1426.99	19.2
Alder	89.74	3	2	6	538.47	5.8
Foxglove	103.68	3	2	1	103.68	1.0
Hazelborough	108.05	3	2	3	324.14	2.9
Thornhill	124.30	4	2	8	994.43	7.7
Winterton	125.79	4	2	3	377.37	2.9
Lynford	132.20	4	2	8	1057.61	7.7
Hepburn	134.15	4	2	14	1878.13	13.5
Sudbury	124.77	3	3	2	249.54	1.9
Loughton Apartment (1.4.7)	43.29	1	1	3	129.88	2.9
Coleford Apartment (2.5.8)	61.97	2	1	3	185.90	2.9
Homsea Apartments (3.6.9)	61.50	2	1	3	184.51	2.9
Sub-Total				74	7450.63	71.2

Affordable						
HT Name	Floor Area (Sqm)	Beds	Storeys	Total	Total Sqm	% of Mix
YH 50	81.85	2	2	6	491.09	5.8
YH 50 (Mid)	81.85	2	2	1	81.85	1.0
YH52	96.15	3	2	8	769.24	7.7
YH54	108.42	4	2	2	216.84	1.9
Alder	89.74	3	2	4	358.98	3.8
Loughton Apartment (1.4.7)	43.29	1	1	3	129.88	2.9
Coleford Apartment (2.5.8)	61.97	2	1	3	185.90	2.9
Homsea Apartments (3.6.9)	61.50	2	1	3	184.51	2.9
Sub-Total				30	2418.27	28.8

Grand Total				104	9868.9	100.0
--------------------	--	--	--	------------	---------------	--------------

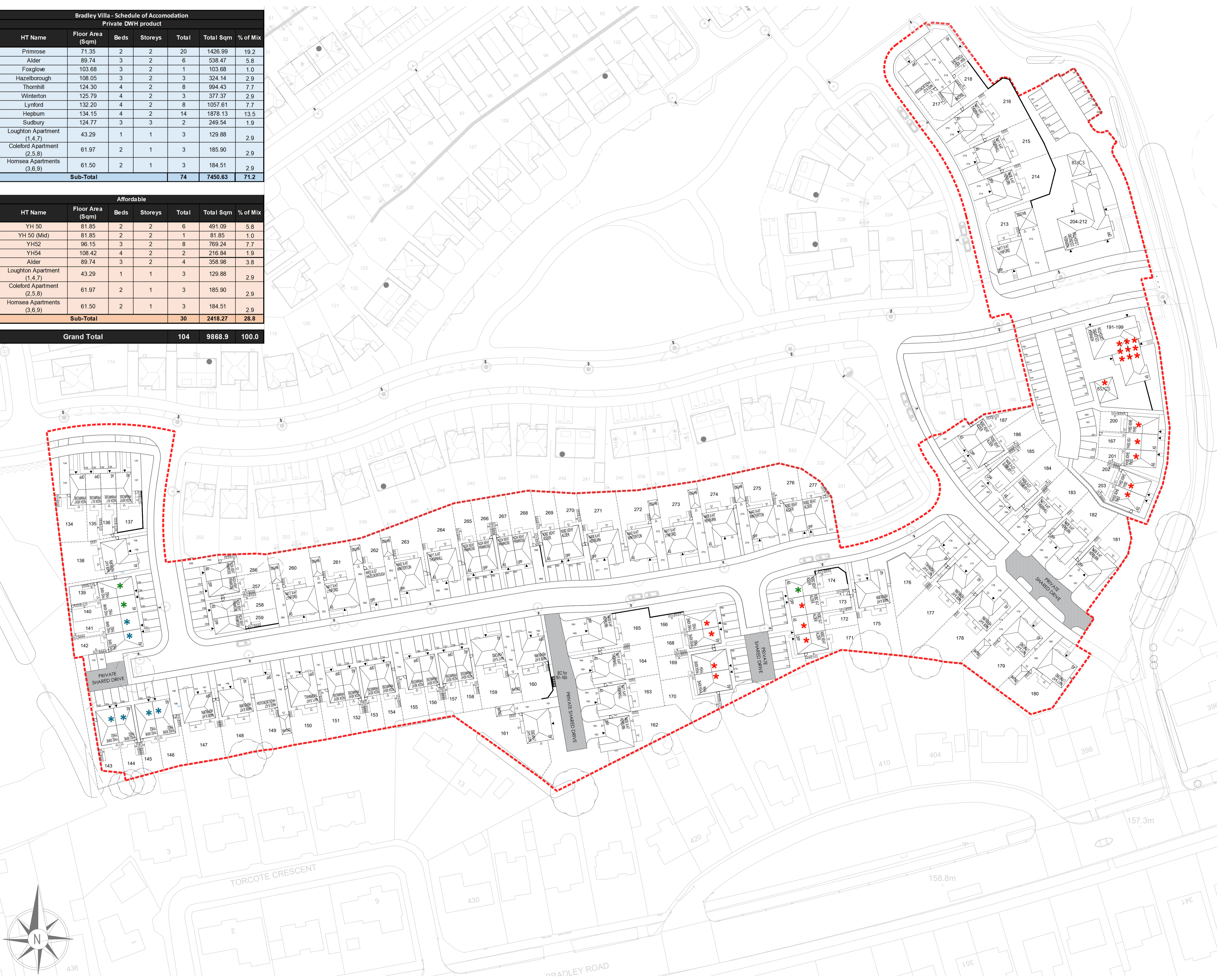

- NOTES:**
- ALL DIMENSIONS ARE IN MILLIMETRES, UNLESS STATED OTHERWISE.
 - DO NOT SCALE FROM THIS DRAWING.
 - ALL DIMENSIONS TO BE VERIFIED ON SITE BEFORE CONSTRUCTION COMMENCES.
 - OPPOSING OPTIONAL WINDOWS CANNOT BE APPLIED WHERE THE DISTANCE BETWEEN OPTIONAL SIDE WINDOWS IS 1000mm OR LESS.
 - EXISTING SERVICE RUNS TO BE VERIFIED BY SITE INSPECTION.
 - THIS DRAWING IS FOR INFORMATION ONLY AND ALL INDIVIDUAL PACKAGE DRAWINGS SHOULD BE REVIEWED IN TANDEM WITH THIS DRAWING.
 - REFER TO ALL ENGINEERING DRAWINGS FOR LEVELS, RETAINING WALLS ETC.
 - CONTACT THE TECHNICAL TEAM FOR ANY QUERIES OR DISCREPANCIES.

- TECHNICAL LAYOUT LEGEND:**
- Social Rent Housing
 - Intermediate Rent Housing
 - First Home Affordable
 - 1.8m high BRICK pier and panel wall with infill fence panels
 - 1.8m high close boarded timber screen fence
 - 0.45m high timber knee rail
 - Adopted road - Tarmac with footpath to both sides
 - Adopted road - Tarmac with footpath and block paved hard margin to other side
 - Front entrance door
 - Secondary entrance
 - Paved patio (refer to schedule)
 - Herringbone block paving (All drives except for 134-137 to be block paved)
 - Side window positions
 - Indicative Bin Collection Point for plots off shared drives
 - Timber cycle store
 - Lockable personal gate
 - Visitor Parking bay
 - Indicates on Street Visitor Parking
 - Existing Tree/Hedge to be removed.
 - Indicative Landscaping. Refer to external landscaping drawings.

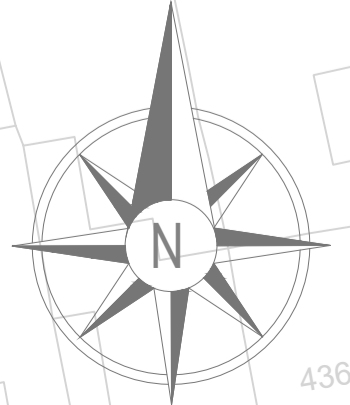

07	Revised layout to notes	19/02/2024
06	Revised layout	13/02/2024
05	Plot 142 Housing Amendment	15/01/2024
04	Apartment Block Houseplans updated	09/01/2024
03	Plot 142 - 202 amended landscaping and houseplan	17/11/2023
02	Revised to include revised plot and apartment house updated	23/10/2023
01	First Issue for Information	22/07/2023



For Information						
Project						
Bradley Villa Bradford Road, Huddersfield HD2 2RG						
Title						
BDW Site Planning Layout Plan						
Drawn	Scale	Checked	Date			
HABBS-BDW-XX-DR-AR-203807	07	1:500BA1	ON	JP	07/25	