

KEY

- Section 104 Adoptable Foul Sewer ● - - -
- Section 104 Surface Water Sewer ● - - -
- Private Foul Drain ○ - - -
- Private Surface Water Drain ○ - - -
- Existing Foul Sewer ○ - - -
- Sewer Easement
- Site Boundary —
- Road Gully & 150mmØ Drain ○ - - -
- Rainwater Pipe, Rodding Eye RWP, RE ○ - - -
- Foul Connection (svp, ss, sink, etc) FW ○ - - -

NOTES

1. THE PROPOSED ADOPTABLE DRAINAGE IS SUBJECT TO S104 AGREEMENT WITH YORKSHIRE WATER.
2. THIS DRAWING SHOULD BE READ IN CONJUNCTION WITH ALL RELEVANT ENGINEERS' AND ARCHITECTS' DRAWINGS.
3. THE ADOPTABLE FOUL & SURFACE WATER SEWERS ARE TO BE CONSTRUCTED IN ACCORDANCE WITH THE DESIGN AND CONSTRUCTION GUIDANCE (APPENDIX C, SEWERAGE SECTOR GUIDANCE), THE CIVIL ENGINEERING SPECIFICATION FOR THE WATER INDUSTRY (7TH EDITION) AND YORKSHIRE WATER REQUIREMENTS.
4. ALL SEWER CONSTRUCTION MATERIALS SHALL BE BS KITE MARKED.
5. ROOT BARRIER PROTECTION IS TO BE PROVIDED FOR ANY SEWERS LOCATED WITHIN TREE CANOPY AREAS.
6. A PROTECTIVE GEOTEXTILE / PLASTIC MEMBRANE IS TO BE APPLIED TO ALL FOUL SEWERS LAID ABOVE STORMWATER PIPES.
7. ALL ROAD GULLY DRAINS TO BE 150mmØ AND ENCASED IN 150mm CONCRETE SURROUND AT JUNCTION WITH MAIN SEWER.
8. BENDS ON GULLY LATERALS TO BE NO GREATER THAN 22.5°.
9. UNLESS OTHERWISE INDICATED, PRIVATE FOUL DRAINS WILL BE 100mmØ LAID AT 1.80 MINIMUM GRADIENT; PRIVATE SURFACE WATER DRAINS WILL BE 150mmØ LAID AT 1.50 MINIMUM GRADIENT.

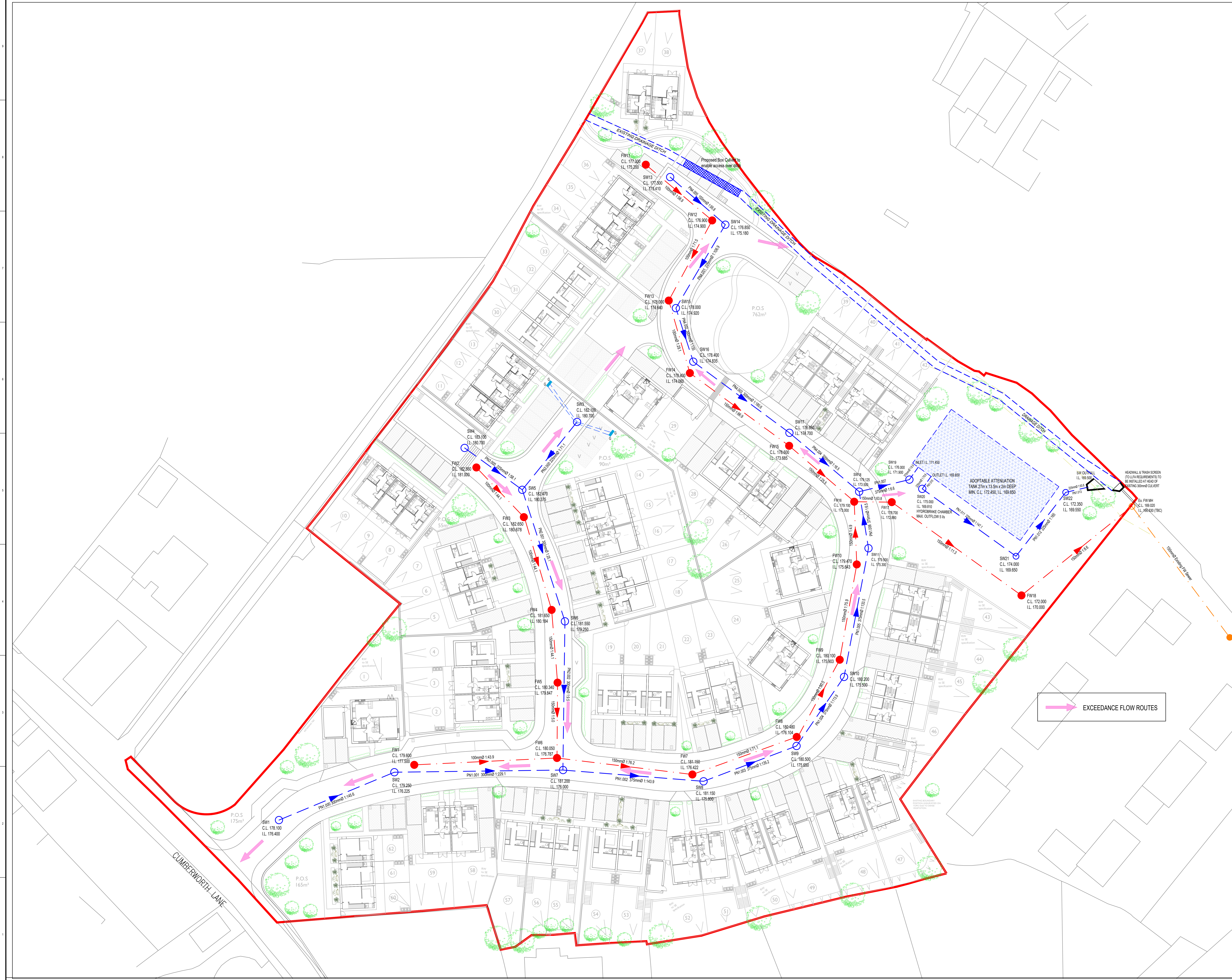

EXCEEDANCE FLOW ROUTES

rev.	date	description	Drawn	Checkd
E	11.07.23	Site plan updated and drainage adjusted to suit.	DM	WEN
D	24.04.23	Site plan updated and drainage adjusted to suit.	DM	WEN
C	02.11.22	Site plan and drainage layout revised to take into account existing drainage assets to the north.	DM	WEN
B	23.09.22	Site plan updated and drainage adjusted to suit.	DM	WEN
A	13.09.22	Rural outflow restricted to 5 l/s; attenuation basin increased with additional attenuation tank.	DM	WEN
-	29.04.22	Preliminary issue.	DM	WEN

WARD & COLE
consulting engineers

Lincoln London Nottingham

Force House
Roman Wharf
Lincoln
LN1 1SR
tel 01522 513032 fax 01522 513559
e-mail structures@wardcole-lincoln.co.uk

client:
Urban Developments Ltd

project:
Denby Dale, Huddersfield

drawing title:
Proposed Drainage Layout

scale: 1:250 (A0)	status: Planning
job number: 10-5610	drawing number: 500
	revision: E