

Bryan G Hall Ltd. Registered in England & Wales Co No. 4104892

This drawing is copyright and shall not be reproduced or used for any other purpose without the written permission of the Bryan G Hall Ltd. This drawing must be read in conjunction with all other related drawings and documentation.

It is the contractor's responsibility to ensure full compliance with the Building Regulations. Do not scale from this drawing, use figured dimensions only. It is the contractor's responsibility to check and verify all dimensions on site. Any discrepancies to be reported immediately.

IF IN DOUBT ASK

Materials not in conformity with relevant British or European Standards/Codes of practice or materials known to be deleterious to health & safety must not be used or specified on this project.

Bryan G Hall Limited has not checked or verified, and shall therefore not be liable for any inaccuracies which may be attributable to any base plan(s) reports, data or information which may be furnished to the client, or purchased by the contractor on the client's behalf, that may have been utilised within this drawing.

Bryan G Hall Limited shall not be liable for the use of this or any associated documents, for any purpose, by any person other than that for which they were provided.

It remains the client's and/or its appointed contractor's responsibility to check for any discrepancies. Any anomalies discovered must be reported immediately to Bryan G Hall Limited for verification.

The locations of utilities apparatus, if shown, have been reproduced from plans supplied to Bryan G Hall Limited. Although care has been taken where duplicating this information, these locations are approximate only. No guarantee can be given by Bryan G Hall Limited for their accuracy. It is the client or its appointed agent/contractor's responsibility to verify the exact locations on site by appropriate means prior to mechanical excavation.

KEY:

- FFL-7.200 Proposed Finished Floor Level
- GFLL-7.200 Proposed Garage Finished Floor Level
- Existing Site Spot Level
- Proposed Carriageway Contour 500mm Major, 100mm Minor
- Proposed Level
- Proposed Gradient
- Proposed External Steps (Typical 300 steps, 150mm risers)
- Proposed Embankment Steeper than 1 in 10m
- Exposed Brickwork and Maximum Height (measured from 150mm below FFL)
- Proposed Tanking and Maximum Height (measured from 150mm below FFL)
- Proposed Retaining Structure - Geowall GWR Ground Mass Plus GWR Groundwater Table Bar GWR Groundwater Table Force
- Proposed Retaining Structure - Stone to Match Plot
- Proposed Retaining Structure - Stone to Match Plot
- Proposed Retaining Structure - Sheet Pile
- Proposed Retaining Structure - L Shape for Split Levels
- Proposed Retaining Structure - MACWALL MBR Ground Mass Plus MBR Groundwater Table Bar MBR Groundwater Table Force
- Proposed Retaining Structure - L Shape Wall
- Proposed Highway Gully and 150mm Ø Connection
- ACO drainage Channel or Similar
- Yard Gully

NOTES:

- All retaining walls to frontage areas 600mm or greater are to have a handrail.

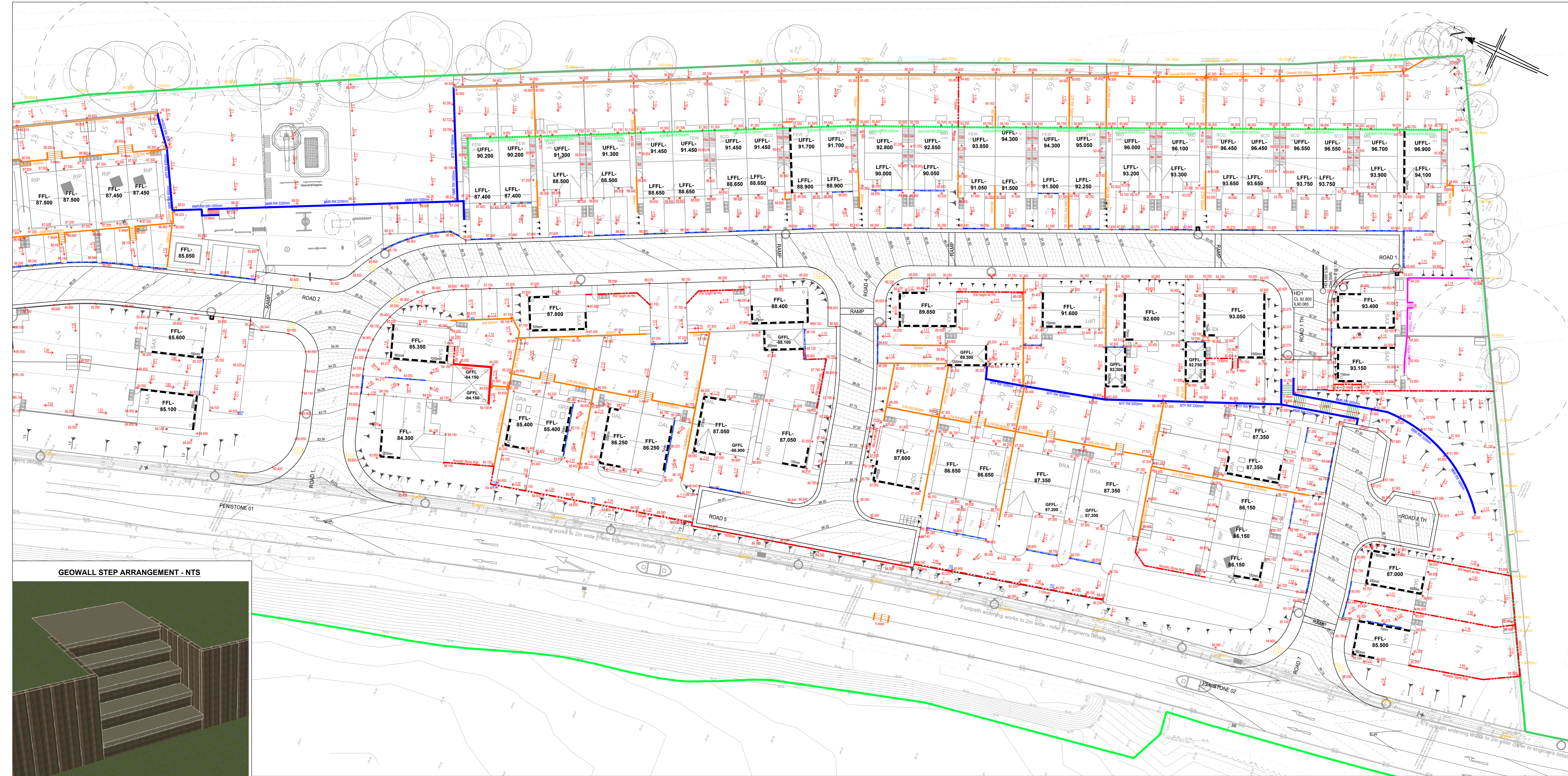

GEOWALL STEP ARRANGEMENT - NTS

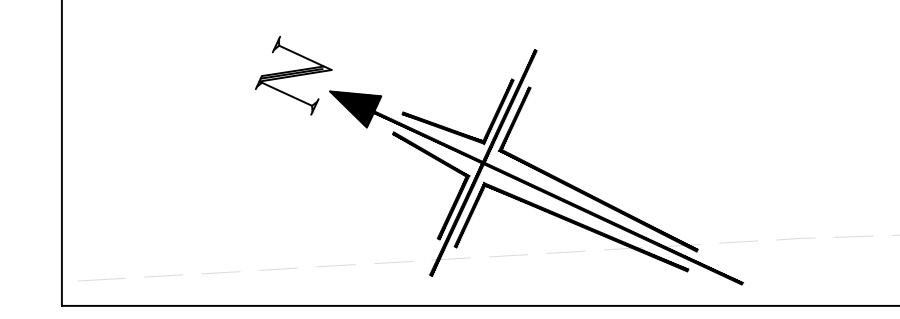
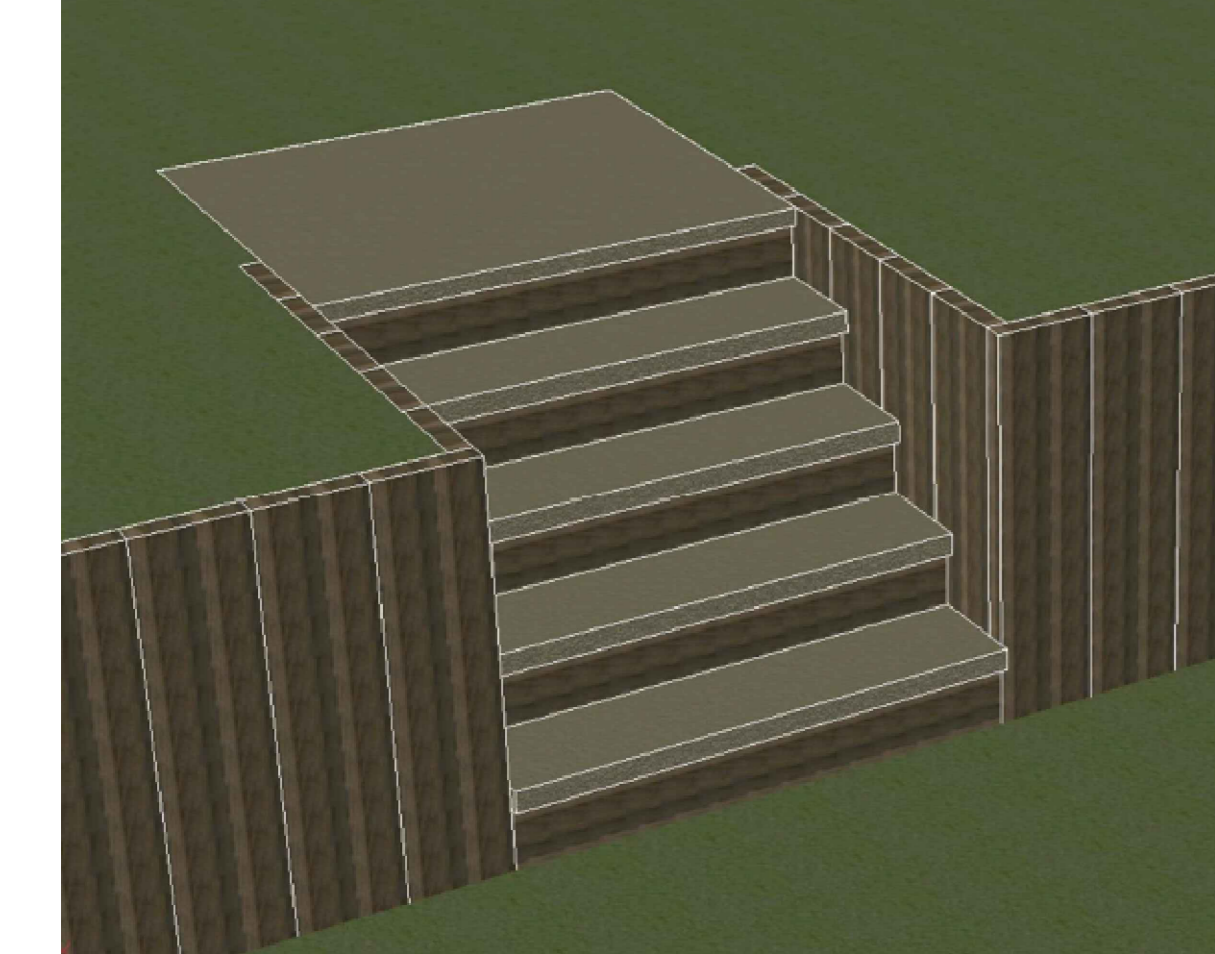

HEALTH AND SAFETY CONSTRUCTION DESIGN MANAGEMENT			
Roads, Sewer, & External Works Hazard Identification Schedule			
	LOW	MEDIUM	HIGH
Design Hazard Identified	Design Hazard Identified		
Working near live underground services	Ensure works are protected by the appropriate means and signed correctly. Operatives to hand dig where services are known to be present		
Working near live overhead services	Appropriate working methods to be employed in proximity to the overhead cables and early coordination with the Statutory undertakers		
Excavation	Appropriate methods of working to be used to reduce risk of trench collapse		
Contamination	If any contaminated material is found it shall be removed and placed in an appropriate area and barriered off, until such time as it can be taken away to a registered tip.		
Working Next to Live Highway and Pedestrians	Appropriate traffic management to Chapter 8 put in place to ensure safe working areas		
Contamination to watercourse or other water bodies	Ensure appropriate barriers and safety measures are installed to minimise any contaminated runoff into the existing watercourse		
Working At Height	Ensure appropriate methods of working are utilised to reduce risk of falls from height		
NOTES:	Retaining Walls: The retaining walls indicated on these plans are shown as an indication of the approximate retained height at that location. They are not detailed designs. The final retaining structure at these locations should consider the associated residual risks including falls from height, protection from vehicle impact and overturn and ongoing maintenance and operation.		

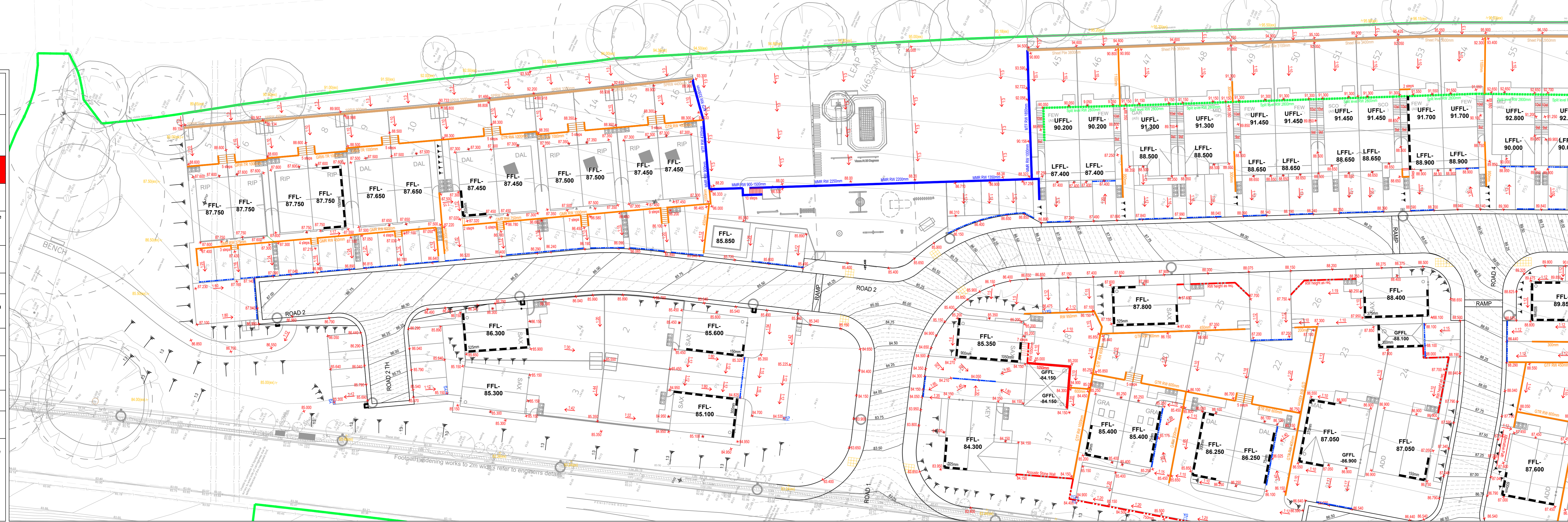

L	19.08.25	New site layout 2078-001 Rev 1 received 13.08.25 incorporated into layout and associated details updated.	J	NB	IE
K	28.05.25	New site layout Rev 5 received 28.05.25 and associated details updated.	NB	IE	
J	10.01.25	Details updated following Kirkless comments dated 10.01.25.	NB	IE	
I	18.12.24	Garage tanking reduced at plots 17 as per Newett Homes comments / search dated 18.12.24.	NB	IE	
H	29.11.24	Updated as per Newett Homes comments dated 28.11.24.	NB	IE	
G	21.11.24	Updated as per Newett Homes comments dated 21.11.24.	NB	IE	
F	07.11.24	Newett Homes external works details updated following VE exercise received 07.11.24.	IE	NB	
E	21.06.24	Newett Homes external works details updated following VE exercise received 18.06.24.	IE	NB	
D	22.02.24	Newett Homes external works details updated following VE exercise received 05.02.24.	NB	IE	
C	07.12.23	Drainage reviewed and associated details updated where necessary.	NB	IE	
B	27.09.23	Site layout updated to latest drawing 2078-002 revision N. Three lost gardens removed at plots 11-16.	IE	NB	
A	07.09.23	Site layout updated to latest drawing revision M. External works updated following comments from Newett Homes dated 25.08.23.	NB	IE	

BRYAN G HALL
CONSULTING CIVIL & TRANSPORTATION PLANNING ENGINEERS

LEDS 0113 246 1355 LONDON 0203 552336

Suite E15 | Josephs Wall | www.bryanghall.co.uk
Honeywell Work | LEEDS | LS3 1AB | info@bryanghall.co.uk

Client: Newett Homes

Status:
Scale: 1:250
Size: A0 - 1189 x 841
Drawn: NB
CHK: IE
Appr:
Project: Residential Development
Penistone Road, Fenay Bridge
Title: External Works

Drawing No: 22491/EXT/001 Revision: L
Job No: 22-491 Date: 06.02.23

smas CHAS
WORKSAFE
Bryan G Hall Ltd.

Copyright Reserved Bryan G Hall Ltd.