

D:\ONEDRIVE\ATTP\23004- DIXON HALL, GRAFTON STREET, BATLEY\23004_SPA_001.DWG

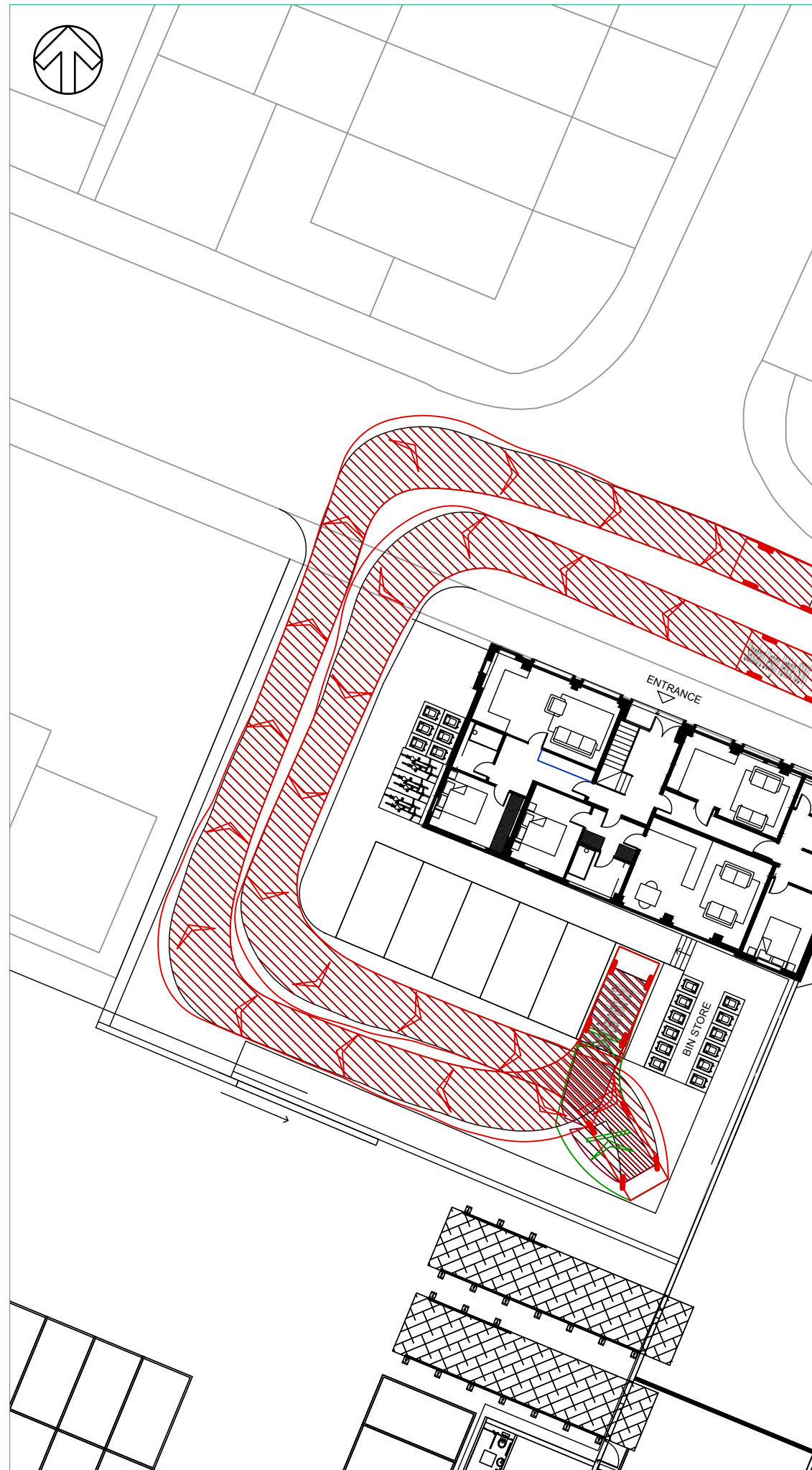

DO NOT SCALE

VEHICLE DETAILS

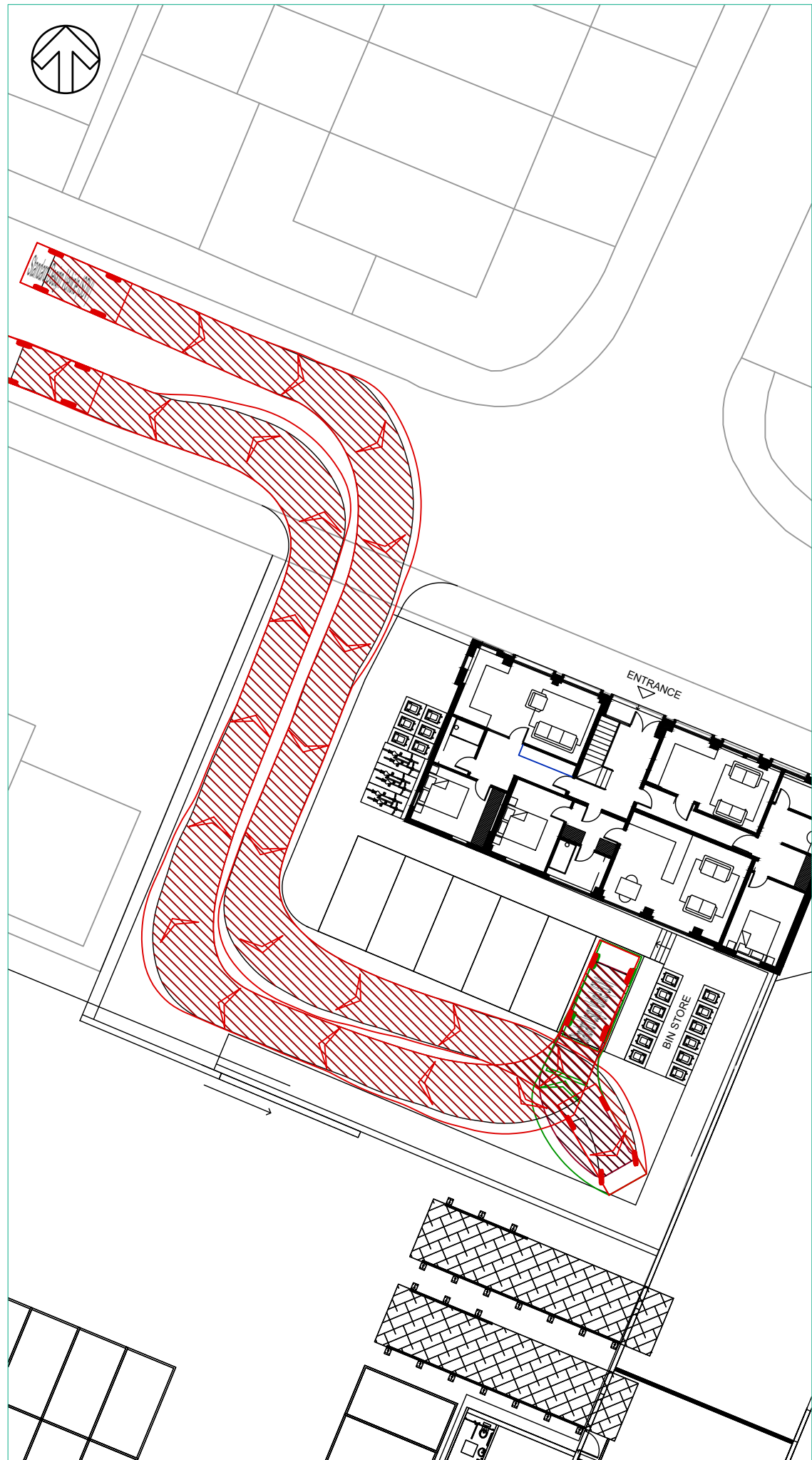
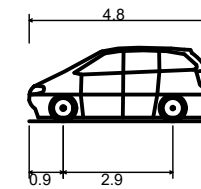

Standard Design Vehicle (SDV)	
Overall Length	4.800m
Overall Width	2.000m
Overall Body Height	1.950m
Min Body Ground Clearance	0.100m
Track Width	2.000m
Lock to lock time	4.00s
Wall to Wall Turning Radius	6.000m

REV	DATE	BY	DESCRIPTION	CHK	APP
A	06/09/2023	TS	SITE LAYOUT UPDATED	AT	AT
-	04/05/2023	TS	FIRST ISSUE	AT	AT

DRAWING STATUS: FOR INFORMATION ONLY



CLIENT: UNITECH INDUSTRIES

ARCHITECT: EDG ARCHITECTURE

PROJECT: DIXON HALL,
GRAFTON STREET
BATLEY
CHANGE OF USE OF OFFICE BUILDING

TITLE: SWEPT PATH ANALYSIS
STANDARD DESIGN VEHICLE (CAR)

SCALE @ A3: 1:200	CHECKED: AT	APPROVED: AT
CAD FILE: 23004_SPA_001.dwg	DESIGN-DRAWN: TS	DATE: 04/05/2023
PROJECT No: 23005	DRAWING No: 23005/SPA/001	REV: A

© Aimee Thompson Transport Planning Ltd
T: 07507 342334 E: aimee@at-transportplanning.co.uk