

01 GA East Elevation (Upperhead Row) - Existing
1 : 100

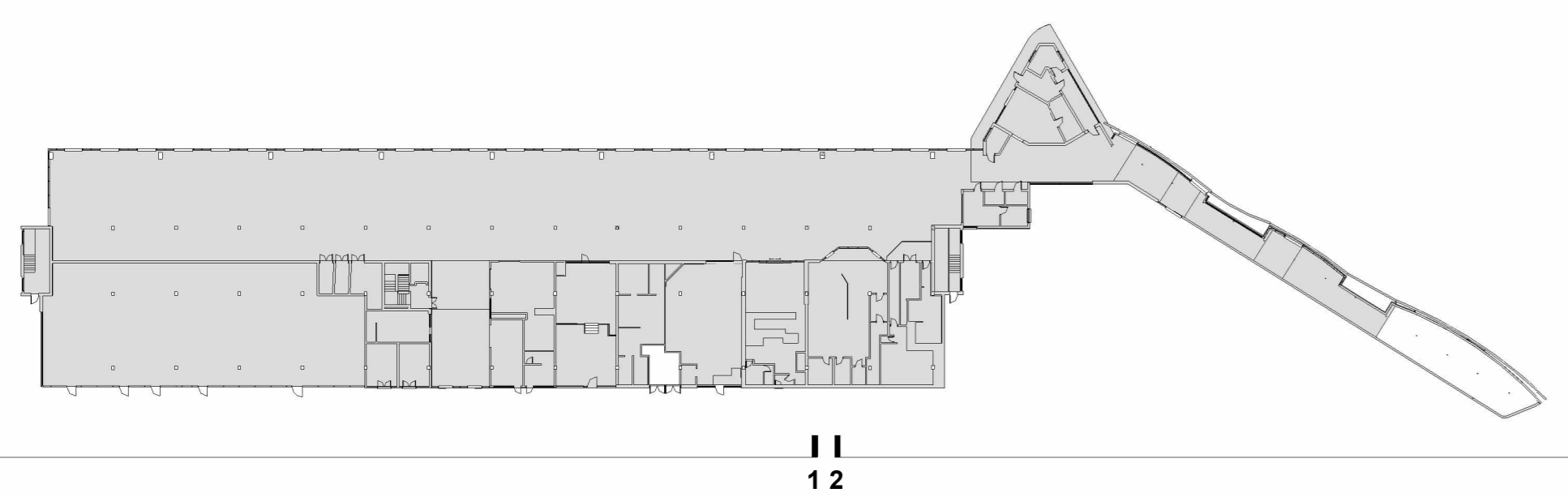

02 GA East Elevation (Upperhead Row) - Existing
1 : 100



SCALE 1 : 100
0 2 4 6

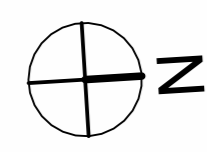

EXISTING MATERIALS

No.	Material / Finish
01	Dark brick
02	Cream painted concrete
03	Clear glazing
04	Metal cladding panels
05	Black painted ironmongery
06	Red painted metal framing
07	Red brick cladding
08	Blue painted metal
09	Grey fascias
10	Red painted metal framed barrier with wires in between
11	Steel guardrails
12	Obscure glazing
13	Metal ventilation grilles
14	Painted metal doors
15	Clear glazing (some with graphics / manifestation behind)
16	Unpainted concrete

NOTES:

- Any structural, services, fit out or external works are indicated for coordination purposes only, please refer to relevant Consultants / Clients information for full details where applicable.
- The areas indicated relate to the fabric mass of the building at the current state of design. Any details to be made on the basis of these predictions, contractor agreements or the like, should include due allowance for design development and building tolerances. Plans are subject to Building Control and other statutory approvals.
- Refer to outline performance specification and NBS for full specification of Architectural elements.
- All primary structure to Structural Engineers design, details and specification and with allowance also made for Secondary Structure and EPS according to specialist subcontractor design in applicable.
- The content of this drawing is for design intent only and may require further design coordination with all relevant consultants, specialist designers, subcontractors, manufacturers and with statutory authorities where applicable.
- All Wall and Roof / Plant penetrations to be confirmed and coordinated with by MEP Engineer design.
- All external envelope construction, insulation specifications, number and face of glazing lights, and size of frames are subject to verification by Thermal U-values model and detail coordination with the Structural and MEP Engineers.
- Maintenance strategy to be agreed. Current design indicated indicative only.
- Roof Drainage Strategy:**
- Rain Water Pipe / Hopper (RWP)
Indicative positions shown only. Number of required, locations and size all to be confirmed by specialist. Subcontractor who is required to carry out installation accordingly. Include leaf guards to all locations. Drainage in connection with to Engineers design, details and specification.
- Weir Outlets (WO)
Indicative positions, weeping outlets. Number, of positions and size to be confirmed by specialist.
- Roof Access hatch - Signage at base of roof access ladder to read "Roof access for authorized personnel only. Roof not to be accessed outside daylight hours"

PLEASE NOTE:
IT IS THE CONTRACTORS RESPONSIBILITY TO CARRY OUT A SITE SURVEY INCLUDING ANY DIMENSIONAL COMMENTS AND MET WHERE APPLICABLE TO ANY CRITICAL LOCATIONS PRIOR TO COMMENCEMENT OF WORKS. THE CONTRACTOR SHALL BE RESPONSIBLE FOR VERIFYING ALL DIMENSIONS AND LOCATIONS PRIOR TO COMMENCEMENT OF WORKS. THE CONTRACTOR SHALL BE ADVISED OF ANY SUCH DISCREPANCIES PRIOR TO COMMENCEMENT OF INSTALLATION OF ASSOCIATED WORKS.

Rev	Description	Date	Ch	App. By
P1	Preliminary issue for review	24/05/24	IZ	RD
01				
02				
03				
04				
05				
06				
07				
08				
09				
10				
11				
12				
13				
14				
15				
16				



Client name	Willmott Dixon Construction Ltd		
Project	Huddersfield Bus Station		
Drawing	Existing Elevations - 1 of 5		
Computer file	2023_00190_000	Plot date	
Project number	2023.00190.000	Issue	As indicated@A0
Drawing number	HBS-AHR-XX-ZZ-D-A-00-101	Rev	P1
		Issue status	S2

This drawing is to be read in conjunction with all related drawings. All dimensions must be checked and verified on site before commencing any work or producing any drawings. The originator should be notified immediately of any discrepancy. This drawing is copyright and remains the property of AHR.