

PLAN: 600mm ϕ TWIN PIPE ATTENUATION HEADER
SCALE 1:20

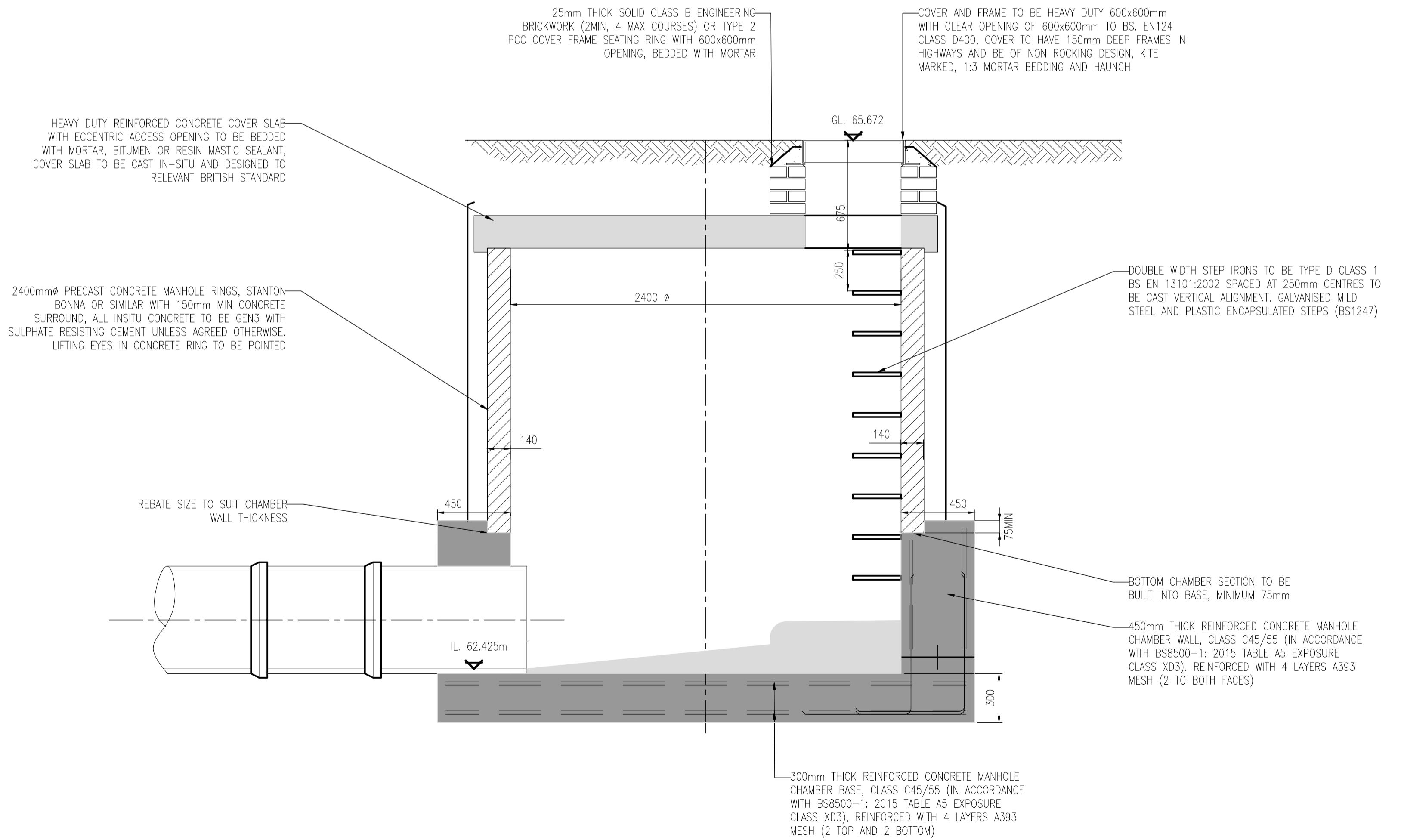

SECTION A-A: 600mm ϕ TWIN PIPE ATTENUATION HEADER MANHOLE MHSW04
SCALE 1:20

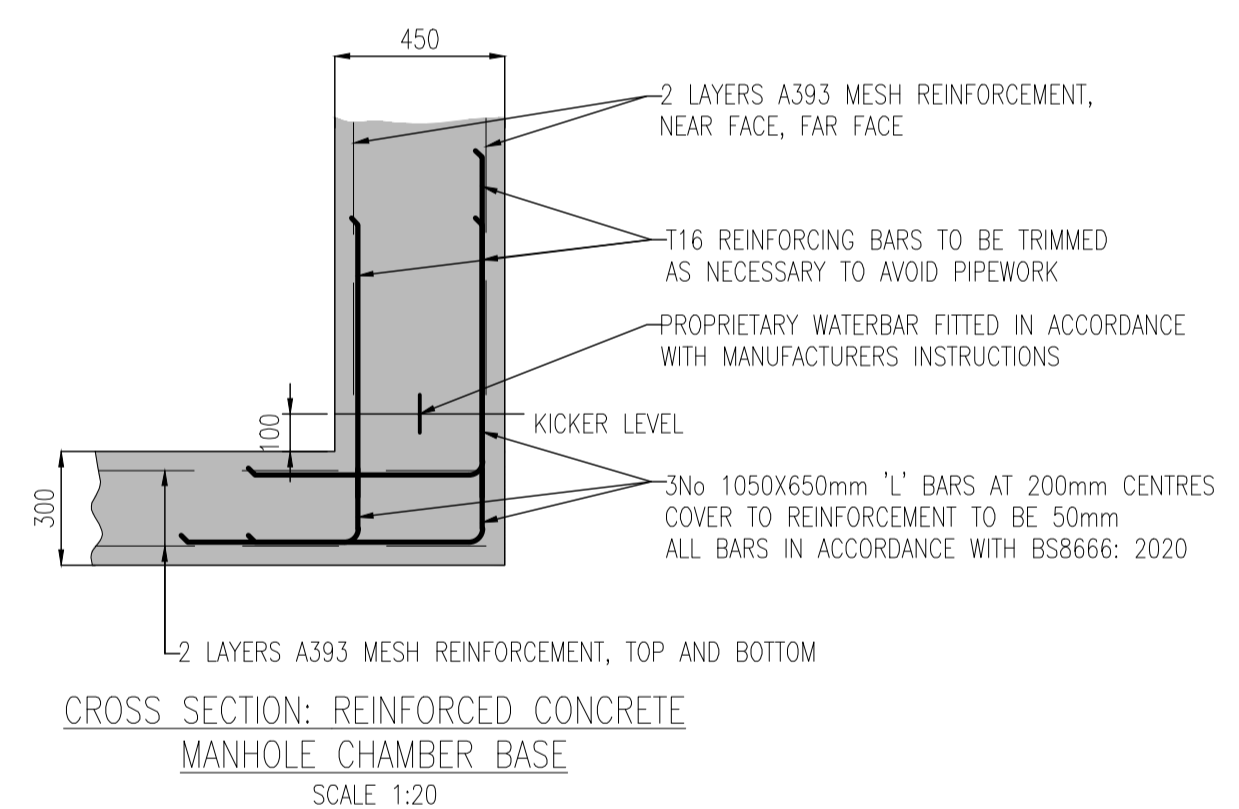

- CONCRETE NOTES:
- DESIGNED CONCRETE:
- ALL DESIGNED CONCRETE TO CONFORM TO BS 8500-2
 - STRUCTURAL CONCRETE:
 - COMPRESSIVE STRENGTH CLASS - C45/55
 - MAXIMUM WATER CEMENT RATIO - 0.35
 - MINIMUM CEMENT CONTENT - 380 Kg/m³
 - CEMENT COMBINATION TYPE - SRPC
 - MAXIMUM AGGREGATE SIZE - 20mm
 - CONSISTENCY CLASS - TO BE AGREED ON SITE
 - COVER TO CONCRETE - 55mm (MINIMUM)
- DESIGNATED CONCRETE:
- ALL DESIGNATED CONCRETE TO CONFORM TO BS 8500-2
 - BLINDING CONCRETE:
 - DESIGNATION - GEN 3
 - CEMENT TYPE - SRPC
 - MAXIMUM AGGREGATE SIZE - 20mm
 - CONSISTENCY CLASS - TO BE AGREED ON SITE
- PRECAST CONCRETE
- PRECAST CONCRETE MANHOLES TO BE IN ACCORDANCE WITH BS 5911. PRECAST CONCRETE RINGS AND COVER SLABS TO BE JOINTED WITH CEMENT MORTAR.
 - ALL CONCRETE PIPES TO BE CLASS 120 TO BS EN 1916/BS 5911-1:2021.
 - ALL CONCRETE MANHOLES TO BE IN ACCORDANCE WITH BS 1917/BS EN 5911-3:2022.
 - INSITU AND PRECAST CONCRETE UNITS SHALL HAVE SULPHATE RESISTING PORTLAND CEMENT TO BS 4027, UNLESS AGREED OTHERWISE WITH THE ADOPTING AUTHORITY
 - NOMINAL COVER TO ALL REINFORCEMENT TO BE 50mm (UNLESS NOTED OTHERWISE).
 - ALL HIGH YIELD REINFORCEMENT (H BARS) TO BE GRADE 500.
 - BOTTOM STEEL REINFORCEMENT TO BE SUPPORTED ON 50x50x50mm DEEP CONCRETE BLOCKS OR SIMILAR, WIRED TO THE REINFORCEMENT.
 - TYING WIRE TO BE STAINLESS STEEL.
 - SPACING OF REINFORCEMENT TO BE ADJUSTED LOCALLY AS REQUIRED IN PARTICULAR TO AVOID HOLES, POCKETS, SOCKETS, RECESSES AND HOLDING DOWN BOLTS.
 - ALL EXPOSED EDGES TO HAVE 20x20mm CHAMFER.
 - IMMEDIATELY AFTER LAYING, CONCRETE SHALL BE PROTECTED FROM RAIN, RAPID TEMPERATURE CHANGE, FROST AND FROM DRYING OUT. ALSO MAINTAIN THE CONCRETE ABOVE 2" IN COLD WEATHER. THE METHODS USED SHALL BE IN ACCORDANCE WITH BS 5400, OR APPROVED BY THE ENGINEER.

DO NOT SCALE

- NOTES
- THIS DRAWING SHALL BE READ IN CONJUNCTION WITH ALL RELATED DOCUMENTATION AND STANDARD DETAILS.
 - THE WORKS SHALL BE CARRIED OUT IN ACCORDANCE WITH THE DOT MCDHW, DMRB AND THE LOCAL REQUIREMENTS OF KIRKLEES COUNCIL.
 - CONFLICTING INFORMATION SHOWN ON THE ENGINEER'S DRAWINGS OR DISCREPANCIES BETWEEN THE INFORMATION GIVEN BY THE ENGINEER AND THAT PROVIDED BY OTHERS MUST BE REFERRED TO THE ENGINEER BEFORE THE WORKS COMMENCE.
 - THE CONTRACTOR SHALL USE SETTING OUT COORDINATES AND DIMENSIONS PROVIDED WHICH TAKE PREFERENCE OVER ANY LESS ACCURATE SCALED DIMENSIONS.
 - TEMPORARY WORKS DESIGN ASSOCIATED WITH THE CONSTRUCTION OF THE WORKS SHALL BE RESPONSIBILITY OF THE CONTRACTOR.
 - ALL WORKS AND PROGRAMMING SHALL BE AGREED IN ADVANCE WITH THE OVERSEEING ORGANISATION AND THE CLIENT.
 - THE CONTRACTOR SHALL MAINTAIN FREE AND OPEN ACCESS TO THE PUBLIC HIGHWAY AND ADJACENT LANDS AND PROPERTIES AT ALL TIME UNLESS OTHERWISE AGREED IN WRITING WITH THE INTERESTED PARTIES.
 - PRIOR TO THE START OF THE WORKS THE CONTRACTOR SHALL AGREE A REGIME OF FORMATION TESTING WITH THE ADOPTING AUTHORITY. THE FINDINGS OF SUCH TESTING (FOR EXAMPLE CBR READINGS) SHALL BE AGREED WITH THE ADOPTING AUTHORITY AND THE CAPPING / SUB BASE DESIGN REVIEWED ACCORDINGLY.
 - FOR DETAILS ON BUS HUB PROPOSALS REFER TO THE ARCHITECTS DRAWINGS AND SPECIFICATION.
 - FOR DRAINAGE DETAILS REFER TO DWG TCF-WSP-KIR-HECK-DR-CH-0500

UNTIL TECHNICAL APPROVAL HAS BEEN OBTAINED FROM THE RELEVANT LOCAL AUTHORITIES OR STATUTORY BODIES, IT SHOULD BE UNDERSTOOD THAT ALL DRAWINGS ARE ISSUED AS PRELIMINARY AND NOT FOR CONSTRUCTION. SHOULD THE CONTRACTOR AND / OR EMPLOYER COMMENCE WORK PRIOR TO APPROVAL BEING GIVEN, IT IS ENTIRELY AT THEIR OWN RISK

P01	21/07/2023	CC	FIRST ISSUE	SG	DB
REV	DATE	BY	DESCRIPTION	CHK	APP

DRAWING STATUS: S2 - FOR INFORMATION

wsp

3 Wellington Place, Leeds, LS1 4AP, UK
T+ 44 (0) 113 395 6200, F+ 44 (0) 113 395 6201
wsp.com

CLIENT: KIRKLEES COUNCIL

ARCHITECT: SGP

SITE/PROJECT: HECKMONDWIKE BUS STATION RIBA4

TITLE: MANHOLE MHSW04 CONSTRUCTION DETAIL

SCALE @ AT: 1:20	CHECKED: SG	APPROVED: DB
PROJECT NO: 70097732	DESIGNED: CC	DRAWN: CC
		DATE: May 24

DRAWING NO: TCF-WSP-KIR-HECK-DR-CH-0511 REV: P01

© WSP UK Ltd

File name: \\UK.VSPGROUP.COM\CENTRAL_DATA\PROJECTS\70097732 - HECKMONDWIKE BUS STATION\DRAWINGS\CF-INSP-MR-HECK-DR-CH-0511.DWG, printed on 20 May 2024 13:44:52 by Cooper, Chris