

1 PROPOSED GROUND FLOOR PLAN  
AR-04 Scale 1:40 MTS

LEGEND: KITCHEN EQUIPMENTS-GROUND FLOOR

CODE	DESCRIPTION	CODE	DESCRIPTION
1	TILL SCREEN	11	CHARGRILL 1200 W X 770 D
2	SLIM UPRIGHT JERRY & FREEZER 380 W X 540 D	12	RATIONAL SCC61G 6 GRID GAS 845 W X 760 D
3	VIPER INSTALLATION SPECIFICATIONS TANGO ICE BLAST MACHINE 860 D X 435 W	13	SS STEEL PREP TABLE 1200W X 600D
4	3 TIER GANTRY 1400 W X 600 D	14	HAND WASH BASIN 300W X 300D
5	S/S TABLE	15	MOP SINK 500 W X 500D
6	FRIDGE COKE IC00L 900-880 W X 755D	16	PREP TABLE 1370 W X 700D
7	CHIP DUMP 760 W X 800 D	17	MICROWAVE 500 W X 400D
8	FRYERS 400W X 975D	18	RACKING 760W X 460D
9	FREEZER 600 W X 600 D	19	WASH SINK 1550 W X 700 D
10	SAUCE TABLE 300 W X 600 D	21	PREP TABLE 1500 W X 700D

LEGEND: KITCHEN EQUIPMENTS-BASEMENT

CODE	DESCRIPTION
1	TWIN WASH SINK 1740 W X 700D
2	RACKING FOR DRY STORAGE 1500 W X 400 D
3	FREEZER ROOM 1500 W X 2475D
4	COLD ROOM 1500 W X 2475D
5	FRIDGE 240LTR DOUBLE DOOR COUNTER POLAR G-SERIES UG636 900W X 700D

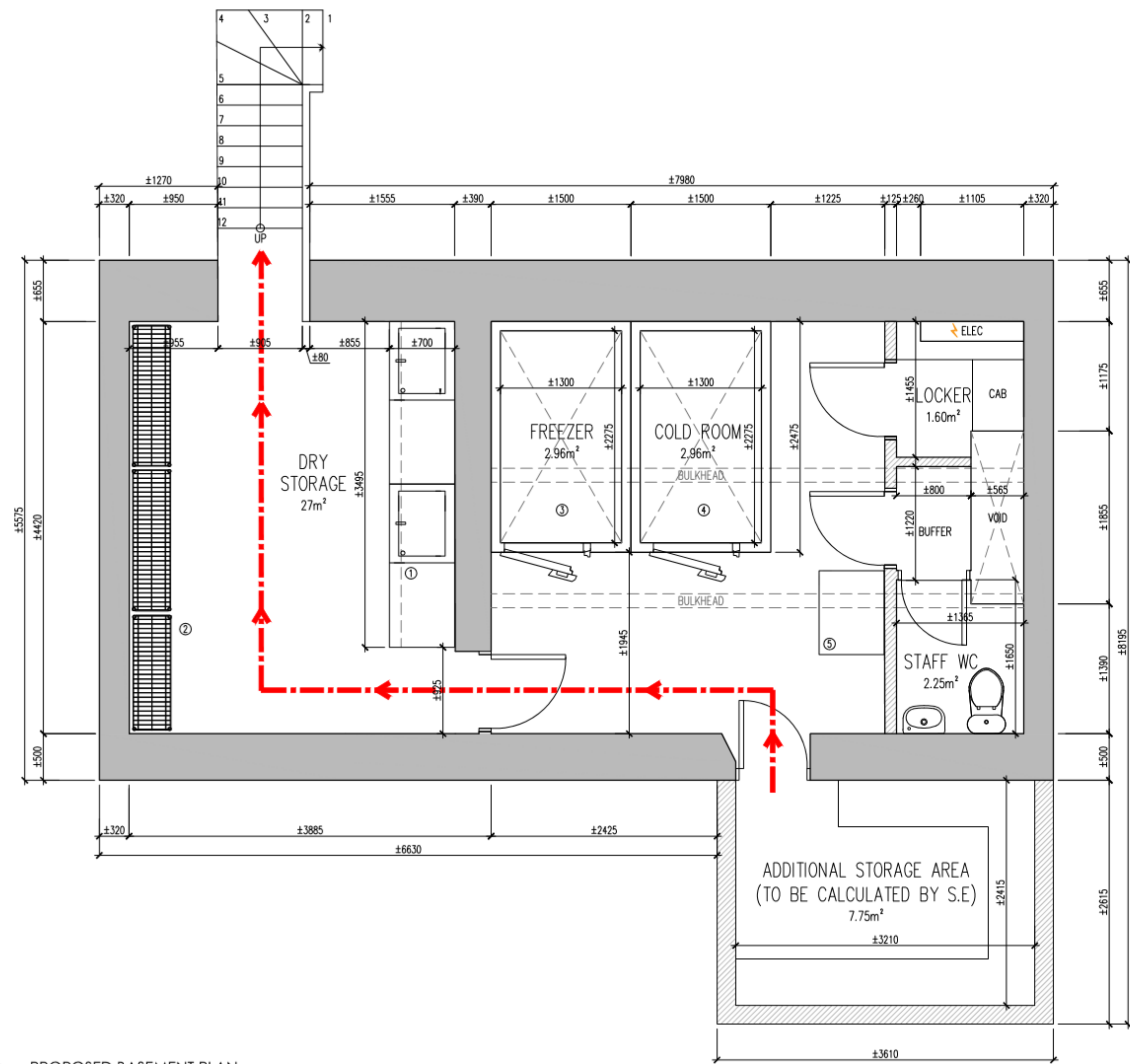

2 PROPOSED BASEMENT PLAN  
AR-04 Scale 1:40 MTS



3 PROPOSED FACADE ELEVATION  
AR-04 Scale 1:40 MTS

- NOTES
- All drawings to be read in conjunction with Structural Engineer's details & any relevant sub-contractor's details. All works to comply with current Building Regulations, British Standards & Codes of Practice.
  - The Main Contractor & Sub-Contractor where applicable will be responsible for checking all dimensions on site & reporting any discrepancies to all relevant consultants.
  - The contractor must familiarize himself with the site and measure all areas affecting his work. All dimensions must be verified on site prior to manufacture of any joinery or works on or off site.
  - All works to be carried out by approved installation contractors, and to manufacturers recommendations.
  - All dimensions to be in millimeters.
  - Contractor to ensure that all work meets the requirements of the EHO, Building Control, Fire Authority and all other statutory bodies.
  - All shop-fit decoration to achieve Class '0' surface spread of flame in accordance with BS476, Part 7, 1971 or 1987.
  - All stained timber areas to be treated with Thermoguard or similar to achieve Class '0' surface spread of flame. All painted timber areas to be treated with Thermoguard Timbercoat or similar to achieve Class '0' surface spread of flame.
  - Where MDF is specified this is to be Zero or Low Formaldehyde type MDF made to British Standards.
  - The contractor is to ensure that all walls to be decorated are prepared prior to decoration and all surfaces smooth level and joint free.
  - All applied coatings are to be water based to large wall areas.
  - Contractor to allow for one mist coat and two top coats in cases, walls and timberworks.
  - All new timber to be pressure impregnated with preservative prior to delivery to site. Where subsequent cutting & bonding is necessary all exposed faces to be coated with Protim.

REV	DESCRIPTION	DATE	BY
-	-	-	-
-	-	-	-
-	-	-	-

**CHILLI FLAMES**

PROJECT NAME  
**CHILLI FLAMES**  
234 Lockwood Road, Huddersfield, HD1 3TG

SHEET NO.	SCALE	DATE	REV
AR-04	1:40	10/10/22	00