

**ROLEC EV/OLEV Home Car charge Point**  
 The cable and circuitry ratings for the charging points shall be of adequate size to ensure a minimum continuous current demand of 16 Amps and a maximum demand of 32Amps

- Key to Drainage**
- New 80mm diameter RWP with gully and 125mm wide gutters
  - New surface water manhole
  - New 100mm diameter surface water drain, Min Fall 1:60

- Surfaces**
- Grey Permeable Resin/ Brick Paviors
  - Red Permeable Resin/ Brick Paviors
  - Buff Permeable Resin/ Brick Paviors
  - Grassed areas

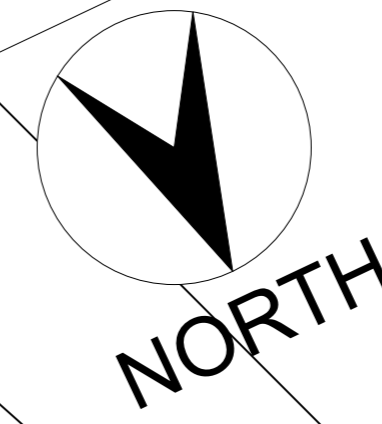

**NOTES:**  
 Any errors or omissions to be reported to Code L6 immediately.  
 This drawing and design is the copyright of Code L6 and is not to be used for any purpose without their consent.

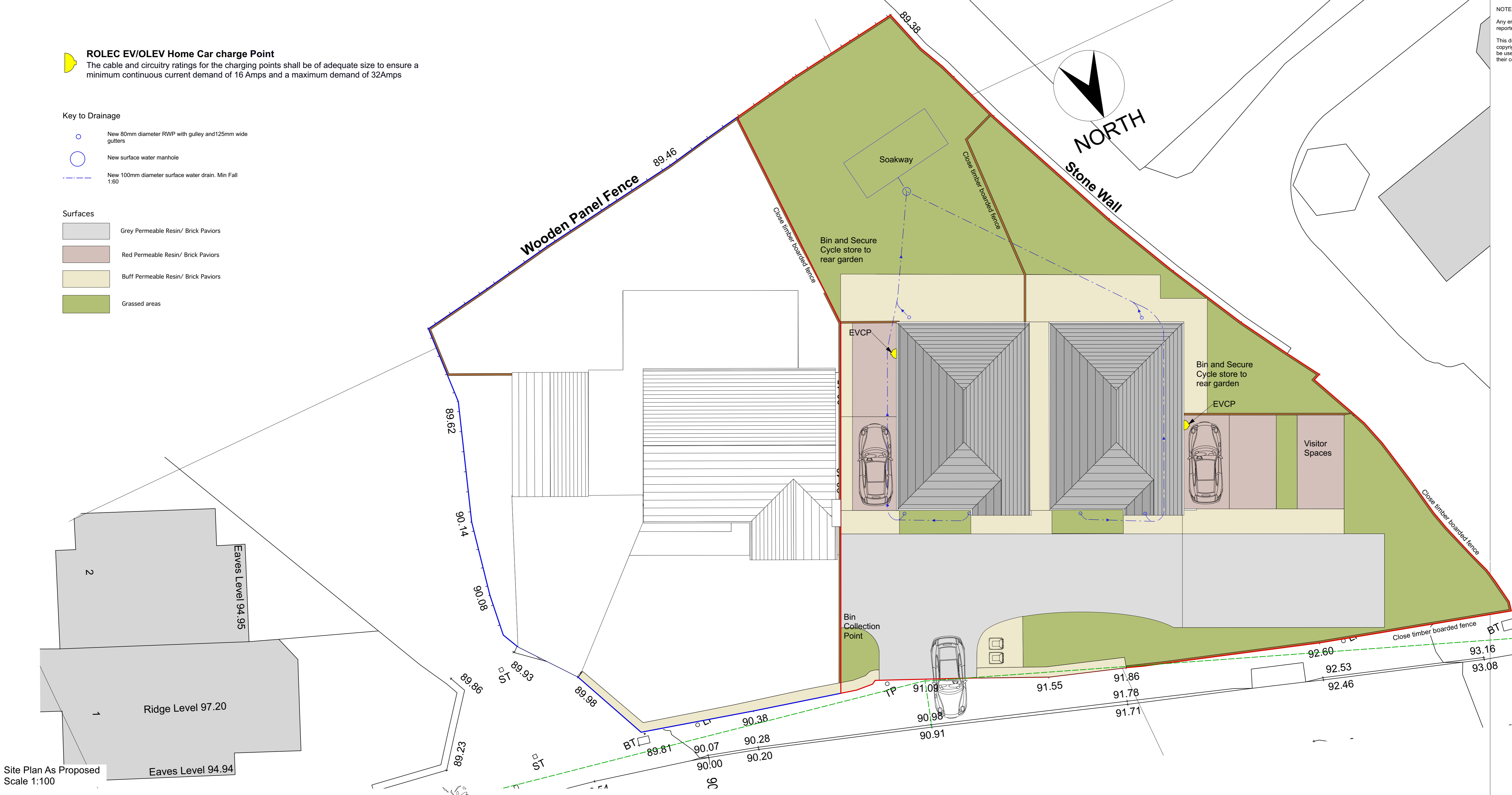

Site Plan As Proposed  
 Scale 1:100



Site Section/ Elevation As Proposed  
 Scale 1:100

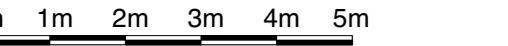

B Roof design altered and 06/02/24 houses detached. Landscaping increased to front.  
 A Visibility splay altered and entrance moved to avoid telegraph pole. 14/12/23

**Code L6 Architecture Ltd**  
 31 Halifax Road Brighouse West Yorkshire HD6 2AA  
 T: 01484 714 870  
 E: codeL6@btinternet.com  
 W: www.CODEL6.com

Project:  
 93A Halifax Road Liversedge WF15 6PP

Client:

Drawing:  
 Site Plan and Elevation As Proposed

Date: 28/11/23 Scale: 1:100 Size: A1

Drawing Number:  
 23-007-31B

**AS PROPOSED**