

This drawing is the copyright of Bluehill Landscape Design and cannot be reproduced in any form without the express consent of the company. Written and scaled dimensions to be checked on site, any discrepancies reported prior to work commencing. If in doubt please ask. This drawing has been prepared for the purpose of planning approval.

Planting Notes
 Topsoil: Topsoil shall be a minimum of 400mm depth over planting beds and graded to fall. Imported topsoil must be BS3882:2007 compliant and existing topsoil must be cultivated in accordance with BS3882:2007. No cultivation should take place in wet/waterlogged conditions. Topsoil and subsoil arising from tree pit excavation shall be temporarily stored on site (in separate piles) in such a way as to avoid contamination of existing topsoil. Excess subsoil to be either reused within pits or removed from site. Excess topsoil to be spread thinly over existing planting areas.
 Herbicide and cultivation: Topsoil to be treated with two applications of herbicide prior to planting, where necessary, strictly in accordance with the Control of Pesticides Regulations 1986 (as amended 1997, or, otherwise, updated/superseded legislation) and following manufacturer's instructions by qualified staff. The topsoil shall then be cultivated to 150mm depth.
 Planting: All planting and turfing shall conform to BS: 3936: 1992 and BS:4428:1989.
 Trees: All trees shall be supplied as container grown, air pot or root balled specimens. All trees need to be procured and planted in accordance with British Standard BS 8545:2014, with the nursery provider demonstrating Plant Healthy Certification and/or an adopted biosecurity policy & plant passport scheme. Standard trees to be planted in pits 800x800x450mm or dimensions of rootball, whichever is greater. Heavy and Extra Heavy Standard trees to be planted in pits 1000x1000x600mm or dimensions of rootball, whichever is greater. In accordance with BS 8545:2014 (Trees from Nursery to Independence), each tree pit (unless it forms part of a naturalistic woodland type scheme) shall include an irrigation tube with cap. Alginate soil improver and 150g Enmag (or equivalent) to be incorporated into the soil of all new tree pits. Trees to be planted centrally within a tree pit. Tree stakes shall be of hazel, chestnut or other approved timber. They shall be round, rough sawn, straight, free from projections, large or edge knots and other defects and be pointed at the lower end. They shall be strong enough not to split when driven into the ground and when ties are nailed to them (both initially and when adjusted). For Feathered trees use 2Nr stakes (1.4m by 75mm) to be driven into ground 800mm, leaving 600mm above ground. For all trees above feather size, three low stakes (height 800mm above ground) with flexible ties shall be provided per tree for support (other than semi-mature trees which require underground guying). All trees in grass shall be planted within a 1.5m diameter bark mulch circle and shall include a spiral guard/mower guard to protect against mower damage/trimmer damage.
 Plastics: In line with Defra policy, all planting paraphernalia should be from sustainable sources, plastic free and with a low carbon footprint (e.g., Green-tech Natural tree tie, Bio-Earth Biodegradable Plastic-free tree shelter guard, Rainbow Treelife' biodegradable spiral guard).
 Container grown shrubs, transplants and whips: Shrubs and transplants shall be planted in pits 300x300x400mm depth, and the backfill shall include 3 litres of peat-free tree and shrub compost. Where two or more shrub species are indicated within a single bed each species shall be randomly mixed throughout the bed in groups of 3/5.
 Mulch: Planting beds to receive 75mm depth pulverized ornamental bark mulch. Native woodland/edge plants to be planted with 800g flax fibre mulch mat pinned to soil. Native hedgerow to be planted through 800g flax fibre mulch roll, edges tucked. Ensure the top of the mulch layer is a minimum of 15mm below adjacent pavements and other surfaces, to prevent spillage.
 Plant position: Final position of trees and shrubs subject to confirmation of service location and approval of statutory undertakers.
 Protection to planting: Native hedgerow plants to be protected by spiral shelters. Native trees and shrubs within mixes to be protected by shelter guards as supplied by Acorn Planting Products Ltd (01508 528763), or equivalent.
 Ornamental hedging: Hedges to comprise a single row of plants. 400mm wide trench excavated to take plants and topsoil cultivated to 400mm depth prior to application of fertilizer.
 Grass: All turf/seeded areas to be cultivated and levelled as required removing any stones, rubble, subsoil, general construction waste.
 Planting Season: Bare-root shrubs to be planted between mid-November and mid-March dependent upon the planting season.
 Poisonous Plants: Please be aware that whilst we have made every effort to avoid the use of poisonous plant materials on this site, it should be noted that consumption of any ornamental plant may lead to adverse symptoms. Any plant substitutions made by the contractor are done at their own risk.
 Implementation schedule: Planting works will be undertaken during first planting season following completion of building works.

LEGEND

- Site Boundary
- Existing tree/ tree group retained
- Existing vegetation removed
- Proposed tree (selected standard)
- Proposed shrub bed
- Proposed hedge
- Proposed grass (Emorsgate EL1 Flowering Lawn Mix @ 4g/m2 together with EG21 Fine Grass Mix @ 10g/m2)
- Proposed wild flower mix (Emorsgate EM2 Standard General Purpose Meadow Mix @ 4g/m2)

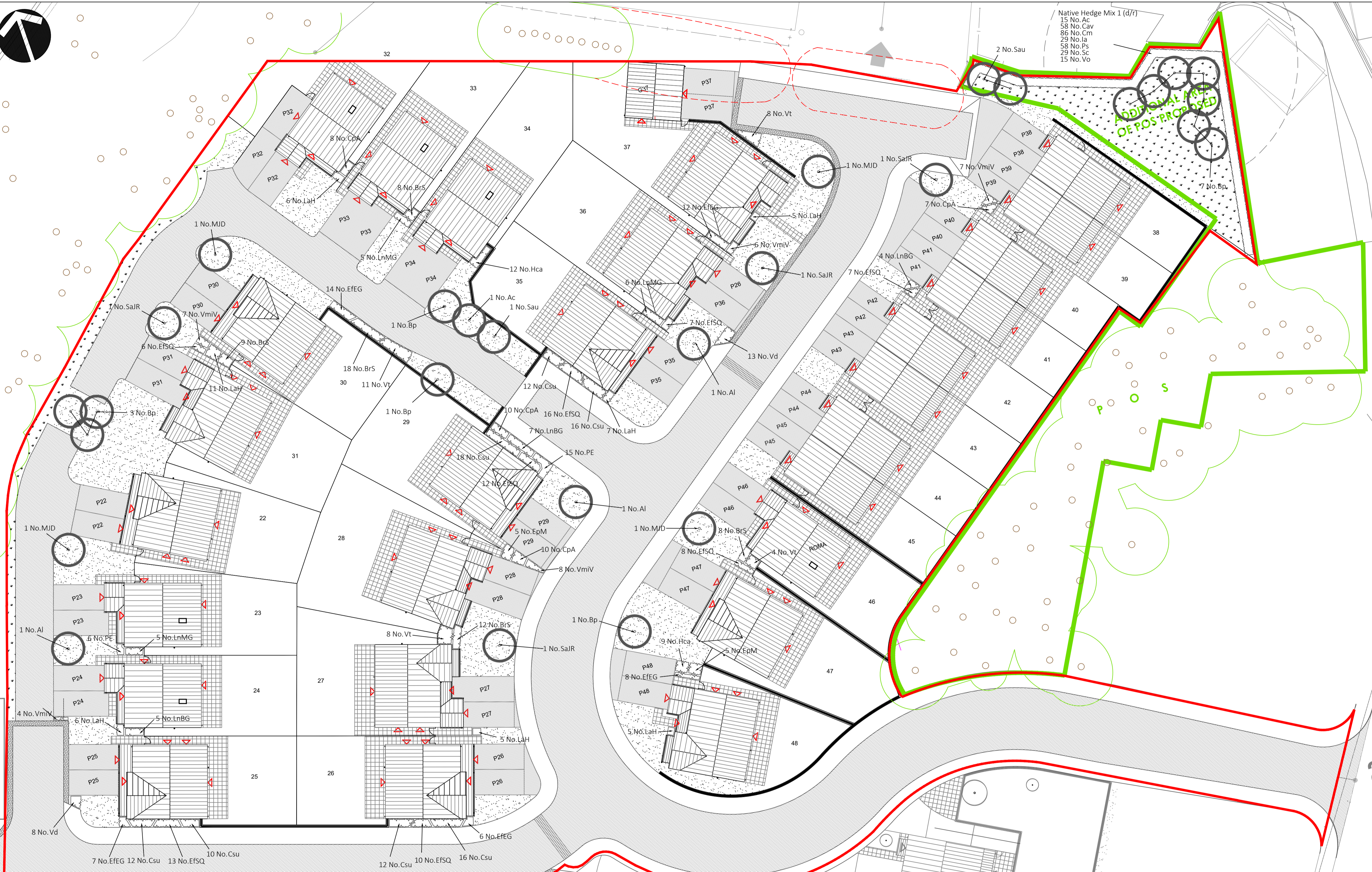

Proposed Planting Schedule

Nr	Code	Tree Name	Specification	Girth	Height
1	Ac	Acer campestre	Selected Standard : Clear Stem 175-200 : RB	10-12cm	300-350cm
3	Al	Amelanchier lamarckii	Selected Standard : Clear Stem 175-200 : RB	10-12cm	300-350cm
16	Bp	Betula pendula	Selected Standard : Clear Stem 175-200 : RB	10-12cm	300-350cm
4	MJD	Malus 'John Downie'	Selected Standard : Clear Stem 175-200 : RB	10-12cm	300-350cm
4	SaJR	Sorbus aucuparia 'Joseph Rock'	Selected Standard : Clear Stem 175-200 : RB	12-14cm	300-350cm
2	Sau	Sorbus aucuparia	Selected Standard : Clear Stem 175-200 : RB	12-14cm	300-350cm
Total :28					
Nr	Code	Plant Name	Height	Cntr (l)	Nr/m2
55	BrS	Brachyglottis 'Sunshine'	40-60cm	SL	4/m ²
35	CpA	Cytisus praecox 'Allegro'	20-30cm	SL	4/m ²
96	Csu	Chaenomeles superba 'Crimson & Gold'	30-40cm	SL	4/m ²
47	EfEG	Euonymus fortunei 'Emerald 'n' Gold'	30-40cm	SL	4/m ²
79	EFSQ	Euonymus fortunei 'Silver Queen'	30-40cm	SL	4/m ²
10	EpM	Elaeagnus pungens 'Maculata'	30-40cm	SL	2/m ²
21	Hca	Hypericum calycinum	40-60cm	SL	4/m ²
45	Lah	Lavandula angustifolia 'Hidcote'	30-40cm	SL	4/m ²
16	LnBG	Lonicera nitida 'Baggesen's Gold'	30-40cm	SL	2/m ²
16	LnMG	Lonicera nitida 'May Green'	30-40cm	SL	2/m ²
21	PE	Potentilla fruticosa 'Elizabeth'	30-40cm	SL	4/m ²
21	Vd	Viburnum davidii	30-40cm	SL	4/m ²
32	VmiV	Vinca minor 'Variegata'	30-40cm	SL	4/m ²
31	Vt	Viburnum tinus	30-40cm	SL	2/m ²
Total :525					

NHM 1 Number	Abbreviation	Species	Height	Density
15	Ac	Acer campestre	80-100cm	0.4Ctr Double Staggered at 0.4m offset
58	Cav	Corylus avellana	80-100cm	0.4Ctr Double Staggered at 0.4m offset
86	Cm	Crataegus monogyna	80-100cm	0.4Ctr Double Staggered at 0.4m offset
29	la	Ilex aquifolium	80-100cm	0.4Ctr Double Staggered at 0.4m offset
58	Ps	Prunus spinosa	80-100cm	0.4Ctr Double Staggered at 0.4m offset
29	Sc	Salix caprea	80-100cm	0.4Ctr Double Staggered at 0.4m offset
15	Vo	Viburnum opulus	80-100cm	0.4Ctr Double Staggered at 0.4m offset
Total :290				

For planting details of phase 1 see separate drawing

Based on drawing: 1602-140D by Loroc Architects.

PROJECT New Mill Road, Holmfirth (Phase 2)

TITLE Detailed Landscape Proposals

CLIENT Signature Homes (Yorkshire) Ltd

DATE 09 Nov 23 SCALE 1 : 250 SHEET A1

DRAWN MP / pr DRAWING NO 5054/1

CHECKED MP REVISION -

Blue Hill
 Landscape Design
 Chartered Landscape Architects

7 Blue Hill Crescent, Leeds LS12 4PA
 Tel: 0113 210 9559
 Mob: 07939 058770
 Email: martin@bluehilllandscape.co.uk
 Web: www.bluehilllandscape.co.uk