

THIS DRAWING IS COPYRIGHT, AND REMAINS THE PROPERTY OF
HTC ARCHITECTS. IT MUST NOT BE REPRODUCED, USED,
DISCLOSED OR TRANSMITTED TO THIRD PARTIES IN ANY FORM, IN
WHOLE OR IN PART, WITHOUT PRIOR WRITTEN PERMISSION.

DO NOT SCALE!
ALL DIMENSIONS SHOULD BE CHECKED ON SITE BEFORE
WORK COMMENCES

SUBJECT TO LEVEL REVIEW BY TOPPINGS ENGINEERS
DRAWING NR 21561-DR-C-0800

BASED ON LIDL ECO 2020.2 FEB 2021 SPECIFICATION

SUBJECT TO TREE SURVEY

SUBJECT TO HIGHWAYS DESIGN

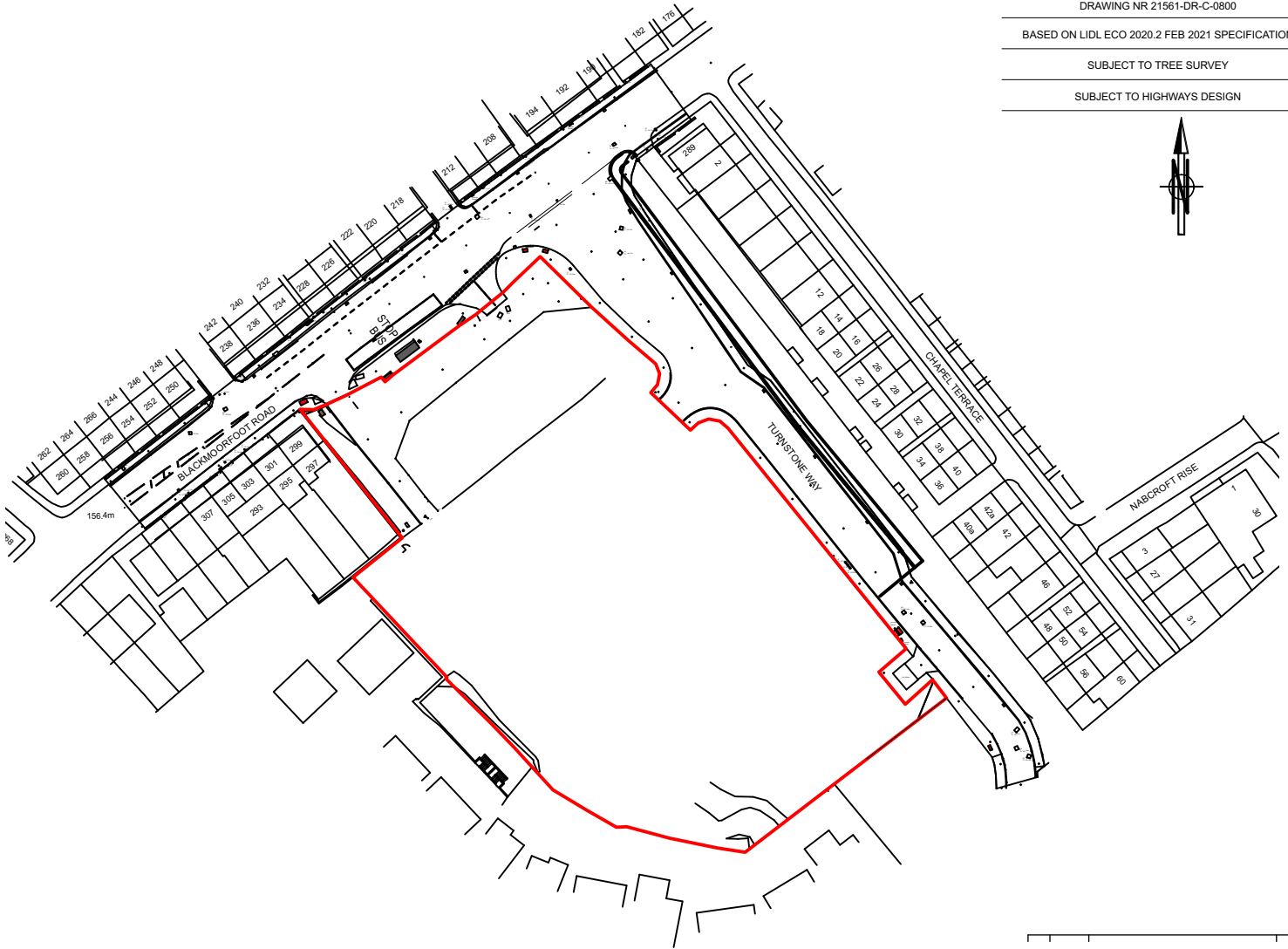

Rev.	Date	Description	Drawn
------	------	-------------	-------

htcarchitects

York Place Studio
8 Britannia Street
Leeds
LS1 2DZ

T:(0113) 244 3457

W: www.htcarchitects.co.uk
E: info@htcarchitects.co.uk

client
Lidl GB Ltd.



project
Blackmoorfoot Road
Huddersfield

drawing title
Location Plan

date August 2021
status Planning
scale 1:1250 @ A4
drawn BM checked PH
job no. 2783 dwg no. P406 rev.