

0 2 4
m
Scale 1:100

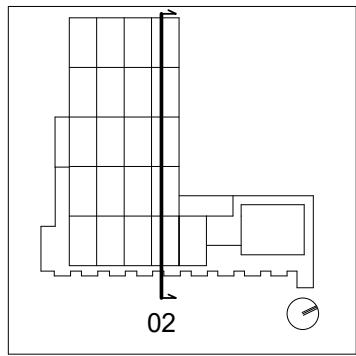

FeildenCleggBradleyStudios
LLP

London Office
Tottenham Street
London
W1T 4RG

t +44 20 7323 5737
e london@fcbstudios.com

Rev	Status	Date
P01	S2 Issued for Planning and Listed Building Consent Approval	30/09/22

Conservation of Art Work - Commerce

'Commerce' is a black painted metal relief by sculptor Fritz Steller. It was commissioned as part of the public art included within the original Murrayfield Development of Queensgate Market. The sculpture is formed of thin sheet metal and rods gas welded together to create humanistic forms. The composition describes the activity of growing and processing plants to create cloth. The scene is divided into three parts which parallel the activities which it depicts. From the left of the scene the composition described the ploughing of the land and planting of seeds. The plants are harvested and processed. At its centre the sculpture likely depicts the processing raw material via crushing and scutching. To the right of the scene the fibres are woven into cloth on a loom.

'Commerce' is approximately 46.5m long and stretches the length of the building. It is mounted on hidden fixings over a rendered brick wall that has a buff appearance.

The sculpture can be seen from several positions within the market. In almost every instance the available views offer fragmentary glances. It is possible to see the whole sculpture from the upper level which had been intended to be a publicly accessible restaurant but was in practice never made open to the public.

Survey and Repair

The sculpture is to be inspected by a conservator. Detailed proposals will be developed to inform the appropriate demounting repair and cleaning prior to safe storage for the period of construction. The assessment work will include a detailed survey of the sculpture to enable its accurate reassembly. The conservator's work will inform the design for the support frame over which the sculpture will be mounted as part of its reinstallation.

Outline Proposal

Survey – photogrammetric survey capturing geometric data and to include a record of condition and assembly.
Demount – Sculpture to be taken down to enable cleaning, essential repair and storage.
Storage – storage in timber cases with packing. Cases to be placed in safe storage in a conditioned building to preserve the sculpture in advance of further work.
Overhaul – Repair on the bench by an appropriately skilled conservator. Re-treatment of the surface of the metal to address corrosion and degradation in any historic coatings.
Develop designs for the treatment of the hidden back face of the sculpture which will become partially visible once the sculpture is remounted over the proposed glazed curtain walling.
Remount – A new frame is to be fabricated to enable the sculpture to be remounted with the existing fixing points. This secondary frame will be fixed back to the building either at the curtain walling or columns. The intention is for the secondary frame to be decorated to be disguised from view and to blend with the sculpture.

- Notes**
- Dimensions are not to be scaled from this drawing.
 - Drawing only to be used for the purposes it was issued for.
 - Landscape, public realm and neighbouring buildings shown indicatively.
 - Existing locations and footprints of surrounding buildings are taken from; (OS Map - Promap-1634985-1735589-720-0.dwg) received 2021.10.27; (21359-100-Topo-Millimetres.dwg) received from Maltby Surveys on 2022.02.23
 - Existing building survey information taken from Maltby survey model received 22.07.22 and Maltby Survey drawings received 28.04.22.

Job/Drawing No	Revision
IR430301-FCB-XX-ZZ-DR-A-040952	P01
Kirklees Cultural Heart	Status
Huddersfield Library - Conservation of Artwork - Commerce	S2
Scale As indicated@A1	Drawn Author
Date 07/25/22	Checked Checker
FCBS project no IR430301	
Do not scale	All dimensions to be checked on site