

Copyright All rights reserved. This drawing must not be reproduced without permission.  
 The drawing must not be used in any way other than that specified.

Rev	Description	Date	By	Check
A	blue outline added to site location plan	07.06.18	MJD	mjd
B	revised to Planning Dept. comments	09.05.19	MJD	mjd
C	wood pellet boiler and flue added	03.06.21	MJD	mjd
D	update boundary information added	14.02.24	MJD	mjd

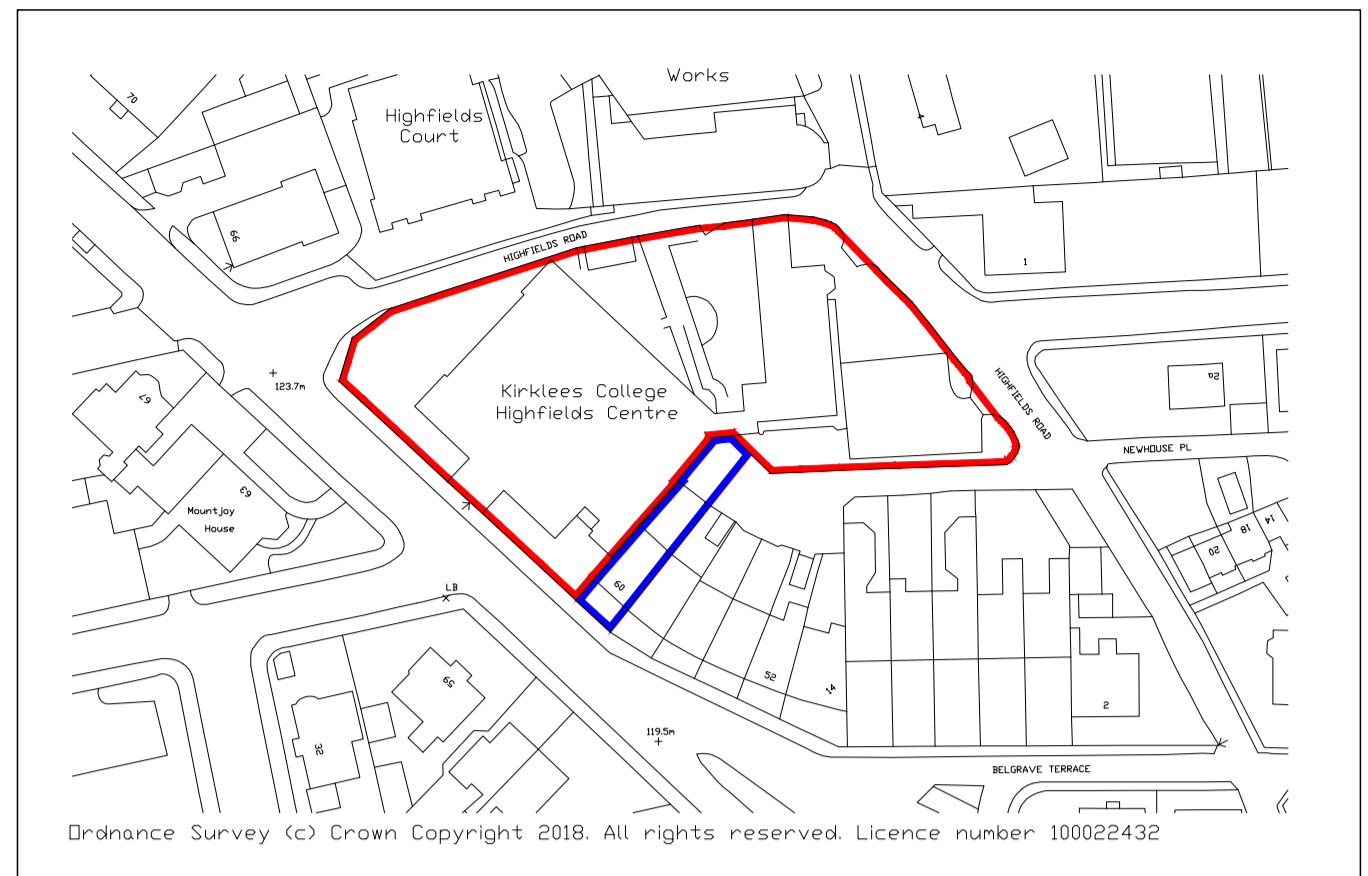

**SITE LOCATION PLAN @ 1:1250**

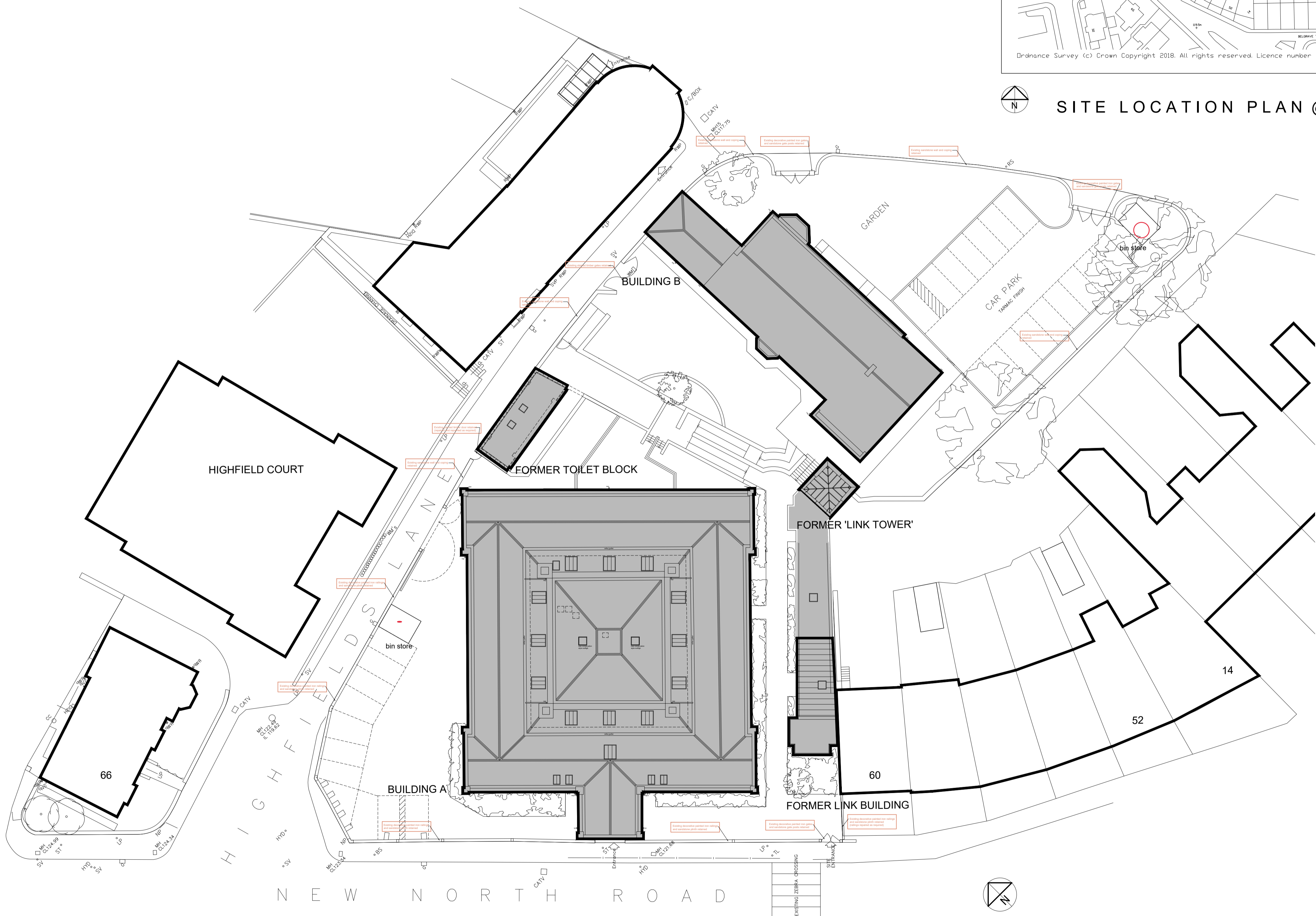

This drawing is based on survey information provided by other another party. The information shown relating to any proposed design or construction is therefore dependant upon the accuracy and completeness of the original survey.

Drawn Status: **PRELIMINARY**

**space**  
 architecture and design limited

The Studio  
 Lake House  
 Blackmoorfoot Road  
 Huddersfield  
 HD7 5TR

t 01484 841423  
 f 01484 847757  
 e: md@spacearchitecture.net  
 w: www.spacearchitecture.net

Client: San Pedro Properties Ltd

Project: Conversion of Former College Buildings to Residential Apartments  
 Highfields, New North Road, Huddersfield, HD1 5LS

Drawing Title: Proposed Site Layout Plan

Scale	Author	Date	Drawn	Checked	Drawing Number	Revision
1:250	11500	08.03.18	MJD	mjd	18.00719-3008	D