

Id	No.	Name	Age	Height	Coverage	North	East	South	West	Condition	Life Exp	Category	Diameter	Stems	Tree Works Required for Scheme	Arboricultural Impacts	Control measures	Risk	RPI Ratio	RPA Area
	T1	Hawthorn	M	8	2	4.5	4	3	3	Fair	20+	B2	330	1	Remove due to scheme	Loss of Medium value tree	Replacement in landscaping scheme.	Low	3.96	49.27
	G2	Hawthorn, Ash, Sycamore, Privet, Wych Elm	M	1	0	1	1	1	1	Fair	20+	C3	100	1	No Works Required for Scheme	No Arboricultural Impact	Protect from site changes.	Low	1.2	4.52
	T3	Grey Lawson Cypress	EM	9	0	2.5	3	3	3.5	Fair	20+	B2	380	1	No Works Required for Scheme	No Arboricultural Impact	Protect from site changes.	Low	4.56	65.33
	H4	Hawthorn, Ash, Sycamore, Privet	M	2	0	1	1	1	1	Fair	20+	C3	100	1	No Works Required for Scheme	No Arboricultural Impact	Protect from site changes.	Low	1.2	4.52
	T5	Wych Elm	M	7	3	3	3	1	2	Fair	<10	C3	180	2	Remove to protect wall, irrespective of scheme	Loss of small Low value tree	Replacement in landscaping scheme.	Low	2.16	14.66
	G6	Ash	M	7	3	3	3	1	2	Fair	<10	C3	225	5	Remove to protect garage, irrespective of scheme	Loss of small Low value tree	Replacement in landscaping scheme.	Low	2.7	22.91
	T7	Ash	M	22	3	9	8	4	3	Fair	<10	C3	400	1	Remove to protect wall, irrespective of scheme	Loss of Medium Low value tree	Replacement in landscaping scheme.	Low	4.8	72.39
	T8	Sycamore	M	21	3	6.5	6.5	6.5	6.5	Good	20+	B2	620	1	No Works Required for Scheme	No Arboricultural Impact	Protect from site changes.	Low	7.44	173.92
	T9	Ash	M	7	3	3	3	1	2	Fair	<10	C3	180	2	Remove to protect wall, irrespective of scheme	Loss of small Low value tree	Replacement in landscaping scheme.	Low	2.16	14.66
	T10	Sycamore	M	7	3	3	3	1	3	Poor	<10	C3	250	1	No Works Required for Scheme	No Arboricultural Impact	Protect from site changes.	Low	3	28.28
	G11	Leyland Cypress	M	8	3	3	3	3	3	Poor	<10	C3	250	1	No Works Required for Scheme	No Arboricultural Impact	Protect from site changes.	Low	3	28.28
	T12	Sycamore	M	7	3	2	2	2	2	Fair	10+	C3	100	1	No Works Required for Scheme	No Arboricultural Impact	Protect from site changes.	Low	1.2	4.52
	T13	Sycamore	M	9	3	2.5	2.5	2.5	2.5	Fair	10+	C3	150	1	No Works Required for Scheme	No Arboricultural Impact	Protect from site changes.	Low	1.8	10.18
	T14	Sycamore	M	7	3	2	3	3	2	Fair	10+	C3	150	1	No Works Required for Scheme	No Arboricultural Impact	Protect from site changes.	Low	1.8	10.18
	T15	Sycamore	M	9	3	2.5	2.5	2.5	2.5	Fair	10+	C3	150	1	No Works Required for Scheme	No Arboricultural Impact	Protect from site changes.	Low	1.8	10.18
	T16	Sycamore	M	21	4	8	9	8	6	Fair	20+	B2	780	1	No Works Required for Scheme	No Arboricultural Impact	Protect from site changes.	Low	9.36	275.27
	T17	Sycamore	M	21	4	7	9	7	6	Good	20+	B2	850	1	No Works Required for Scheme	No Arboricultural Impact	Protect from site changes.	Low	10.2	326.89
	T18	Honey Locust	M	3	2	2	2	2	2	Fair	20+	B2	250	1	No Works Required for Scheme	No Arboricultural Impact	Protect from site changes.	Low	3	28.28
	G19	Firethorne	M	3	0	2	2	2	2	Fair	20+	C3	75	1	No Works Required for Scheme	No Arboricultural Impact	Protect from site changes.	Low	0.9	2.55

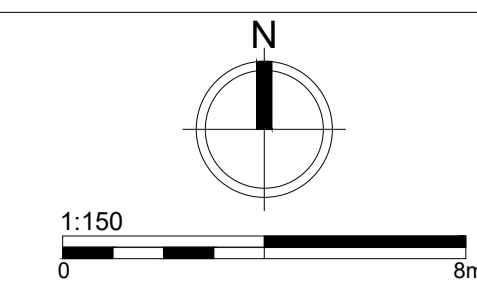

© Barnes & Associates Ltd. This plan should be viewed in **Color**. If printed in black and white, please do not scale from this drawing. All dimensions should be checked on site. Any errors or divergences should be brought to the attention of Barnes and Associates Ltd. All right described in Chapter IV of the Copyright, Design & Patents Act 1988 have been generally asserted and copyright of this plan remains with Barnes Associates Ltd until all fees are paid in full.

**Individual Tree Symbols**

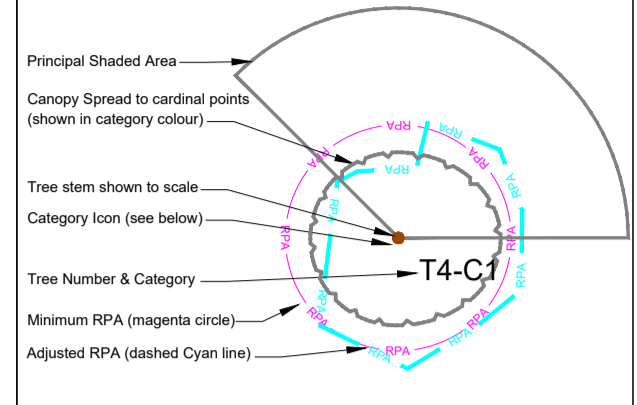

**Tree Management Requirements**

- Trees to be retained within the scheme and protected in line with the guidelines set out in BS5837. (Symbol: Green circle with dot)
- Trees to be retained and protected in line with BS5837 though requiring facilitation pruning. Pruning to be in line with BS3998. (Symbol: Green circle with blue outline)
- Trees identified as U category which are not thought to affect the scheme. See tree survey recommendations. (Symbol: Red exclamation mark in circle)
- Trees to be removed to enable the scheme to be carried out as proposed. All works to be undertaken in line with BS3998. (Symbol: Red star in circle)

Notes:  
Plan is based upon the supplied topographical Survey Plan. Copies of this plan are available in CAD Formats .dwg & .dxf upon request.

Revision Description:  
A - Preliminary Issue

Client:	Den Architecture
Benefit of:	
Project:	61-63 Moor Ln, BD19 4LF
Title:	Arboricultural Impact Assessment
Drawing No:	BA11605AIA
Status:	P
Scale:	1:150 @ A1
Revision:	A
Date:	22/09/2022
Drawn By:	TG
Checked:	SB
Approved:	SB

**BARNES associates**  
SURVEY MANAGE IMPROVE  
Unit 1 Foundry Yard, New Row  
Boroughbridge YO51 9AX  
T 01423 322 371  
E info@barnesassociates.co.uk  
W barnesassociates.co.uk  
Company Number 10438116  
Registered in England and Wales

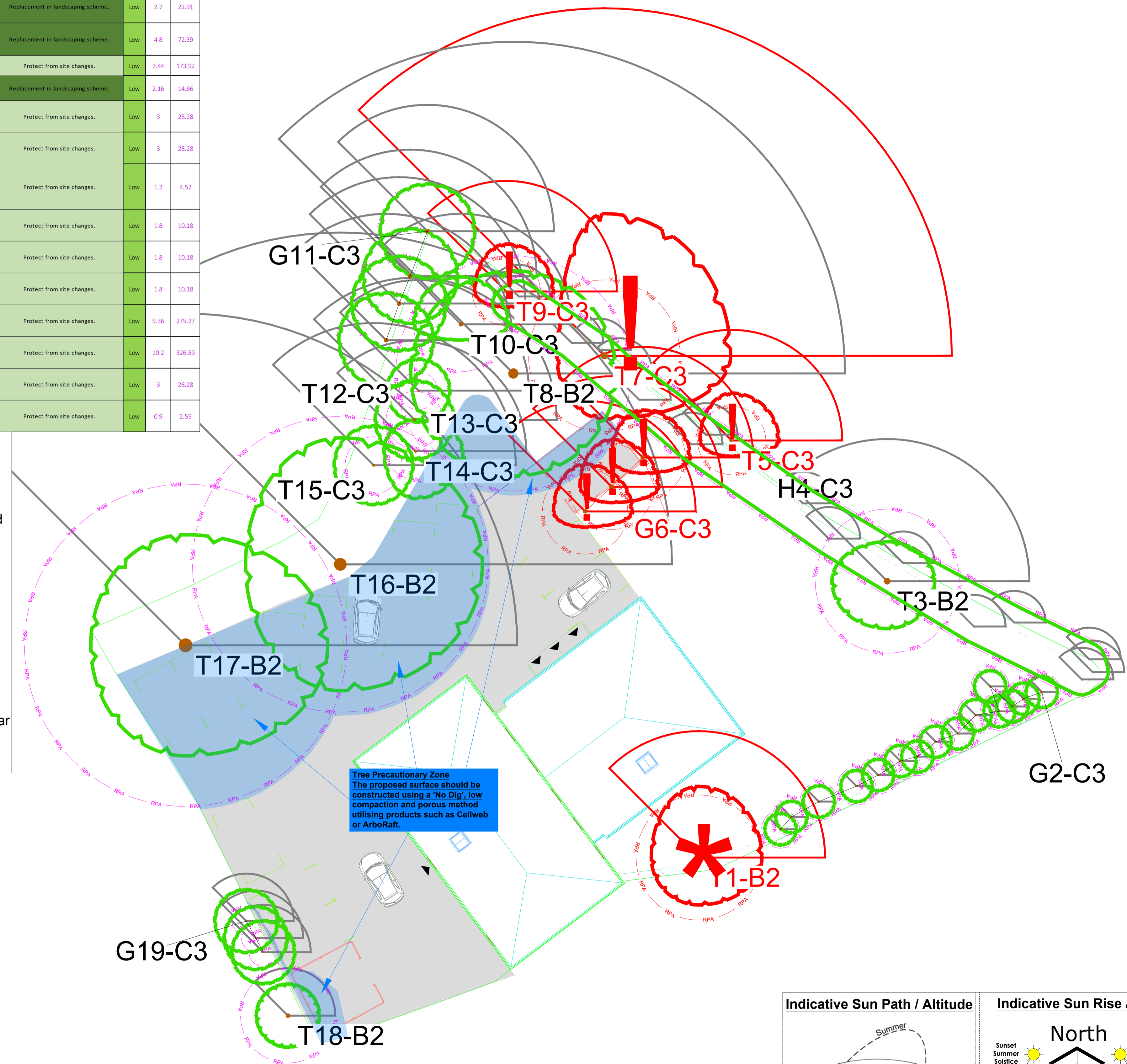

**Site Address:** 61-63 Moor Ln, Gomersal BD19 4LF

**Arboricultural Impact Assessment:**

No pruning is required or associated with the proposal.

The following trees and groups are recommended to be removed to protect the existing walls and garage.

T5, G6, T7 & T9.

The following tree is proposed to be removed for the scheme:

T1.

The current surfacing around the site is a mix of grassed lawn and tarmac car parking.

The proposed car parking areas lie within the footprint of the existing car park and therefore changes to the soil surface are not proposed. However, if a new surface is proposed for the car parking areas, the existing one should be removed carefully in order to avoid damage to the tree roots below and the new surface should be of 'above ground construction' using Cellweb or similar (subject to engineers assessment). The final surface should be porous to allow water penetration and gaseous exchange to the soil below.

**Tree Precautionary Zone**  
The proposed surface should be constructed using a 'No Dig', low compaction and porous method utilising products such as Cellweb or ArboRaft.

