

1 Existing LGF Mezzanine Plan - Fabric Removal
1 : 200

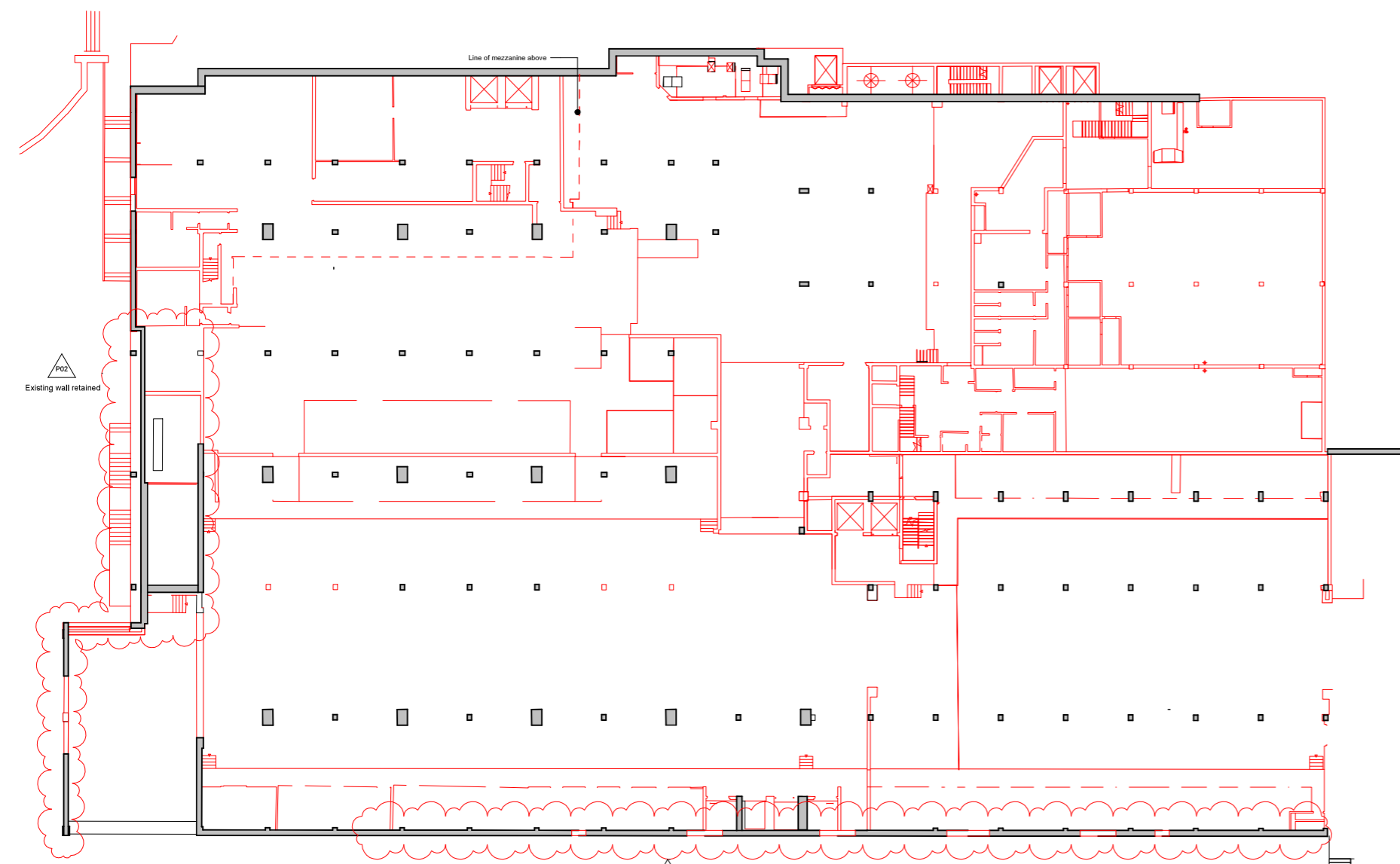

2 Existing LGF Plan - Fabric Removal
1 : 200

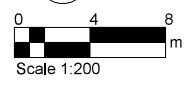

General Note

- Dimensions are not to be scaled from this drawing. All discrepancies in this drawing are to be reported to Feilden Clegg Bradley Studios. Drawing only to be used for the purposes it was issued for. Do not modify any element of this CAD drawing. Landscape, public realm and neighbouring buildings shown indicatively. This drawing is copyright.
- Existing locations and footprints of surrounding buildings are taken from: (OS Map - Promap-1634985-1735589-720-0.dwg) received 2021.10.27; (21359-100-Topo-Millimetres.dwg) received from Maltby Surveys on 2022.02.23
- Existing building survey information taken from Maltby survey model received 22.07.22 and Maltby Survey drawings received 28.04.22.

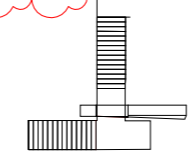
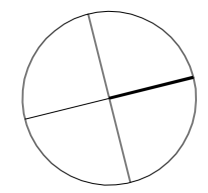

FeildenCleggBradleyStudios
LLP
London Office
Tottenham Street
London
W1T 4RG
t +44 20 7323 5737
e london@fcbstudios.com

Rev	Status	Date
P01	S2 Issued for Planning and Listed Building Consent Approval	30/09/22
P02	S2 Issued for Planning and Listed Building Consent Approval	01/12/22

Key	
	To be Retained
	To be Removed

Job/Drawing No	Revision
IR430301-FCB-XX-LG-DR-A-040190	P02
Kirklees Cultural Heart Huddersfield Library - Fabric Removal Drawing Lower Ground Floor Plan	Status S2
Scale 1 : 200@A1 Date 07/25/22	FCBS project no IR430301
Do not scale	All dimensions to be checked on site