

site plan - as existing - 1 : 200

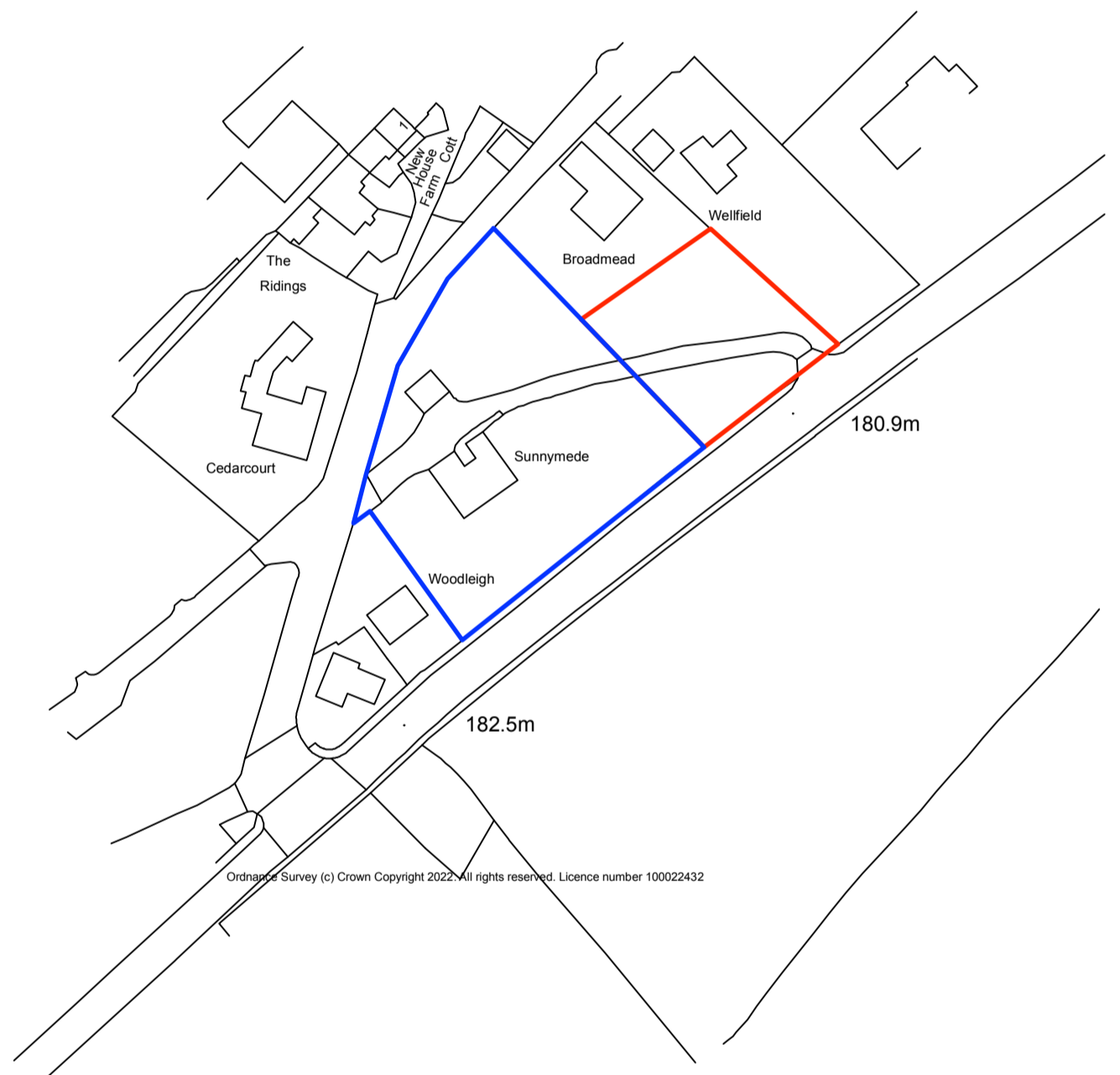

site location plan - 1 : 1250



site section a-a - as existing - 1 : 200

This drawing has been prepared specifically for the purpose of obtaining Planning Permission and/or Building Regulation Approval. Its suitability for other purposes, without supplementary details and specifications cannot be guaranteed. The Permissions and/or Approvals are beyond the Architects control and no guarantee that such will be granted is given or to be inferred by reason of the preparation of this drawing. Only figured dimensions are to be used. All dimensions to be checked on site. This drawing together with the design is the property and copyright of the Architect and must not be reproduced without prior written permission.

P01	Drawing originated	28.04.22	LH	XX
rev.	description	date	drawn	approved



project Outline planning for new dwelling at Sunnymede, Woodhead Road, Holmfirth, HD9 2PX for Mr D Plumstead

title Site Plan as Existing
 number 22010D-03-P01
 scale 1:200/1:1250
 size A1