

LEGEND: TREE RETENTION & REMOVAL

NB The original of this drawing was produced in colour - a monochrome copy should not be relied upon.

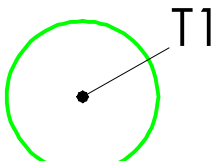

T1

Category A: High quality and/or value to be retained and protected to BS5837.

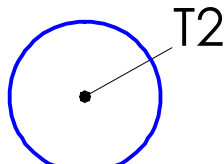

T2

Category B: Moderate quality and /or value to be retained and protected to BS5837.

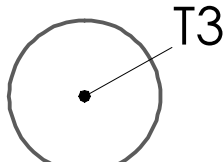

T3

Category C: Low quality and/or value to be retained and protected to BS5837.

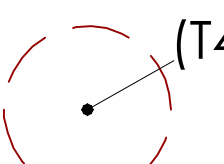

(T4)

Trees to be removed due to being in poor condition, unsuitable for retention.

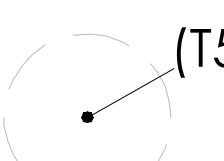

(T5)

Trees to be removed to facilitate the proposed development.

facility

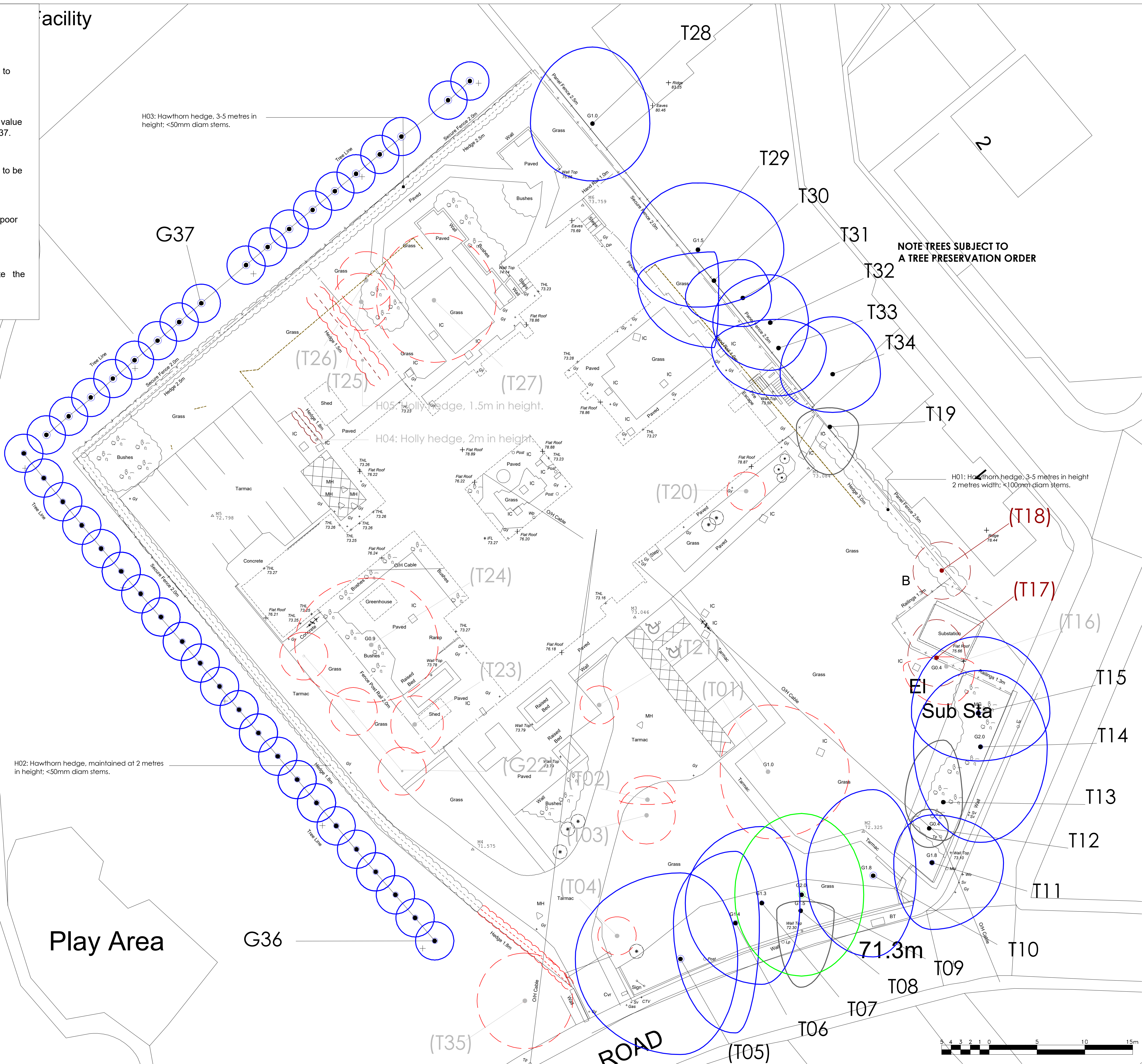

This drawing and the design it depicts are copyright and may not be copied or reproduced without written permission from Bea Landscape Design Ltd. No liability will be accepted for amendments made by others. This drawing is to be read in conjunction with the landscape specification and other relevant drawings.

Contains Ordnance Survey Data © Crown Copyright and Database Right 2020. © Crown Copyright. All rights reserved 100018739.

Refer any query to office of origination.

rev	date:	amendments:	alt:
A	08/01/2021	Graphic amended.	E.H
B	27/01/2021	T05 retained; T35 removed	DR

NOTE TREES SUBJECT TO A TREE PRESERVATION ORDER



client: KIRKLEES		
project: KNOWL PARK DEMENTIA FACILITY		
title: TREE RETENTION & REMOVAL PLAN		
status: PLANNING		
date: NOV' 20	drawn: DR	number: 20-069-08
scale@A1: 1:200	checked: ECH	revision: B
Bea Landscape Design Ltd 132A 'The Westlands', Compton Road, Wolverhampton, WV3 9GB T: 01902 424 950 / 01902 425 001 E: info@bealandscape.co.uk W: www.bealandscape.co.uk		