

Historical Mapping Legends

Ordnance Survey County Series 1:10,560

	Gravel Pit		Sand Pit		Other Pits
	Quarry		Shingle		Orchard
	Osiers		Reeds		Marsh
	Mixed Wood		Deciduous		Brushwood
	Fir		Furze		Rough Pasture
	Arrow denotes flow of water		Trigonometrical Station		
	Site of Antiquities		Bench Mark		
	Pump, Guide Post, Signal Post		Well, Spring, Boundary Post		
	•285 Surface Level				
	Sketched Contour		Instrumental Contour		
	Main Roads		Minor Roads		
	Sunken Road		Raised Road		
	Road over Railway		Railway over River		
	Railway over Road		Level Crossing		
	Road over River or Canal		Road over Stream		
	Road over Stream				
	County Boundary (Geographical)				
	County & Civil Parish Boundary				
	Administrative County & Civil Parish Boundary				
	County Borough Boundary (England)				
	County Burgh Boundary (Scotland)				
	Rural District Boundary				
	Civil Parish Boundary				

Ordnance Survey Plan 1:10,000

	Chalk Pit, Clay Pit or Quarry		Gravel Pit
	Sand Pit		Disused Pit or Quarry
	Refuse or Slag Heap		Lake, Loch or Pond
	Dunes		Boulders
	Coniferous Trees		Non-Coniferous Trees
	Orchard		Scrub
	Bracken		Heath
	Marsh		Reeds
	Building		Glasshouse
	Sloping Masonry		Pylon
	Cutting		Embankment
	Road Under		Road Over
	Level Crossing		Foot Bridge
	Standard Gauge Multiple Track		Standard Gauge Single Track
	Siding, Tramway or Mineral Line		Narrow Gauge
	Geographical County		Administrative County, County Borough or County of City
	Municipal Borough, Urban or Rural District, Burgh or District Council		Borough, Burgh or County Constituency
	Civil Parish		
	BP, BS Boundary Post or Stone		Police Station
	Church		Post Office
	Club House		Public Convenience
	Fire Engine Station		Public House
	Foot Bridge		Signal Box
	Fountain		Spring
	Guide Post		Telephone Call Box
	Mile Post		Telephone Call Post
	Mile Stone		Well

1:10,000 Raster Mapping

	Gravel Pit		Refuse tip or slag heap
	Rock		Rock (scattered)
	Boulders		Boulders (scattered)
	Shingle		Mud
	Sand		Sand Pit
	Slopes		Top of cliff
	General detail		Underground detail
	Overhead detail		Narrow gauge railway
	Multi-track railway		Single track railway
	County boundary (England only)		Civil, parish or community boundary
	District, Unitary, Metropolitan, London Borough boundary		Constituency boundary
	Area of wooded vegetation		Non-coniferous trees
	Non-coniferous trees (scattered)		Coniferous trees
	Coniferous trees (scattered)		Positioned tree
	Orchard		Coppice or Osiers
	Rough Grassland		Heath
	Scrub		Marsh, Salt Marsh or Reeds
	Water feature		Flow arrows
	Mean high water (springs)		Mean low water (springs)
	Telephone line (where shown)		Electricity transmission line (with poles)
	Bench mark (where shown)		Triangulation station
	Point feature (e.g. Guide Post or Mile Stone)		Pylon, flare stack or lighting tower
	Site of (antiquity)		Glasshouse
	General Building		Important Building



ARP GEOTECHNICAL LIMITED
CHARTERED CONSULTING ENGINEERS

Historical Mapping & Photography included:

Mapping Type	Scale	Date	Pg
Yorkshire	1:10,560	1854	3
Yorkshire	1:10,560	1894	4
Yorkshire	1:10,560	1907 - 1908	5
Yorkshire	1:10,560	1930	6
Yorkshire	1:10,560	1933	7
Yorkshire	1:10,560	1938	8
Yorkshire	1:10,560	1948 - 1949	9
Ordnance Survey Plan	1:10,000	1955 - 1956	10
Ordnance Survey Plan	1:10,000	1966 - 1969	11
Ordnance Survey Plan	1:10,000	1970 - 1979	12
Ordnance Survey Plan	1:10,000	1982 - 1984	13
Huddersfield	1:10,000	1984	14
Ordnance Survey Plan	1:10,000	1992	15
10K Raster Mapping	1:10,000	2006	16
10K Raster Mapping	1:10,000	2013	17

Historical Map - Slice A

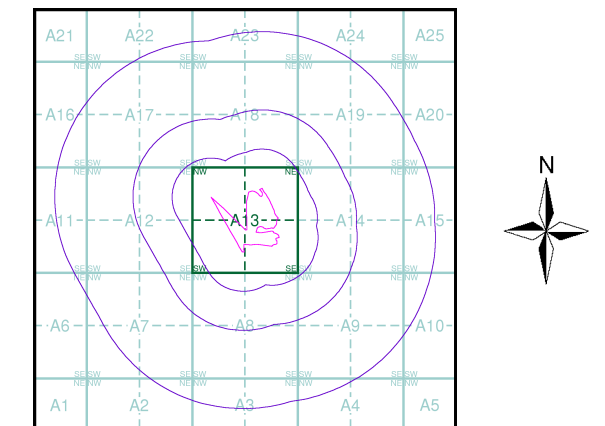

Order Details

Order Number: 47933383_1_1
Customer Ref: MLR/07
National Grid Reference: 414750, 411150
Slice: A
Site Area (Ha): 7.51
Search Buffer (m): 1000

Site Details

Land off Woodhead Rd, Brockholes, HOLMFIRTH, HD9 6PR



Tel: 0844 844 9952
Fax: 0844 844 9951
Web: www.envirocheck.co.uk

Russian Military Mapping Legends

1:5,000 and 1:10,000 mapping

a. Not drawn to scale b. Drawn to scale

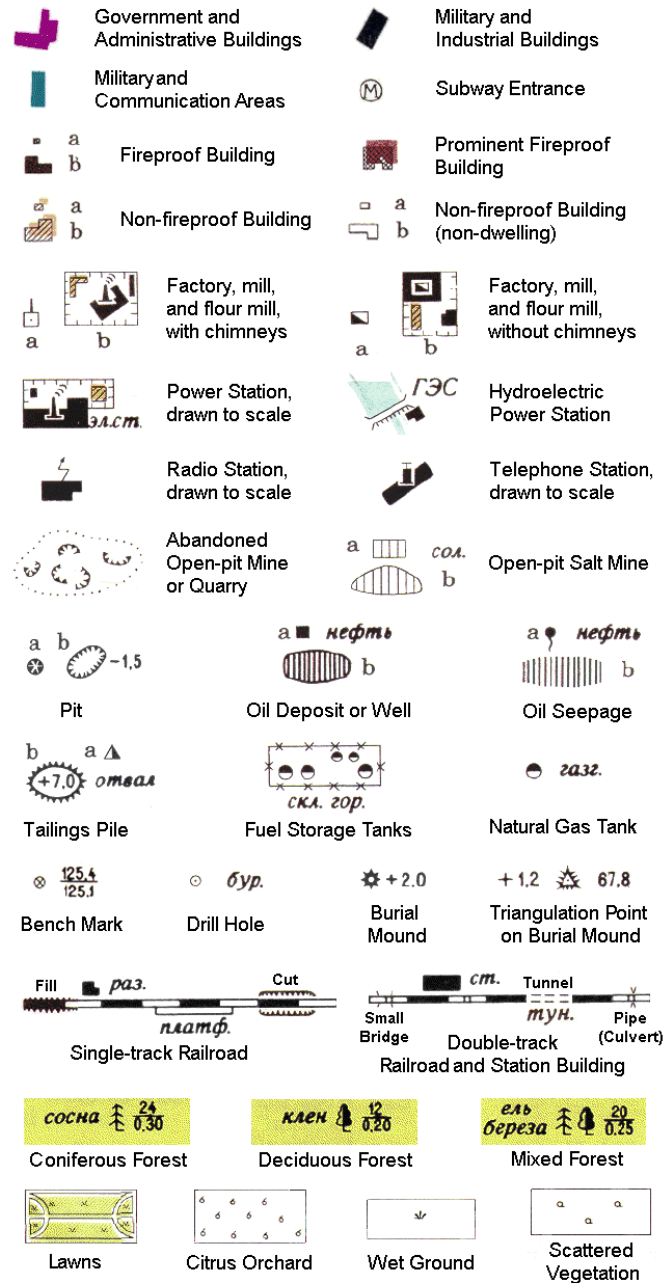

243.8 Values for prominent elevations

186.0 Numbers for spot elevations, depth soundings, contour lines, etc.

0.2 Velocity of the current, width of river bed, depth of river

180/12 Fractional terms: length and capacity of bridges; depth of fords and condition of the river bottom; height of forest and the diameter of trees

Russian Alphabet (For reference and phonetic interpretation of map text)

А а (A)	З з (Z)	П п (P)	Ч ч (CH)
Б б (B)	И и (I)	Р р (R)	Ш ш (SH)
В в (V)	Й й (Y)	С с (S)	Щ щ (SHCH)
Г г (G)	К к (K)	Т т (T)	Ъ (-)
Д д (D)	Л л (L)	У у (U)	Ы (Y)
Е е (E)	М м (M)	Ф ф (F)	Ь (')
Ё ё (YO)	Н н (N)	Х х (KH)	Э э (E)
Ж ж (ZH)	О о (O)	Ц ц (TS)	Ю ю (YU or IU)
			Я я (YA or IA)

1:25,000 mapping

a. Not drawn to scale b. Drawn to scale

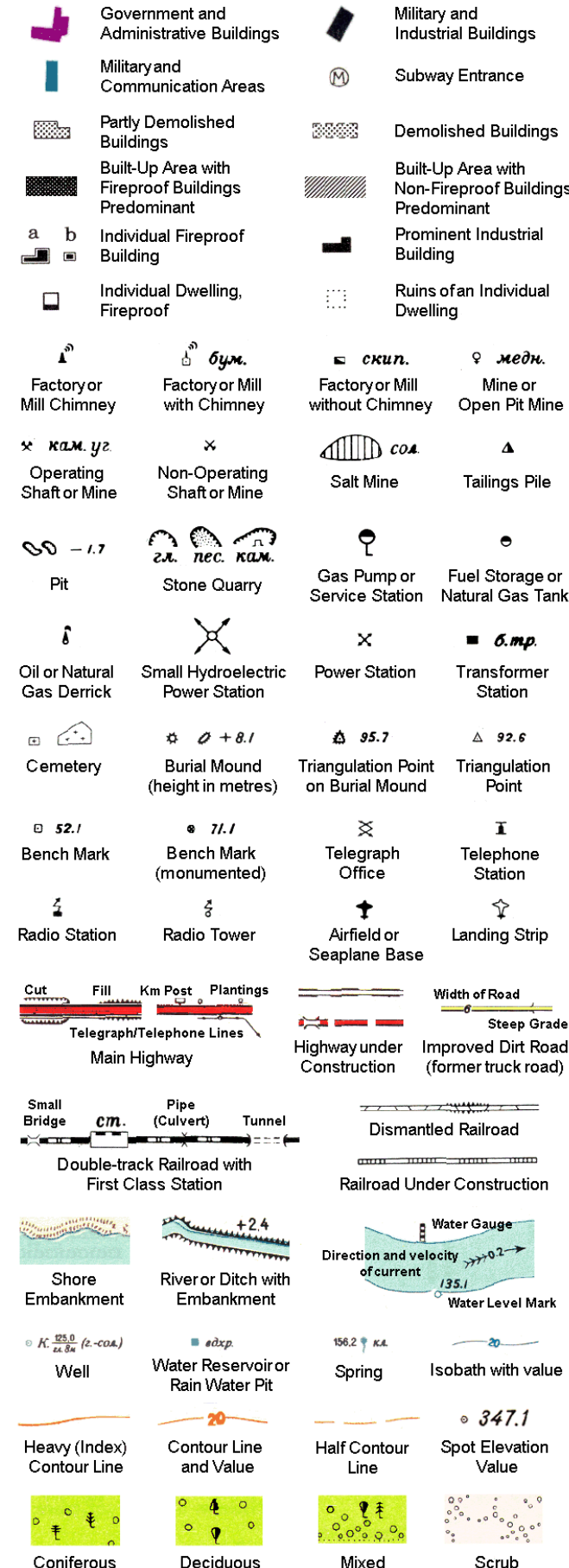

Key to Numbers on Mapping

SE11SW_Huddersfield

No.	Description
26	Police Station/Headquarters
34	Industrial Building (Use Unknown)
46	Sewage Works



ARP GEOTECHNICAL LIMITED
CHARTERED CONSULTING ENGINEERS

Historical Mapping & Photography included:

Mapping Type	Scale	Date	Pg
Yorkshire	1:10,560	1854	3
Yorkshire	1:10,560	1894	4
Yorkshire	1:10,560	1907 - 1908	5
Yorkshire	1:10,560	1930	6
Yorkshire	1:10,560	1933	7
Yorkshire	1:10,560	1938	8
Yorkshire	1:10,560	1948 - 1949	9
Ordnance Survey Plan	1:10,000	1955 - 1956	10
Ordnance Survey Plan	1:10,000	1966 - 1969	11
Ordnance Survey Plan	1:10,000	1970 - 1979	12
Ordnance Survey Plan	1:10,000	1982 - 1984	13
Huddersfield	1:10,000	1984	14
Ordnance Survey Plan	1:10,000	1992	15
10K Raster Mapping	1:10,000	2006	16
10K Raster Mapping	1:10,000	2013	17

Russian Map - Slice A

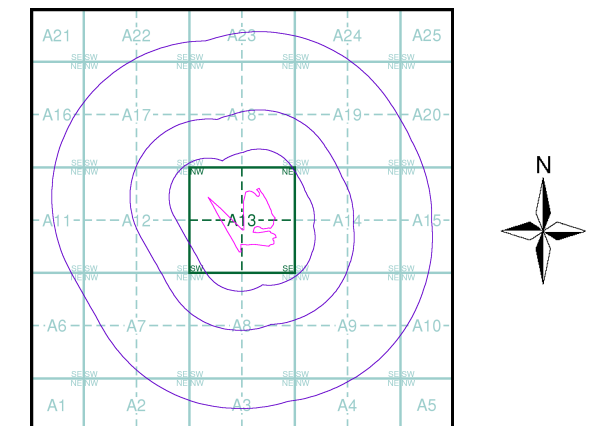

Order Details

Order Number: 47933383_1_1
Customer Ref: MLR/07
National Grid Reference: 414750, 411150
Slice: A
Site Area (Ha): 7.51
Search Buffer (m): 1000

Site Details

Land off Woodhead Rd, Brockholes, HOLMFIRTH, HD9 6PR



Tel: 0844 844 9952
Fax: 0844 844 9951
Web: www.envirocheck.co.uk



ARP GEOTECHNICAL LIMITED
CHARTERED CONSULTING ENGINEERS

Yorkshire

Published 1854

Source map scale - 1:10,560

The historical maps shown were reproduced from maps predominantly held at the scale adopted for England, Wales and Scotland in the 1840's. In 1854 the 1:2,500 scale was adopted for mapping urban areas; these maps were used to update the 1:10,560 maps. The published date given therefore is often some years later than the surveyed date. Before 1938, all OS maps were based on the Cassini Projection, with independent surveys of a single county or group of counties, giving rise to significant inaccuracies in outlying areas. In the late 1940's, a Provisional Edition was produced, which updated the 1:10,560 mapping from a number of sources. The maps appear unfinished - with all military camps and other strategic sites removed. These maps were initially overprinted with the National Grid. In 1970, the first 1:10,000 maps were produced using the Transverse Mercator Projection. The revision process continued until recently, with new editions appearing every 10 years or so for urban areas.

Map Name(s) and Date(s)

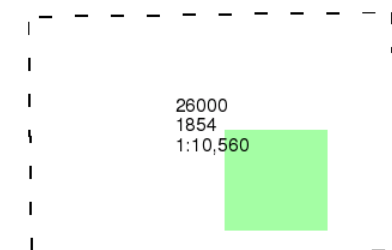

Historical Map - Slice A

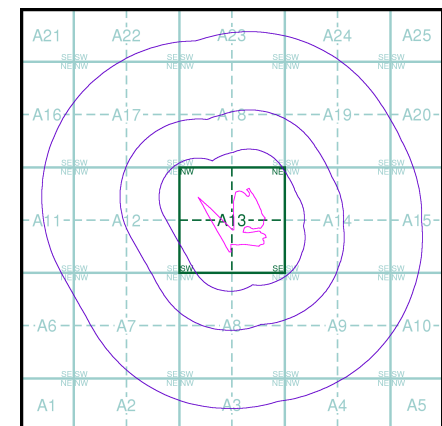

Order Details

Order Number: 47933383_1_1
Customer Ref: MLR/07
National Grid Reference: 414750, 411150
Slice: A
Site Area (Ha): 7.51
Search Buffer (m): 1000

Site Details

Land off Woodhead Rd, Brockholes, HOLMFIRTH, HD9 6PR



Tel: 0844 844 9952
Fax: 0844 844 9951
Web: www.envirocheck.co.uk

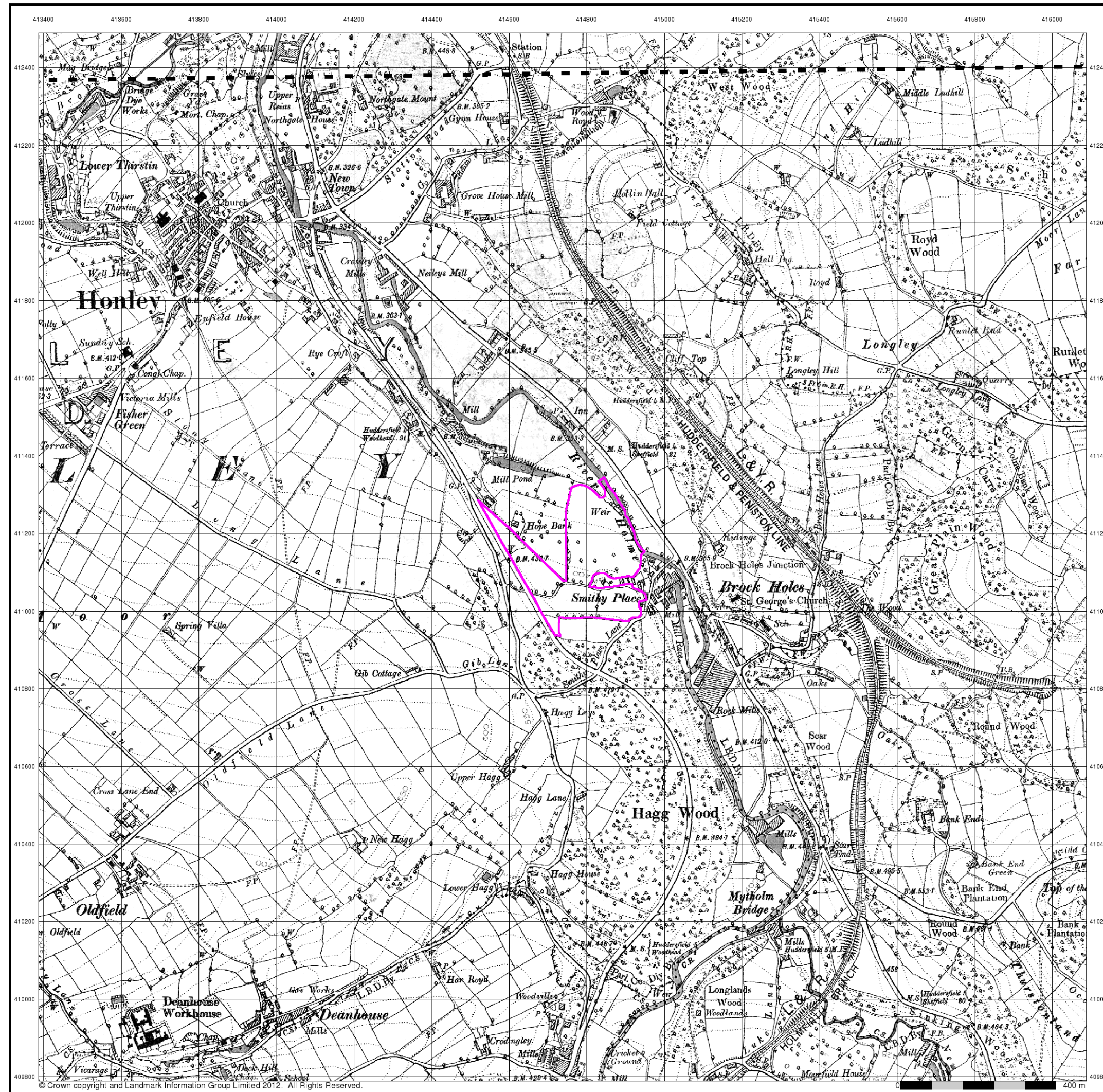

© Crown copyright and Landmark Information Group Limited 2012. All Rights Reserved.



ARP GEOTECHNICAL LIMITED
CHARTERED CONSULTING ENGINEERS

Yorkshire

Published 1894

Source map scale - 1:10,560

The historical maps shown were reproduced from maps predominantly held at the scale adopted for England, Wales and Scotland in the 1840's. In 1854 the 1:2,500 scale was adopted for mapping urban areas; these maps were used to update the 1:10,560 maps. The published date given therefore is often some years later than the surveyed date. Before 1938, all OS maps were based on the Cassini Projection, with independent surveys of a single county or group of counties, giving rise to significant inaccuracies in outlying areas. In the late 1940's, a Provisional Edition was produced, which updated the 1:10,560 mapping from a number of sources. The maps appear unfinished - with all military camps and other strategic sites removed. These maps were initially overprinted with the National Grid. In 1970, the first 1:10,000 maps were produced using the Transverse Mercator Projection. The revision process continued until recently, with new editions appearing every 10 years or so for urban areas.

Map Name(s) and Date(s)

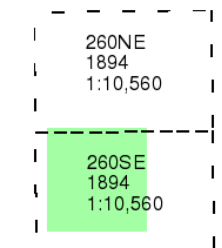

Historical Map - Slice A

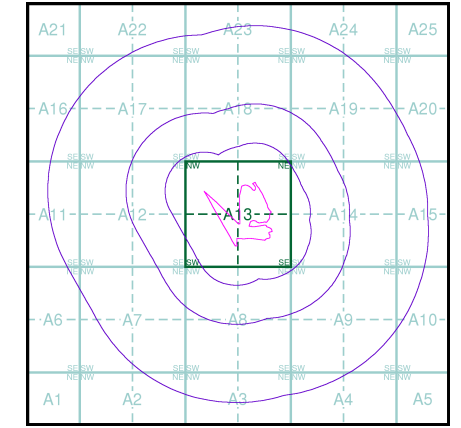

Order Details

Order Number: 47933383_1_1
Customer Ref: MLR/07
National Grid Reference: 414750, 411150
Slice: A
Site Area (Ha): 7.51
Search Buffer (m): 1000

Site Details

Land off Woodhead Rd, Brockholes, HOLMFIRTH, HD9 6PR



Tel: 0844 844 9952
Fax: 0844 844 9951
Web: www.envirocheck.co.uk



ARP GEOTECHNICAL LIMITED
CHARTERED CONSULTING ENGINEERS

Yorkshire

Published 1907 - 1908

Source map scale - 1:10,560

The historical maps shown were reproduced from maps predominantly held at the scale adopted for England, Wales and Scotland in the 1840's. In 1854 the 1:2,500 scale was adopted for mapping urban areas; these maps were used to update the 1:10,560 maps. The published date given therefore is often some years later than the surveyed date. Before 1938, all OS maps were based on the Cassini Projection, with independent surveys of a single county or group of counties, giving rise to significant inaccuracies in outlying areas. In the late 1940's, a Provisional Edition was produced, which updated the 1:10,560 mapping from a number of sources. The maps appear unfinished - with all military camps and other strategic sites removed. These maps were initially overprinted with the National Grid. In 1970, the first 1:10,000 maps were produced using the Transverse Mercator Projection. The revision process continued until recently, with new editions appearing every 10 years or so for urban areas.

Map Name(s) and Date(s)

260NE
1908
1:10,560
260SE
1907
1:10,560

Historical Map - Slice A

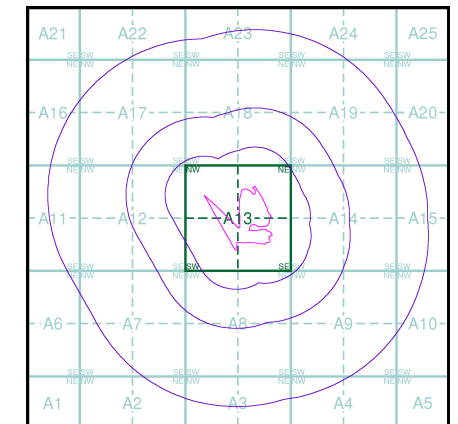

Order Details

Order Number: 47933383_1_1
Customer Ref: MLR/07
National Grid Reference: 414750, 411150
Slice: A
Site Area (Ha): 7.51
Search Buffer (m): 1000

Site Details

Land off Woodhead Rd, Brockholes, HOLMFIRTH, HD9 6PR



Tel: 0844 844 9952
Fax: 0844 844 9951
Web: www.envirocheck.co.uk

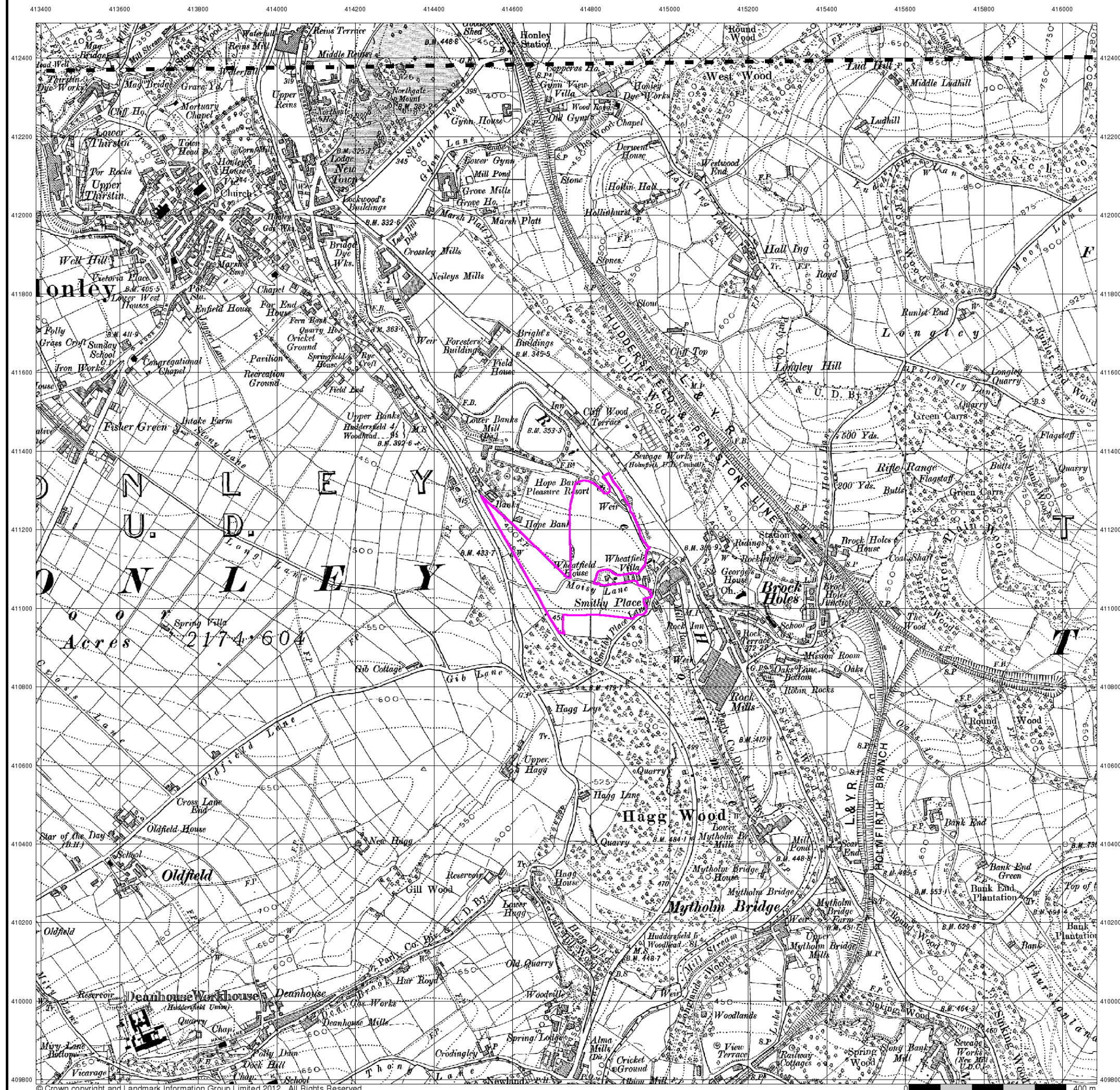



Yorkshire

Published 1930

Source map scale - 1:10,560

The historical maps shown were reproduced from maps predominantly held at the scale adopted for England, Wales and Scotland in the 1840's. In 1854 the 1:2,500 scale was adopted for mapping urban areas; these maps were used to update the 1:10,560 maps. The published date given therefore is often some years later than the surveyed date. Before 1938, all OS maps were based on the Cassini Projection, with independent surveys of a single county or group of counties, giving rise to significant inaccuracies in outlying areas. In the late 1940's, a Provisional Edition was produced, which updated the 1:10,560 mapping from a number of sources. The maps appear unfinished - with all military camps and other strategic sites removed. These maps were initially overprinted with the National Grid. In 1970, the first 1:10,000 maps were produced using the Transverse Mercator Projection. The revision process continued until recently, with new editions appearing every 10 years or so for urban areas.

Map Name(s) and Date(s)

260NE
1930
1:10,560



Historical Map - Slice A

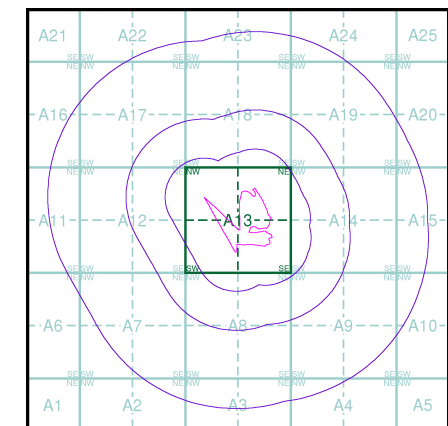

Order Details

Order Number: 47933383_1_1
Customer Ref: MLR/07
National Grid Reference: 414750, 411150
Slice: A
Site Area (Ha): 7.51
Search Buffer (m): 1000

Site Details

Land off Woodhead Rd, Brockholes, HOLMFIRTH, HD9 6PR

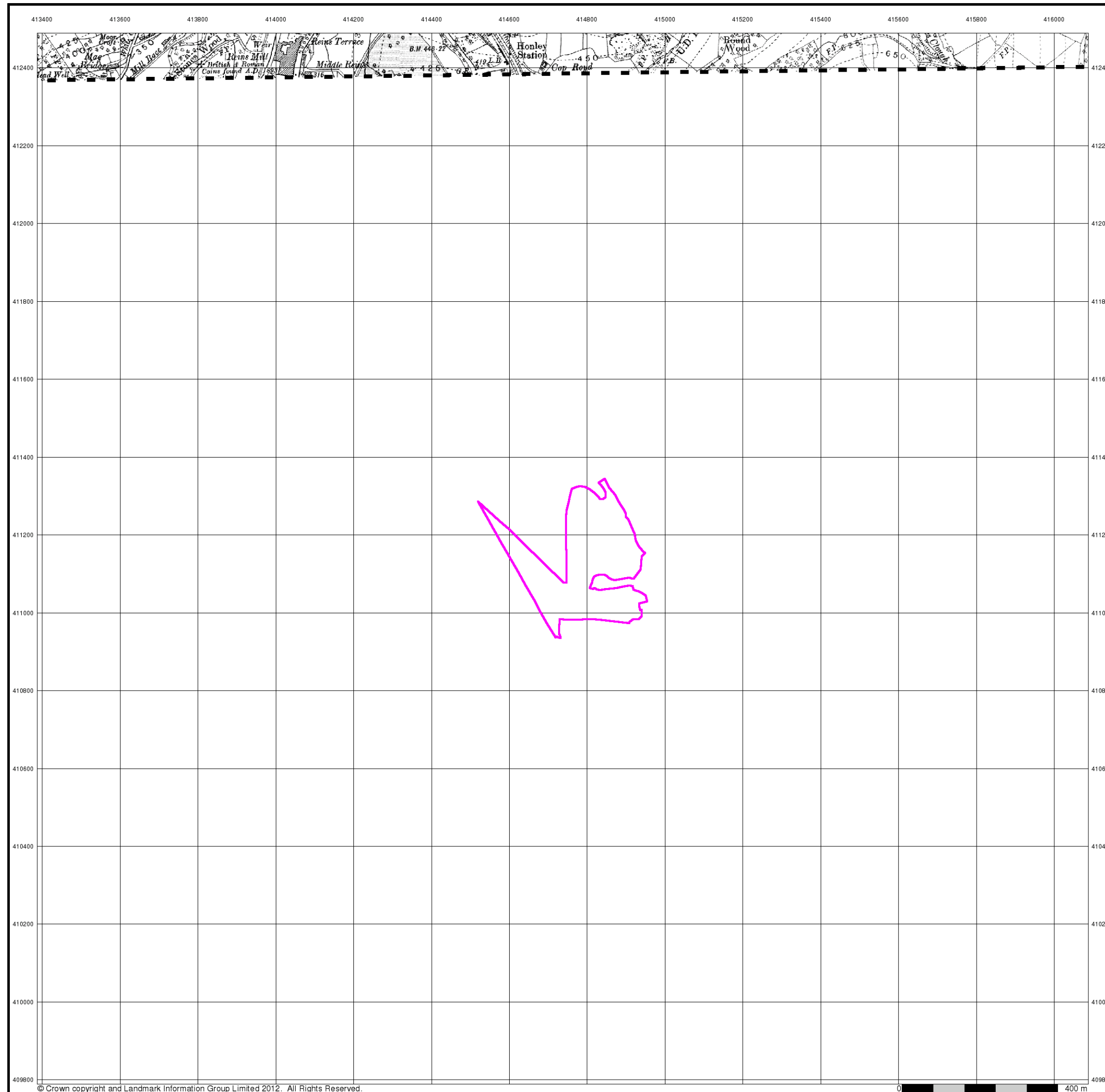

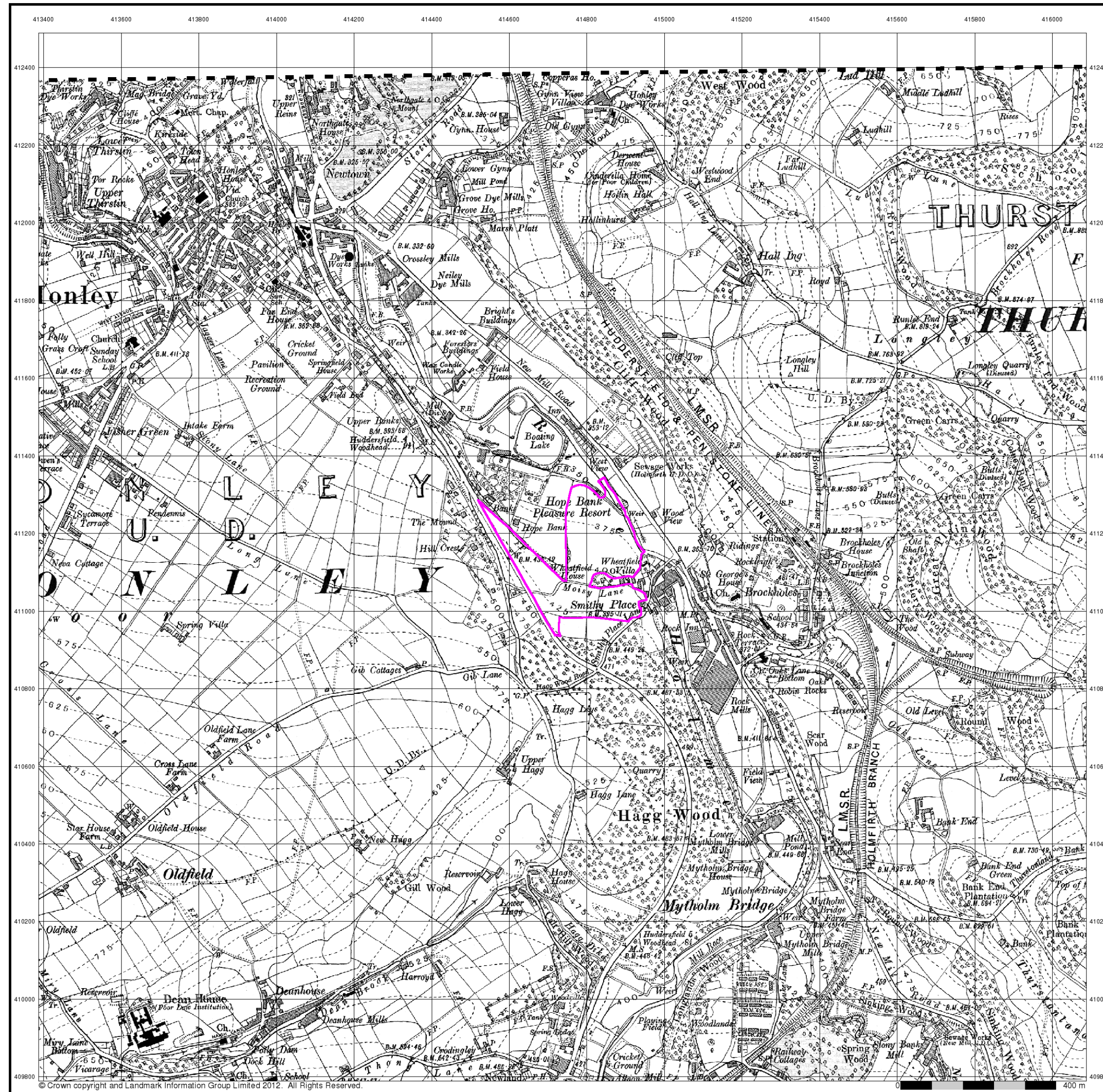

ARP GEOTECHNICAL LIMITED
CHARTERED CONSULTING ENGINEERS

Yorkshire

Published 1933

Source map scale - 1:10,560

The historical maps shown were reproduced from maps predominantly held at the scale adopted for England, Wales and Scotland in the 1840's. In 1854 the 1:2,500 scale was adopted for mapping urban areas; these maps were used to update the 1:10,560 maps. The published date given therefore is often some years later than the surveyed date. Before 1938, all OS maps were based on the Cassini Projection, with independent surveys of a single county or group of counties, giving rise to significant inaccuracies in outlying areas. In the late 1940's, a Provisional Edition was produced, which updated the 1:10,560 mapping from a number of sources. The maps appear unfinished - with all military camps and other strategic sites removed. These maps were initially overprinted with the National Grid. In 1970, the first 1:10,000 maps were produced using the Transverse Mercator Projection. The revision process continued until recently, with new editions appearing every 10 years or so for urban areas.

Map Name(s) and Date(s)

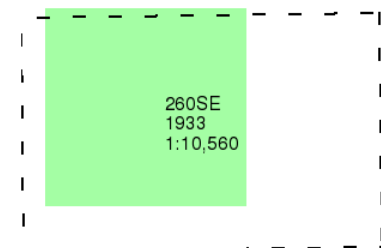

Historical Map - Slice A

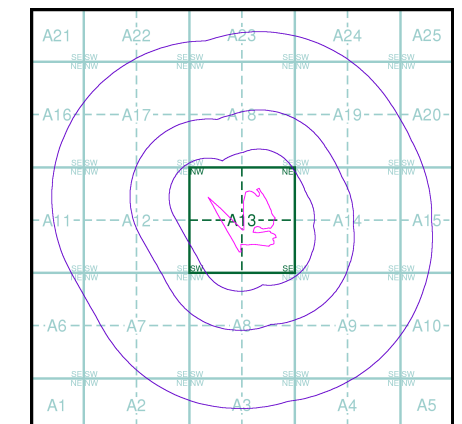

Order Details

Order Number: 47933383_1_1
Customer Ref: MLR/07
National Grid Reference: 414750, 411150
Slice: A
Site Area (Ha): 7.51
Search Buffer (m): 1000

Site Details

Land off Woodhead Rd, Brockholes, HOLMFIRTH, HD9 6PR



Tel: 0844 844 9952
Fax: 0844 844 9951
Web: www.envirocheck.co.uk