

1

## Window Type A

1 : 20

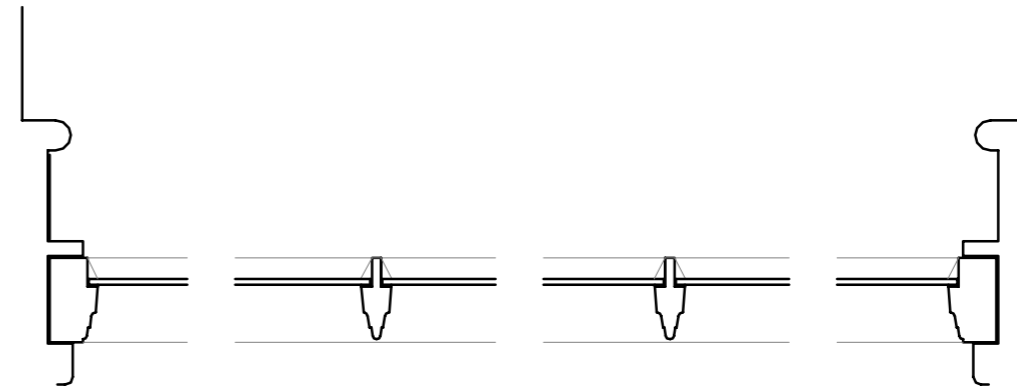

Existing

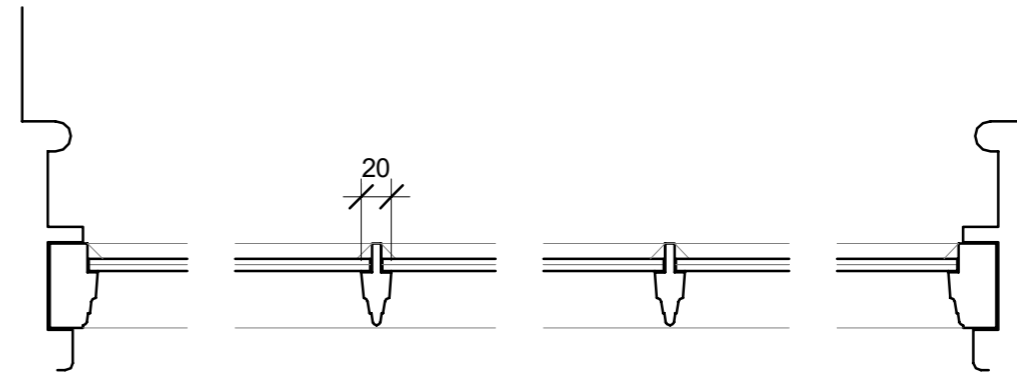

Proposed

2

## Window type A

1 : 5

### Windows:

Contractor to record and number all sliding sash windows, including corresponding top and bottom sash prior to works commencing. Sliding sash windows to have the following works undertaken:

- Modern draught strips to be carefully removed from existing windows
- Remove top and bottom sashes for repair and upgrading to vacuum (minimum rebate of 19mm required)
- Retain box frame in situ and undertake repairs to frame and cill as necessary
- Re-balance weights and replace pulley cords to both top and bottom sashes
- Undertake paint analysis to sample selection of window frames to determine re-decoration
- Install new timber parting beads and staff beads with rebated brush seals with central fin
- Install rebated draught seals to meeting rails and perimeter of sashes

There is a variety of window furniture extant within the building from different periods, these will require rationalisation and replacement.

P2	Minor amendment to windows following meeting with Conservation Officer	08/03/22	HW	
P1	Amendment to elevation	09/11/21	HW	
Revision	Date	By	Chk	

All dimensions to be verified on site, and the Architect informed of any discrepancy. All drawings and specifications should be read in conjunction with the Health and Safety Plan; all conflicts should be reported to the appointed Principal Designer.

Kirklees Council  
 Station Gateway, Huddersfield  
 St George's Square, Huddersfield HD1 1JA

Sheet Name: Window Type A Detail

Purpose of issue: Status:

Date: 07/02/21 Checked by:

Drawn by: HW Scale @ A3: As indicated

Project No: 4004 Revision: P2

Drawing No: 4004-BOW-A1-ZZ-DR-A-5001

