

Notes

Do not scale from drawing, use figured dimensions only.
 All dimensions must be checked and verified on site prior to commencement of work and architect to be notified of any discrepancies.
 This drawing is intended to permit overall scheme proposals only and cannot be used for construction purposes without further information.

| Rev | Drawn | Checked | Date |
|-----|-------|---------|------------|
| A | FWG | | 01.08.2021 |
| B | FWG | | 08.10.2021 |
| C | FWG | | 26.11.2021 |
| D | FWG | | 03.12.2021 |
| E | FWG | | 21.02.2022 |
| F | FWG | | 25.07.2022 |
| G | FWG | | 19.08.2022 |
| H | FWG | | 19.09.2022 |
| I | FWG | | 19.10.2022 |

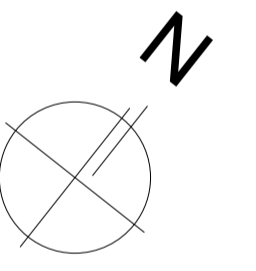
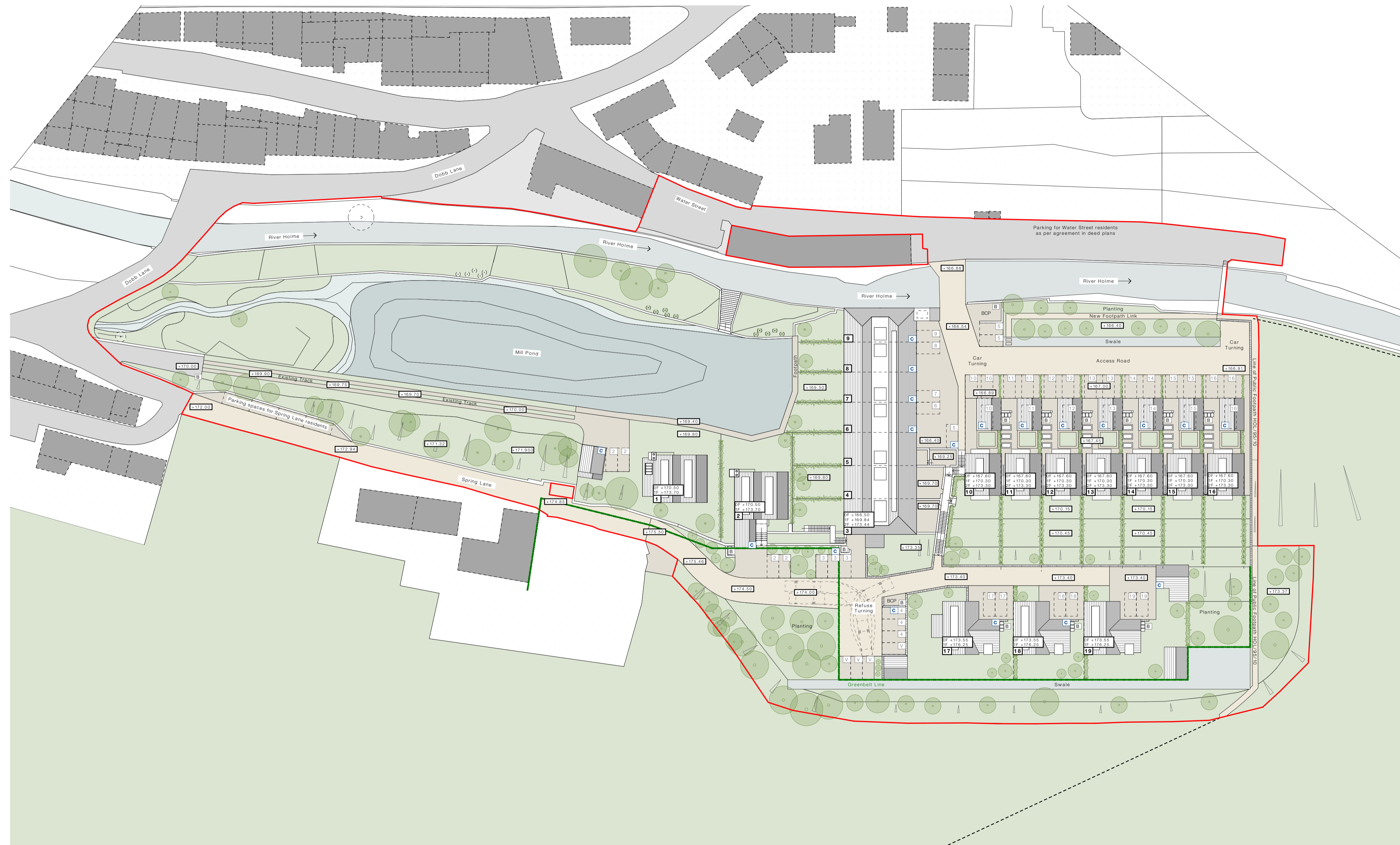

KEY

- B Bin Collection Point
- C Electric Car Charging Point

| | |
|--|------------------------|
| Job Title Proposed Residential Development, Hinchcliffe Mill, Holmfirth, HD9 2NX | |
| Client MD One Ltd | Company AD |
| Drawing Overall Site Plan | |
| Scale @ A1 1:500 | |
| Date Jan '21 | Drawn / Checked FWG |
| Drawing No. 3372 (0-) 623 | Revision 1 |

Proposed Overall Site Plan 1:500

ONE17
 ARCHITECTS & INTERIOR DESIGNERS

The Dyehouse, Armitage Bridge
 Huddersfield, West Yorkshire HD4 7PD
 T 01484 668 000 F 01484 668 001
 E solutions@one17design.com
ONE17DESIGN.COM