



GEO

Environmental Engineering



PHASE 1: COAL MINING DESK TOP STUDY REPORT
(PRELIMINARY COAL MINING RISK ASSESSMENT)

PROPOSED RESIDENTIAL DEVELOPMENT

27 CHURCH LANE

MIRFIELD

WF14 9HX

FOR:

MR G YOUNG

GEO Environmental Engineering

DOCUMENT CONTROL SHEET

Report Ref: 2020-4543

Report Date: 21.01.2021

Report Type: DRAFT CMRA DTS

Prepared By: Andrew Hampson *B.Sc. (Hons) FGS* – Geo Environmental Engineer/Associate

Checked By: Curtis Evans *B.Sc. (Hons) FGS* – Geo Environmental Engineer/Director

Signature:

Redacted

Client: Mr G Young

Consultant: Bradbury PM Limited

CONTENTS

Section		Page
1.0	Introduction	4
2.0	Site Location and Development Proposals	5
3.0	Geological Setting	6
4.0	Conclusions and Recommendations	9
Appendix I:	Site Location Plan Aerial Photograph Extract Existing Site Layout Plan (Topographical Survey) Proposed Site Layout Plan	
Appendix II:	The Coal Authority Coal Mining Consultants Report & Online Database (CA) BGS Geological Plan Extract (247NW Mirfield) Historical BGS Borehole Records (SE22SW184 & SE22SW205)	

1.0 Introduction

1.1 Instruction

GEO Environmental Engineering (GEO) Ltd has completed a Phase 1: Coal Mining Desk Top Study Report (Preliminary Coal Mining Risk Assessment) for the proposed residential property within the existing garden of the adjacent property, 27 Church Lane, Mirfield, WF14 9HX to determine any potential coal mining related geohazards that may affect the proposed redevelopment of the site.

GEO has been commissioned to complete the report by the Consultant, Bradbury PM Limited on behalf of the Client, Mr G Young.

The Phase 1: Coal Mining Desk Top Study Report (Preliminary Coal Mining Risk Assessment) is to be used for submission to the Local Authority as part of the planning application as it is the Client's intention for an area of the existing garden to be redeveloped with a single residential property as detailed in Appendix I. Further development details are available from the Consultant.

1.2 Aims and Objectives

The aims and objectives of this Phase 1: Coal Mining Desk Top Study Report (Preliminary Coal Mining Risk Assessment) are to assess the geological sensitivity of the development area and the immediate surrounding environs with respect to potential coal mining related geohazards that could pose a potential risk of ground subsidence/movement/settlement, mine entries or ground gas that could negatively affect the proposed development.

During the completion of this appraisal, information has been obtained and reviewed from the following sources:

- British Geological Survey Published Geological Plans (BGS) – an extract given in Appendix II.
- The Coal Authority Coal Mining Consultants Report and Online Database (CA – Appendix II).

1.3 Limitations of Use

The information, assessments, conclusions and recommendations presented within this report are solely based on, and are limited to, the boundaries of the site, with the approximate location of the site marked on the Site Location Plan in Appendix I.

Any comments, opinions, diagrams, cross sections and/or sketches contained within the DTS, and/or any configuration of the findings is purely conjectural and given for guidance only as no intrusive investigation works have been completed by GEO and it is recommended that confirmation of the anticipated ground conditions should be considered before development proceeds.

The conclusions and recommendations presented within this report are considered reasonable based on the available information. However, these cannot be guaranteed to gain regulatory approval. Therefore, the report should be passed to the appropriate regulatory authorities and/ or other key stakeholders in order to seek their approval of the findings prior to undertaking any works on site. GEO accepts no responsibility for the accuracy of third party information involved within the completion of this report.

Agreement for the use or copying of this report by any Third Party must be obtained in writing from GEO. Reliance on the report is strictly in accordance with GEO standard terms and conditions.

Any items not specifically mentioned cannot be assumed to be covered.

2.0 Site Location and Development Proposals

2.1 Site Location

The site is rectangular in shape and is currently the location of existing gardens in the grounds of 27 Church Lane in Mirfield which has a large garden to the north which is to be the location of the proposed property. The site is centred on National Grid Reference 421216, 420207.

2.2 Existing Site Levels

From the plans provided, the site is shown to fall from the northeast (c.50m AOD) to the southwest (45m AOD). A copy is attached in Appendix I.

2.3 Existing Site Surfacing and Buildings

The area of the proposed property is free from structures and is located in an existing garden of 27 Church Lane, Mirfield.

2.4 Development Proposal

It is understood that the proposal is for the development of a single residential property as detailed in Appendix I. Further development details are available from the Consultant.

3.0 Geological Setting

3.1 Development Area Geology

A geological review of the site has been undertaken using information provided by the BGS by-way of Geological Plan Sheet 77 Huddersfield (Solid and Drift, 1: 50,000 Scale) and 247NW Mirfield (1:10,560 Scale) with chosen extracts provided as part of Appendix II.

3.1.1 Made Ground

A review of published geological plans does not indicate the presence of made ground materials on site.

Although no historical assessment has been undertaken as part of this report, it is envisaged that topsoil and possibly re-worked materials may be present on site associated with the adjacent property developments and landscaping of the existing garden. These materials are unlikely to be present to significant depths.

3.1.2 Drift Geological Deposits

A review of published geological plans indicates that the site is devoid of drift geological deposits although residual soils may be present possibly comprising clay, sand, gravel, etc. Where present, these deposits are unlikely to be present to significant depths.

3.1.3 Solid Geological Deposits

The BGS Geological Plan indicates that the site is underlain by the Carboniferous Coal Measures strata typically comprising layers of Mudstone, Siltstone and Sandstone with seatearths and productive coal seams.

Reference to the BGS suggests the site close to and possibly underlain by the Fal House Rock (Sandstone) with mudrocks to the west.

The BGS and the CA suggests that the closest coal seam is the Blocking Bed which subcrops to the south / southwest of the site and dips to the north / northeast below the site. Within the surrounding area, numerous other subcropping coal seams are present which also dip to below the site.

From the BGS plan (247NW) the following information has been noted;

- A mine entry / shaft is recorded c.145m north of the site and is located to the rear of the existing Church. At this location, the Blocking Bed (the same which subcrops to the south / southwest and dips below the site) is encountered at a depth of 42ft (c.12.08m).
- A geological note to the northeast records the Blocking Bed to be 1ft 8" thick (c.0.51m).
- Another note to the northwest recorded the same coal seam to at a depth of 43ft (c.13.01m) and is 2ft 3" thick (c.0.69m).

The CA website records the mine entry noted above as being c.12.8m deep and was utilised to target a coal seam which is considered to be the Blocking Bed. A copy of 247NW is attached in Appendix II.

3.1.4 Geological Features

The CA does not note the presence of any geological structural fault lines as passing through the site or within close proximity to the site. However, the BGS plan notes a fault on the opposite side of Church Lane which downthrows to the east.

In addition to the above, the borehole location plan that accompanies the historical borehole records (Appendix II) indicates that a “fault zone” is present which trends in a northeast to southwest direction and which is located c.90m south / southwest of the site.

To the north of the “fault zone”, all boreholes completed note an absence of any coal seams and / or geohazards associated with shallow coal mine workings. However, from the borehole records available that were positioned to the south of the “fault zone”, they each record a “shallow and intact coal seam” typically c.0.6m to c.0.7m thick and at varying depths of between c.3.5m to c.9.4m

Due to the presence of the “fault zone” the Blocking Bed coal seam appears to have been displaced to the north of the fault as well as being impacted to the south given the varying depths that the coal seam was encountered.

3.1.5 The Coal Authority Correspondence

The underlying Solid geological deposits are recorded by the Carboniferous Coal Measures strata typically comprising layers of Mudstone, Siltstone and Sandstone with seatearths and productive coal seams.

Site specific reference has been made to The Coal Authority (CA) by way of a CA Coal Mining Consultants Report, (Ref: 51002393634001, Appendix II), referenced as follows:

- Past Underground Mining: One seam has been recorded as being worked beneath the site with this seam noted to be the Black Bed at depths of c.149m and c.155m with an extraction of c.0.76m.
- Probable Unrecorded Shallow Workings (less than 30m): Yes.
- Outcrops: None.
- Spine Roadways at Shallow Depth: None.
- Mine Entries: None recorded within c.100m.
- Coal Mining Subsidence: No claims.

Reference to the On-line Database (Interactive Map Viewer) has identified the following:

- Coal seams are indicated as sub cropping and surrounding the site.
- No mine shafts are recorded within c.100m of the site.
- The site is recorded as being within a CA defined “High Risk Development Area”.
- The CA records no shallow coal mine workings on site.
- The CA suggests probable unrecorded shallow coal mine workings below the site.
- The site does not lie within an area of surface (opencast) mining (historical or current). However, an area to the east / northeast has undergone historical opencast mining although there are no records to what depth and what seam(s) was targeted suggesting that shallow coal may be present at shallow depth.

3.1.6 Historical BGS Borehole Records (SE22SW184 & 205)

A search of the BGS Online Database has recorded numerous boreholes to the south, southwest, west and northwest were undertaken in c.1988 and completed as part of the adjacent residential development on Pinfold Lane, Mirfield. Borehole SE22SW205 is located c.16m from the site boundary and c.25m from the rear of the proposed property. On this borehole record, the following information was noted;

- Soil and clay traces were recorded to a depth of c.1.7m.
- Mudstones and shales with sandstone bands were recorded to a depth of c.12.5m.
- The borehole was terminated at this depth with no geohazards noted (i.e. voids, workings, etc).

As discussed in Section 3.1.4, a “fault zone” is present c.90m south / southwest of the site and trends in a northeast to southwest direction. Numerous boreholes to the south of the “fault zone” have recorded the presence of an intact coal seam with one record noted below.

BGS borehole SE22SW184 has recorded the following;

- Soil and clay recorded to a depth of c.1.3m.
- Clay with sandstone fragments to c.2.0m.
- Mudstones and shales were recorded to a depth of c.9.4m and between c.10.1m to c.12.0m
- An intact coal seam was encountered between c.9.4m to c.10.1m (c.0.7m thick).
- The borehole was terminated at a depth c.12.0m with no geohazards noted (i.e. voids, workings, etc).

3.1.7 Coal Mining Overview

As a result of the above information and in-conjunction with the desk-based information available from the CA, the site would appear to be at potential risk from the Blocking Bed coal seam given that the CA suggests “probable unrecorded workings are present below the site” as well as the site being located in their “High Risk Development Area”.

However, the historical borehole record located c.25m from the rear of the proposed property has not recorded any geohazards (i.e. voids, broken ground, etc.) which are associated with historical mining activities with solid deposits noted from c.1.7m down to a terminal depth of c.12.5m.

As noted in section 3.1.4 and 3.1.6, numerous boreholes were undertaken as part of historical intrusive investigation works with these works identifying a “fault zone” located to the south / southwest of the site, which appears to have displaced the Blocking Bed coal seam. Therefore, as a result of the faulting it is not considered to be within an influencing depth of the surface to impact on the proposed development.

Therefore, based on the information presented to GEO, the development site is not considered to be at potential risk of coal mining related geohazards in the form of unrecorded shallow coal mine workings beneath the site.

It should be noted that GEO is not responsible for third party information and records may be inaccurate or incomplete. Consequently, GEO recommends that care and consideration of potential mining features should be made by the developer during construction.

4.0 Conclusions and Recommendations

Utilising all of the above information, it has been identified that the site is not at (structural) risk from potential unrecorded shallow coal workings (i.e. voids, broken ground, etc.) below the development site and remedial measures (i.e. grouting) are not considered necessary.

However, a potential exists for mine gas migrations within this area, particularly as deeper workings are recorded beneath the site. Therefore it is recommended that a period of ground gas monitoring be undertaken to determine if the proposed structure requires ground gas protection measures.

As part of any future development works, GEO recommends that a “watching brief” and “observational technique” be applied to this site to ensure that if ground conditions appear to vary from those identified within this investigation report then advice should be sought from a suitably qualified and experienced Engineering Geologist, Geotechnical or Geo-Environmental Engineer.

The conclusions and recommendations presented within this report are considered reasonable based on the available information. However, these cannot be guaranteed to gain regulatory approval. Therefore, the report should be passed to the appropriate regulatory authorities and/ or other key stakeholders as soon as practicably possible in order to seek their approval of the findings prior to undertaking any works on site. GEO accepts no responsibility for the accuracy of third party information involved within the completion of this report.

End of Report

Appendix I

- Site Location Plan
- Aerial Photograph Extract
- Existing Site Layout Plan (Topographical Survey)
- Proposed Site Layout Plan

GEO2020-4543: Site Location Plan (Approximate Site Location)

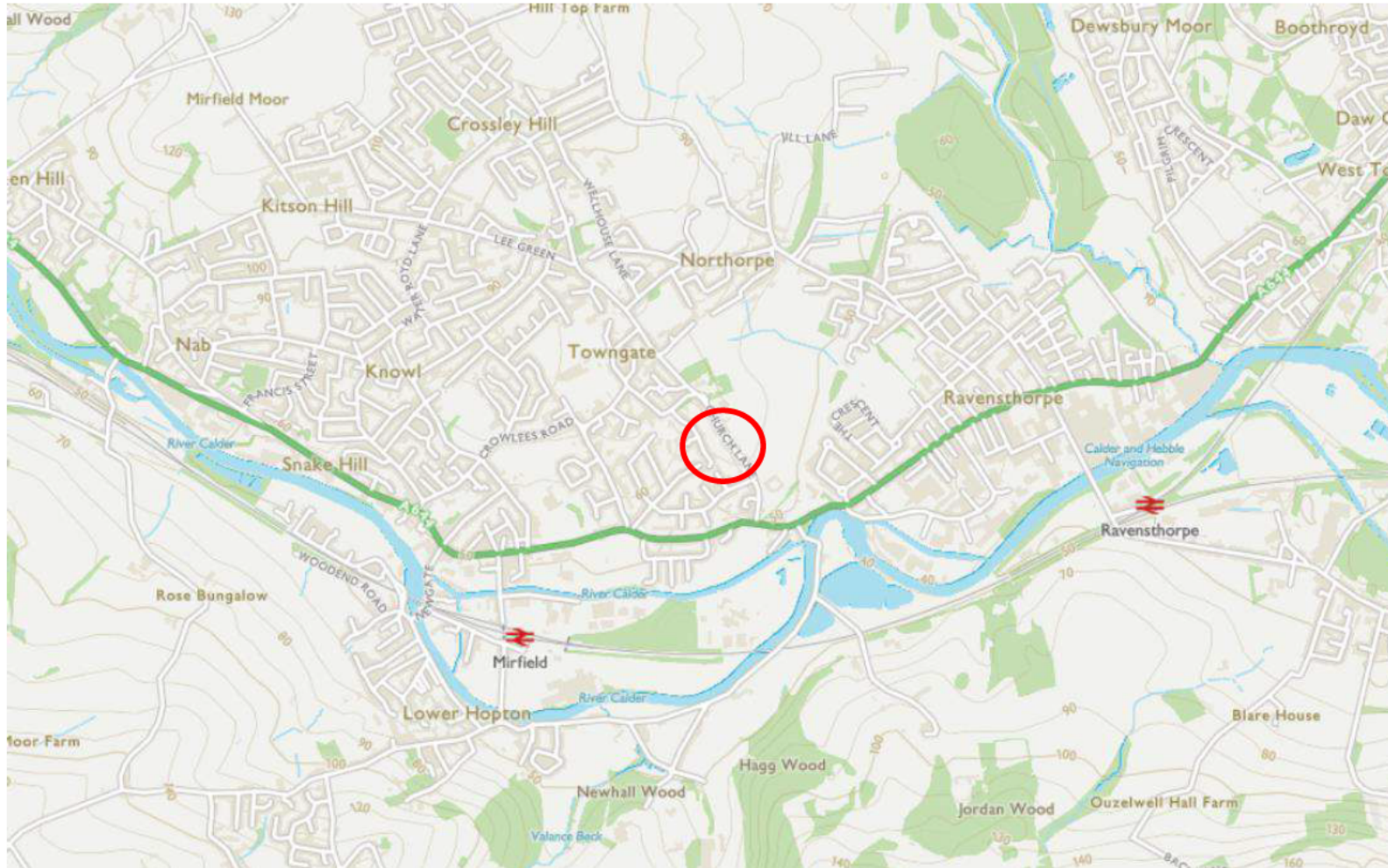

GEO2020-4543: Aerial Photograph Extract (Approximate Site Location)

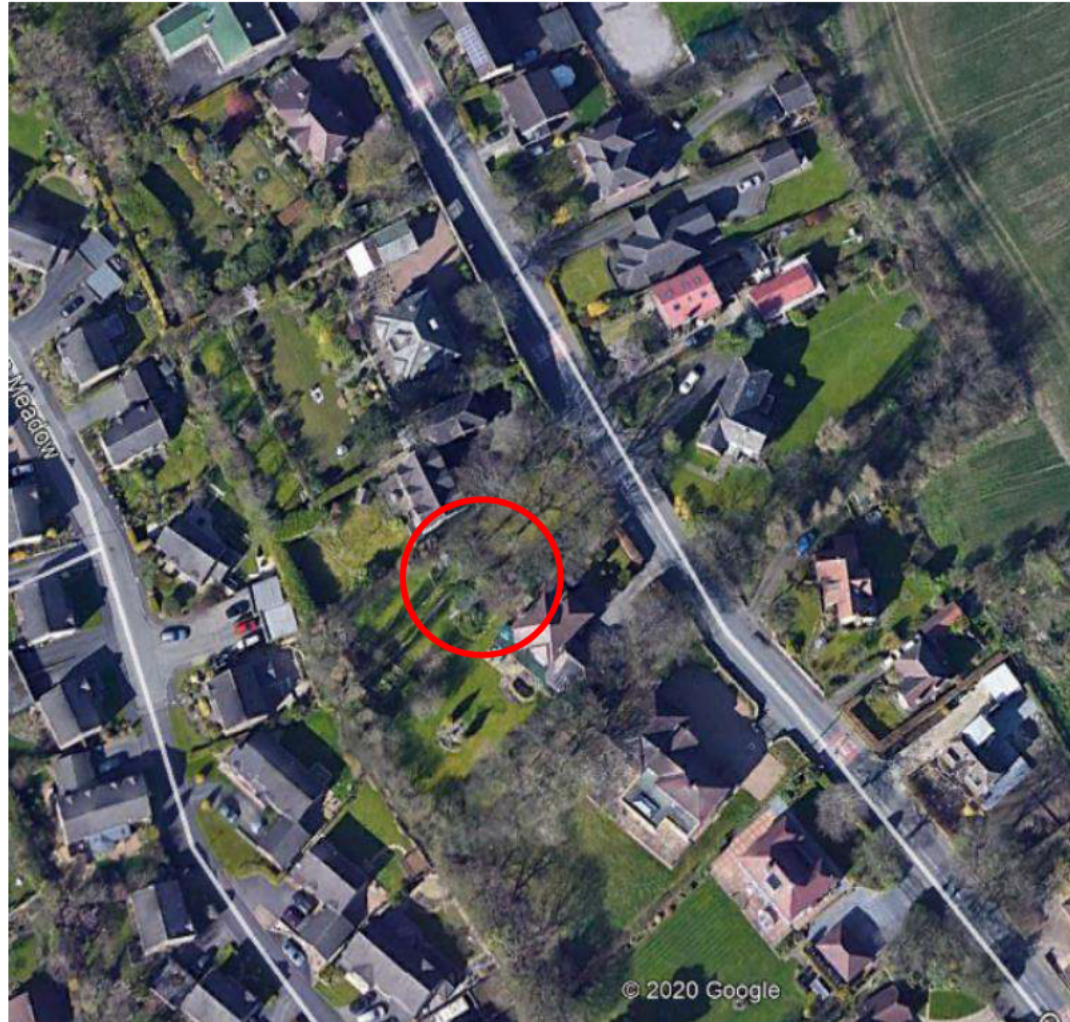

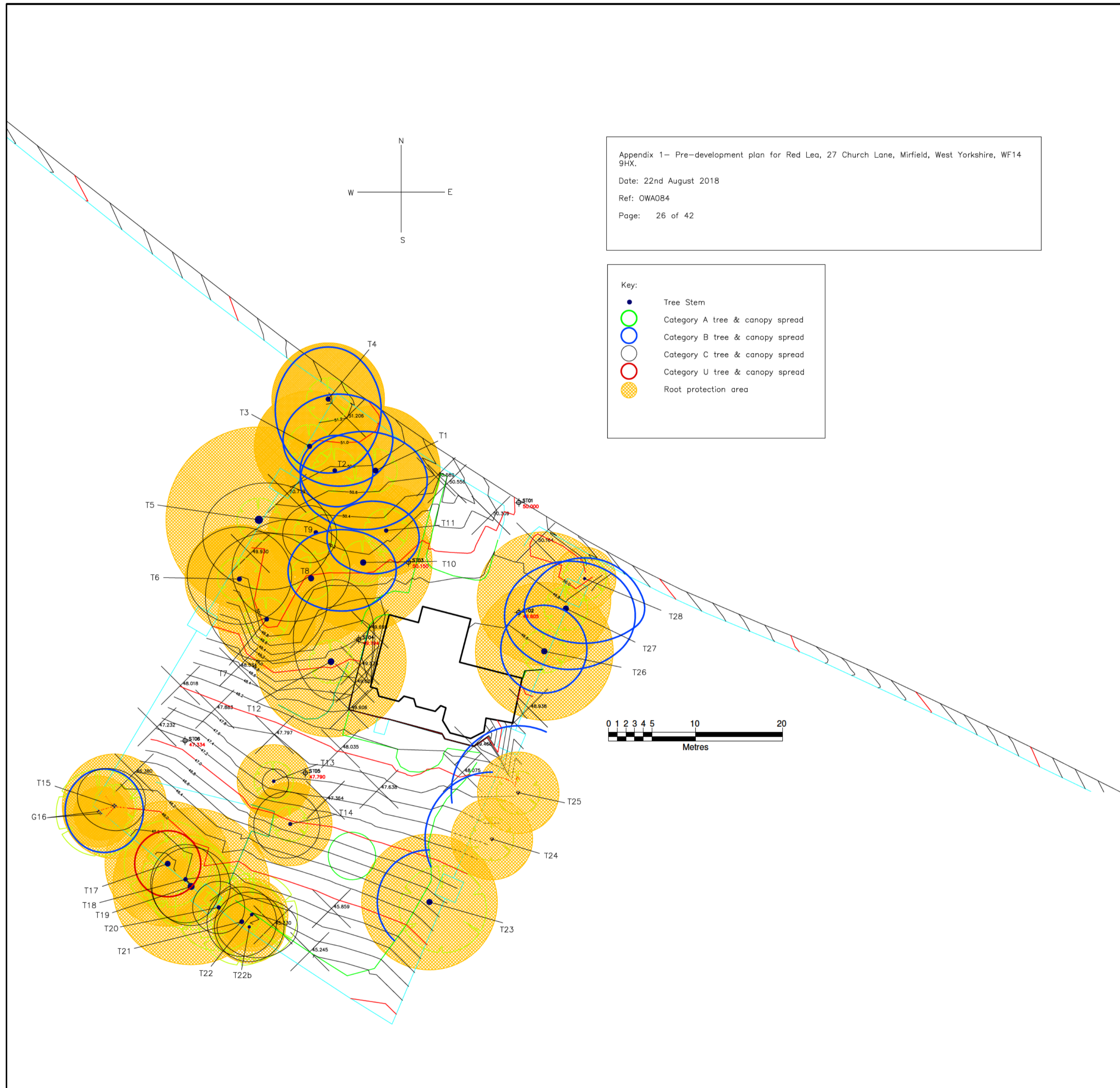

SITE SURVEY
 TREE SURVEY COMPLETED BY ONEWORLD ARBORICULTURAL CONSULTANTS
 SEE ARBORICULTURAL REPORT

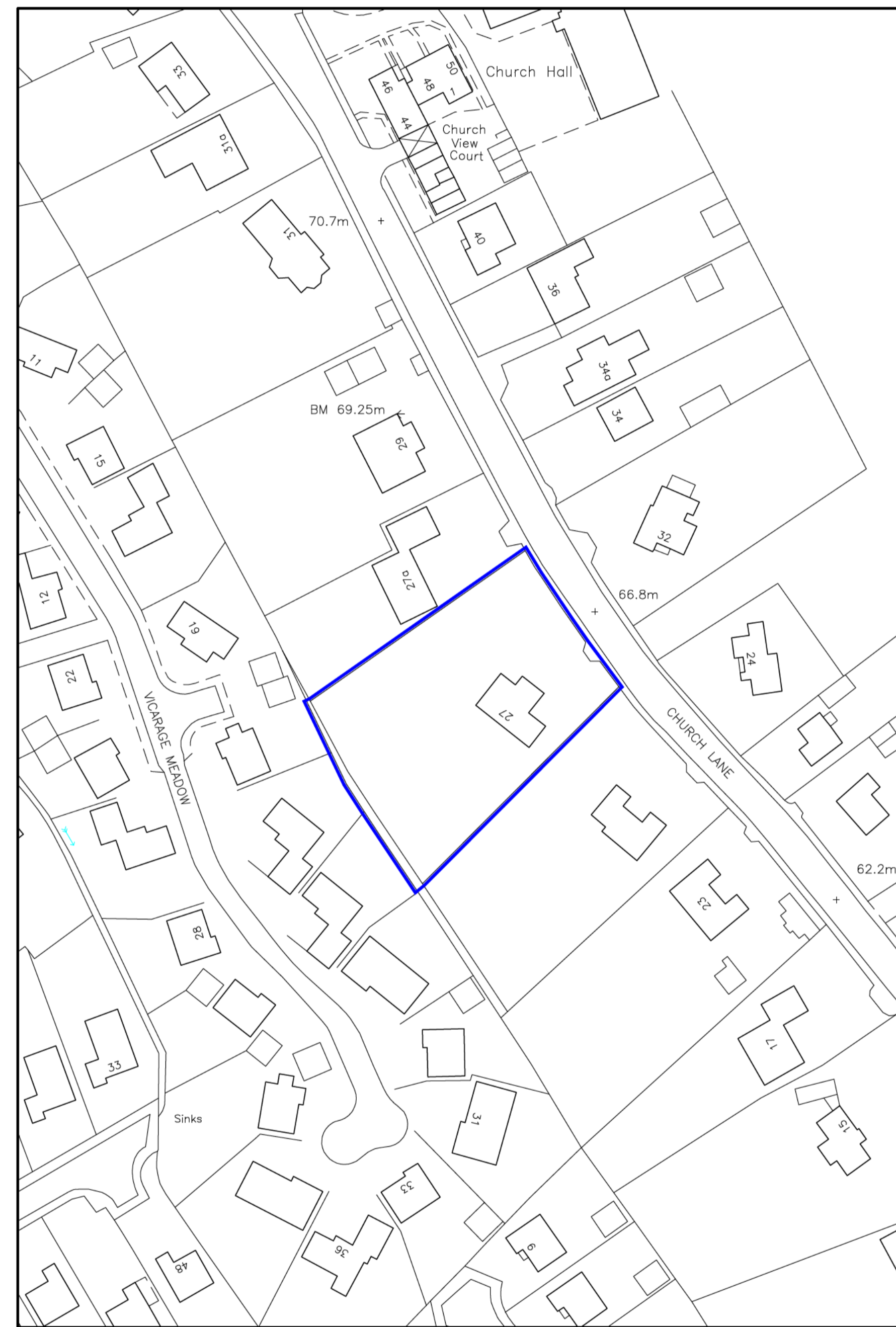

ORDNANCE SURVEY

NOTES

Planning notes
 These drawings have been prepared for the purpose of an outline planning submission only.
 All forms of construction and detailing are solely the responsibility of the builder.

Where applicable both planning and building regulation approval must be obtained before work commences. If there is any doubt please consult the designer or the appropriate Local Authority department.

Planning reserved matters
 Planning approval notice to be checked for all reserved matters relevant to the proposal.

The Planning system can do nothing to assist owners when boundary disputes arise.

TELE 0113 2525825
 MOB 07973 519015
 Email mick@mjcoates.com

T J Coates Ltd
 2 Unity Hall Court
 Haigh Moor Road
 West Ardsley
 Wakefield WF3 1BE

DESIGN

CLIENT Mr & Mrs Young
 27 Church Lane
 Mirfield
 WF14 9HX

PROJECT Proposed Detached Dwelling
 Land adjacent 27 Church Lane
 Mirfield
 WF14 9HX

TITLE Existing site plan and location plan

SCALE	SITE PLAN 1:200 LOCATION PLAN 1:1250	DATE	28.08.2020
DRAWN BY	MC	CHECKED	
DRAWING NO	364-P01	REVISION	

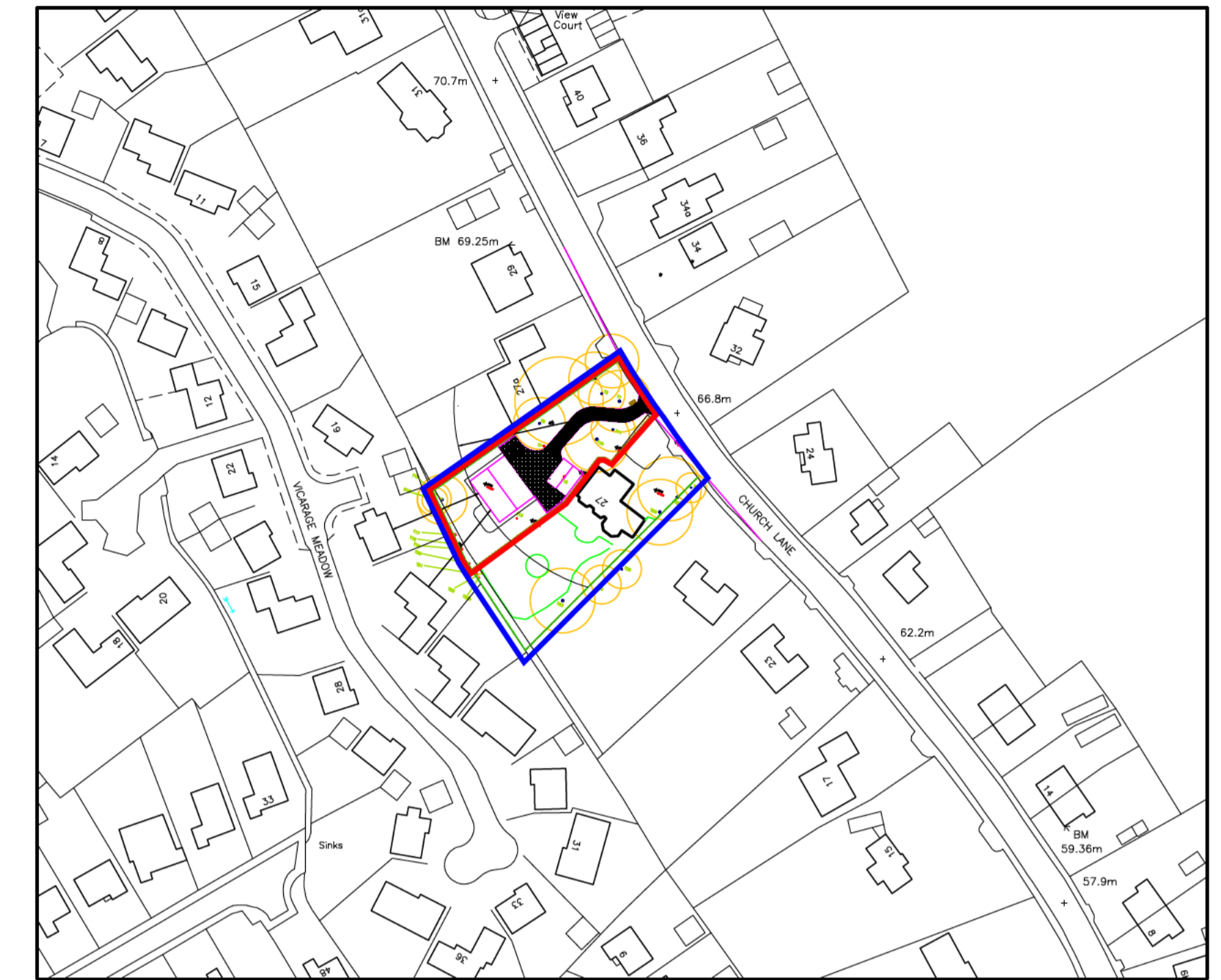

Key

- Proposed 2.1m high fence with 0.30m concrete gravel board, 100 x 100mm posts with 1.8m ship lap fence infill panels, finish dark oak cuplimol
- Existing fence and hedge line to remain
- Decayed tree removal see arboricultural report
- Tree route zone
- Tree number
- 2.4 x 43 Site line
- Bin store enclosure
- CellWeb TRP fitted to BS5837 2005
- Permeable hard surfacing
- Concrete paved path and patio area

RE- PLANTING SCHEME AND SOFT LANDSCAPING BY ONEWORD ARBORICULTURAL CONSULTANTS

Planning notes
These drawings have been prepared for the purpose of a outline planning submission only.
Where applicable both planning and building regulation approval must be obtained before work commences. If there is any doubt please consult the designer or the appropriate Local Authority department.
Planning reserved matters
Planning approval notice to be checked for all reserved matters relevant to the proposal.
The Planning system can do nothing to assist owners when boundary disputes arise.

T J Coates Ltd
2 Unity Hall Court
Haigh Moor Road
West Ardsley
Wakefield WF3 1BE

DESIGN

CLIENT Mr & Mrs Young
27 Church Lane
Mirfield
WF14 9HX

PROJECT Proposed Detached Dwelling
Land adjacent 27 Church Lane
Mirfield
WF14 9HX

TITLE Proposed site plan and location plan

SCALE	SITE PLAN 1:200 LOCATION PLAN 1:1250	DATE	28.08.2020
DRAWN BY	MC	CHECKED	
DRAWING NO	364-P02	REVISION	

Appendix II

- The Coal Authority Coal Mining Consultants Report & Online Database Extracts (CA)
- BGS Geological Plan Extract (247NW Mirfield)
- Historical BGS Borehole Records (SE22SW184 & SE22SW205)



The Coal
Authority

Consultants Coal Mining Report

Land At 27 Church Lane
Mirfield
Kirklees
WF14 9HX

Date of enquiry:	11 January 2021
Date enquiry received:	11 January 2021
Issue date:	11 January 2021
Our reference:	51002353634001
Your reference:	GEO2020-4543

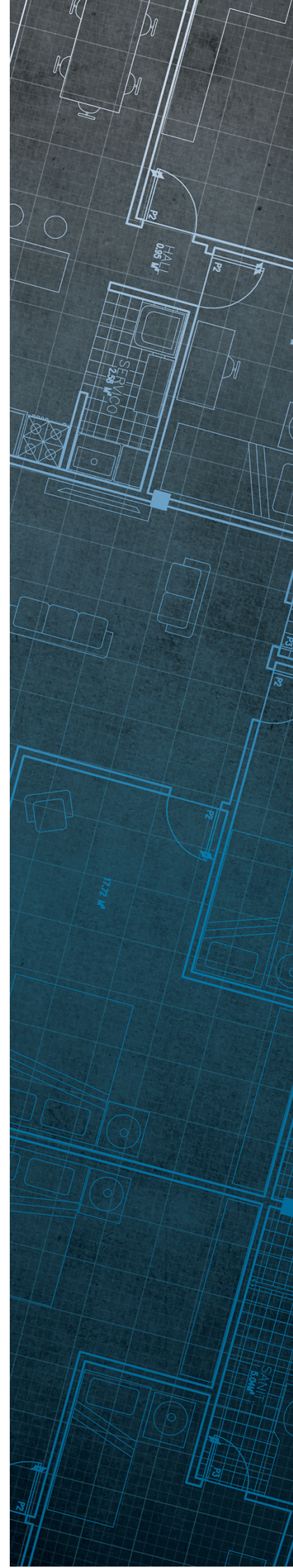

Consultants

Coal Mining Report

This report is based on and limited to the records held by the Coal Authority at the time the report was produced.

Client name

ANDREW HAMPSON

Enquiry address

Land At 27 Church Lane
Mirfield
Kirklees
WF14 9HX

How to contact us

0345 762 6848 (UK)
+44 (0)1623 637 000 (International)

200 Lichfield Lane
Mansfield
Nottinghamshire
NG18 4RG

www.groundstability.com

 @coalauthority

 /company/the-coal-authority

 /thecoalauthority

 /thecoalauthority

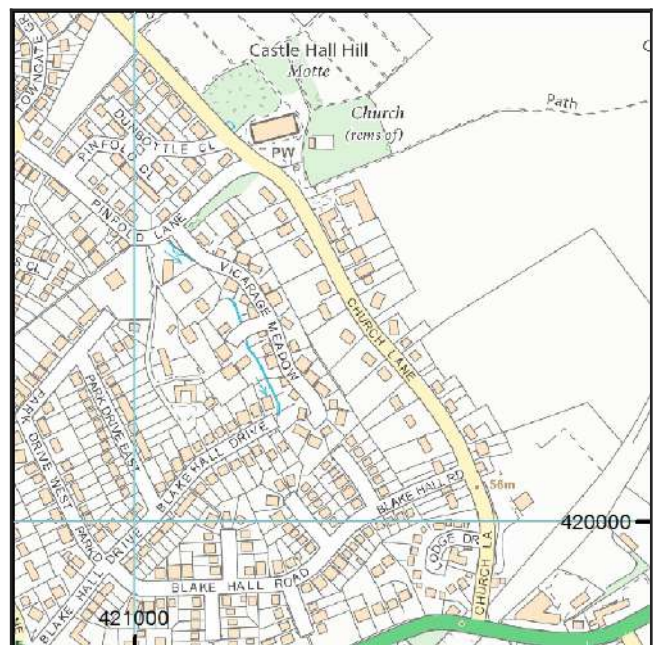

Approximate position of property



Reproduced by permission of Ordnance Survey on behalf of HMSO. © Crown copyright and database right 2018. All rights reserved.

Ordnance Survey Licence number: 100020315

Section 1 – Mining activity and geology

Past underground mining

Colliery	Seam	Mineral	Coal Authority reference	Depth (m)	Direction to working	Dipping rate of seam worked (degrees)	Dipped direction of seam worked	Extraction thickness (cm)	Year last mined
unnamed	BLACK BED	Coal	6HBO	149	Beneath Property	2.7	East	76	1931
unnamed	BLACK BED	Coal	6HBN	155	Beneath Property	2.7	East	76	1895

Probable unrecorded shallow workings

Yes.

Spine roadways at shallow depth

No spine roadway recorded at shallow depth.

Mine entries

None recorded within 100 metres of the enquiry boundary.

Abandoned mine plan catalogue numbers

The following abandoned mine plan catalogue numbers intersect with some, or all, of the enquiry boundary:

10527	NE425	GCR57
GCR54		

Please contact us on 0345 762 6848 to determine the exact abandoned mine plans you require based on your needs.

Outcrops

No outcrops recorded.

Geological faults, fissures and breaklines

No faults, fissures or breaklines recorded.

Opencast mines

Please refer to the “Summary of findings” map (on separate sheet) for details of any opencast areas within 500 metres of the enquiry boundary.

Coal Authority managed tips

None recorded within 500 metres of the enquiry boundary.

Section 2 – Investigative or remedial activity

Please refer to the 'Summary of findings' map (on separate sheet) for details of any activity within the area of the site boundary.

Site investigations

None recorded within 50 metres of the enquiry boundary.

Remediated sites

None recorded within 50 metres of the enquiry boundary.

Coal mining subsidence

The Coal Authority has not received a damage notice or claim for the subject property, or any property within 50 metres of the enquiry boundary, since 31 October 1994.

There is no current Stop Notice delaying the start of remedial works or repairs to the property.

The Coal Authority is not aware of any request having been made to carry out preventive works before coal is worked under section 33 of the Coal Mining Subsidence Act 1991.

Mine gas

None recorded within 500 metres of the enquiry boundary.

Mine water treatment schemes

None recorded within 500 metres of the enquiry boundary.

Section 3 – Licensing and future mining activity

Future underground mining

None recorded.

Coal mining licensing

None recorded within 200 metres of the enquiry boundary.

Court orders

None recorded.

Section 46 notices

No notices have been given, under section 46 of the Coal Mining Subsidence Act 1991, stating that the land is at risk of subsidence.

Withdrawal of support notices

The property is not in an area where a notice to withdraw support has been given.

The property is not in an area where a notice has been given under section 41 of the Coal Industry Act 1994, cancelling the entitlement to withdraw support.

Payments to owners of former copyhold land

The property is not in an area where a relevant notice has been published under the Coal Industry Act 1975/Coal Industry Act 1994.

Section 4 – Further information

The following potential risks have been identified and as part of your risk assessment should be investigated further.

Development advice

The site is within an area of historical coal mining activity. Should you require advice and/or support on understanding the mining legacy, its risks to your development or what next steps you need to take, please contact us.

For further information on specific site or ground investigations in relation to any issues raised in Section 4, please call us on 0345 762 6848 or email us at groundstability@coal.gov.uk.

Section 5 – Data definitions

The datasets used in this report have limitations and assumptions within their results. For more guidance on the data and the results specific to the enquiry boundary, please **call us on 0345 762 6848** or **email us at groundstability@coal.gov.uk**.

Past underground coal mining

Details of all recorded underground mining relative to the enquiry boundary. Only past underground workings where the enquiry boundary is within 0.7 times the depth of the workings (zone of likely physical influence) allowing for seam inclination, will be included.

Probable unrecorded shallow workings

Areas where the Coal Authority believes there to be unrecorded coal workings that exist at or close to the surface (less than 30 metres deep).

Spine roadways at shallow depth

Connecting roadways either, working to working, or, surface to working, both in-seam and cross measures that exist at or close to the surface (less than 30 metres deep), either within or within 10 metres of the enquiry boundary.

Mine entries

Details of any shaft or adit either within, or within 100 metres of the enquiry boundary including approximate location, brief treatment details where known, the mineral worked from the mine entry and conveyance details where the mine entry has previously been sold by the Authority or its predecessors British Coal or the National Coal Board.

Abandoned mine plan catalogue numbers

Plan numbers extracted from the abandoned mines catalogue containing details of coal and other mineral abandonment plans deposited via the Mines Inspectorate in accordance with the Coal Mines Regulation Act and Metalliferous Mines Regulation Act 1872. A maximum of 9 plan extents that intersect with the enquiry boundary will be included. This does not infer that the workings and/or mine entries shown on the abandonment plan will be relevant to the site/property boundary.

Outcrops

Details of seam outcrops will be included where the enquiry boundary intersects with a conjectured or actual seam outcrop location (derived by either the British Geological Survey or the Coal Authority) or intersects with a defined 50 metres buffer on the coal (dip) side of the outcrop. An indication of whether the Coal Authority believes the seam to be of sufficient thickness and/or quality to have been worked will also be included.

Geological faults, fissures and breaklines

Geological disturbances or fractures in the bedrock. Surface fault lines (British Geological Survey derived data) and fissures and breaklines (Coal Authority derived data) intersecting with the enquiry boundary will be included. In some circumstances faults, fissures or breaklines have been known to contribute to surface subsidence damage as a consequence of underground coal mining.

Opencast mines

Opencast coal sites from which coal has been removed in the past by opencast (surface) methods and where the enquiry boundary is within 500 metres of either the licence area, site boundary, excavation area (high wall) or coaling area.

Coal Authority managed tips

Locations of disused colliery tip sites owned and managed by the Coal Authority, located within 500 metres of the enquiry boundary.

Site investigations

Details of site investigations within 50 metres of the enquiry boundary where the Coal Authority has received information relating to coal mining risk investigation and/or remediation by third parties.

Remediated sites

Sites where the Coal Authority has undertaken remedial works either within or within 50 metres of the enquiry boundary following report of a hazard relating to coal mining under the Coal Authority's Emergency Surface Hazard Call Out procedures.

Coal mining subsidence

Details of alleged coal mining subsidence claims made since 31 October 1994 either within or within 50 metres of the enquiry boundary. Where the claim relates to the enquiry boundary confirmation of whether the claim was accepted, rejected or whether liability is still being determined will be given. Where the claim has been discharged, whether this was by repair, payment of compensation or a combination of both, the value of the claim, where known, will also be given.

Details of any current 'Stop Notice' deferring remedial works or repairs affecting the property/site, and if so the date of the notice.

Details of any request made to execute preventative works before coal is worked under section 33 of the Coal Mining Subsidence Act 1991. If yes, whether any person withheld consent or failed to comply with any request to execute preventative works.

Mine gas

Reports of alleged mine gas emissions received by the Coal Authority, either within or within 500 metres of the enquiry boundary that subsequently required investigation and action by the Coal Authority to mitigate the effects of the mine gas emission.

Mine water treatment schemes

Locations where the Coal Authority has constructed or operates assets that remove pollutants from mine water prior to the treated mine water being discharged into the receiving water body.

These schemes are part of the UK's strategy to meet the requirements of the Water Framework Directive. Schemes fall into 2 basic categories: Remedial – mitigating the impact of existing pollution or Preventative – preventing a future pollution incident.

Mine water treatment schemes generally consist of one or more primary settlement lagoons and one or more reed beds for secondary treatment. A small number are more specialised process treatment plants.

Future underground mining

Details of all planned underground mining relative to the enquiry boundary. Only those future workings where the enquiry boundary is within 0.7 times the depth of the workings (zone of likely physical influence) allowing for seam inclination will be included.

Coal mining licensing

Details of all licenses issued by the Coal Authority either within or within 200 metres of the enquiry boundary in relation to the under taking of surface coal mining, underground coal mining or underground coal gasification.

Court orders

Orders in respect of the working of coal under the Mines (Working Facilities and Support) Acts of 1923 and 1966 or any statutory modification or amendment thereof.

Section 46 notices

Notice of proposals relating to underground coal mining operations that have been given under section 46 of the Coal Mining Subsidence Act 1991.

Withdrawal of support notices

Published notices of entitlement to withdraw support and the date of the notice. Details of any revocation notice withdrawing the entitlement to withdraw support given under Section 41 of the Coal Industry Act 1994.

Payment to owners of former copyhold land

Relevant notices which may affect the property and any subsequent notice of retained interests in coal and coal mines, acceptance or rejection notices and whether any compensation has been paid to a claimant.



This page left intentionally blank

VAT receipt

Issued by	The Coal Authority 200 Lichfield Lane Mansfield Nottinghamshire NG18 4RG
Tax point date	11 January 2021
Issued to	ANDREW HAMPSON 34 GRANGE PARK AVENUE SUNDERLAND SR5 1NS
Property search for	LAND AT 27 CHURCH LANE MIRFIELD KIRKLEES WF14 9HX
Reference number	51002353634001
Date of issue	11 January 2021
Cost	£112.13
VAT @ 20%	£22.43
Total received	£134.56
VAT registration	598 5850 68

The map highlights any specific surface or subsurface features within or near to the boundary of the site.

Key

- Approximate position of the enquiry boundary shown 
- Unlicensed opencast site 

How to contact us
0345 762 6848 (UK)
+44 (0)1623 637 000 (International)
www.groundstability.com

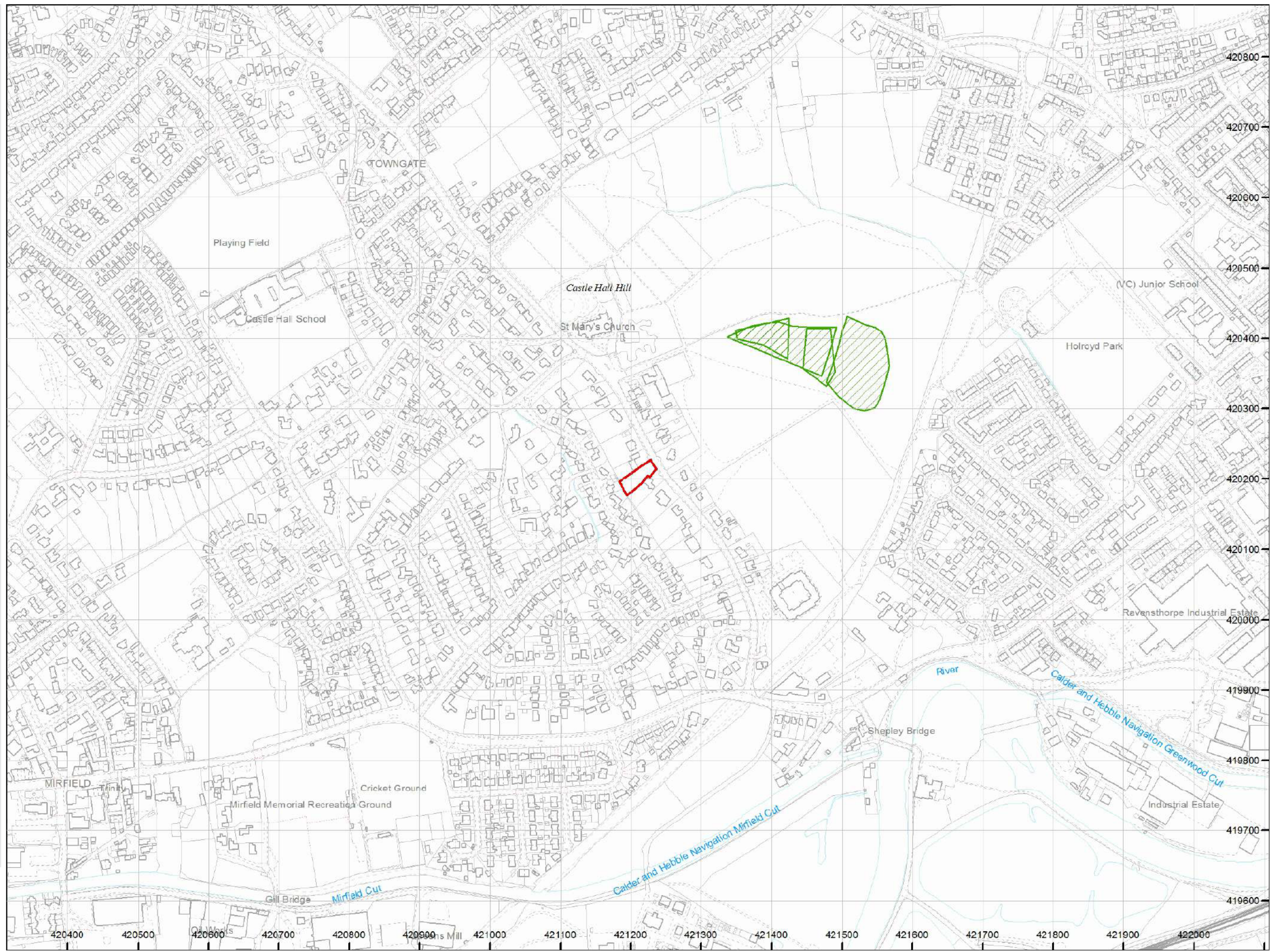

GEO2020-4543: Coal Authority Online Database – 27 Church Lane, Mirfield

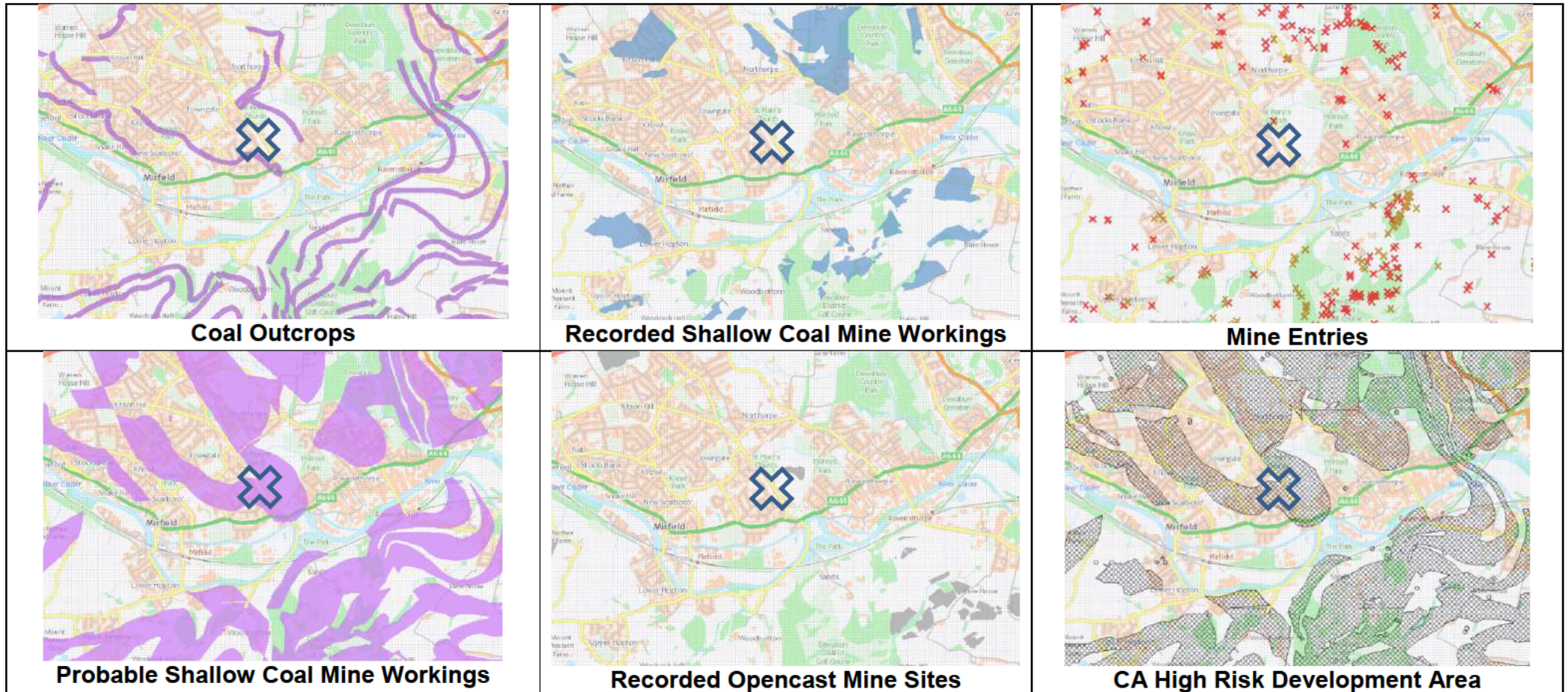

Approximate Site Location marked with the 

Website: www.geoenvironmentalengineering.com

Email: info@geoenvironmentalengineering.com

Telephone: 08456 768 895 / 07883 440 186

GEO2020-4543: Coal Authority Online Database – 27 Church Lane, Mirfield (Mine Entry Data)

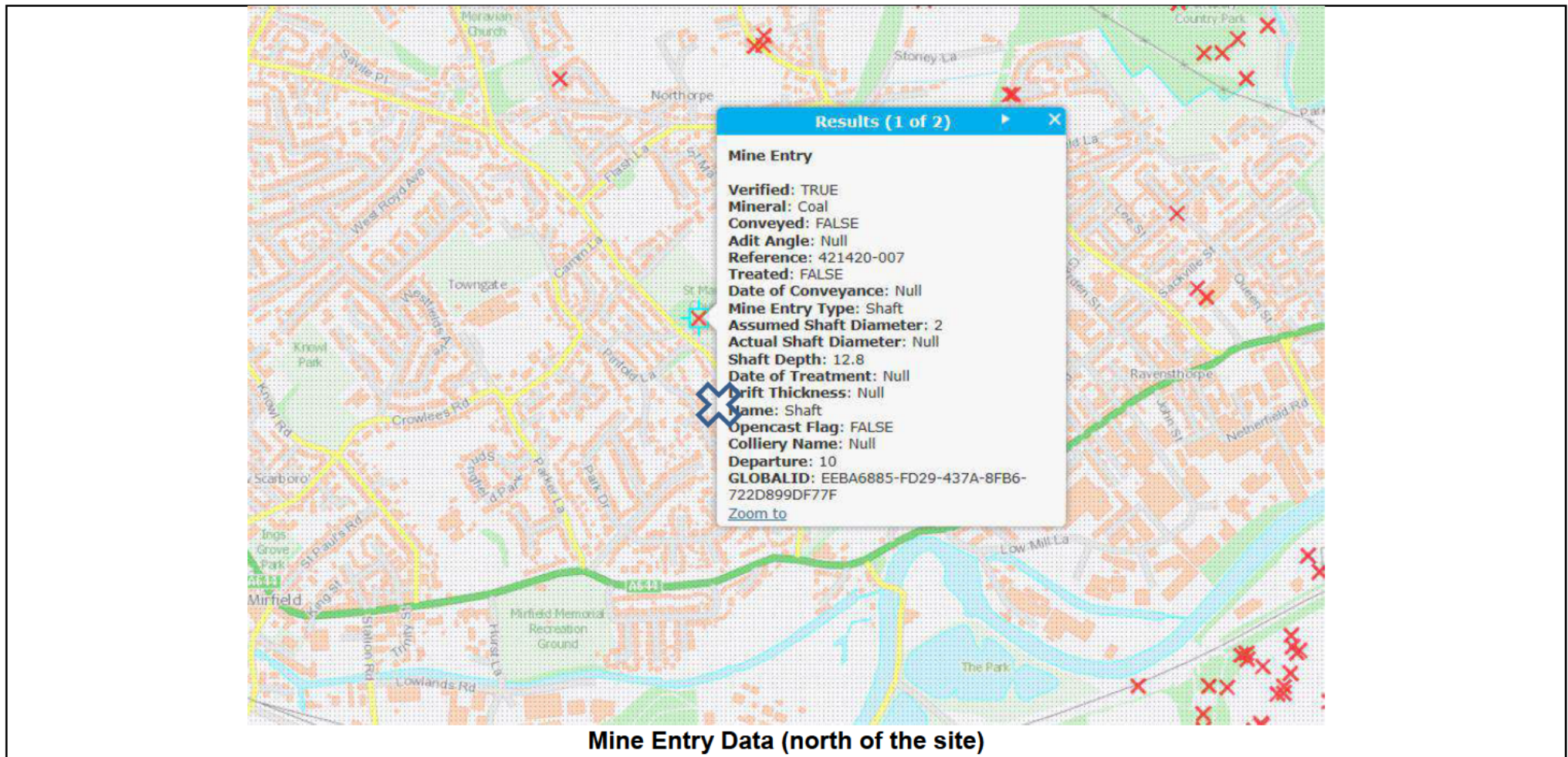

Approximate Site Location marked with the 

Website: www.geoenvironmentalengineering.com

Email: info@geoenvironmentalengineering.com

Telephone: 08456 768 895 / 07883 440 186

PLAN REFERRED TO

SE22SW 180-210

Borehole Location Plan

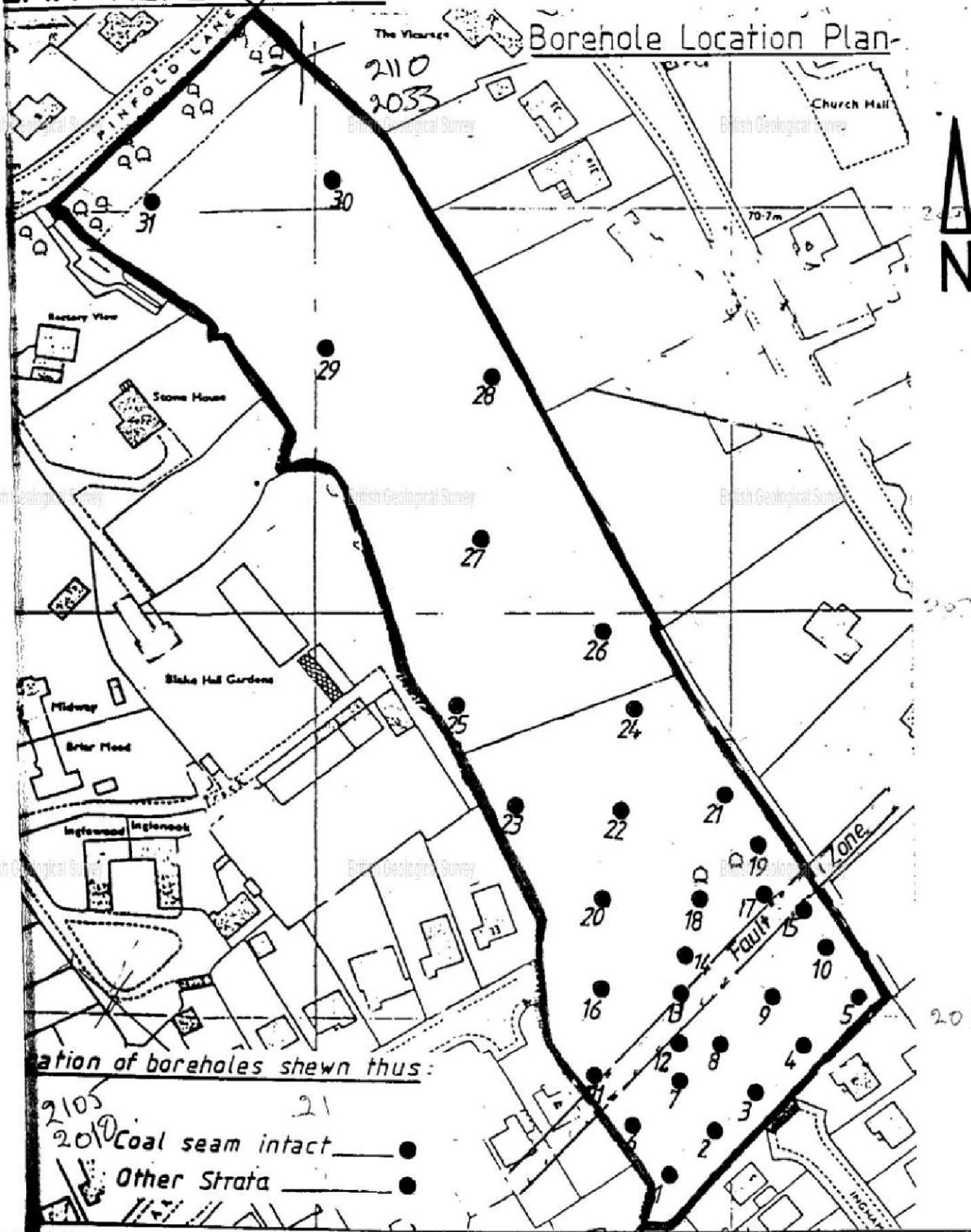

Location of boreholes shown thus:

- 2105 ●
- 2010 ●
- Coal seam intact —●
- Other Strata —●



HETS

WEST YORKSHIRE HIGHWAYS
ENGINEERING AND TECHNICAL
SERVICES JOINT COMMITTEE

Director: W.F. COTTON, B.A., D.M.S., C.Eng., F.I.C.E., M.I.H.T.

PROJECT <u>Proposed Housing</u>		
DRAWING TITLE <u>Pinfold Lane, Mirfield.</u>		
UNIT <u>Mining</u>	DRAWN <u>AD</u>	TRACED <u>AD</u>
SCALE <u>1/1250</u>	DATE <u>Oct 1988</u>	DRG No. <u>86/70</u>



ENGINEERING AND TECHNICAL
SERVICES JOINT COMMITTEE

MATERIALS LABORATORY
Horbury Road, Ossett, WF5 0BZ.
Telephone: Wakefield (0924) 260621

SE22SW 184
2124 2010

LOG OF DRILLING

Proposed Housing Development
Pinfold Lane, Mirfield **BOREHOLE NO** 5

TYPE OF DRILL Holman Rotary Percussive **O.S. DATUM LEVEL** Existing GL

DIAMETER OF DRILL 75 mm **STANDING WATER LEVEL** -

DRILLING COMMENCED 11.10.88 **DATE COMPLETED** 11.10.88

DEPTH M	DESCRIPTION OF STRATA	THICKNESS M	REMARKS
- 1.3	Soil and clay	1.3	
- 2.0	Clay with sandstone fragments	0.7	
- 9.2	Mudstones and shales	7.2	
- 9.4	Black shale	0.2	
- 10.1	Coal	0.7	
- 12.0	Shale	1.9	



GEO Environmental Engineering Ltd
Geotechnical
&
Environmental Drilling Experts
&
Consultants

Intellectual Copyright 2021
(GEO Standard Terms and Conditions
Apply)