

NOTE:
 1. Drawing based on SBA/WYG drawing no. A079758-A-3, revision B, dated 30.06.15
 2. Drawing based on Ordnance Survey base mapping and Topographical Survey information received 17.09.13

 - Junction Intervisibility Zone

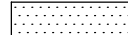
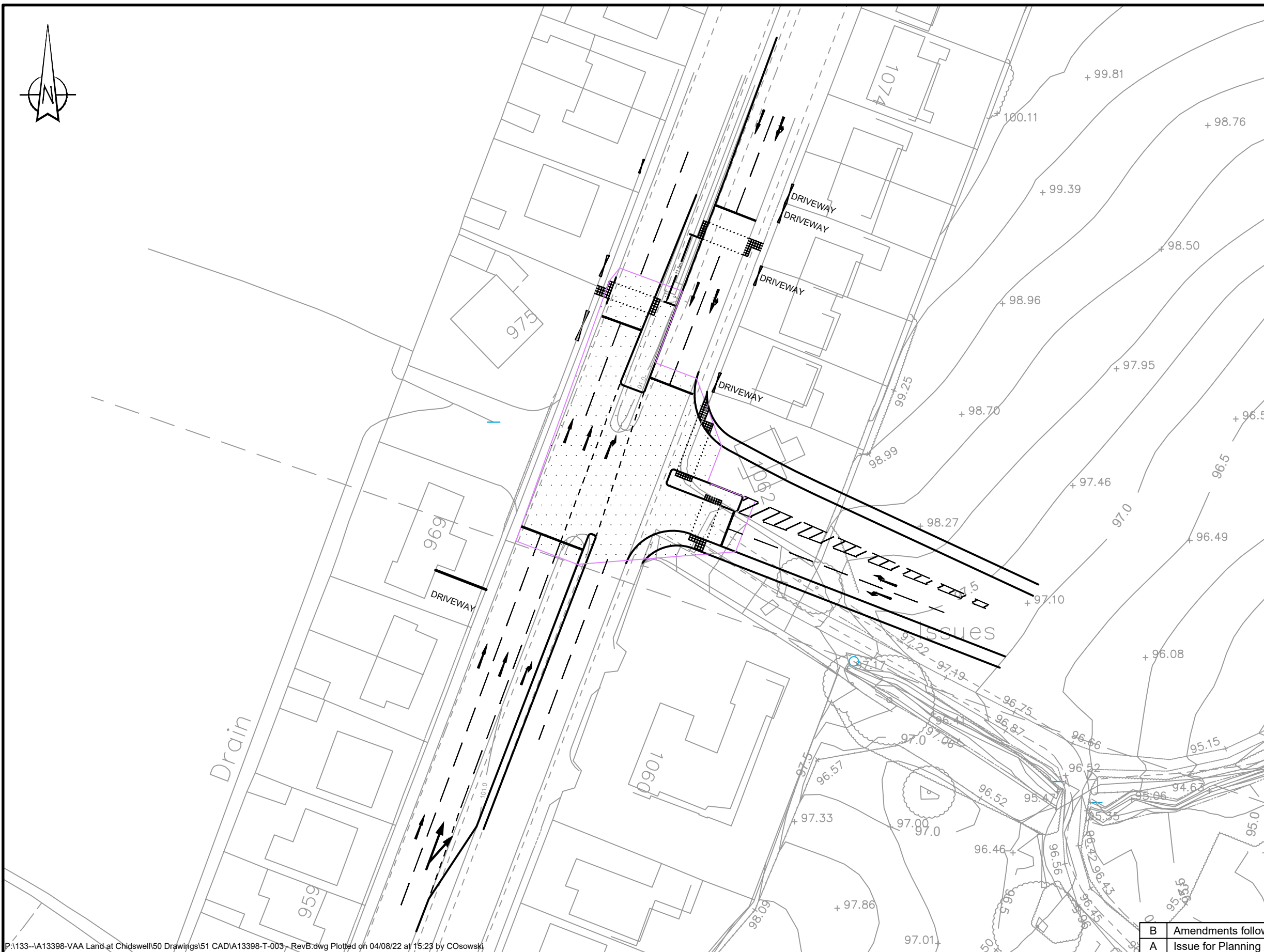

P:\133-VA13398-VAA Land at Chidswell\50 Drawings\51 CAD\A13398-T-003 - RevB.dwg Plotted on 04/08/22 at 15:23 by COsowski

B	Amendments following Stage 1 RSA			CJO	SME	SME	04.08.22
A	Issue for Planning			AGA	SME	SME	25.07.18
	Name	Date	Scale	NTS @ A3			
Drawn	AGA	25/07/18	File No.	A13398-T-003 - RevB.dwg			
Designed	AGA	25/07/18	Drawing Status	DRAFT			
Checked	SME	25/07/18	Drawing No.	A13398-T-003			Revision
Approved	SME	25/07/18				B	

Pell Frischmann
 5TH FLOOR, 85 STRAND, LONDON, WC2R 0DW
 Telephone +44 (0)20 7486 3661
 Email: pflondon@pellfrischmann.com
 www.pellfrischmann.com

Project
C.C. Projects
Land East of Leeds Road (Site B)
Land at Chidswell, Dewsbury

Drawing Title
Proposed Site Access 2 - 1062 Leeds Road