

Building 1 _ Ground Floor GA Plan _ Works to Existing
1 : 100

For survey of Building 1 as existing, refer to Met Surveys drg P17-00727-MET-INT-GFP-M2-B-001

GENERALLY : WORKS TO EXISTING

- existing non-historic floor finishes to be carefully removed to reveal historic floors. Floor finishes to be further assessed for heritage value and condition.
- existing suspended grid ceilings and their integrated services to be removed.
- existing services generally to be removed. historic bracketry or vestiges of historic services to be identified and retained for further consideration.
- historic, timber-lined air-vents above doors to be retained and in-filled with fire-resisting construction or fire-rated glazing - to be reviewed further.
- where openings are to be formed in original walls, ribs and downstands are to remain to describe the location of the former wall.

GENERALLY : PROPOSED

- proposed internal walls to be formed in metal stud partition, boarded and painted, c/w suitable insulation to fulfill acoustic and fire-rating requirements.
- proposed doors within proposed partitions to be flush, hardwood veneered doors c/w stainless steel ironmongery.
- proposed sanitary facilities - rooms to be formed from metal stud partition and existing walls to be lined in universal wall liner, ready for internal finishes.
- proposed ceilings in office suites to be typically overboarding of exposed existing soffit to create suitable fire-rated separation. (overboarding to be as slim as practicable and existing covings to remain), skim and paint.
- coverings, picture rails, skirtings, architraves and door details: vary by location and some spaces appear never to have had coverings and picture rails. generally rooms to be restored with joinery and moulding details authentic to their location.

KEY

- Existing Construction to Retain
- Existing Construction to Remove
- Proposed Construction
- Indicates opening to be formed in original walls: ribs and ceiling downstands to remain to describe the location of the former wall.

Building One - Proposed GIA

Name	Area	Area sqft
Building 1 Basement (Level 1.B)	482.4 m ²	5192 ft ²
Building 1 Ground Floor (Level 1.0)	477.8 m ²	5143 ft ²
Building 1 First Floor (Level 1.1)	480.1 m ²	5167 ft ²
Building 1 Second Floor (Level 1.2)	425.8 m ²	4584 ft ²
Grand total: 4	1866.0 m ²	20086 ft ²

Building One - Proposed Office Suites NIA

Name	Area	Area [sqft]
Level 1.B		
Office Suite B.01	41.4 m ²	445 ft ²
Office Suite B.02	56.7 m ²	610 ft ²
Office Suite B.03	58.1 m ²	625 ft ²
Office Suite B.04	53.4 m ²	574 ft ²
	209.5 m ²	2255 ft ²
Level 1.0		
Office Suite G.01	40.7 m ²	438 ft ²
Office Suite G.02	82.2 m ²	884 ft ²
Office Suite G.03	8.0 m ²	86 ft ²
Office Suite G.04	78.2 m ²	842 ft ²
Office Suite G.05	46.0 m ²	495 ft ²
	255.1 m ²	2746 ft ²
Level 1.1		
Office Suite 1.01	41.7 m ²	449 ft ²
Office Suite 1.03	9.3 m ²	100 ft ²
Open Plan Office 1.02	247.9 m ²	2668 ft ²
	298.9 m ²	3218 ft ²
Level 1.2		
Office Suite 2.01	190.6 m ²	2051 ft ²
Office Suite 2.02	47.8 m ²	515 ft ²
	238.4 m ²	2566 ft ²
Grand total: 14	1001.9 m ²	10784 ft ²

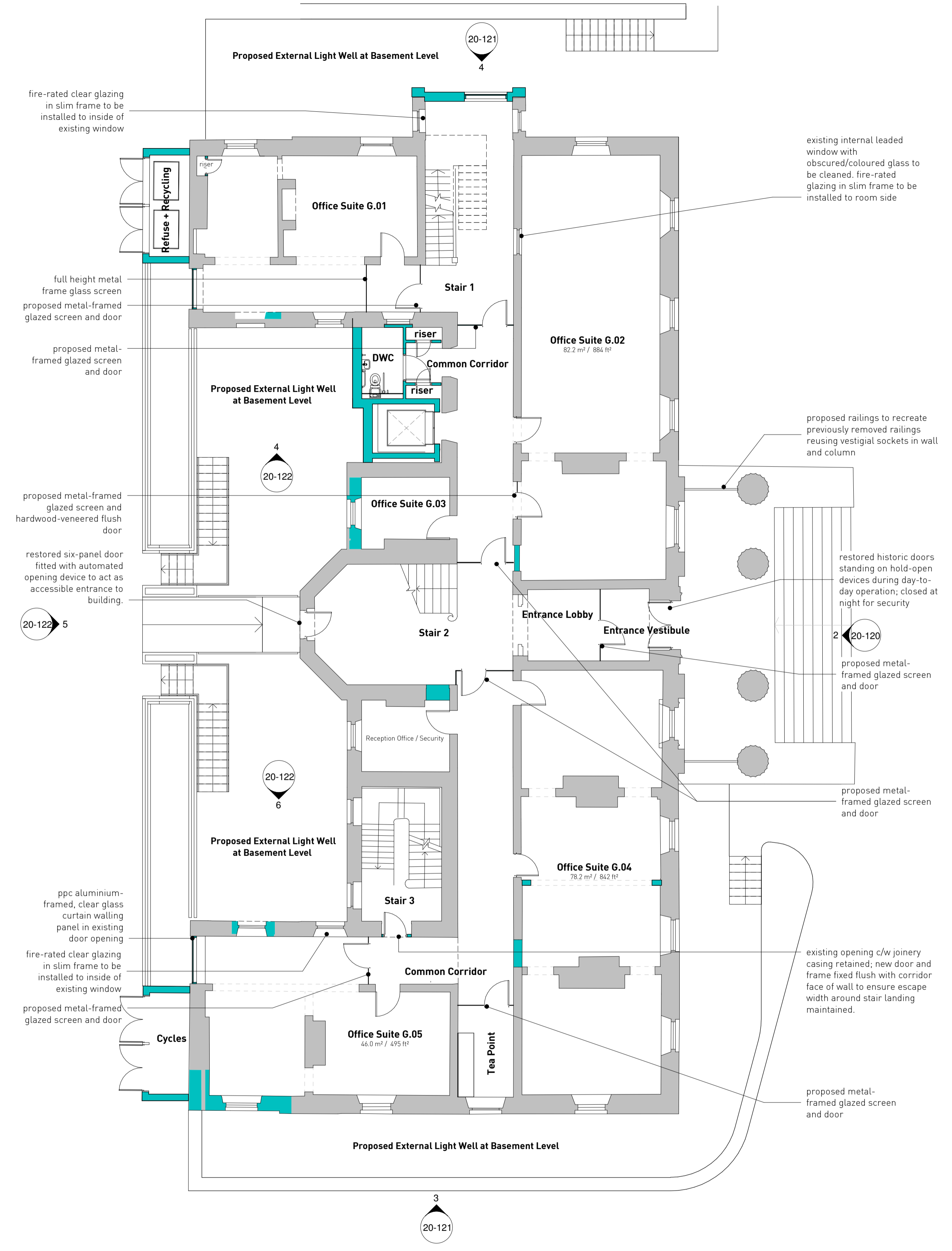

Building 1 _ Ground Floor GA Plan _ As Proposed
1 : 100

Notes.

Contractor must verify all dimensions on site before commencing any work or shop drawings. If this drawing exceeds the quantities taken in any way the Architects are to be informed before the work is initiated. Only figured dimensions to be taken from this drawing. Do not scale off this drawing. Drawings based on Ordnance Survey and / or existing record drawings - design and drawing content subject to Site Survey, Structural Survey, Site Investigations, Planning and Statutory Requirements and Approvals. Authorised reproduction from Ordnance Survey Map with permission of the Controller of Her Majesty's Stationery Office. Crown Copyright reserved. Enjoy Design Ltd.

A	Updated with latest comments from design team.	JNS	11Jul18	APPROVAL	The Old Brewery High Court Leeds LS2 7ES Tel: 0113 242 3622 www.enjoy-design.co.uk	Client:	Job No:
	Rev.	Des.	By			Date	Ch.
						Project:	
						Title:	
						Date:	Scale:
						Nov 17	1 : 100BA1
						Checked by:	
						RG	
						Drawing No:	Revision:
						20-101	A

