

Section 5

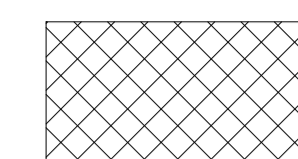

Proposed area of fill brought into the railway cutting.

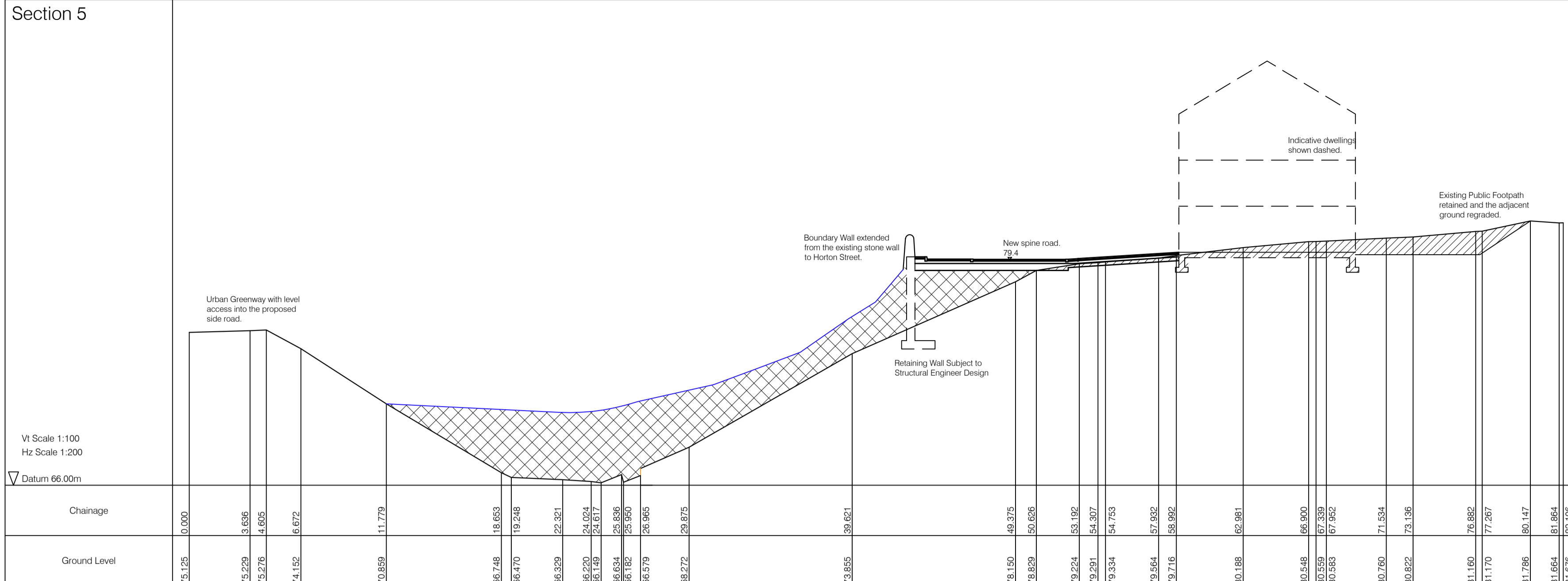
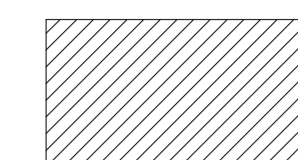

Proposed area of cut ground from the railway cutting.

Section 6

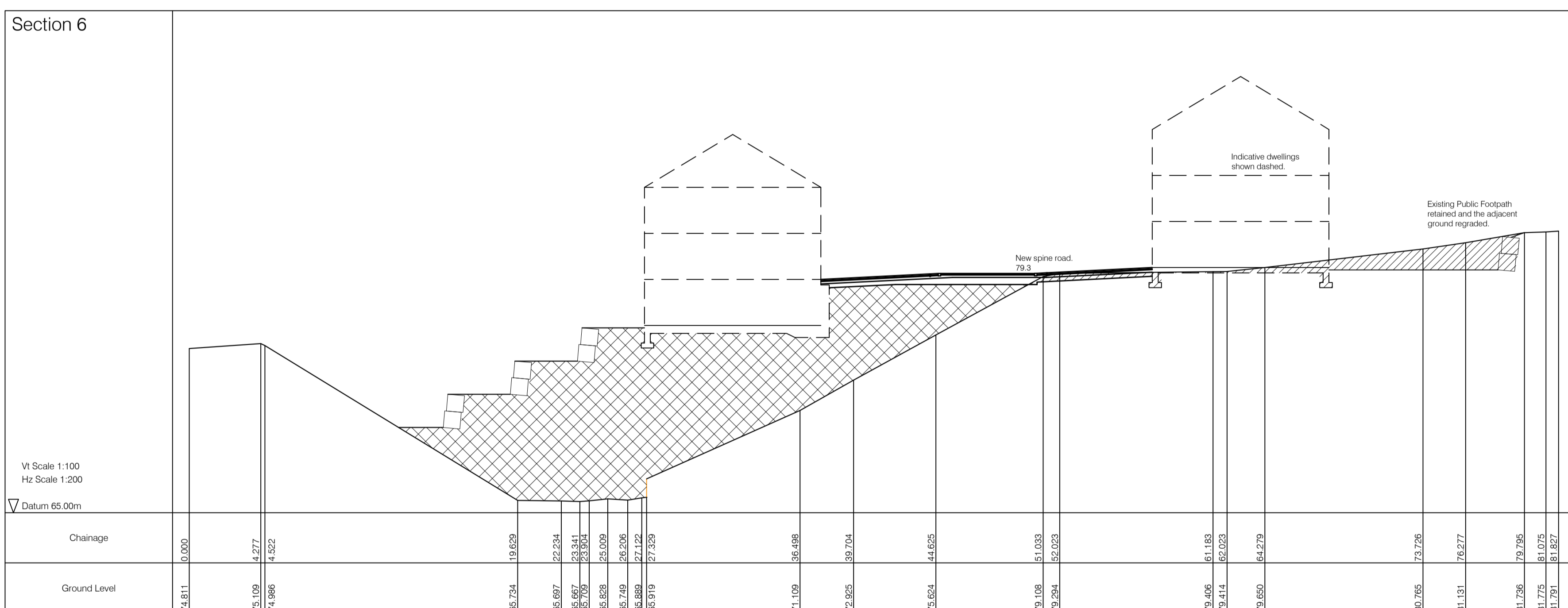

Section 7

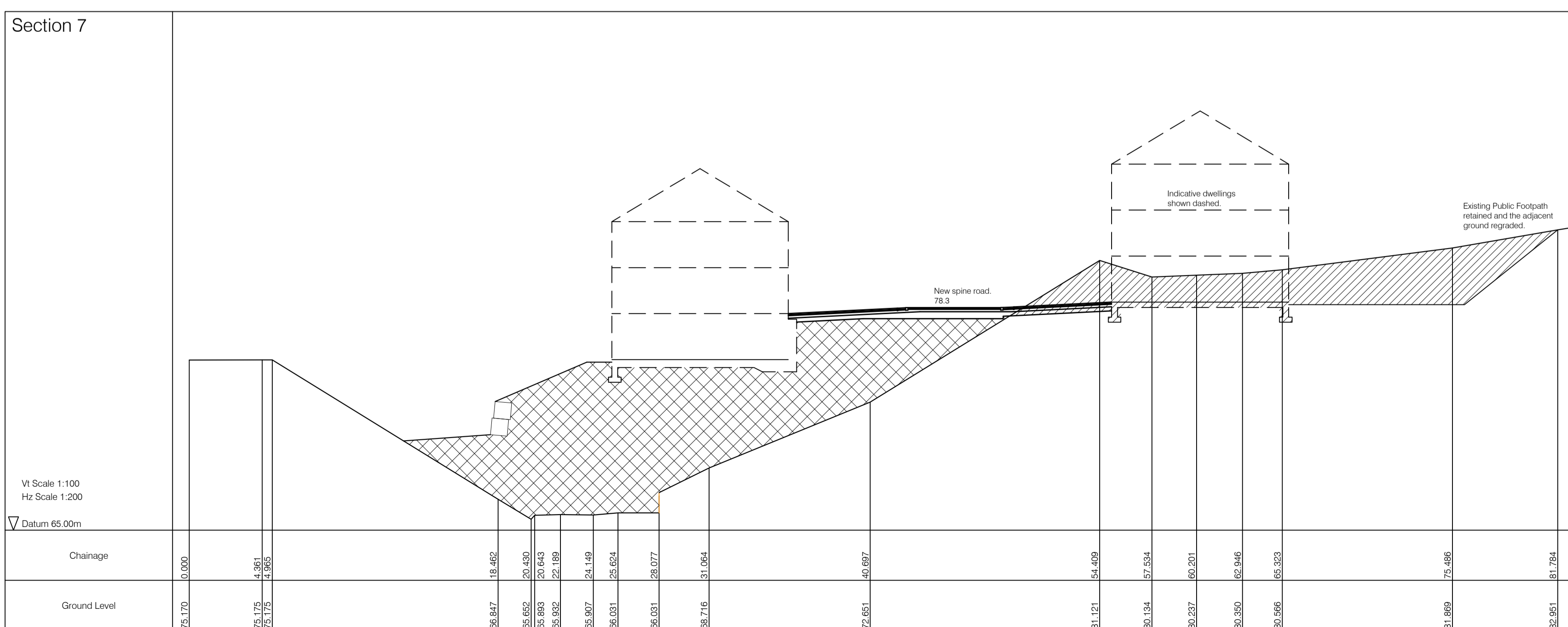

Rev	Description	Date	By	Appr
-	-	-	-	-
-	-	-	-	-

VIDA ARCHITECTS
Round Foundry Media Centre,
Foundry Street, Leeds, LS11 5QP
T: 0113 827287
E: info@vida-architects.co.uk
www.vida-architecture.com

Client: Ernest Gordon Ltd

Project: Outline Residential Use at Disused Railway Cutting, Heckmondwike.

Drawing Title: INDICATIVE SITE REGRADING SECTIONS 5 to 7

Project No.	Dwg No.	Rev.	Scale @ A1	Date	By
2014-034	PL204	-	1:200	26.04.18	AR

Issue Status: **PLANNING**

This drawing should be read in conjunction with all related drawings. Do not scale from this drawing. All dimensions shown must be checked and verified on site before commencing any work or producing shop drawings. Vida Development & Investments Ltd should be notified immediately of any discrepancy on the drawing. This drawing together with the design is copyright and remains the property of Vida Development & Investments Ltd.