

**GROUND FLOOR PLAN**

**KEY**

- Foundation
- ▨ Natural stone
- ▩ Blockworks 3.6N 0.15 W/mk

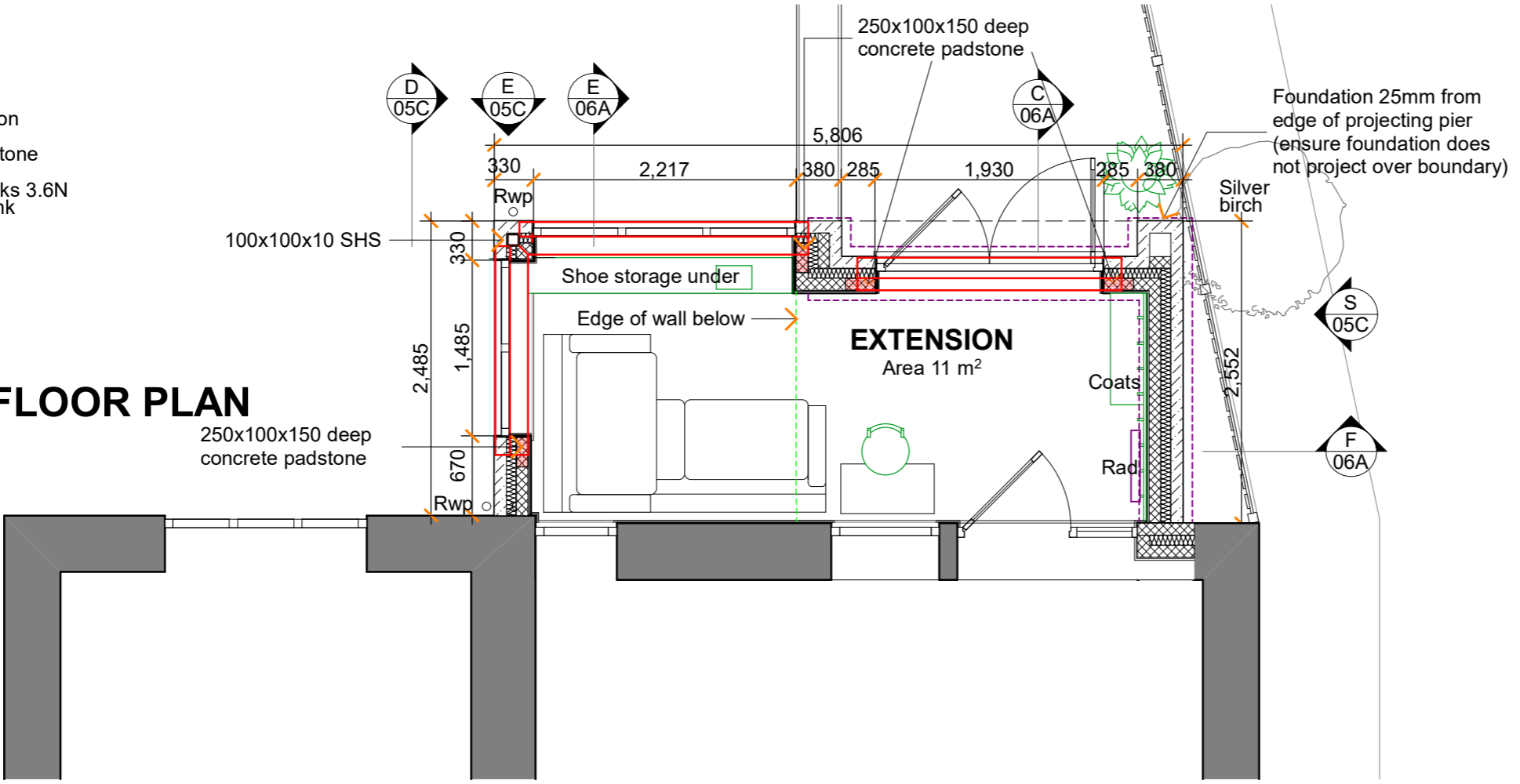

**FIRST FLOOR PLAN**

C	06.02.18	Planning/Building Regulations/Pricing
B	22.08.17	Lower storey removed.
A	02.04.17	Lower storey added. Cladding changed to stone.

ISSUE: DATE: DESCRIPTION:

**PROJECT3**  
architecture

Chartered Institute of  
Architectural Technologists  
Registered Practice

**Project 3 Architecture Ltd**  
1 Bramble Road, Retford, DN22 7EY  
t. 01777 719114 m. 07503 638949  
e. tracy@project3architecture.biz  
www.project3architecture.biz

Client:  
**Matt and Sheree Mosley,  
Wheatsheaf Cottage,  
Thunderbridge Lane,  
Kirkburton, Huddersfield  
HD8 0PX**

Project:  
**Proposed extension  
Wheatsheaf Cottage**

Drawing Title:  
**Proposed Ground and First  
Floor Plans**

Job No. <b>Z1501</b>	Scale 1:50 at A3
Sheet No. <b>04C</b>	Date Jul 2015
	Drawn TVB

Do not scale this drawing.  
Contractor to verify all dimensions on site.  
Any discrepancies between the dimensions and the layout shown  
shall be referred to Project 3 Architecture Ltd for clarification.

THESE DRAWINGS ARE TO REMAIN THE COPYRIGHT OF  
PROJECT 3 ARCHITECTURE LTD.