

ABOVE - VIEW LOOKING DOWN MORLEY LANE ADJACENT TO HOFFMAN STREET

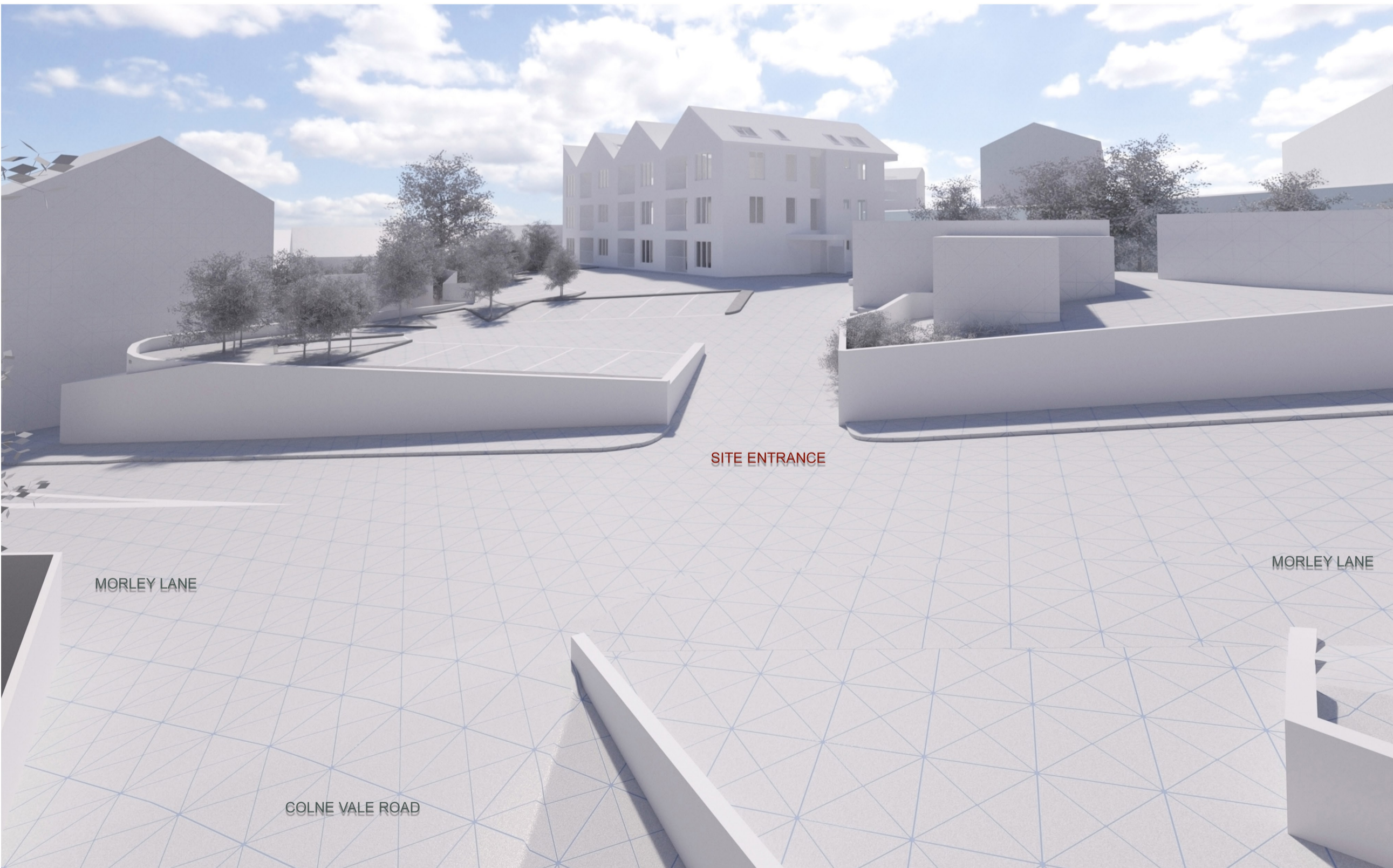

ABOVE - VIEW FROM RIVER COLNE PATHWAY ADJACENT TO PROPOSED BUILDING

BELOW - VIEW FROM COLNE VALE ROAD LOOKING TOWARD SITE ENTRANCE



BELOW - VIEW LOOKING UP MORLEY LANE



GENERAL NOTES:

WRITTEN DIMENSIONS TO TAKE PRECEDENT OVER SCALED DIMENSIONS.
 MAIN CONTRACTOR TO CONFIRM ALL DIMENSIONS ON SITE PRIOR TO COMMENCING CONSTRUCTION OR MANUFACTURE TO ENSURE ACCURACY.

- DRAWING STATUS:**
- PRELIMINARY ISSUE
 - PLANNING ISSUE
 - BUILDING REGULATIONS
 - PRE-CONSTRUCTION
 - TENDER ISSUE
 - CONSTRUCTION ISSUE
 - RECORD ISSUE
- NOTE: ONLY 'CONSTRUCTION ISSUE' DRAWINGS ARE TO BE USED ON SITE

DRAWING REVISIONS:

- Rev 1 16.02.2017
Preliminary Issue.
Pre-application submission to Local Authority.
- Rev 2 17.05.2017
Preliminary Issue.
Adjusted scheme following Local Authority Planning Officer comments.
- Rev 3 25.09.2017
Planning Issue.

PROJECT TITLE: REDEVELOPMENT OF SITE AT VALE WORKS
 25 MORLEY LANE
 MILNSBRIDGE
 HUDDERSFIELD
 HD3 4NS

CLIENT: MR ALAN BATLEY

DRAWING TITLE: PROPOSED DRAWINGS
 CONTEXTUAL SITE VISUALS, SHEET 1

SCALE: NTS

DRAWING NO: R1050-401 Rev 3

DAWSON WILLIAMSON
 ARCHITECTS

Hope Park Business Centre Bradford, BD5 8HB
 0 1 2 7 4 5 5 1 3 0 0
 info@dawsonwilliamson.co.uk
 www.dawsonwilliamson.co.uk

THE DETAILS SHOWN ON THIS DRAWING ARE CONFIDENTIAL & THE DRAWING IS THE EXCLUSIVE PROPERTY OF DAWSON WILLIAMSON LTD. NO USE, COPY OR DISCLOSURE OF THE DRAWING MAY BE MADE WITHOUT OUR PERMISSION & THE DRAWING MUST BE RETURNED TO DAWSON WILLIAMSON LTD WHEN REQUIRED.
 © Dawson Williamson Ltd 2017