

© Copyright Landmark Information Group Ltd. All Rights Reserved.



**ARP GEOTECHNICAL LIMITED**  
**CHARTERED CONSULTING ENGINEERS**

## Huddersfield

Published 1984

Source map scale - 1:10,000

These maps were produced by the Russian military during the Cold War between 1950 and 1997, and cover 103 towns and cities throughout the U.K. The maps are produced at 1:25,000, 1:10,000 and 1:5,000 scale, and show detailed land use, with colour-coded areas for development, green areas, and non-developed areas. Buildings are coloured black and important building uses (such as hospitals, post offices, factories etc.) are numbered, with a numbered key describing their use.

They were produced by the Russians for the benefit of navigation, as well as strategic military sites and transport hubs, for use if they were to have invaded the U.K. The detailed information provided indicates that the areas were surveyed using land-based personnel, on the ground, in the cities that are mapped.

### Map Name(s) and Date(s)

SE01NE 1984 1:10,000	SE11NW 1984 1:10,000
SE01SE 1984 1:10,000	SE11SW 1984 1:10,000

### Russian Map - Slice A

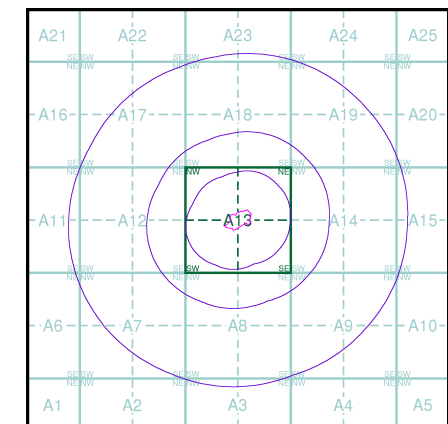

### Order Details

Order Number: 72526992\_1\_1  
 Customer Ref: MOY/02  
 National Grid Reference: 410900, 415470  
 Slice: A  
 Site Area (Ha): 1.23  
 Search Buffer (m): 1000

### Site Details

Land at, Cowlersley Lane, Linthwaite, HUDDERSFIELD



Tel: 0844 844 9952  
 Fax: 0844 844 9951  
 Web: www.envirocheck.co.uk

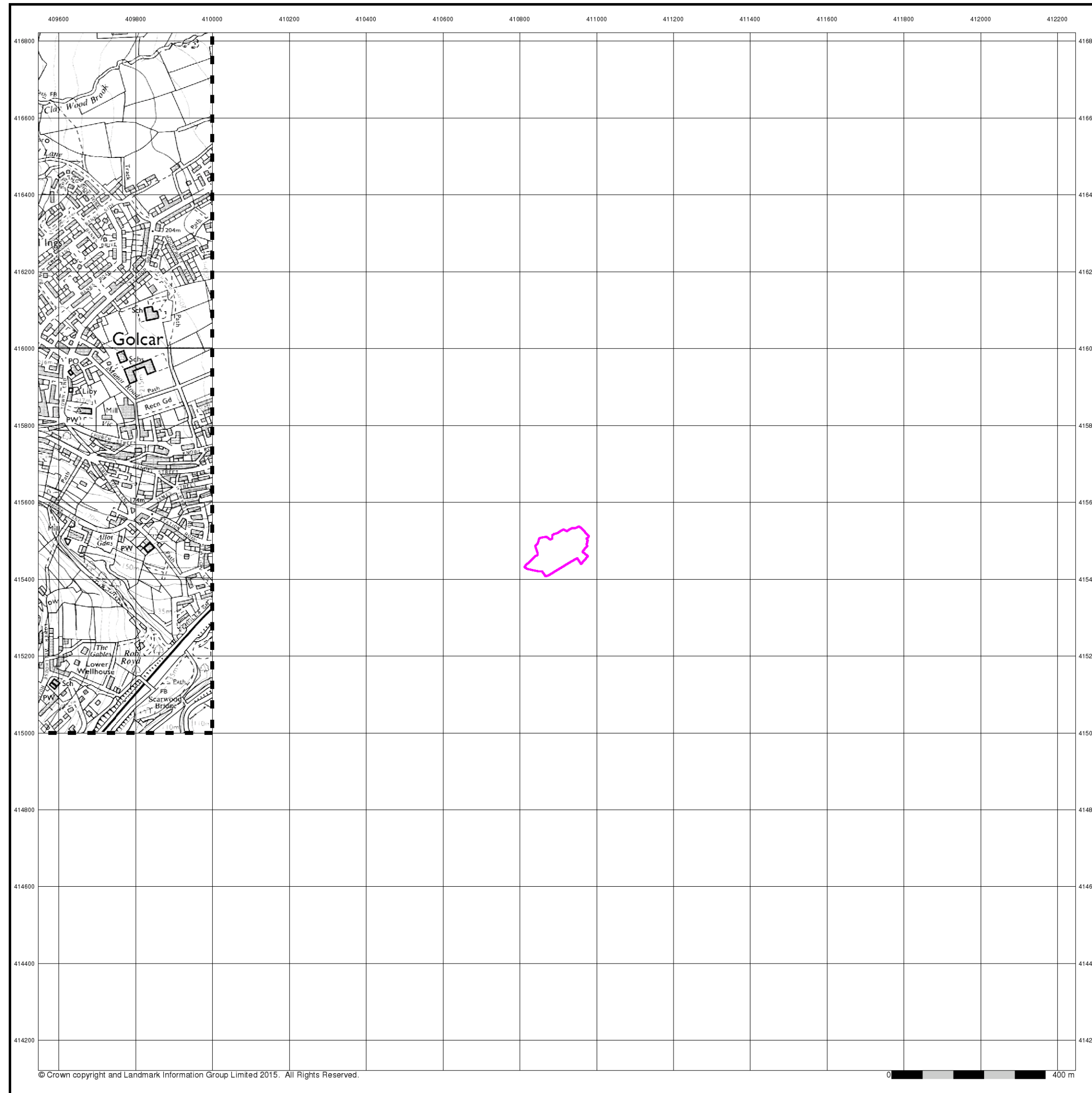

**ARP GEOTECHNICAL LIMITED**  
**CHARTERED CONSULTING ENGINEERS**

### Ordnance Survey Plan

**Published 1993**

**Source map scale - 1:10,000**

The historical maps shown were reproduced from maps predominantly held at the scale adopted for England, Wales and Scotland in the 1840's. In 1854 the 1:2,500 scale was adopted for mapping urban areas; these maps were used to update the 1:10,560 maps. The published date given therefore is often some years later than the surveyed date. Before 1938, all OS maps were based on the Cassini Projection, with independent surveys of a single county or group of counties, giving rise to significant inaccuracies in outlying areas. In the late 1940's, a Provisional Edition was produced, which updated the 1:10,560 mapping from a number of sources. The maps appear unfinished - with all military camps and other strategic sites removed. These maps were initially overprinted with the National Grid. In 1970, the first 1:10,000 maps were produced using the Transverse Mercator Projection. The revision process continued until recently, with new editions appearing every 10 years or so for urban areas.

### Map Name(s) and Date(s)

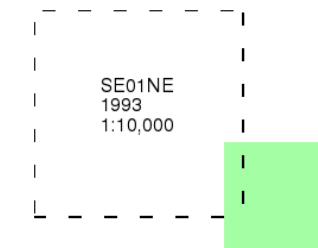

### Historical Map - Slice A

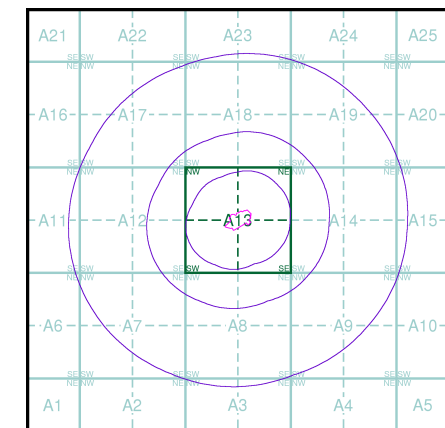

### Order Details

Order Number: 72526992\_1\_1  
 Customer Ref: MOY/02  
 National Grid Reference: 410900, 415470  
 Slice: A  
 Site Area (Ha): 1.23  
 Search Buffer (m): 1000

### Site Details

Land at, Cowlersley Lane, Linthwaite, HUDDERSFIELD



Tel: 0844 844 9952  
 Fax: 0844 844 9951  
 Web: www.envirocheck.co.uk

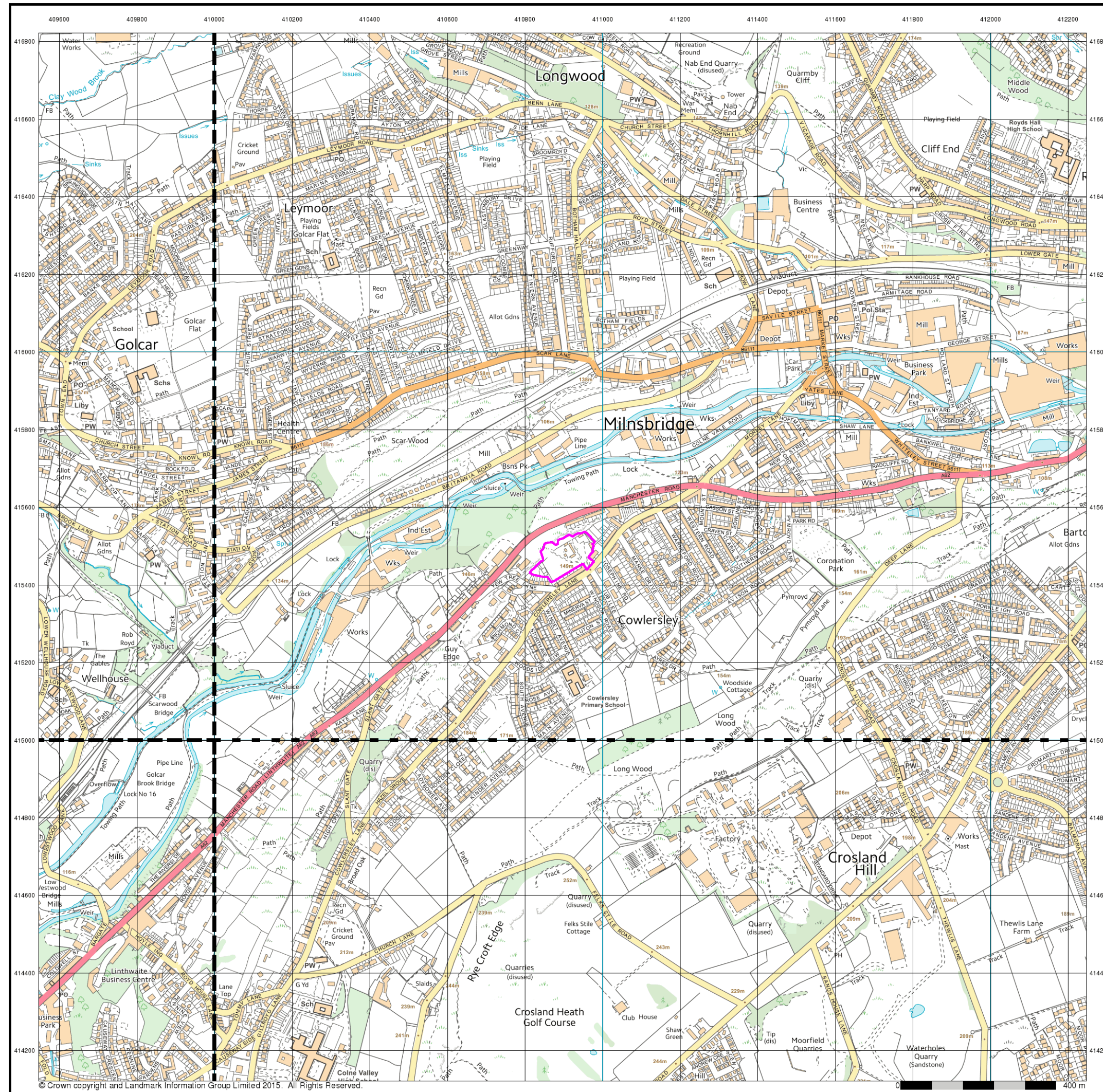

© Crown copyright and Landmark Information Group Limited 2015. All Rights Reserved.



**ARP GEOTECHNICAL LIMITED**  
**CHARTERED CONSULTING ENGINEERS**

### VectorMap Local

Published 2015

Source map scale - 1:10,000

VectorMap Local (Raster) is Ordnance Survey's highest detailed 'backdrop' mapping product. These maps are produced from OS's VectorMap Local, a simple vector dataset at a nominal scale of 1:10,000, covering the whole of Great Britain, that has been designed for creating graphical mapping. OS VectorMap Local is derived from large-scale information surveyed at 1:1250 scale (covering major towns and cities), 1:2500 scale (smaller towns, villages and developed rural areas), and 1:10 000 scale (mountain, moorland and river estuary areas).

### Map Name(s) and Date(s)

SE01NE 2015 Variable	SE11NW 2015 Variable
SE01SE 2015 Variable	SE11SW 2015 Variable

### Historical Map - Slice A

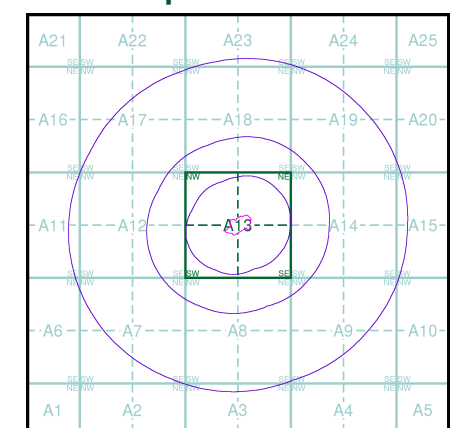

### Order Details

Order Number: 72526992\_1\_1  
 Customer Ref: MOY/02  
 National Grid Reference: 410900, 415470  
 Slice: A  
 Site Area (Ha): 1.23  
 Search Buffer (m): 1000

### Site Details

Land at, Cowlersley Lane, Linthwaite, HUDDERSFIELD



Tel: 0844 844 9952  
 Fax: 0844 844 9951  
 Web: www.envirocheck.co.uk

# Historical Mapping Legends

## Ordnance Survey County Series and Ordnance Survey Plan 1:2,500

**Quarry**   **Gravel Pit**   **Sand Pit**  
**Clay Pit**   **Shingle**   **Refuse Heap**  
**Sloping Masonry**   **Flat Rock**  
**Marsh**   **Reeds**   **Osiers**  
**Rough Pasture**   **Furze**   **Wood**  
**Mixed Wood**   **Brushwood**   **Orchard**  
**Fir**   **Ford**   **Stepping Stones**  
**Ferry**   **Waterfall**   **Lock**  
**Trig. Station**   **Altitude at Trig. Station**  
**B.M. 325.9**   **Bench Mark**   **Surface Level**  
**Arrow denotes flow of water**   **Antiquities (site of)**  
**Cutting**   **Embankment**  
**Railway crossing Road**   **Level Crossing**   **Road crossing Railway**  
**Railway crossing River or Canal**   **Road over single stream**   **Road over River or Canal**  
**County Boundary (Geographical)**  
**County & Civil Parish Boundary**  
**Administrative County & Civil Parish Boundary**  
**County Borough Boundary (England)**  
**County Burgh Boundary (Scotland)**  
**Co. Boro. Bdy.**  
**Co. Burgh Bdy.**  
**BP BS** Boundary Post or Stone   **P.C.B** Police Call Box  
**B.R.** Bridle Road   **P** Pump  
**E.P** Electricity Pylon   **S.P** Signal Post  
**F.B.** Foot Bridge   **SL** Sluice  
**F.P.** Foot Path   **Sp.** Spring  
**G.P** Guide Post or Board   **T.C.B** Telephone Call Box  
**M.S** Mile Stone   **Tr.** Trough  
**M.P M.R** Mooring Post or Ring   **W** Well

## Ordnance Survey Plan, Additional SIMs and Supply of Unpublished Survey Information 1:2,500 and 1:1,250

**Inactive Quarry, Chalk Pit or Clay Pit**   **Active Quarry, Chalk Pit or Clay Pit**  
**Rock**   **Boulders**  
**Cliff**   **Slopes**   **Top**  
**Roofed Building**   **Glazed Roof Building**  
**Sloping Masonry**   **Archway**  
**Non-Coniferous Tree (surveyed)**   **Coniferous Tree (surveyed)**  
**Non-Coniferous Trees (not surveyed)**   **Coniferous Trees (not surveyed)**  
**Orchard Tree**   **Scrub**   **Bracken**  
**Coppice, Osier**   **Reeds**   **Marsh, Saltings**  
**Rough Grassland**   **Heath**   **Culvert**  
**Direction of water flow**   **Bench Mark**   **Antiquity (site of)**  
**Cave Entrance**   **Triangulation Station**   **Electricity Pylon**  
**Electricity Transmission Line**  
**County Boundary (Geographical)**  
**County & Civil Parish Boundary**  
**Civil Parish Boundary**  
**Admin. County or County Bor. Boundary**  
**London Borough Boundary**  
**Symbol marking point where boundary mereing changes**  
**BH** Beer House   **P** Pillar, Pole or Post  
**BP, BS** Boundary Post or Stone   **PO** Post Office  
**Cn, C** Capstan, Crane   **PC** Public Convenience  
**Chy** Chimney   **PH** Public House  
**D Fn** Drinking Fountain   **Pp** Pump  
**EI P** Electricity Pillar or Post   **SB, S Br** Signal Box or Bridge  
**FAP** Fire Alarm Pillar   **SP, SL** Signal Post or Light  
**FB** Foot Bridge   **Spr** Spring  
**GP** Guide Post   **Tk** Tank or Track  
**H** Hydrant or Hydraulic   **TCB** Telephone Call Box  
**LC** Level Crossing   **TCP** Telephone Call Post  
**MH** Manhole   **Tr** Trough  
**MP** Mile Post or Mooring Post   **Wr Pt, Wr T** Water Point, Water Tap  
**MS** Mile Stone   **W** Well  
**NTL** Normal Tidal Limit   **Wd Pp** Wind Pump

## Large-Scale National Grid Data 1:2,500 and 1:1,250

**Cliff**   **Slopes**   **Top**  
**Rock**   **Rock (scattered)**  
**Boulders**   **Boulders (scattered)**  
**Positioned Boulder**   **Scree**  
**Non-Coniferous Tree (surveyed)**   **Coniferous Tree (surveyed)**  
**Non-Coniferous Trees (not surveyed)**   **Coniferous Trees (not surveyed)**  
**Orchard Tree**   **Scrub**   **Bracken**  
**Coppice, Osier**   **Reeds**   **Marsh, Saltings**  
**Rough Grassland**   **Heath**   **Culvert**  
**Direction of water flow**   **Triangulation Station**   **Antiquity (site of)**  
**Electricity Transmission Line**   **Electricity Pylon**  
**B.M. 231.60m** Bench Mark   **Buildings with Building Seed**  
**Roofed Building**   **Glazed Roof Building**  
**Civil parish/community boundary**  
**District boundary**  
**County boundary**  
**Boundary post/stone**  
**Boundary mereing symbol (note: these always appear in opposed pairs or groups of three)**  
**Bks** Barracks   **P** Pillar, Pole or Post  
**Bty** Battery   **PO** Post Office  
**Cemy** Cemetery   **PC** Public Convenience  
**Chy** Chimney   **Pp** Pump  
**Cis** Cistern   **Ppg Sta** Pumping Station  
**Dismtd Rly** Dismantled Railway   **PW** Place of Worship  
**EI Gen Sta** Electricity Generating Station   **Sewage Ppg Sta** Sewage Pumping Station  
**EI P** Electricity Pole, Pillar   **SB, S Br** Signal Box or Bridge  
**EI Sub Sta** Electricity Sub Station   **SP, SL** Signal Post or Light  
**FB** Filter Bed   **Spr** Spring  
**Fn / D Fn** Fountain / Drinking Ftn.   **Tk** Tank or Track  
**Gas Gov** Gas Valve Compound   **Tr** Trough  
**GVC** Gas Governor   **Wd Pp** Wind Pump  
**GP** Guide Post   **Wr Pt, Wr T** Water Point, Water Tap  
**MH** Manhole   **Wks** Works (building or area)  
**MP, MS** Mile Post or Mile Stone   **W** Well



**ARP GEOTECHNICAL LIMITED**  
**CHARTERED CONSULTING ENGINEERS**

## Historical Mapping & Photography included:

Mapping Type	Scale	Date	Pg
Yorkshire	1:2,500	1892 - 1893	2
Yorkshire	1:2,500	1906 - 1907	3
Yorkshire	1:2,500	1916 - 1919	4
Yorkshire	1:2,500	1938	5
Ordnance Survey Plan	1:1,250	1961	6
Additional SIMs	1:1,250	1961 - 1978	7
Ordnance Survey Plan	1:2,500	1962	8
Supply of Unpublished Survey Information	1:1,250	1975	9
Supply of Unpublished Survey Information	1:1,250	1975	10
Additional SIMs	1:1,250	1982 - 1990	11
Additional SIMs	1:1,250	1990	12
Large-Scale National Grid Data	1:1,250	1993	13
Large-Scale National Grid Data	1:1,250	1993 - 1995	14
Large-Scale National Grid Data	1:1,250	1993	15
Large-Scale National Grid Data	1:1,250	1996	16

## Historical Map - Segment A13

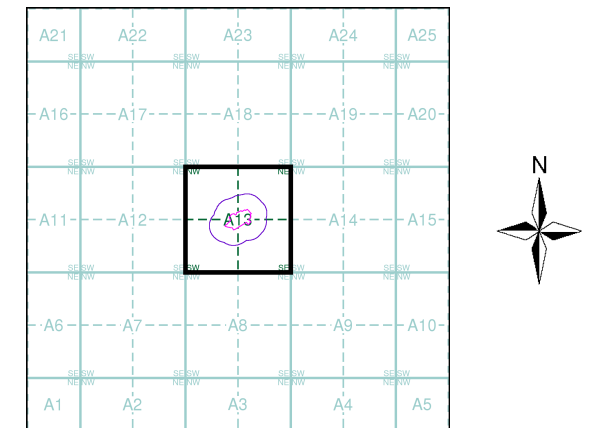

## Order Details

**Order Number:** 72526992\_1\_1  
**Customer Ref:** MOY/02  
**National Grid Reference:** 410900, 415470  
**Slice:** A  
**Site Area (Ha):** 1.23  
**Search Buffer (m):** 100

## Site Details

Land at, Cowlersley Lane, Linthwaite, HUDDERSFIELD



**Tel:** 0844 844 9952  
**Fax:** 0844 844 9951  
**Web:** www.envirocheck.co.uk



## Yorkshire

Published 1892 - 1893

Source map scale - 1:2,500

The historical maps shown were reproduced from maps predominantly held at the scale adopted for England, Wales and Scotland in the 1840's. In 1854 the 1:2,500 scale was adopted for mapping urban areas and by 1896 it covered the whole of what were considered to be the cultivated parts of Great Britain. The published date given below is often some years later than the surveyed date. Before 1938, all OS maps were based on the Cassini Projection, with independent surveys of a single county or group of counties, giving rise to significant inaccuracies in outlying areas.

### Map Name(s) and Date(s)

246_13 1893 1:2,500	246_14 1893 1:2,500
260_01 1892 1:2,500	260_02 1892 1:2,500

### Historical Map - Segment A13

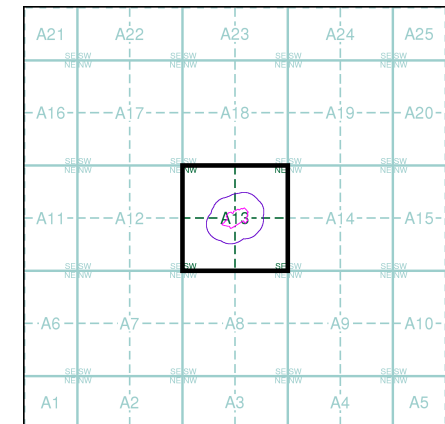

### Order Details

Order Number: 72526992\_1\_1  
Customer Ref: MOY/02  
National Grid Reference: 410900, 415470  
Slice: A  
Site Area (Ha): 1.23  
Search Buffer (m): 100

### Site Details

Land at, Cowlersley Lane, Linthwaite, HUDDERSFIELD

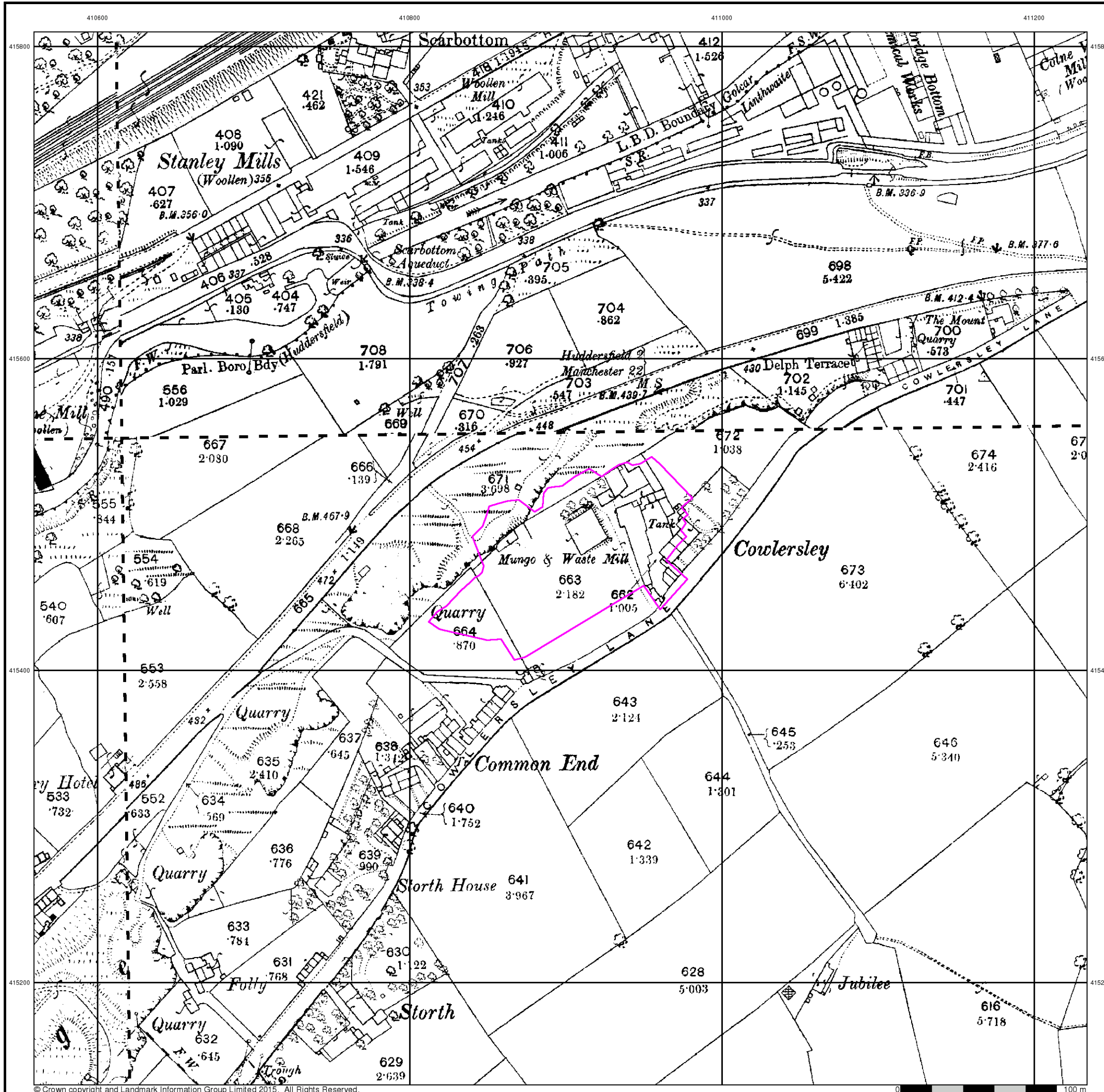



**Yorkshire**

**Published 1906 - 1907**

**Source map scale - 1:2,500**

The historical maps shown were reproduced from maps predominantly held at the scale adopted for England, Wales and Scotland in the 1840's. In 1854 the 1:2,500 scale was adopted for mapping urban areas and by 1896 it covered the whole of what were considered to be the cultivated parts of Great Britain. The published date given below is often some years later than the surveyed date. Before 1938, all OS maps were based on the Cassini Projection, with independent surveys of a single county or group of counties, giving rise to significant inaccuracies in outlying areas.

**Map Name(s) and Date(s)**

246_13 1907 1:2,500	246_14 1907 1:2,500
260_01 1906 1:2,500	260_02 1906 1:2,500

**Historical Map - Segment A13**

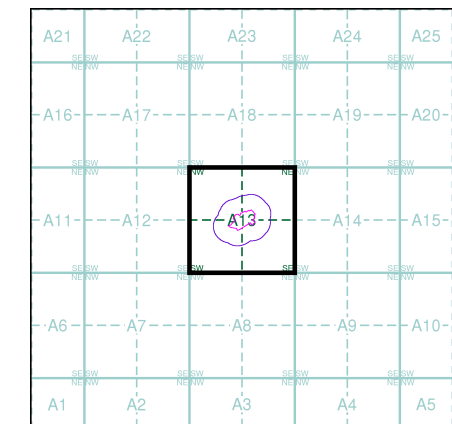

**Order Details**

Order Number: 72526992\_1\_1  
 Customer Ref: MOY/02  
 National Grid Reference: 410900, 415470  
 Slice: A  
 Site Area (Ha): 1.23  
 Search Buffer (m): 100

**Site Details**

Land at, Cowlersley Lane, Linthwaite, HUDDERSFIELD



Tel: 0844 844 9952  
 Fax: 0844 844 9951  
 Web: www.envirocheck.co.uk

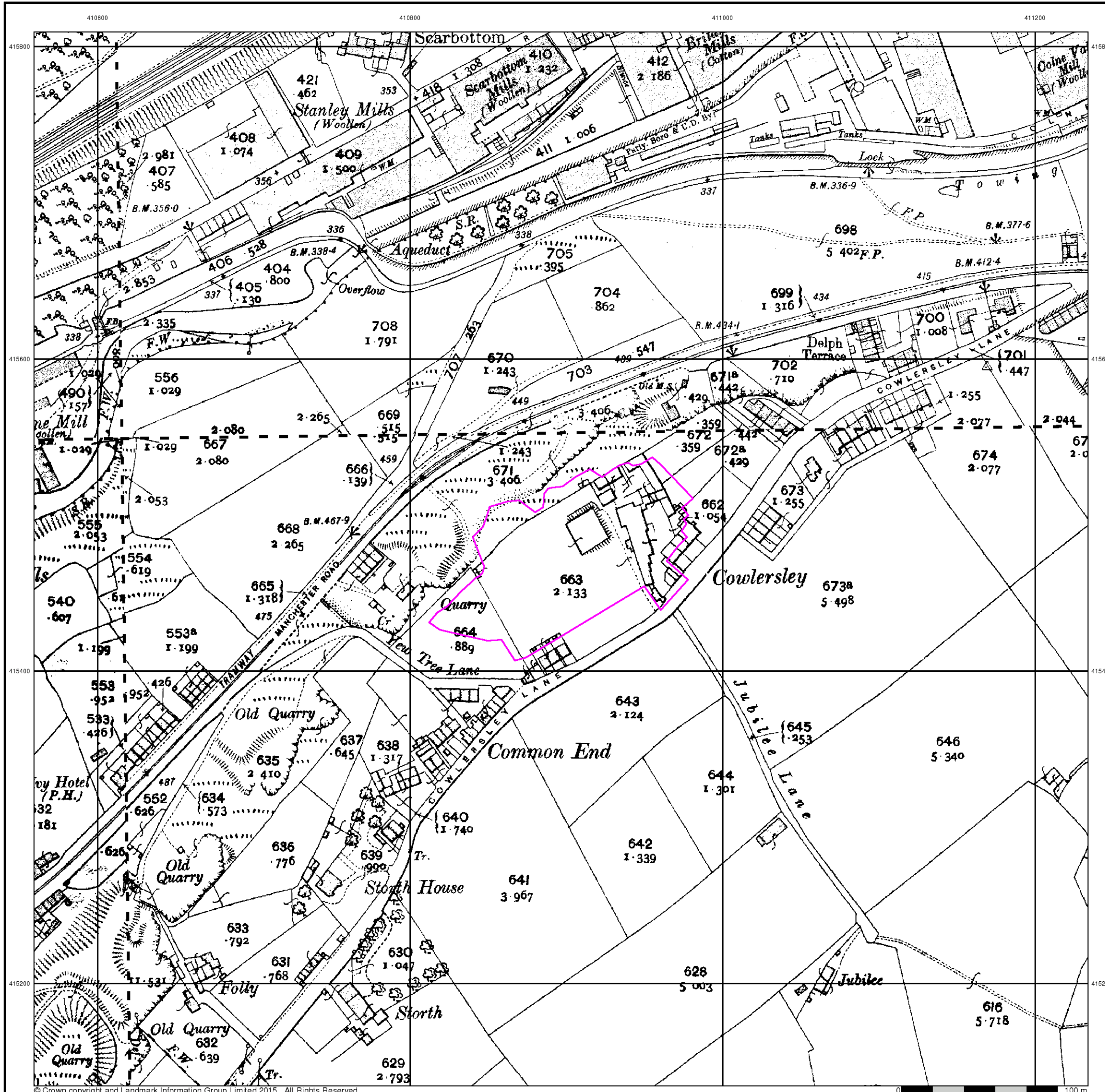



## Yorkshire

Published 1916 - 1919

Source map scale - 1:2,500

The historical maps shown were reproduced from maps predominantly held at the scale adopted for England, Wales and Scotland in the 1840's. In 1854 the 1:2,500 scale was adopted for mapping urban areas and by 1896 it covered the whole of what were considered to be the cultivated parts of Great Britain. The published date given below is often some years later than the surveyed date. Before 1938, all OS maps were based on the Cassini Projection, with independent surveys of a single county or group of counties, giving rise to significant inaccuracies in outlying areas.

### Map Name(s) and Date(s)

246_13 1919 1:2,500	246_14 1918 1:2,500
260_01 1918 1:2,500	260_02 1916 1:2,500

### Historical Map - Segment A13

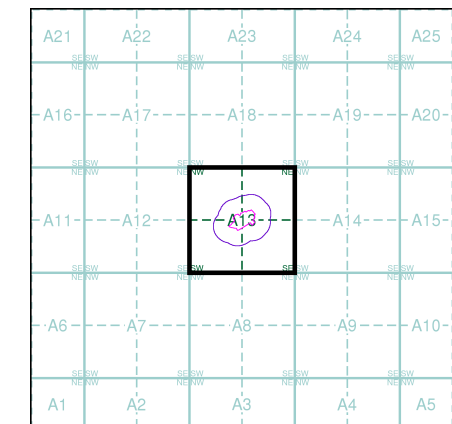

### Order Details

Order Number: 72526992\_1\_1  
Customer Ref: MOY/02  
National Grid Reference: 410900, 415470  
Slice: A  
Site Area (Ha): 1.23  
Search Buffer (m): 100

### Site Details

Land at, Cowlersley Lane, Linthwaite, HUDDERSFIELD

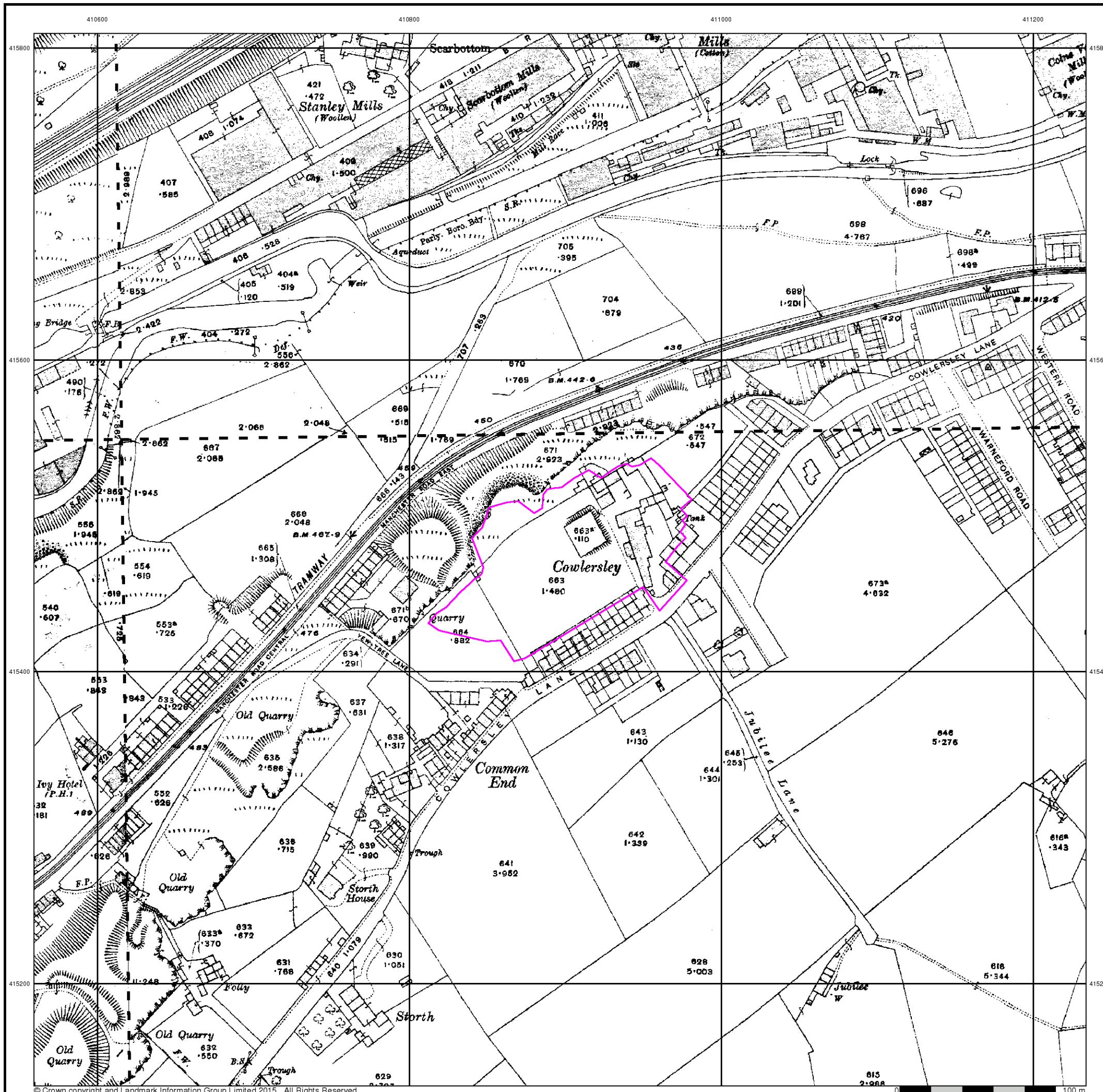

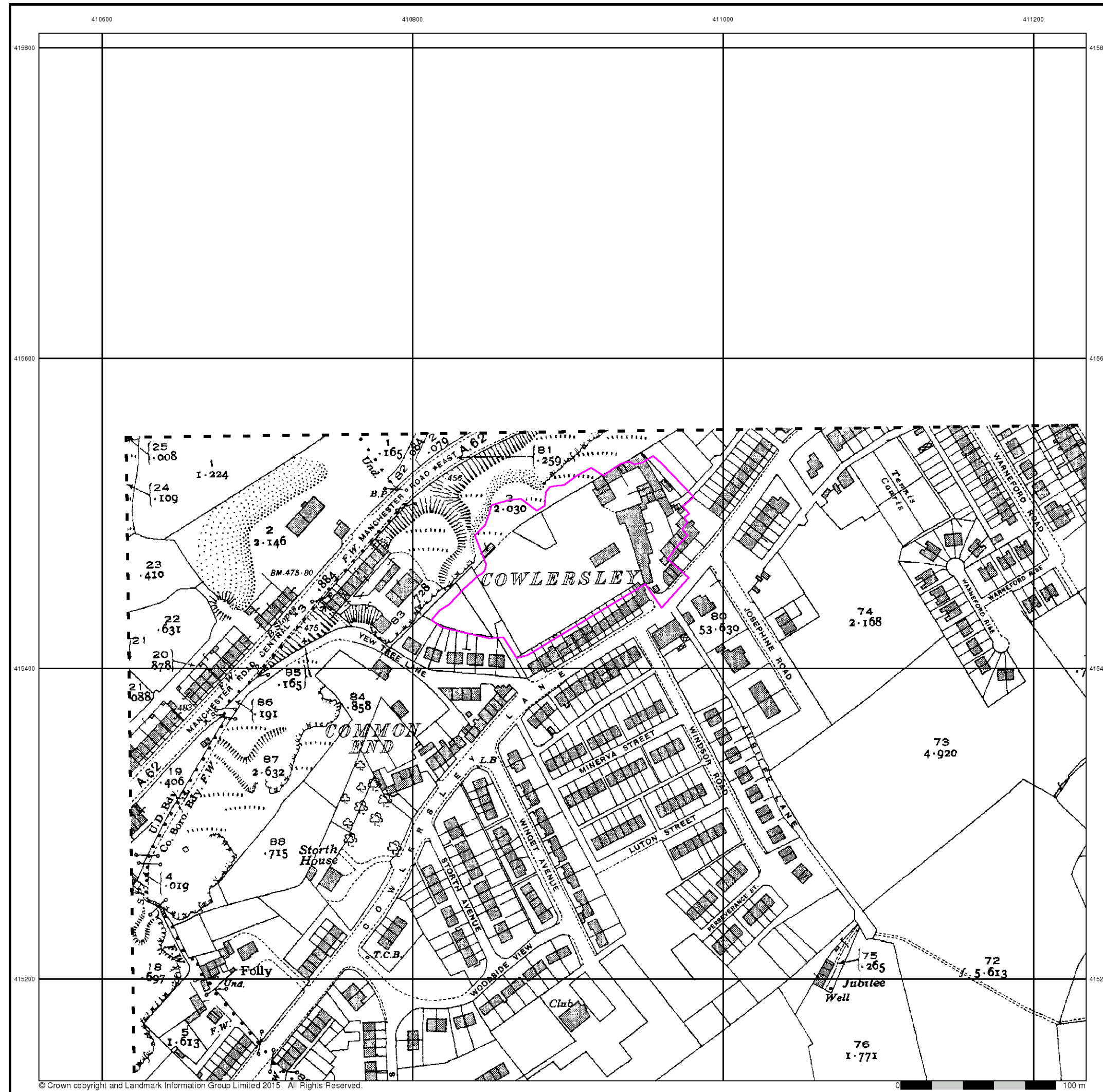

**ARP GEOTECHNICAL LIMITED**  
**CHARTERED CONSULTING ENGINEERS**

## Yorkshire

**Published 1938**

**Source map scale - 1:2,500**

The historical maps shown were reproduced from maps predominantly held at the scale adopted for England, Wales and Scotland in the 1840's. In 1854 the 1:2,500 scale was adopted for mapping urban areas and by 1896 it covered the whole of what were considered to be the cultivated parts of Great Britain. The published date given below is often some years later than the surveyed date. Before 1938, all OS maps were based on the Cassini Projection, with independent surveys of a single county or group of counties, giving rise to significant inaccuracies in outlying areas.

### Map Name(s) and Date(s)

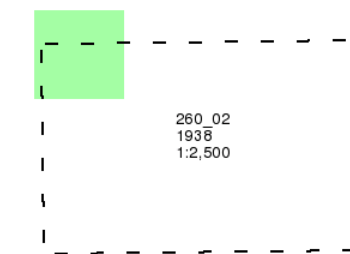

### Historical Map - Segment A13

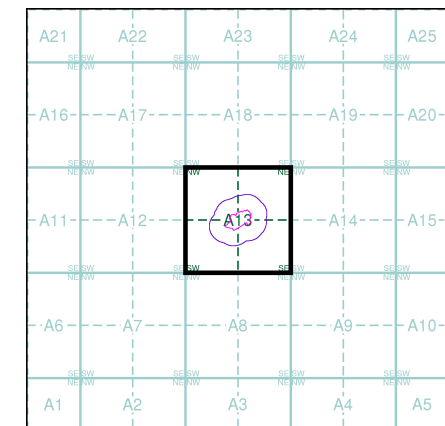

### Order Details

Order Number: 72526992\_1\_1  
 Customer Ref: MOY/02  
 National Grid Reference: 410900, 415470  
 Slice: A  
 Site Area (Ha): 1.23  
 Search Buffer (m): 100

### Site Details

Land at, Cowlersley Lane, Linthwaite, HUDDERSFIELD



Tel: 0844 844 9952  
 Fax: 0844 844 9951  
 Web: www.envirocheck.co.uk



**ARP GEOTECHNICAL LIMITED**  
**CHARTERED CONSULTING ENGINEERS**

## Ordnance Survey Plan

Published 1961

Source map scale - 1:1,250

The historical maps shown were reproduced from maps predominantly held at the scale adopted for England, Wales and Scotland in the 1840's. In 1854 the 1:2,500 scale was adopted for mapping urban areas and by 1896 it covered the whole of what were considered to be the cultivated parts of Great Britain. The published date given below is often some years later than the surveyed date. Before 1938, all OS maps were based on the Cassini Projection, with independent surveys of a single county or group of counties, giving rise to significant inaccuracies in outlying areas.

### Map Name(s) and Date(s)

SE 1015NE 1961 1:1,250	SE 1115NW 1961 1:1,250
SE 1015SE 1961 1:1,250	SE 1115SW 1961 1:1,250

### Historical Map - Segment A13

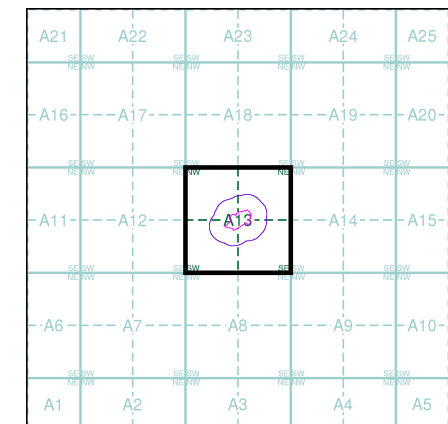

### Order Details

Order Number: 72526992\_1\_1  
 Customer Ref: MOY/02  
 National Grid Reference: 410900, 415470  
 Slice: A  
 Site Area (Ha): 1.23  
 Search Buffer (m): 100

### Site Details

Land at, Cowlersley Lane, Linthwaite, HUDDERSFIELD



Tel: 0844 844 9952  
 Fax: 0844 844 9951  
 Web: www.envirocheck.co.uk

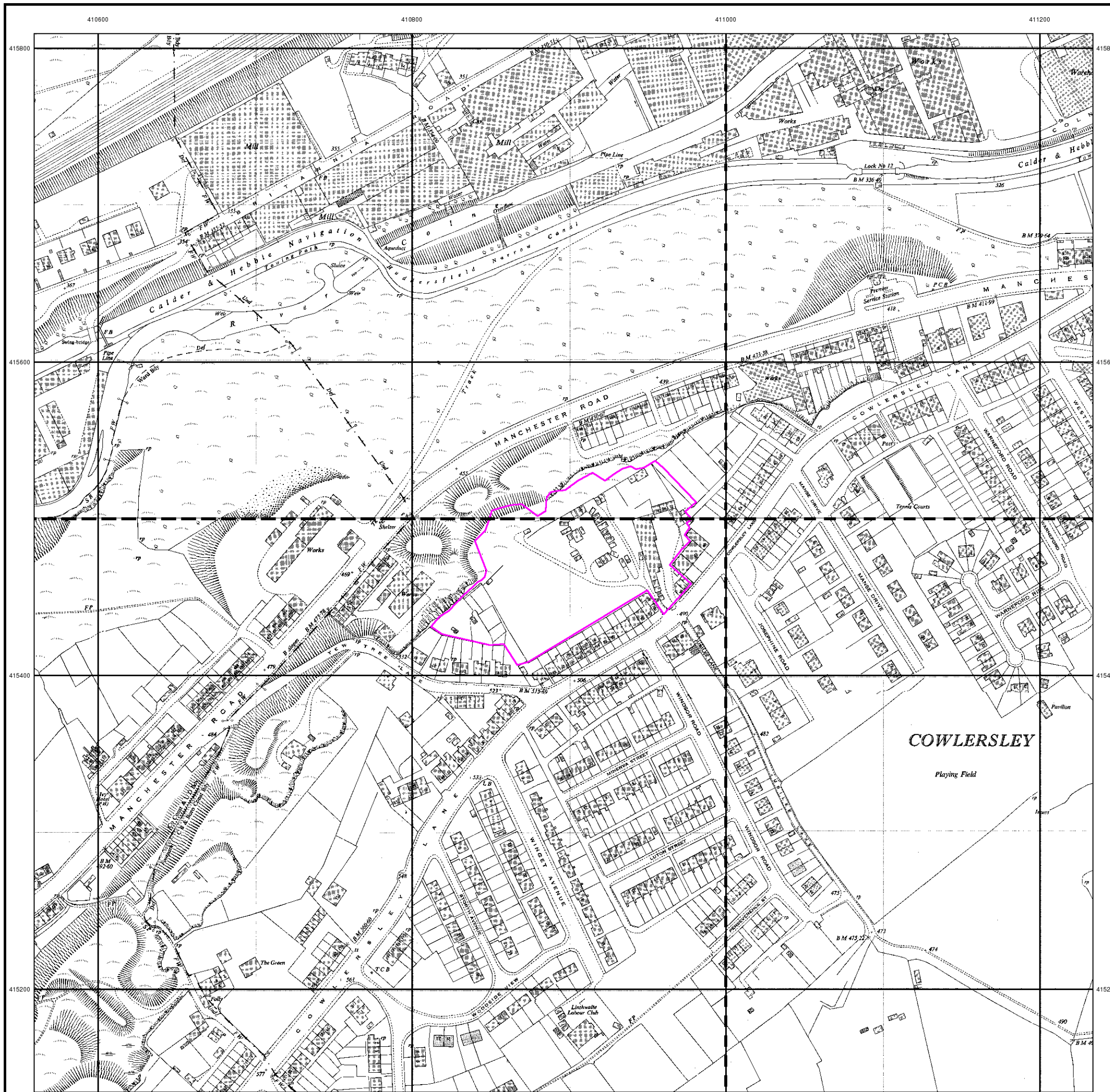

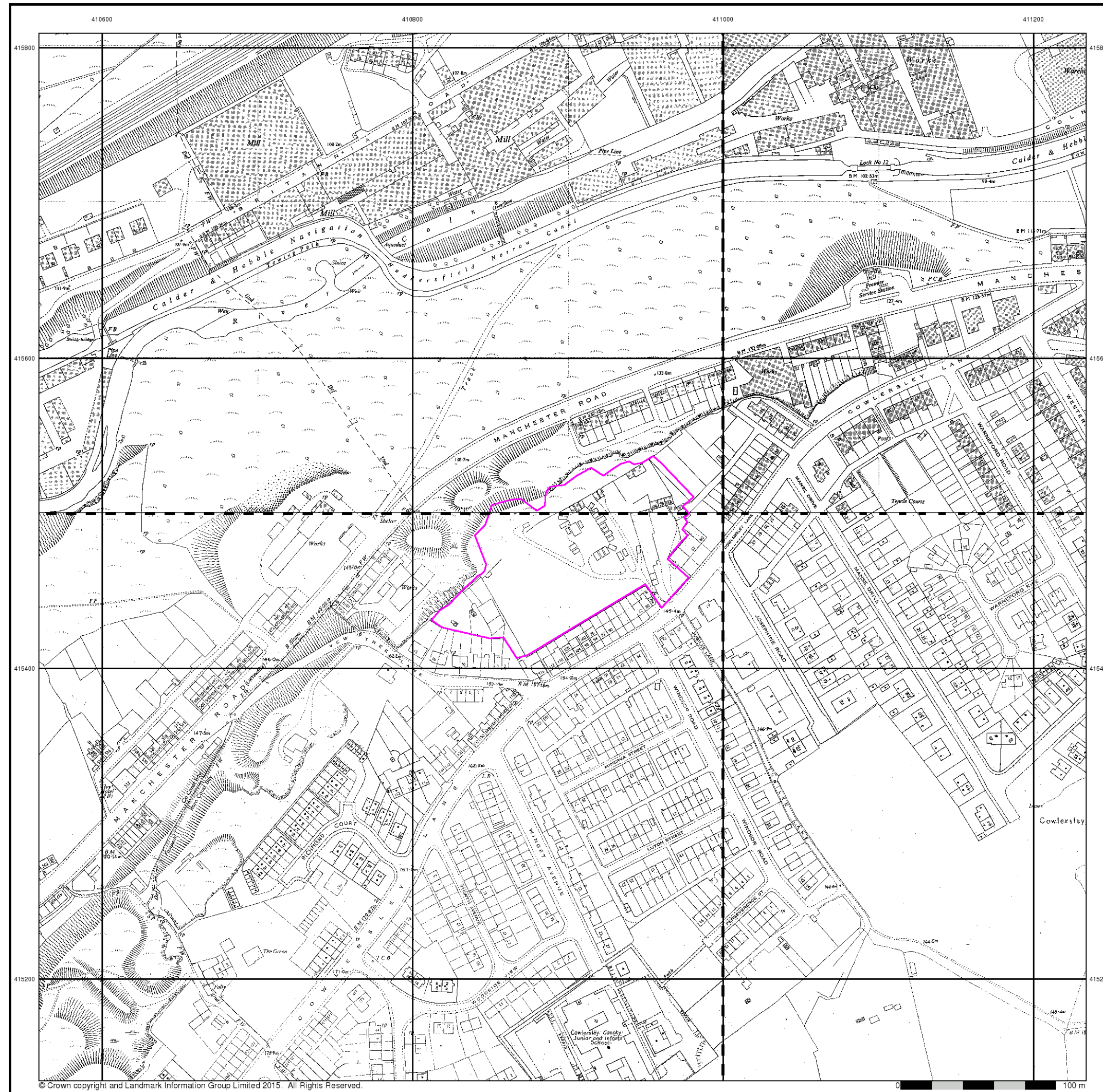

**ARP GEOTECHNICAL LIMITED**  
**CHARTERED CONSULTING ENGINEERS**

**Additional SIMs**

**Published 1961 - 1978**

**Source map scale - 1:1,250**

The SIM cards (Ordnance Survey's 'Survey of Information on Microfilm') are further, minor editions of mapping which were produced and published in between the main editions as an area was updated. They date from 1947 to 1994, and contain detailed information on buildings, roads and land-use. These maps were produced at both 1:2,500 and 1:1,250 scales.

**Map Name(s) and Date(s)**

SE 1015NE	SE 1115NW
1961	1963
1:1,250	1:1,250
SE 1015SE	SE 1115SW
1978	1978
1:1,250	1:1,250

**Historical Map - Segment A13**

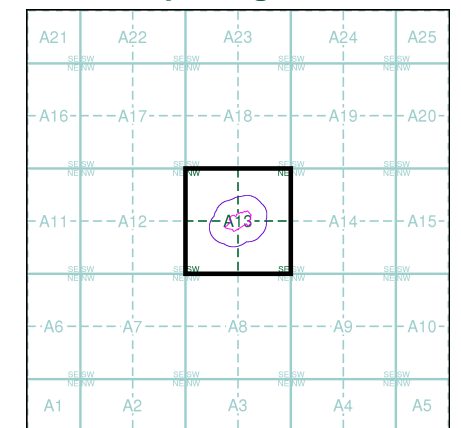

**Order Details**

Order Number: 72526992\_1\_1  
 Customer Ref: MOY/02  
 National Grid Reference: 410900, 415470  
 Slice: A  
 Site Area (Ha): 1.23  
 Search Buffer (m): 100

**Site Details**

Land at, Cawlersley Lane, Linthwaite, HUDDERSFIELD



Tel: 0844 844 9952  
 Fax: 0844 844 9951  
 Web: www.envirocheck.co.uk

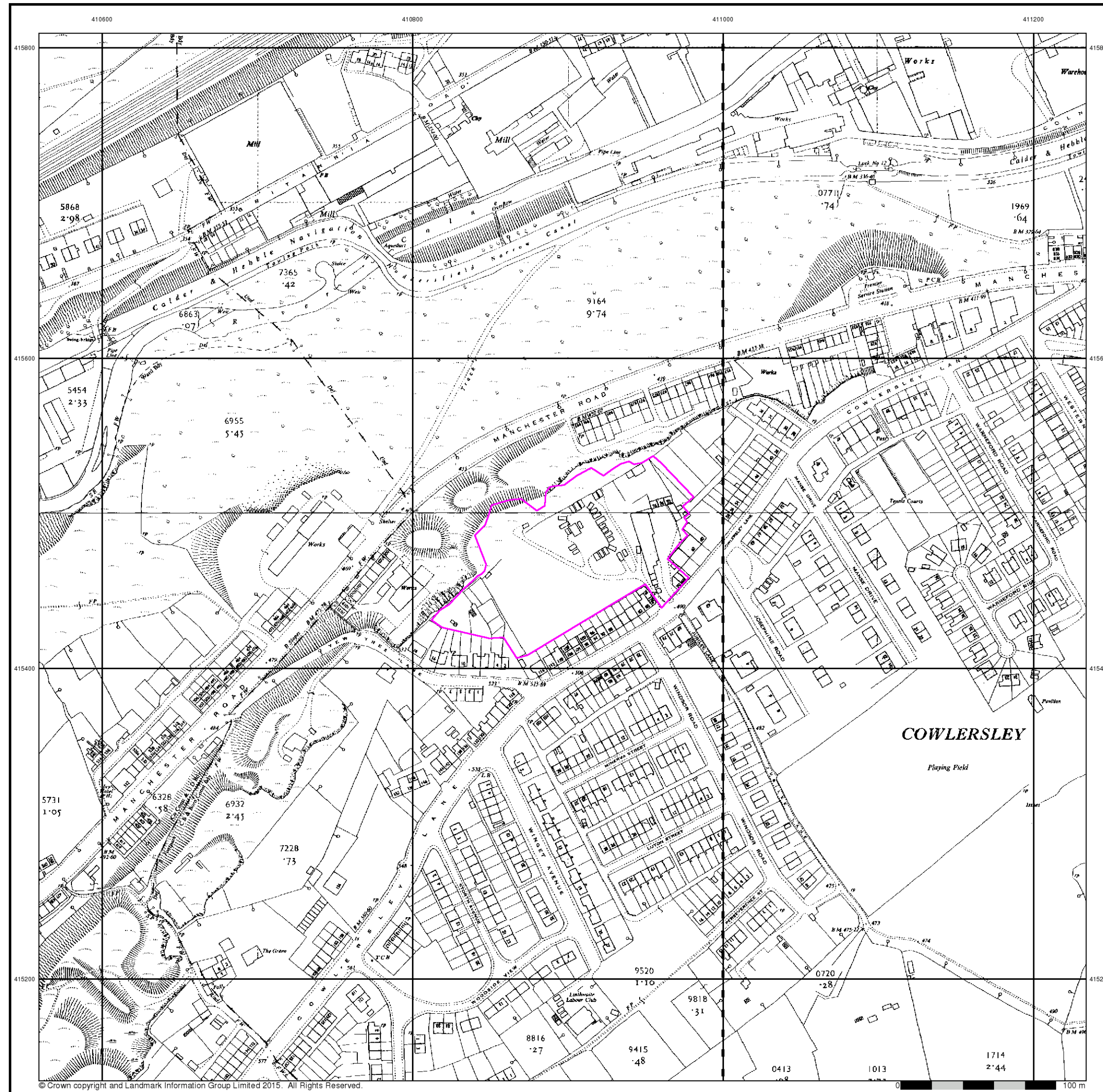

**ARP GEOTECHNICAL LIMITED**  
**CHARTERED CONSULTING ENGINEERS**

**Ordnance Survey Plan**  
**Published 1962**  
**Source map scale - 1:2,500**

The historical maps shown were reproduced from maps predominantly held at the scale adopted for England, Wales and Scotland in the 1840's. In 1854 the 1:2,500 scale was adopted for mapping urban areas and by 1896 it covered the whole of what were considered to be the cultivated parts of Great Britain. The published date given below is often some years later than the surveyed date. Before 1938, all OS maps were based on the Cassini Projection, with independent surveys of a single county or group of counties, giving rise to significant inaccuracies in outlying areas.

**Map Name(s) and Date(s)**

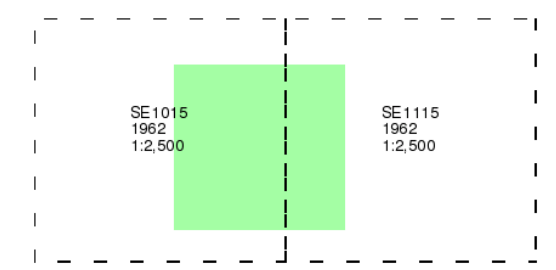

**Historical Map - Segment A13**

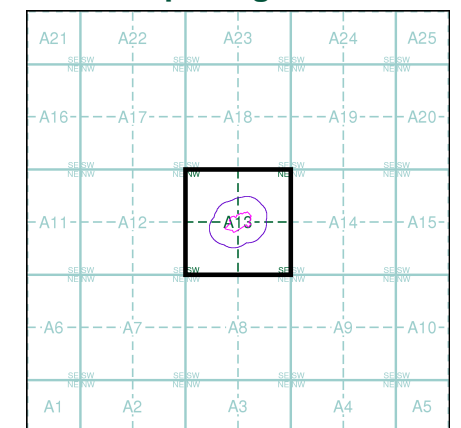

**Order Details**

Order Number: 72526992\_1\_1  
 Customer Ref: MOY/02  
 National Grid Reference: 410900, 415470  
 Slice: A  
 Site Area (Ha): 1.23  
 Search Buffer (m): 100

**Site Details**

Land at, Cowlersley Lane, Linthwaite, HUDDERSFIELD



Tel: 0844 844 9952  
 Fax: 0844 844 9951  
 Web: www.envirocheck.co.uk

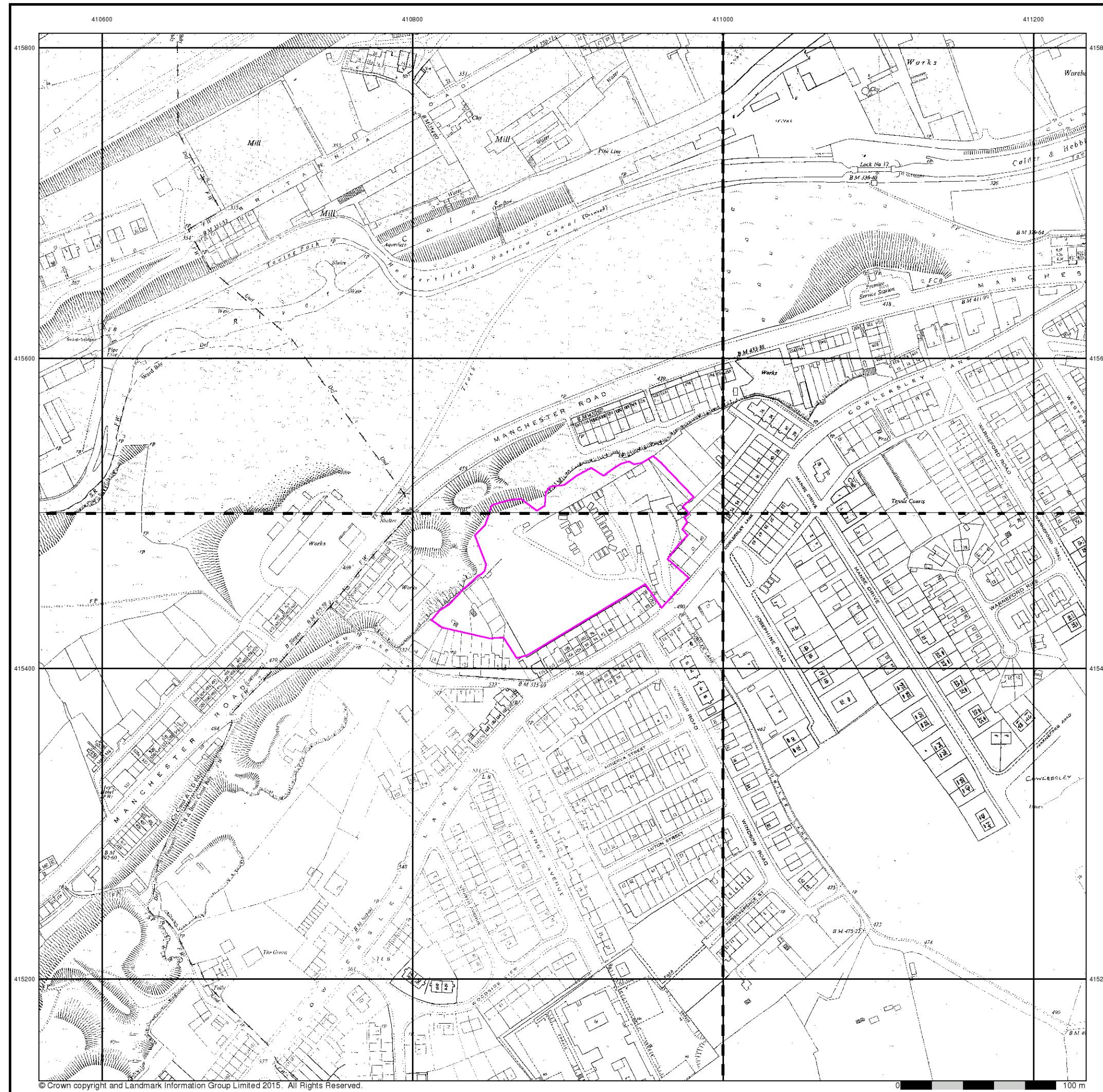

**ARP GEOTECHNICAL LIMITED**  
**CHARTERED CONSULTING ENGINEERS**

## Supply of Unpublished Survey Information

**Published 1975**

**Source map scale - 1:1,250**

SUSI maps (Supply of Unpublished Survey Information) were produced between 1972 and 1977, mainly for internal use at Ordnance Survey. These were more of a 'work-in-progress' plan as they showed updates of individual areas on a map. These maps were unpublished, and they do not represent a single moment in time. They were produced at both 1:2,500 and 1:1,250 scales.

### Map Name(s) and Date(s)

SE 1015NE	SE 1115NW
1975	1975
1:1,250	1:1,250
SE 1015SE	SE 1115SW
1975	1975
1:1,250	1:1,250

### Historical Map - Segment A13

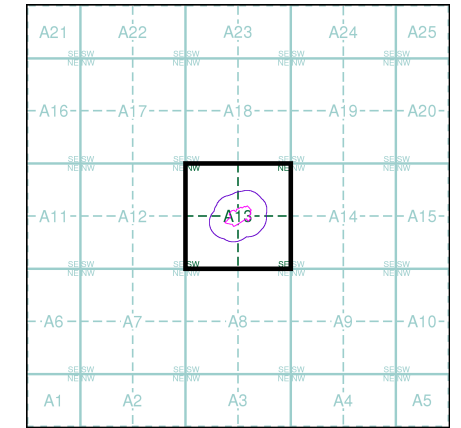

### Order Details

Order Number: 72526992\_1\_1  
 Customer Ref: MOY/02  
 National Grid Reference: 410900, 415470  
 Slice: A  
 Site Area (Ha): 1.23  
 Search Buffer (m): 100

### Site Details

Land at, Cawlersley Lane, Linthwaite, HUDDERSFIELD



Tel: 0844 844 9952  
 Fax: 0844 844 9951  
 Web: www.envirocheck.co.uk