

T1 X EXISTING PINE TREE  
TO BE REMOVED

Distance to boundary wall  
1800 mm

Distance to boundary wall  
1300 mm

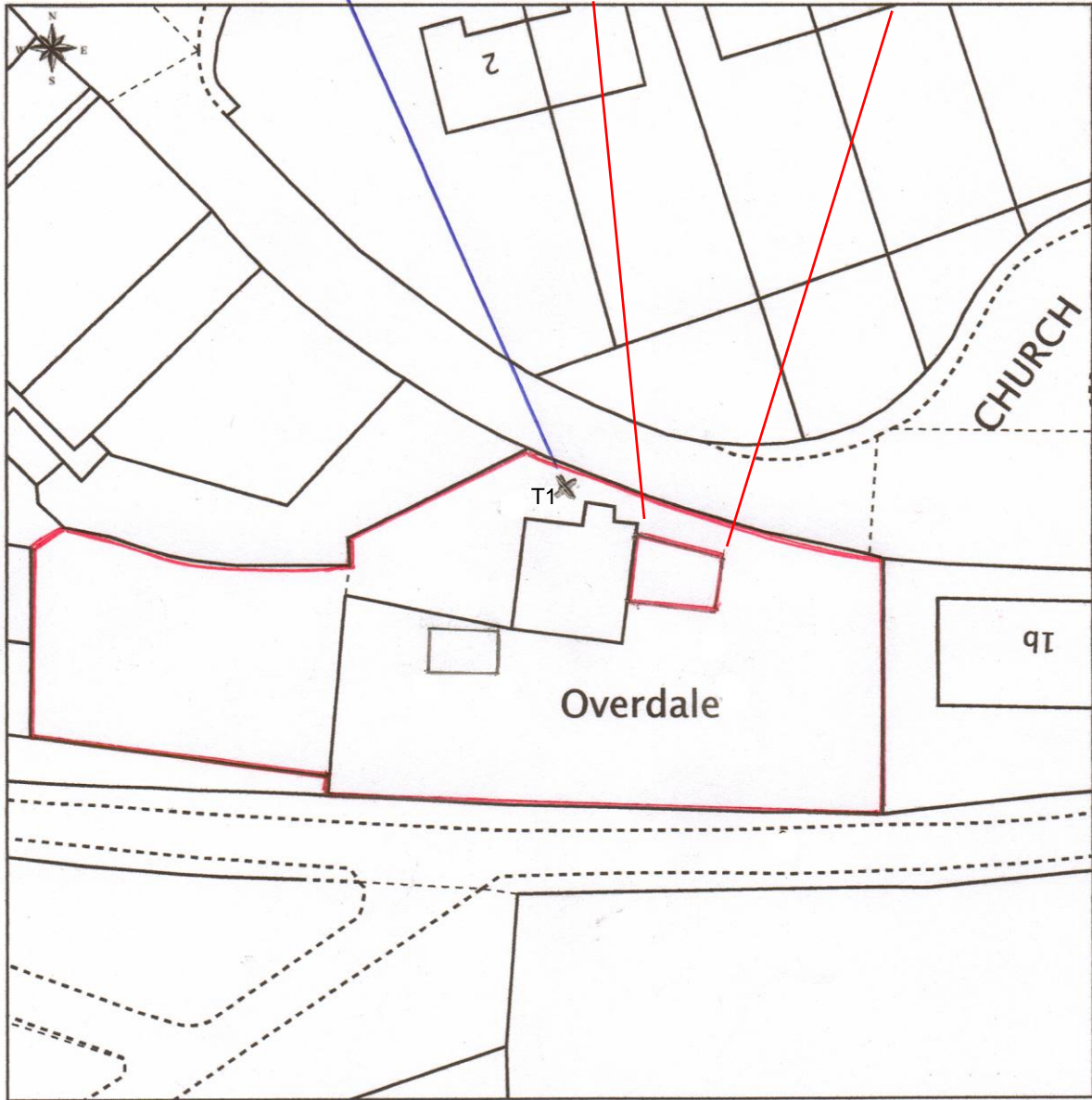

This Plan includes the following Licensed Data: OS MasterMap, Black and White Block Plan by the Ordnance Survey National Geographic Database and incorporating surveyed revision available at the date of production. Reproduction in whole or in part is prohibited without the prior permission of Ordnance Survey. The representation of a road, track or path is no evidence of a right of way. The representation of features as lines is no evidence of a property boundary. © Crown copyright and database rights 2013. Ordnance Survey 0100031673

5m 10m 15m 20m 25m 30m 35m

Scale: 1:500, paper size: A4

Licence number 0100031673

Purchased by David Mayne 08.08.13

**plans ahead** by emapsite