

Revisions :-

OFFICE COPY

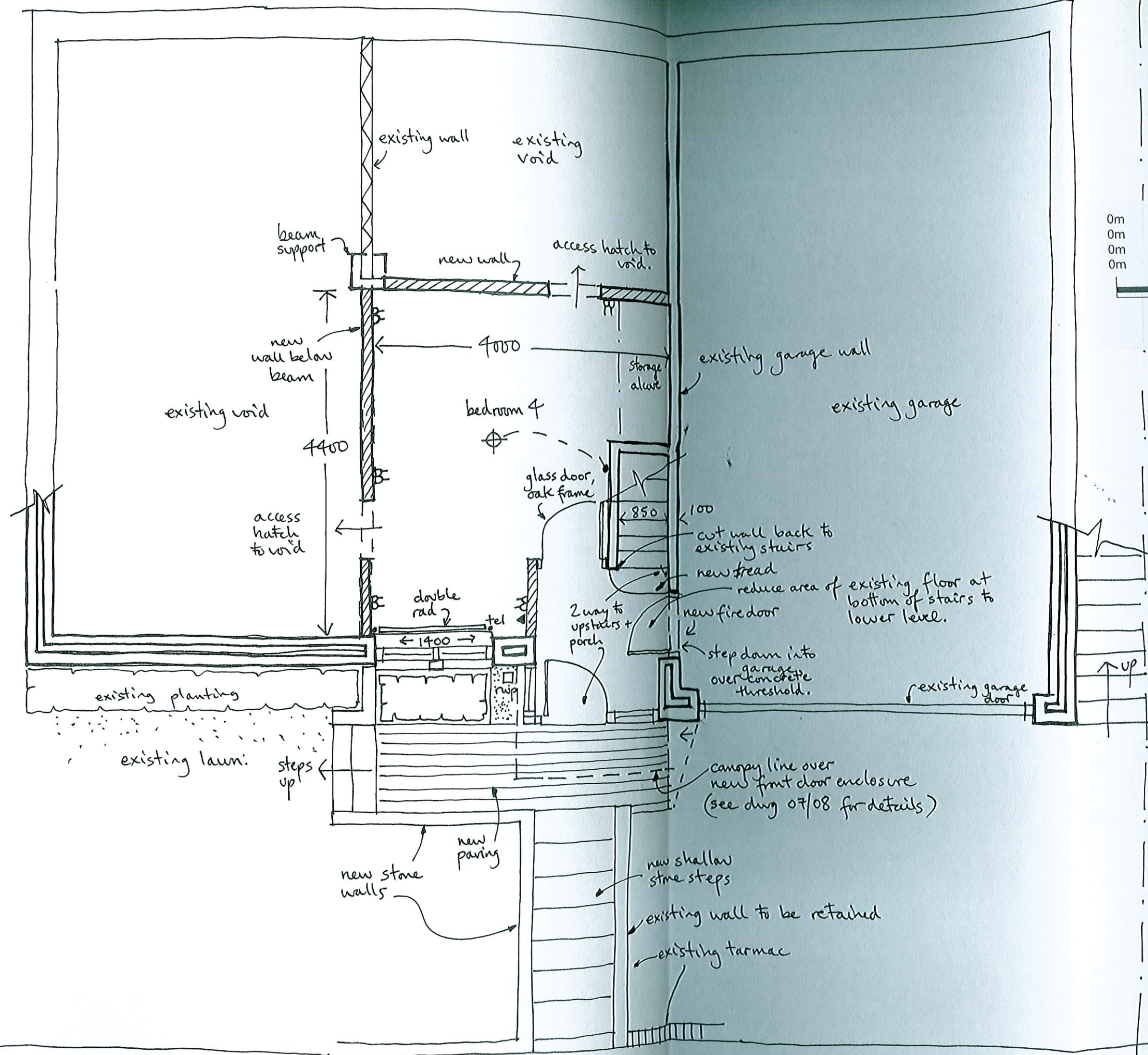
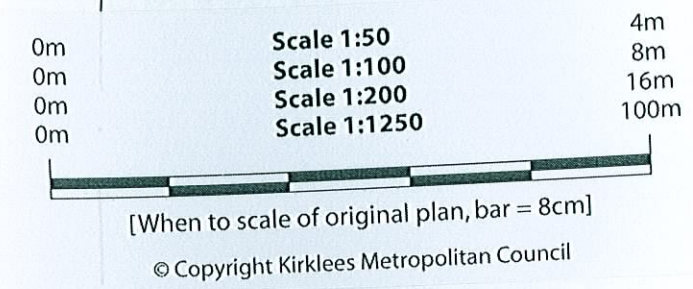

Additions and Alterations to
10, Allergill Park,
Upperthong, Holmfirth,
Yorkshire, HD9 3XH.
for
Gwen and John Yard

Proposed Ground Floor C

Scale : 1: 50 May 2007

Drawing No. 07/06 rev 0

john yard **jy**
architect
10, Allergill Park,
Upperthong,
Holmfirth,
HD9 3XH
West Yorkshire
Tel/fax 01484 687412
m 07739 084038

KIRKLEES METROPOLITAN COUNCIL
- 4 JAN 2008
RECEIVED