

**ROOF**

'marley modern' concrete tiles to match existing on 50 x 25 sw. battens on roofing felt on 100 x 50 sw. rafters at 400 c/c - 150 x 25 sw. ridge - 100 x 50 sw. ceiling joists at 400 c/c supported by 75 x 50 sw. hangers - 100 x 50 sw. 3 no. rafters at 1.8m c/c - vent roof space by continuous 15 air gap behind sw fascia board & 225 x 150 sleeved air grates. 100 insulation quilt between ceiling joists plus 100 insulation quilt over total ceiling area - over 13 foil backed plasterboard & 5 skim finish to all roof voids

**FIRST FLOOR**

20 1&g boards on grade SC3 150 x 50 sw joists @ 400 c/c - finish underside in 13 'fireline' over garage area plasterboard & 5 skim - 30 x 5 galv. m.s. lateral restraint straps @ 1.8m c/c over 3 no. joists - fixing to existing wall by galv. m.s. joist hangers - include for 100 insulation quilt between joists over garage area only - strutting between all joists at midspan

**WALLS**

natural stone external leaf to match existing - 50 continuous clear cavity closed @ eaves with blocks - inner leaf 100 thermal block with 42 insulation batts finish internally with 13 plaster & 5 skim - horizontal dpc min. 150 above ground level - 150 x 100 stone head & cill to new external openings to match existing - all new walls fully bonded to existing - vertical twist type wall ties at 450c/c vert. & 750c/c horiz. - internal loadbearing walls in 100 blockwork off 400 x 150 concrete strip foundation taken down to suit site conditions & to BCO approval - include for dpc min. 150 above GL - finish both sides in 13 plaster & 5 skim - reinforced concrete lintols (2 - T12 dia. bars in bottom) to internal openings unless stated otherwise (up to 1200 span use 150 deep x 100 - up to 1800 span use 215 deep x 100 - over 1800 see plan) - internal non loadbearing walls built off double joists under in 75 x 50 sw. studs @ 400 c/c - finish both sides in 9 plasterboard & 5 skim unless stated otherwise

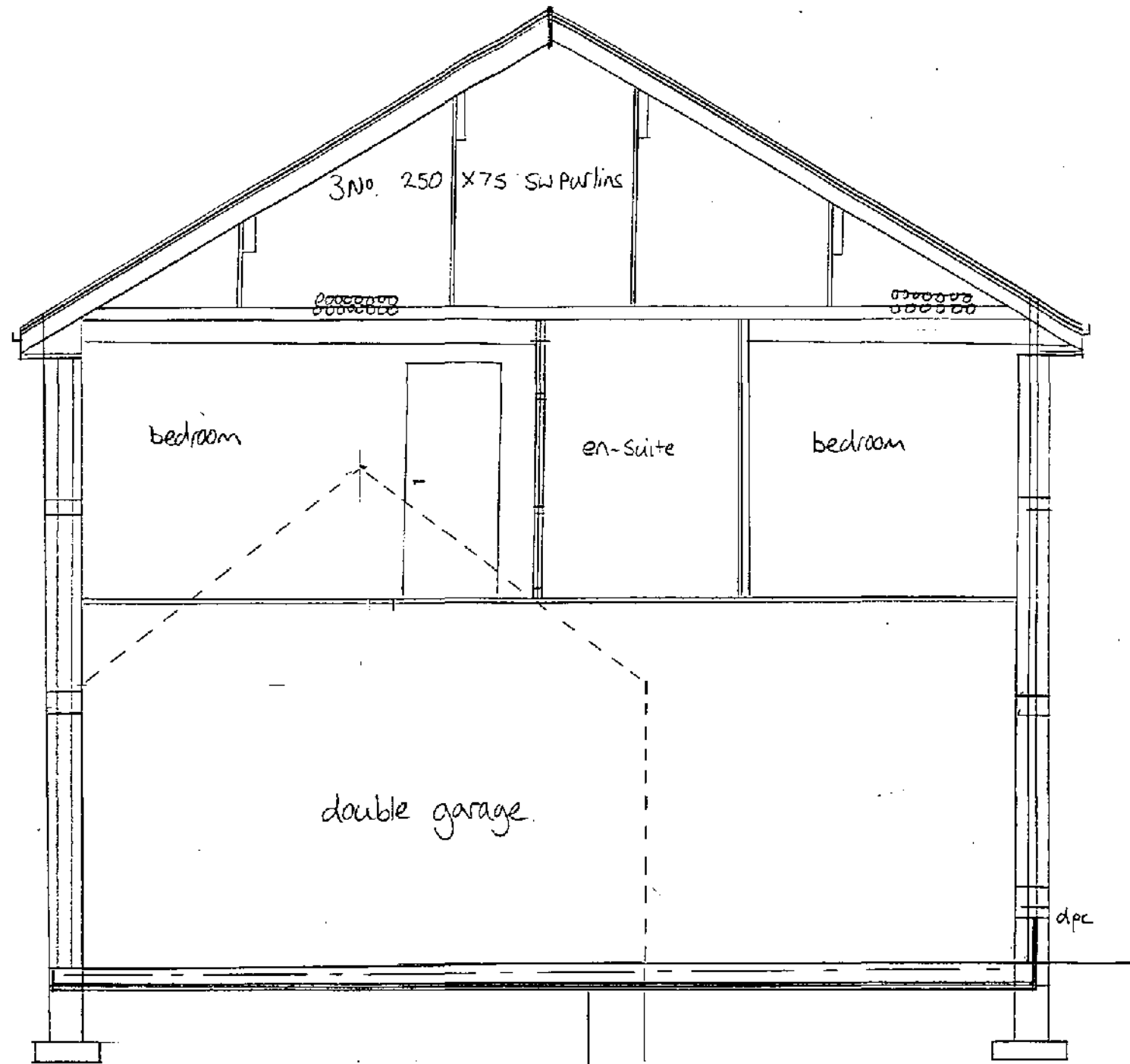

a-a

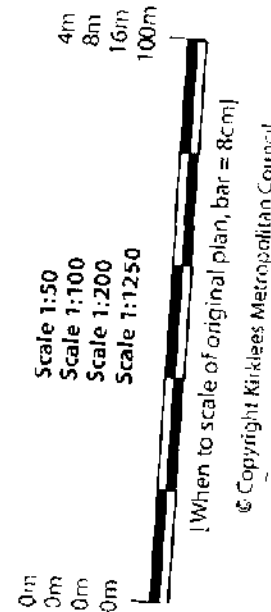

**KIRKLEES METROPOLITAN COUNCIL**  
**APPROVED**  
 19 JUL 2002  
 TO BE READ IN CONIUNCTION WITH THE APPLICATION AND DECISION DOCUMENTS  
**PLANNING SERVICES**

**WARNING**  
 YOU ARE ADVISED TO CONTACT BUILDING CONTROL PRIOR TO COMMENCING WORK AS BUILDING REGULATIONS APPROVAL MAY BE REQUIRED

PROPOSED EXTENSION AT 22 BARCROFT  
 KIRKHEATON HUDDERSFIELD H05044  
 FOR MR M D HODGSON  
 Scale 1:50 — drawing no 3 of 4

**KIRKLEES METROPOLITAN COUNCIL**  
 29 MAY 2002  
**RECEIVED**