

SF-TO-1			
Code	Easting	Northing	Height
FM1	419911.561	425772.538	118.350
M1A	419947.064	425809.521	121.925
M2	419946.210	425763.737	118.427
N1L	419899.889	425760.304	117.472
N2L	419918.034	425791.914	119.914

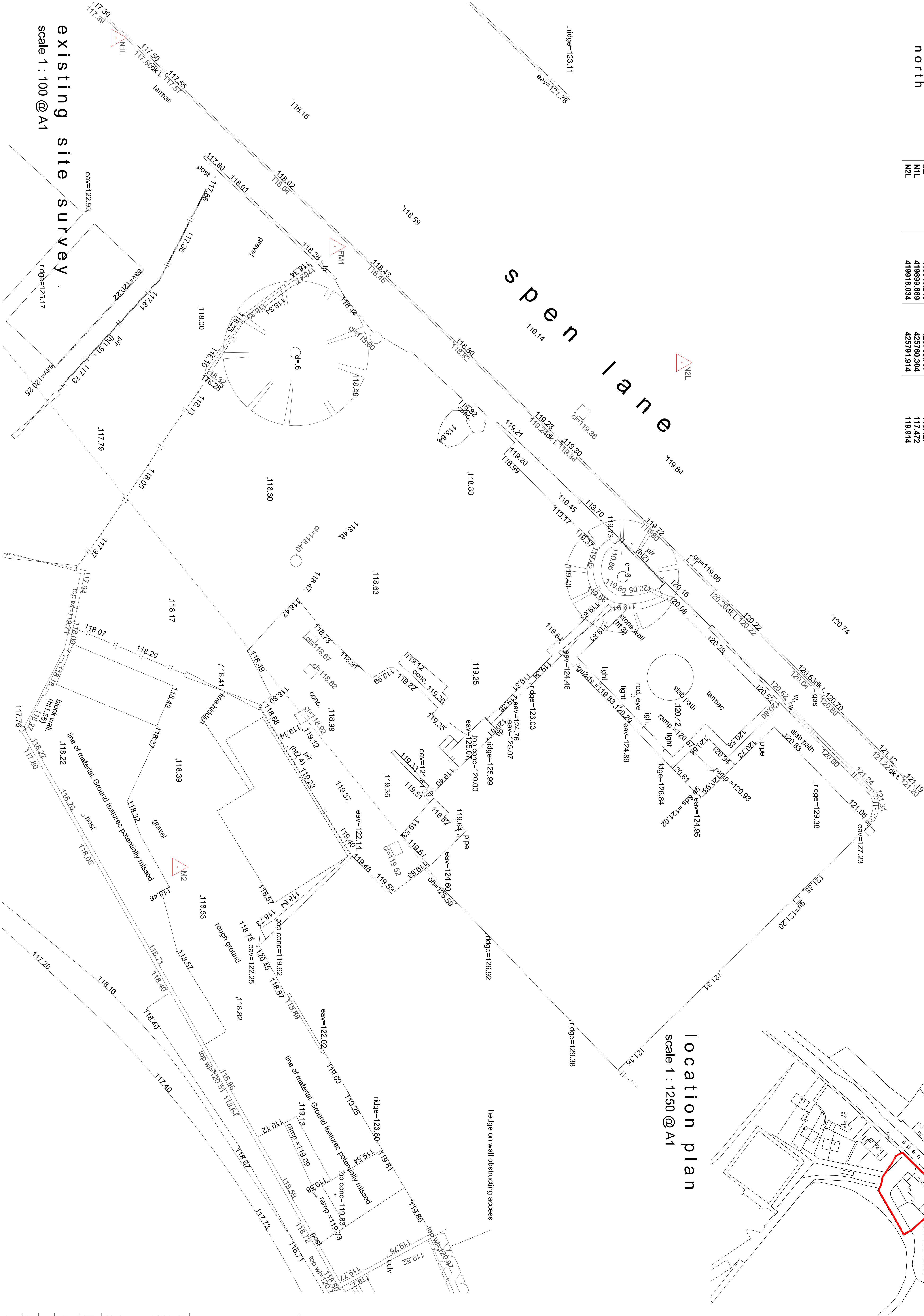

location plan
scale 1 : 1250 @ A1

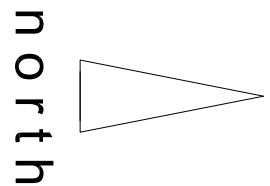

NOTES

Do not scale from this drawing.

LAYOUT AND LEVELS ARE TAKEN FROM TOPOGRAPHICAL SURVEY ANY DISCREPANCIES ARE TO BE REPORTED TO THE ADDRESS.

THIS DRAWING IS VALID FOR THE USE OF OBTAINING PLANNING PERMISSION.

THIS DRAWING IS TO BE USED IN CONJUNCTION WITH ALL RELATED DRAWINGS. ALL DIMENSIONS MUST BE CHECKED AND VERIFIED ON SITE BEFORE COMMENCING ANY WORK OR PRODUCING SHOP DRAWINGS. THE ORIGINAL DRAWING IS VALID IMMEDIATELY AFTER SIGNING OFF.

SITE AREA : 1472.26 m² 15855 sq ft.



e.nj@njplus.com
27 Margerson Road, Liley, S29 8QY
01943 605381
Copyright 2012 nj+ARCHITECTS

Proposed New Residential Development
at
224 Spen Lane
Cleckheaton

for
Quarters Development Ltd
planning submission

Title:			
Existing Site Survey			
Scale:	1 : 100 @ A1	Drawn by:	jszn
Date:	17 march 17	Checked by:	NJ
Drawing No:	17.101.101	Rev:	-

existing site survey .
scale 1 : 100 @ A1