

Biodiversity Mitigation and Enhancements to Site Ecology

Based on recommendations in the Ecological Assessment and Bat Survey reports by Weddle Landscape Design, September 2015, and in consultation response from Kirklees Council Heritage & Design

1 Incorporate native plant species

Include native species to provide pollen, nectar and cover for invertebrates, integrated with selected cultivars of native plants and additional ornamental species. Selected to attract and provide habitat for wildlife, and maximum visual amenity

Tree species to include

Acer campestre Elmijk
Betula pendula
Carpinus betulus var.
Cornus sanguinea 'Paul's Scarlet'
Malus sylvestris
Pyrus calleryana 'Chanticleer'
Sorbus aucuparia 'Cardinal Royal'
Salix alba
Tilia x cordata

Tall Shrubs to include

Buddleia davidii 'Nanho Purple'
Cornus sanguinea 'Mid-Winter fire'
Pyracantha coccinea 'Red Cañon'
Viburnum tinus 'Eve Price'

Ground cover species to include

Geranium macrorrhizum
Hebe Great Orme
Potentilla fruticosa 'Princess Beatty'
Oxalis Martiana
Sierchia japonica 'Ruhelle'
Vinca major 'Elegantissima'
Ceanothus thyrsiflorus repens

2 Landscaping and habitat networks

Native hedge planting to the site boundary adjacent to the railway line/green corridor to develop habitat networks within and beyond the site.

3 Bats

3 artificial bat roosting boxes will be incorporated on buildings. Night time lighting levels to remain low with no spillage into tree habitats and corridors or installed bat boxes.

4 Bird nesting and site clearance guidelines

To initiate bird nesting habitat 20% sparrow terraces, 20% swift boxes and 20% woodcrete nest boxes for starlings should be secured to buildings and trees as indicated. In compliance with Wildlife and Countryside Act 1981, no construction work or demolition which will disturb nesting birds should take place during the breeding season (March-August).

5 Invertebrate habitat

Native and other selected plant species will help provide habitat for invertebrates.

6 Meadow Planting

Meadow planting with a high diversity of plant species

7 Hedgerows

Tree-lined and other potential barriers to be designed not to impede or obstruct free movement of hedgerows within and beyond the site

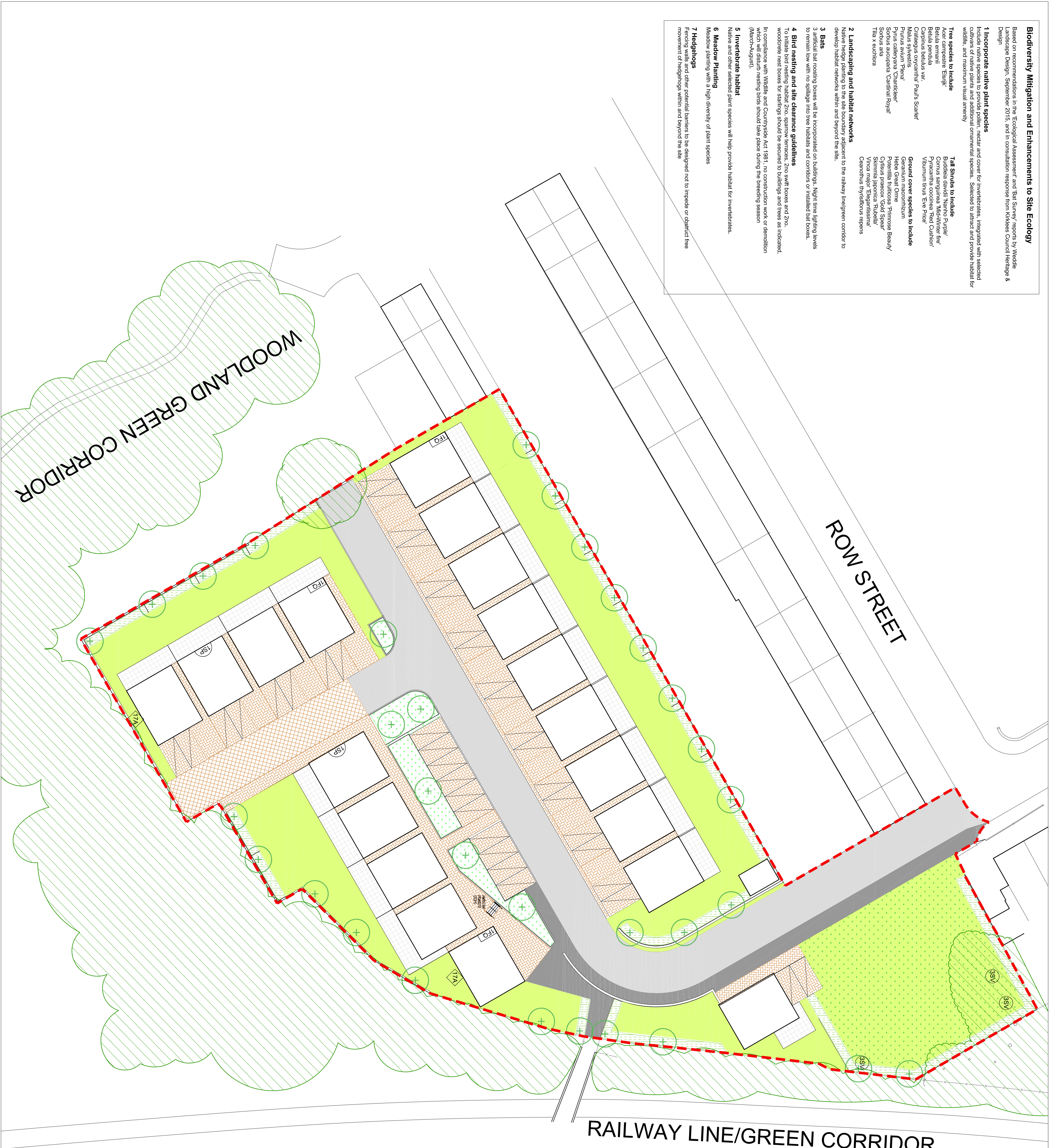

KEY:

- Existing Tree
- Proposed Standard Tree
- Ornamental and Native Shrub & Perennial Planting
- Proposed Native Hedge
- Meadow planting
- Grass
- Block Paving
- Slab Paving
- Proposed Tarmac Footpath
- Proposed Tarmac road
- Site Boundary
- 1FOQ Schwegler 1FO Bat Boxes
- 1SP Schwegler 1SP Sparrow Terrace
- 3SV Schwegler 3SV 45mm Nest box
- 17A Schwegler 17A Swift Nest Box

Revisions:

A - Layout revised as per Coda Studios updated site plan updated. Oct '15. TB

Based on Coda Studios Ltd's proposed site plan '2320-002' received 02/10/15.

Weddle Landscape Design

LANDSCAPE ARCHITECTURE
ENVIRONMENTAL PLANNING
News Studio, Charwood House,
8 Kenwood Park, Sheffield S7 1NU
Tel (0114) 250 1181
Fax (0114) 250 1188
mail@weddle.co.uk
www.weddle.co.uk

Job Row Street, Crosland Moor

Title				
LANDSCAPE MASTERPLAN				
BIODIVERSITY MITIGATION & ENHANCEMENT				
Scale/Alt	drawn	date	job number	number revision
1:250	TB	OCT 01	584	RCH02 A